

STATE OF ILLINOIS
DEPARTMENT OF TRANSPORTATION

INDEX OF SHEETS

Sheet No.	Description
1	Gen. Plan, Gen. Notes & Total Bill of Mat'l
2	Superstructure Details

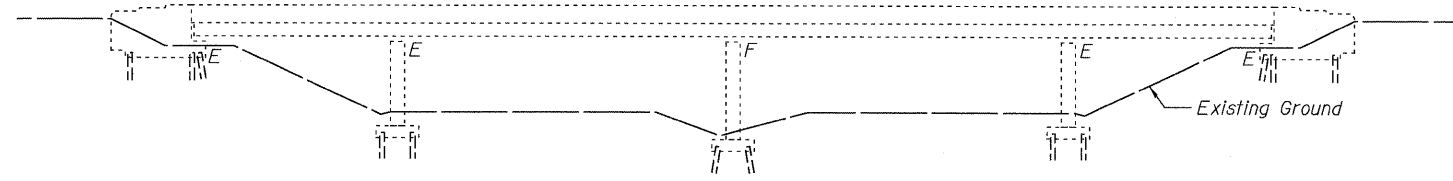

ELEVATION

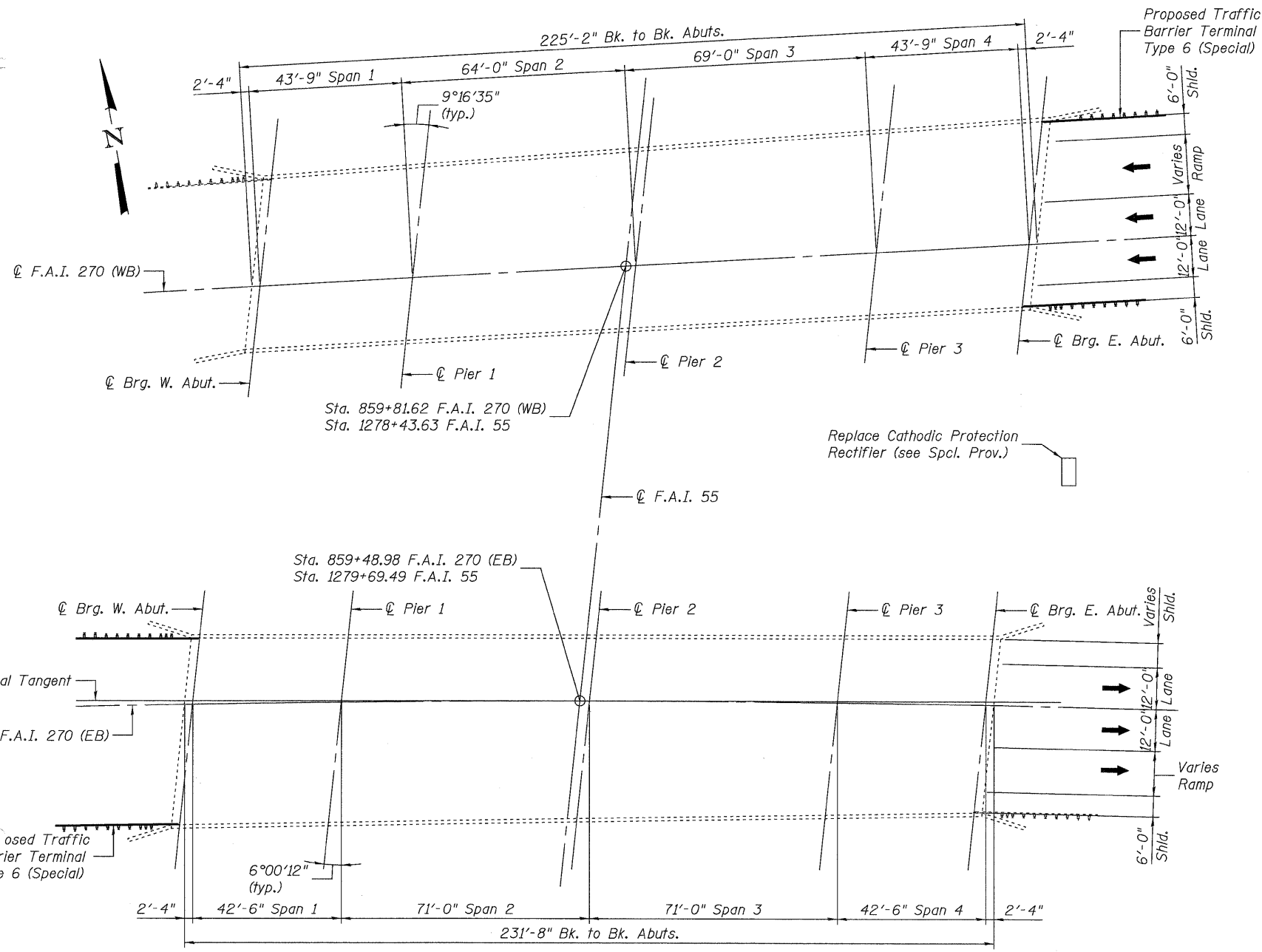

PLAN

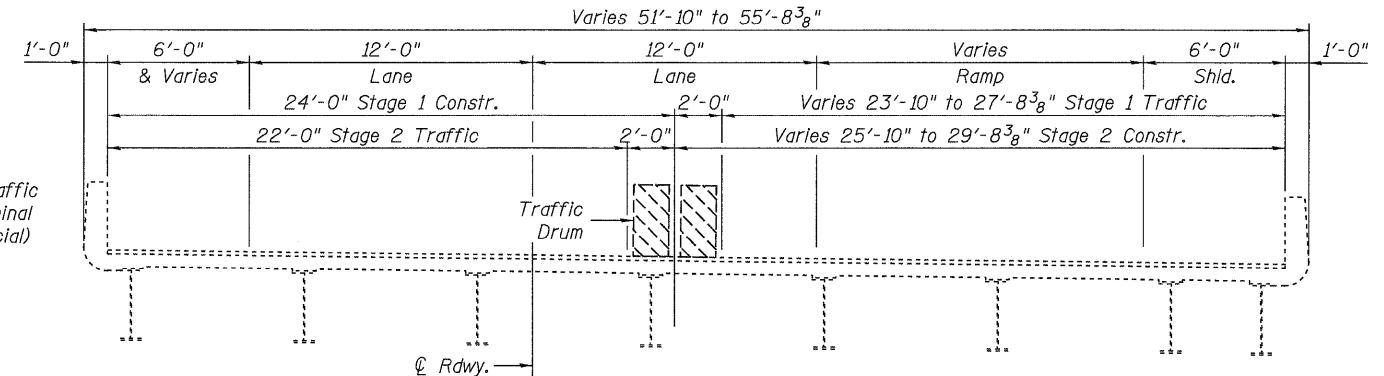

CROSS SECTION
(Eastbound, Looking East)

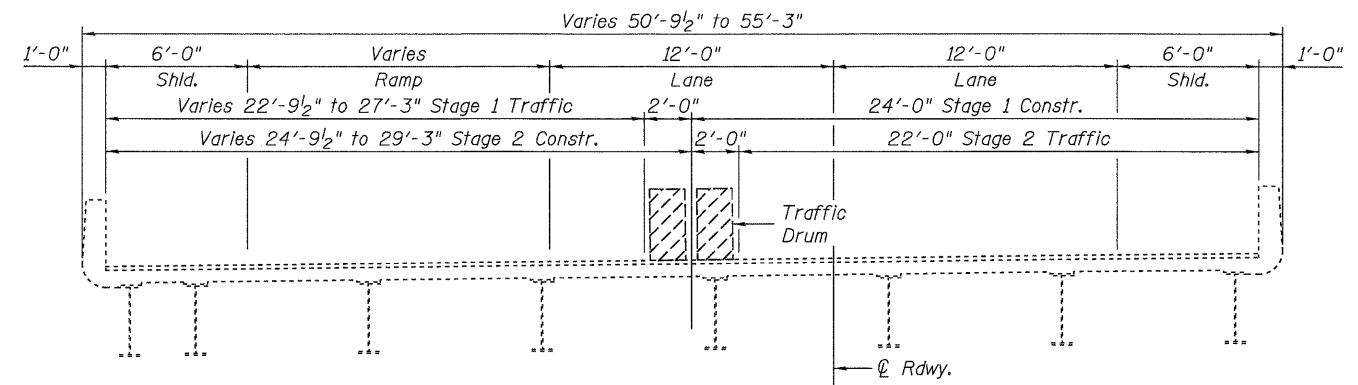

CROSS SECTION
(Westbound, Looking East)

TOTAL BILL OF MATERIAL

ITEM	UNIT	SUPER	SUB	TOTAL
Silicone Joint Sealer, 2 3/4"	Foot	--	212	212
Anchor Bolts, 1"	Each	--	32	32
Bridge Washing No. 7	Each	1	--	1
Bridge Washing No. 8	Each	1	--	1
Replace Cathodic Protection Rectifier	Each	1	--	1

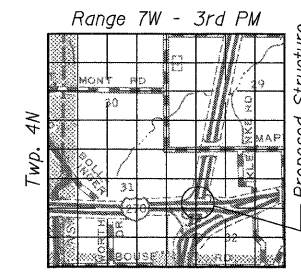

LOCATION SKETCH

GENERAL PLAN & ELEVATION
F.A.I. ROUTE 270 OVER
F.A.I. ROUTE 55
STRUCTURE NO. 060-0057(EB) & 0058(WB)

SHEET	F.A.I. RTE.	SECTION	COUNTY	TOTAL SHEETS	SHEET NO.
1 OF 2	70	60-(8,9,10)BR	MADISON	150	107
		STA. 1278+43.63 (I-55)	CONTRACT NO. 76A73		
		FED. ROAD DIST. NO.	ILLINOIS	FED. AID PROJECT	

JD Johnson, Depp & Quisenberry
CONSULTING ENGINEERS
Springfield, Illinois



Signed: *David Depp*
Date: *6-4-2009*
Lic. Expires: 11-30-2010

DESIGNED: JDQ	DRAWN: PTR
CHECKED: DCD	CHECKED: DCD

FILE: M:\projects\10166 IL-D88V\1-70 Resurfacing\5-SN0600057-0058-1270\0600057-76A73-001-gplan.dgn
USER: SJS
DATE: 06/11/2009 17:28:55