

**INDEX OF SHEETS**

Sheet Number	Drawing Title
1	COVER SHEET
2	INDEX OF DRAWINGS / HIGHWAY STANDARDS
3	GENERAL NOTES/COMMITMENTS
4	SUMMARY OF QUANTITIES
5	SCHEDULE OF QUANTITIES
6	SCHEDULE OF QUANTITIES
7	SEWER LINING KEY PLAN
8	SEWER LINING PLAN SHEET
9	SEWER LINING PLAN SHEET
10	SEWER LINING PLAN SHEET
11	SEWER LINING PLAN SHEET
12	SEWER LINING PLAN SHEET
13	SEWER LINING PLAN SHEET
14	SEWER LINING PLAN SHEET
15	SEWER LINING PLAN SHEET

**HIGHWAY STANDARDS**

STANDARD NO.	DESCRIPTION
000001-05	STANDARD SYMBOLS, ABBREVIATIONS AND PATTERNS
001006	DECIMAL OF AN INCH AND OF A FOOT
420001-07	PAVEMENT JOINTS
442201-03	CLASS C AND D PATCHES
604001-03	FRAME AND LIDS - TYPE 1
701006-03	OFF-RD OPERATIONS, 2L, 2W, 15' (4.5 m) TO 24" (600 mm) FROM PAVEMENT EDGE
701101-02	OFF-RD OPERATIONS, MULTILANE, 15' (4.5 m) TO 24" (600 mm) FROM PAVEMENT EDGE
701106-02	OFF-RD OPERATIONS, MULTILANE, MORE THAN 15' (4.5 m) AWAY
701501-05	URBAN LANE CLOSURE, 2L, 2W, UNDIVIDED
701502-03	URBAN LANE CLOSURE, 2L, 2W, WITH BIDIRECTIONAL LEFT TURN LANE
701601-06	URBAN LANE CLOSURE, MULTILANE, 1W OR 2W WITH NONTRAVERSABLE MEDIAN
701701-06	URBAN LANE CLOSURE, MULTILANE INTERSECTION
701801-04	URBAN LANE CLOSURE, MULTILANE, 1W OR 2W, CROSSWALK OR SIDEWALK CLOSURE
701901-01	TRAFFIC CONTROL DEVICES

Rev. Sheet 8-26-09

FILE NAME = DBTR1-76C48-sht-Index-02.dgn	USER NAME = IDOT	DESIGNED - TTB	REVISED -	<b>STATE OF ILLINOIS DEPARTMENT OF TRANSPORTATION</b>	<b>INDEX OF DRAWINGS / HIGHWAY STANDARDS</b>	F.A.I. RTE.	SECTION	COUNTY	TOTAL SHEETS	SHEET NO.	
	PLOT SCALE = 1.0000' / IN.	DRAWN - GDO	REVISED -			64	82-1T	ST. CLAIR	15	2	
	PLOT DATE = 6/16/2009	CHECKED - JAH	REVISED -			SCALE:		SHEET NO. 1 OF 1 SHEETS		STA.	TO STA.
		DATE - 6/16/2009	REVISED -			FED. ROAD DIST. NO. 8 ILLINOIS FED. AID PROJECT					
						CONTRACT NO. 76C48					

**GENERAL NOTES**

1. EXCESS WORK FOR ANY ITEM NOT IN SCOPE SHALL BE PAID FOR ACCORDING TO ARTICLE 109.04 OF THE STANDARD SPECIFICATIONS.
2. THE USE OF VIBRATORY ROLLERS IS PROHIBITED IN THE RESIDENTIAL AREA. THIS DOES NOT RELIEVE THE CONTRACTOR OF DENSITY REQUIREMENTS FOR THE BITUMINOUS PAVEMENTS AS SPECIFIED IN THE SPECIAL PROVISIONS FOR SUPERPAVE BITUMINOUS CONCRETE MIXTURES.
3. HIGH EARLY STRENGTH CONCRETE MIX SHALL BE USED FOR ALL PCC PATCHING AND NO ADDITIONAL PAYMENT WILL BE CONSIDERED.
4. THE IDOT HIGHWAY STANDARDS LATEST REVISION NUMBERS SHALL APPLY TO THIS PROJECT.
5. EXCEPT WHERE DESIGNATED OTHERWISE, THE LOCATIONS AND/OR DEPTHS OF UNDERGROUND UTILITIES SHOWN HAVE BEEN TAKEN FROM OFFICE RECORD INFORMATION FURNISHED BY THE UTILITY OWNERS AND THE SUE SURVEYS. ALL UNDERGROUND UTILITIES MUST BE CONSIDERED APPROXIMATE.
6. THE CONTRACTOR SHALL VERIFY ALL DIMENSIONS AND CONDITIONS IN THE FIELD PRIOR TO CONSTRUCTION AND ORDERING OF MATERIALS.
7. AT EACH MANHOLE SPECIFIED IN THE PLANS AS TO BE RECONSTRUCTED WITH PAVEMENT PATCHING REQUIRED, 10 SQUARE YARDS OF THE APPROPRIATE PAVEMENT PATCHING WAS INCLUDED.

**RAILROAD COORDINATION**

SPECIAL ATTENTION IS CALLED TO ARTICLE 107.12. THE NAMES AND TELEPHONE NUMBERS OF THE RAILROADS WITHIN THE PROJECT AREA ARE AS FOLLOWS:

METROLINK - (314) 982-1400 EXT. 1874

AFTER COMPLETION OF CONSTRUCTION, RAILROAD DRAINAGE DITCHES SHALL BE CLEANED OF ALL DEBRIS TO THE SATISFACTION OF THE ENGINEER.

**TRAFFIC CONTROL**

1. ALL TRAFFIC CONTROL SIGNS SHALL BE POST MOUNTED UNLESS OTHERWISE NOTED.
2. "ROAD CONSTRUCTION AHEAD" SIGNS SHALL BE PLACED AT THE BEGINNING AND END OF THE PROJECT AND ON THE INTERSECTING SIDE ROADS, AND WILL BE INCLUDED IN THE TRAFFIC CONTROL PAY ITEMS. ALL CONSTRUCTION SIGNS SHALL BE FLUORESCENT ORANGE, 48".
3. FLAGMEN SHALL BE PRESENT DURING ALL CLOSURE HOURS, INCLUDING LUNCH HOUR, AND NO ADDITIONAL COMPENSATION SHALL BE ALLOWED.
4. FOR STABILIZATION, ALL TYPE III BARRICADES SHALL REQUIRE A MINIMUM OF SIXTEEN SANDBAGS PER BARRICADE.

**UTILITY COORDINATION**

ILLINOIS STATE LAW REQUIRES A 48-HOUR NOTICE BE GIVEN TO ALL UTILITIES WITHIN THE PROJECT AREA BEFORE DIGGING BY CALLING J.U.L.I.E. AND BY NOTIFYING NON-J.U.L.I.E. MEMBERS INDIVIDUALLY. FIELD MARKING OF FACILITIES MAY ALSO BE OBTAINED BY PROVIDING A MINIMUM OF 96-HOURS NOTICE TO THE RESIDENT ENGINEER SO THAT UTILITY COMPANIES CAN BE NOTIFIED. AGENCIES KNOWN TO HAVE FACILITIES WITHIN THE PROJECT AREA ARE AS FOLLOWS:

- AMEREN UE
- AMERITECH
- CHARTER COMMUNICATIONS
- EXPLORER PIPELINE
- ILLINOIS POWER COMPANY
- ILLINOIS AMERICAN WATER
- MARATHON ASHLAND PIPELINE COMPANY
- MCI
- MCLEOD USA
- NORAM TRADING AND TRANSPORTATION COMPANY
- QWEST
- SPRINT
- WORLDCOM
- 360 NETWORKS

CITY OF EAST ST LOUIS - (618) 482-6737  
 METRO EAST SANITARY DISTRICT - (618) 452-9400  
 ST LOUIS NATIONAL STOCKYARDS COMPANY - (405) 235-8675

(MEMBERS OF J.U.L.I.E. (800)-892-0123 OR 811 ARE INDICATED BY \*. NON-J.U.L.I.E. MEMBERS MUST BE NOTIFIED INDIVIDUALLY.)

**COORDINATE SYSTEM AND DATUM**

THIS PROJECT IS BASED ON THE MISSISSIPPI RIVER CROSSING (MRC) COORDINATE SYSTEM. THE MISSISSIPPI RIVER CROSSING (MRC) COORDINATE SYSTEM IS BASED ON A MODIFIED UNIVERSAL TRANSVERSE MERCATOR (UTM) SYSTEM. THE MRC COORDINATE SYSTEM HAS BEEN CONVERTED FROM UTM ZONE 15 NORTH BY AN AVERAGE PROJECTION FACTOR AND ALSO CONVERTED FROM METERS TO U.S. SURVEY FEET.

AVERAGE GRID FACTOR = 1.000339495  
 PROJECTION FACTOR = 1/grid = 0.999660620

THE BASE POINT FROM WHICH ALL UTM COORDINATES WERE SCALED WAS PRIMARY CONTROL MONUMENT NUMBER 10, LISTED IN APPENDIX A OF THE MRC SURVEY SUMMARY, AVAILABLE FROM THE ENGINEER. EACH VECTOR FROM MONUMENT NUMBER 10 TO ALL OTHER MONUMENTS WAS MULTIPLIED BY THE PROJECTION FACTOR TO CALCULATE A SURFACE VECTOR AND THEN THIS SURFACE VECTOR WAS USED TO CALCULATE THE SURFACE COORDINATES.

THE VERTICAL CONTROL DATUM IS NAVD 1988.

**COMMITMENTS**

1. ALL CONSTRUCTION ACTIVITIES WILL FOLLOW ILLINOIS PROCEDURES DESIGNED TO MINIMIZE CONSTRUCTION IMPACTS ON AIR QUALITY.
2. THE CONSTRUCTION SPECIFICATIONS WILL INCLUDE REQUIREMENTS TO PROHIBIT THE CONTRACTOR FROM DISPOSING OF ANY POLLUTANTS, SUCH AS FUELS, LUBRICANTS, RAW SEWAGE, OR OTHER HARMFUL SUBSTANCES, INAPPROPRIATELY.

*Rev. Sheet 8-26-09*

FILE NAME = DBTRI-76C48-sht-GenNotes-03.dgn	USER NAME = IDOT	DESIGNED - TTB	REVISED -	<b>STATE OF ILLINOIS DEPARTMENT OF TRANSPORTATION</b>	<b>GENERAL NOTES / COMMITMENTS</b>	F.A.I. RTE.	SECTION	COUNTY	TOTAL SHEETS	SHEET NO.	
		DRAWN - GDO	REVISED -			64	82-1T	ST. CLAIR	15	3	
		CHECKED - JAH	REVISED -			CONTRACT NO. 76C48					
		DATE - 6/16/2009	REVISED -			FED. ROAD DIST. NO. 8 ILLINOIS FED. AID PROJECT					
				SCALE: SHEET NO. 1 OF 1 SHEETS STA. TO STA.							

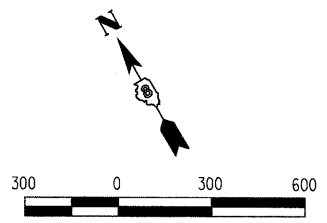

FILE NAME = DBTRI-76C48-ah-Keyp1an-07.dgn	USER NAME = IDOT	DESIGNED - TTB	REVISED -
	PLOT SCALE = 300.0000' / IN.	DRAWN - GDO	REVISED -
	PLOT DATE = 6/16/2009	CHECKED - JAH	REVISED -
		DATE - 6/16/2009	REVISED -

**STATE OF ILLINOIS  
DEPARTMENT OF TRANSPORTATION**

**SEWER LINING KEY PLAN**

SCALE: 1"=300'    SHEET NO. 1 OF 1 SHEETS    STA.    TO STA.

*Rev. Sheet B-20-09*

F.A.I. RTE.	SECTION	COUNTY	TOTAL SHEETS	SHEET NO.
64	82-1T	ST. CLAIR	15	7
FED. ROAD DIST. NO. 8 ILLINOIS FED. AID PROJECT			CONTRACT NO. 76C48	

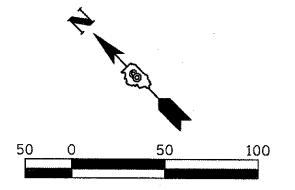
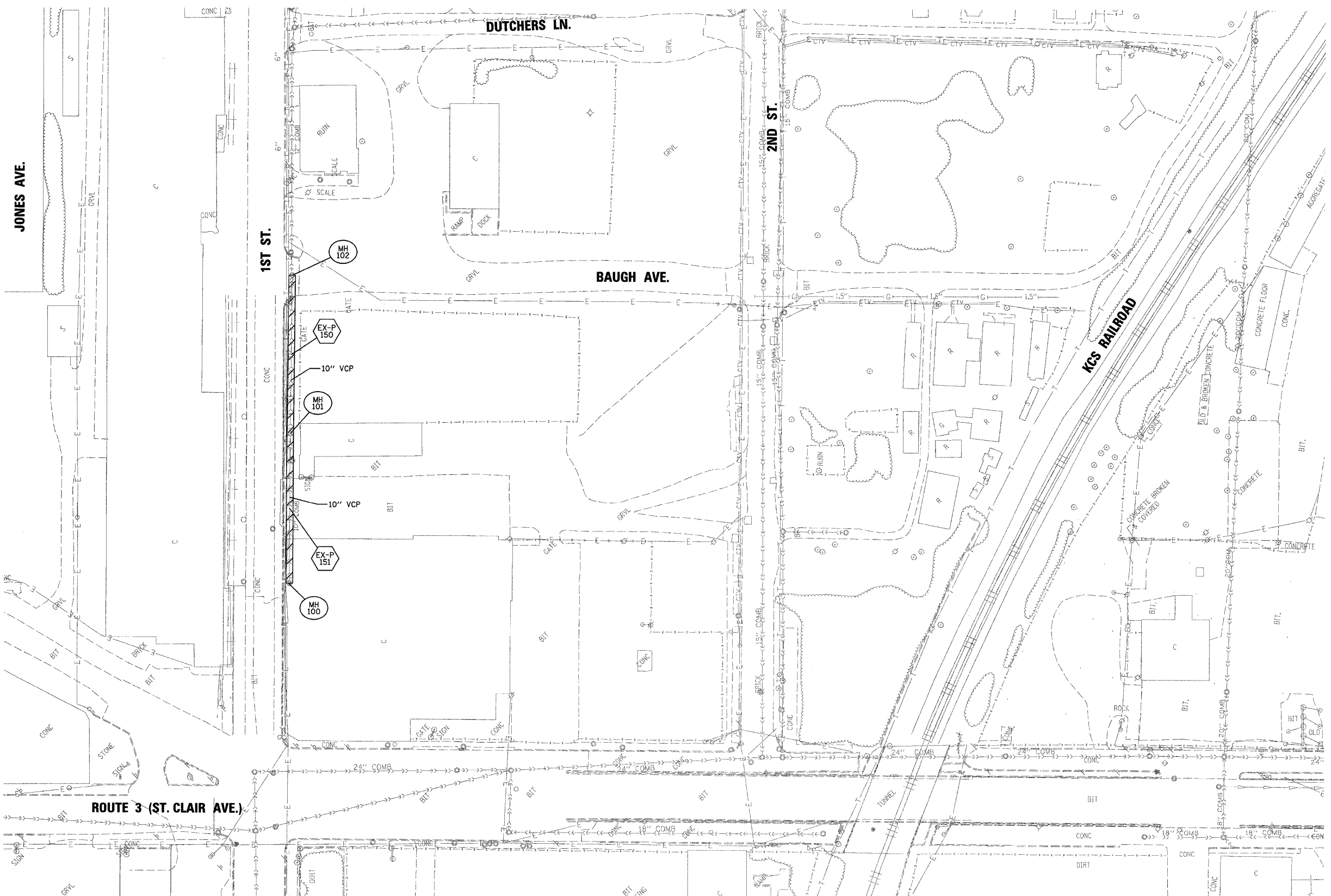

- LEGEND**
- MH  
XXX MANHOLE LABEL
  - EX-P  
XX PIPE LABEL
  - PIPE LINER

MH NO.	MANHOLE REHABILITATION REQUIRED	TRAFFIC CONTROL STANDARD	COMMENT
MH 100	LEVEL B	701006	
MH 101	LEVEL B	701006	
MH 102	LEVEL B	701006	

FILE NAME =  
DBTRI-76C48-sht-Plan-08.dgn

USER NAME = IDOT  
PLOT SCALE = 50.0000' / IN.  
PLOT DATE = 6/16/2009

DESIGNED - TTB  
DRAWN - GDO  
CHECKED - JAH  
DATE - 6/16/2009

REVISED -  
REVISED -  
REVISED -  
REVISED -

**STATE OF ILLINOIS  
DEPARTMENT OF TRANSPORTATION**

**SEWER LINING PLAN**

SCALE: 1"=50'    SHEET NO. 1 OF 8 SHEETS    STA.    TO STA.

A Rev. B-26-09

F.A.I. RTE.	SECTION	COUNTY	TOTAL SHEETS	SHEET NO.
64	82-1T	ST. CLAIR	15	8

CONTRACT NO. 76C48  
FED. ROAD DIST. NO. 8 ILLINOIS FED. AID PROJECT

MATCH LINE SEE SHEET 9

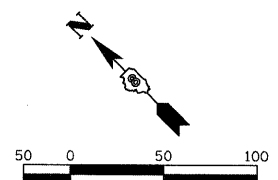
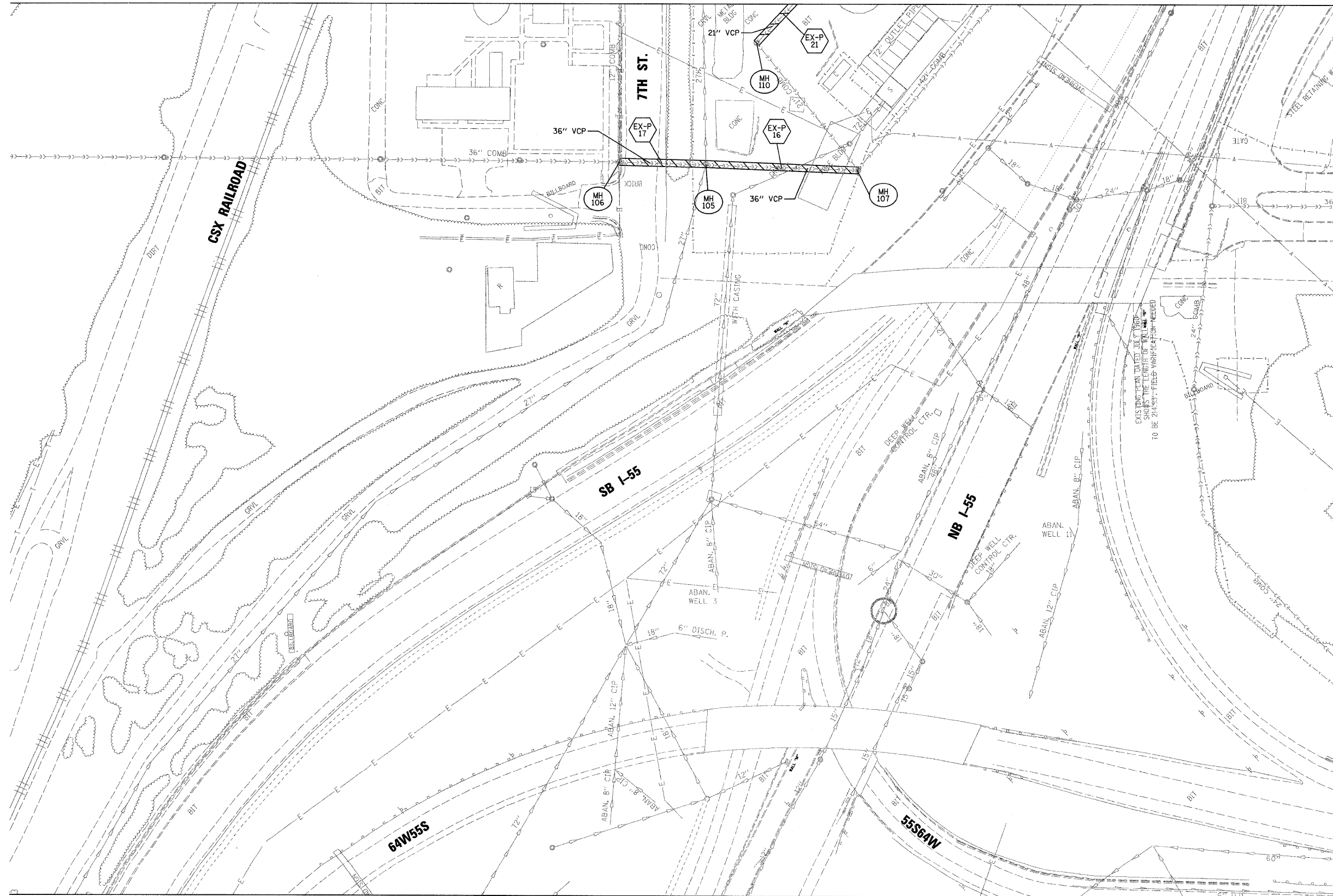

**LEGEND**

- MANHOLE LABEL
- PIPE LABEL
- PIPE LINER

MATCH LINE SEE SHEET 11

MH NO.	MANHOLE REHABILITATION REQUIRED	TRAFFIC CONTROL STANDARD	COMMENT
MH 105	LEVEL C	N/A	
MH 106	LEVEL C	701006	
MH 107	LEVEL C	N/A	
MH 110	RECONSTRUCT	N/A	MH TO BE LOCATED; CLASS D PATCH NEEDED

FILE NAME = DBTR1-76C48-shr-Plan-10.dgn

USER NAME = IDOT  
 PLOT SCALE = 50,0000' / IN.  
 PLOT DATE = 6/16/2009

DESIGNED - TTBB  
 DRAWN - GDO  
 CHECKED - JAH  
 DATE - 6/16/2009

REVISED -  
 REVISED -  
 REVISED -  
 REVISED -

**STATE OF ILLINOIS  
 DEPARTMENT OF TRANSPORTATION**

**SEWER LINING PLAN**

SCALE: 1"=50' SHEET NO. 3 OF 8 SHEETS STA. TO STA.

Rev Sheet 8-26-09

F.A.I. RTE.	SECTION	COUNTY	TOTAL SHEETS	SHEET NO.
64	82-1T	ST. CLAIR	15	10
CONTRACT NO. 76C48			FED. ROAD DIST. NO. 8 ILLINOIS FED. AID PROJECT	

MATCH LINE SEE SHEET 10

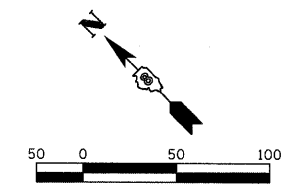
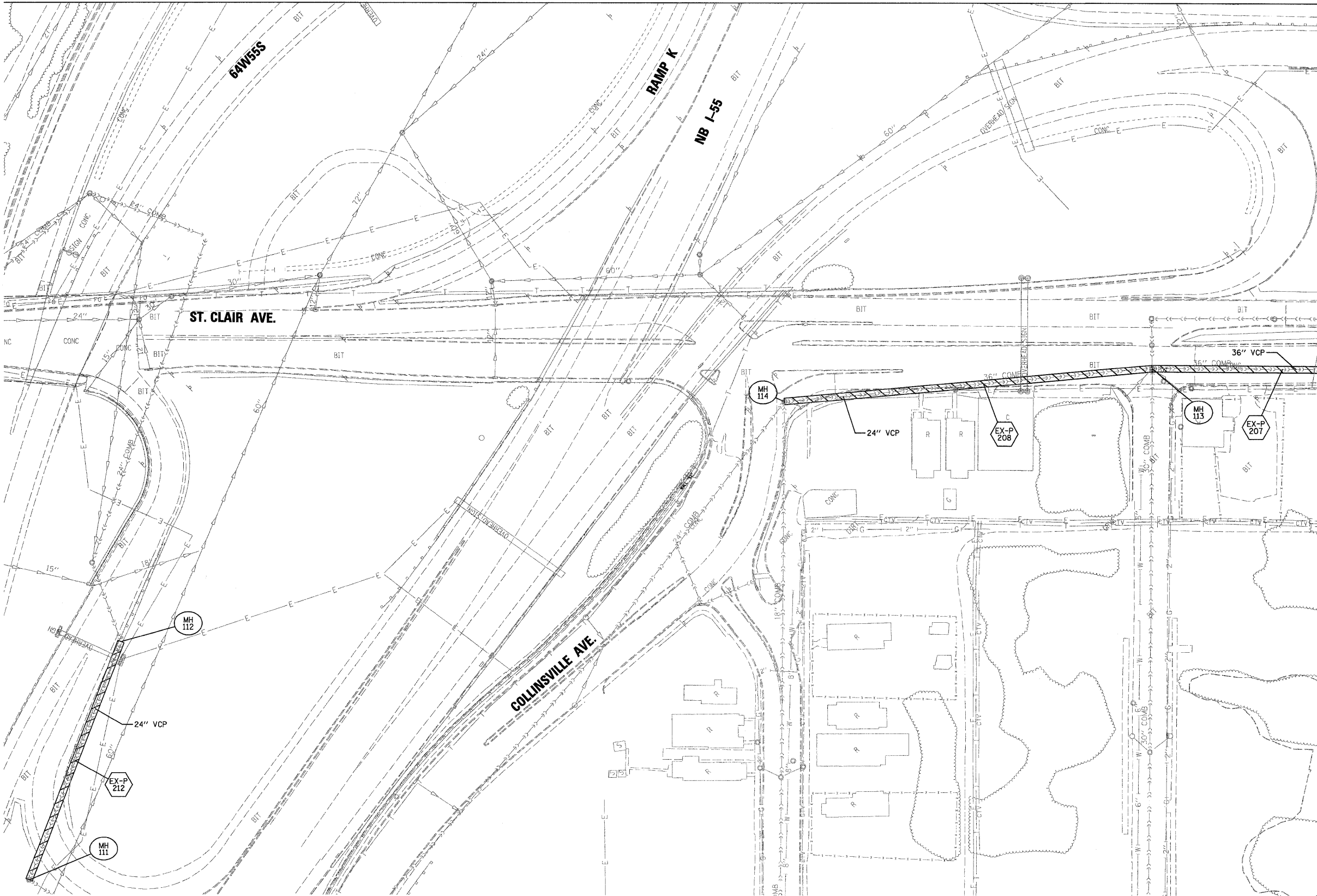

**LEGEND**

- MANHOLE LABEL
- PIPE LABEL
- PIPE LINER

MATCH LINE SEE SHEET 13

MANHOLE NO.	MANHOLE REHABILITATION REQUIRED	TRAFFIC CONTROL STANDARD	COMMENT
MH 111	LEVEL B	701106	
MH 112	LEVEL B	701101	
MH 113	LEVEL B	701501, 701601, & 701701	
MH 114	LEVEL B	701701	

FILE NAME =  
D8TR1-76C48-shr-Plan-11.dgn

USER NAME = IDOT  
DESIGNED - TTB  
DRAWN - GDO  
CHECKED - JAH  
DATE - 6/16/2009

REVISED -  
REVISED -  
REVISED -  
REVISED -

**STATE OF ILLINOIS  
DEPARTMENT OF TRANSPORTATION**

**SEWER LINING PLAN**

SCALE: 1"=50'    SHEET NO. 4 OF 8 SHEETS    STA.    TO STA.

F.A.I. RTE.	SECTION	COUNTY	TOTAL SHEETS	SHEET NO.
64	82-1T	ST. CLAIR	15	11

CONTRACT NO. 76C48

Rev. Sheet 8-26-09

FED. ROAD DIST. NO. 8 ILLINOIS FED. AID PROJECT

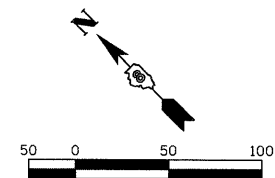

**LEGEND**

- MANHOLE LABEL
- PIPE LABEL
- PIPE LINER

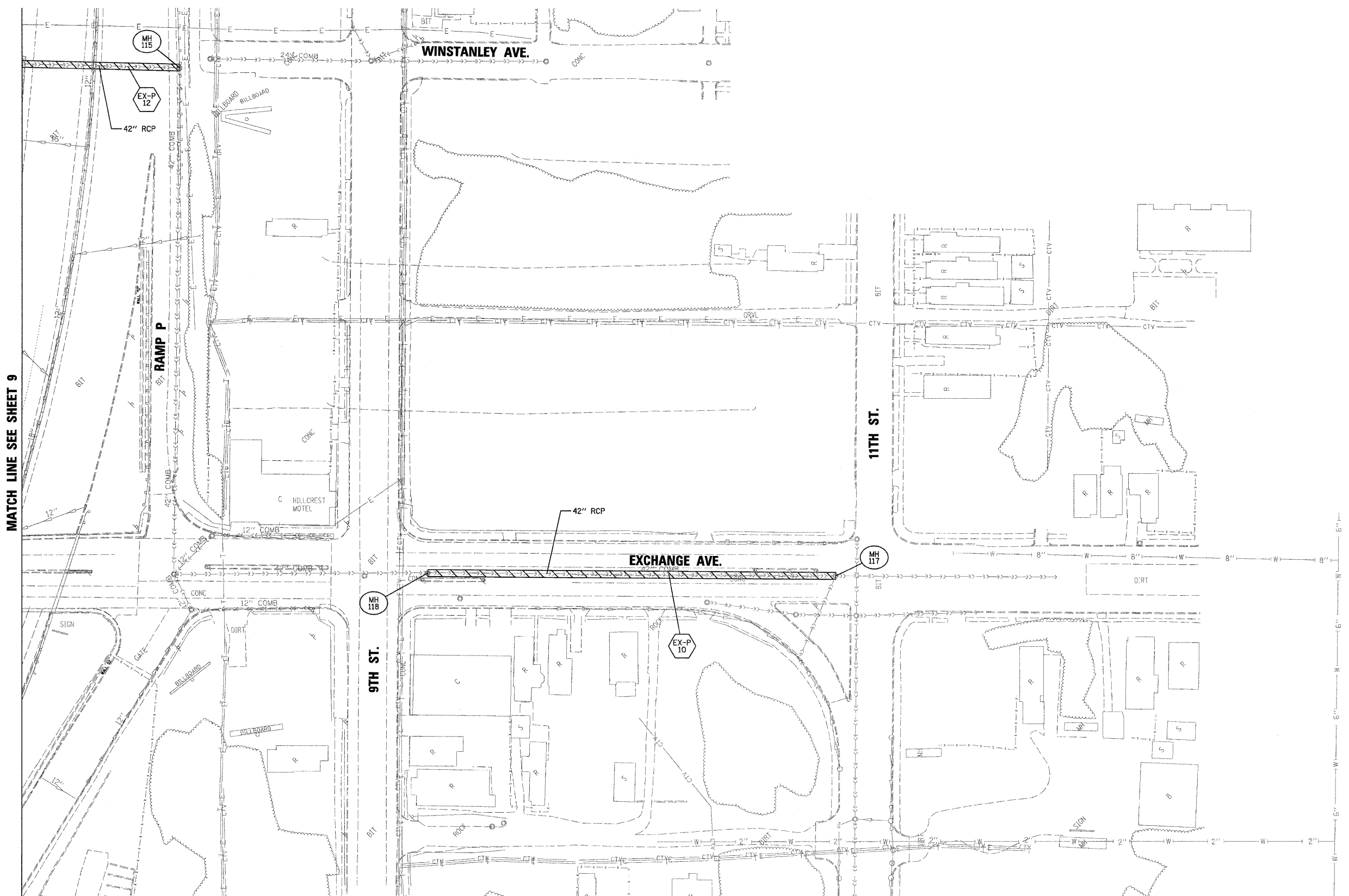

MATCH LINE SEE SHEET 9

MANHOLE NO.	MANHOLE REHABILITATION REQUIRED	TRAFFIC CONTROL STANDARD	COMMENT
MH 115	LEVEL C	701101	
MH 117	LEVEL C	701701 & 701502	
MH 118	LEVEL C	701701	

FILE NAME = DBTR1-76C48-sh1-P1an-12.dgn

USER NAME = IDOT

DESIGNED - TTB

REVISED -

PLOT SCALE = 50.0000' / IN.

DRAWN - GDO

REVISED -

PLOT DATE = 6/16/2009

CHECKED - JAH

REVISED -

DATE - 6/16/2009

REVISED -

**STATE OF ILLINOIS  
DEPARTMENT OF TRANSPORTATION**

**SEWER LINING PLAN**

SCALE: 1"=50' SHEET NO. 5 OF 8 SHEETS STA. TO STA.

*Rev. Sheet B-26-09*

F.A.I. RTE.	SECTION	COUNTY	TOTAL SHEETS	SHEET NO.
64	82-1T	ST. CLAIR	15	12

CONTRACT NO. 76C48  
FED. ROAD DIST. NO. 8 ILLINOIS FED. AID PROJECT

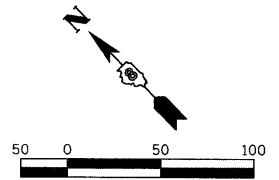

**LEGEND**

- MANHOLE LABEL
- PIPE LABEL
- PIPE LINER

MATCH LINE SEE SHEET 11

MATCH LINE SEE SHEET 14

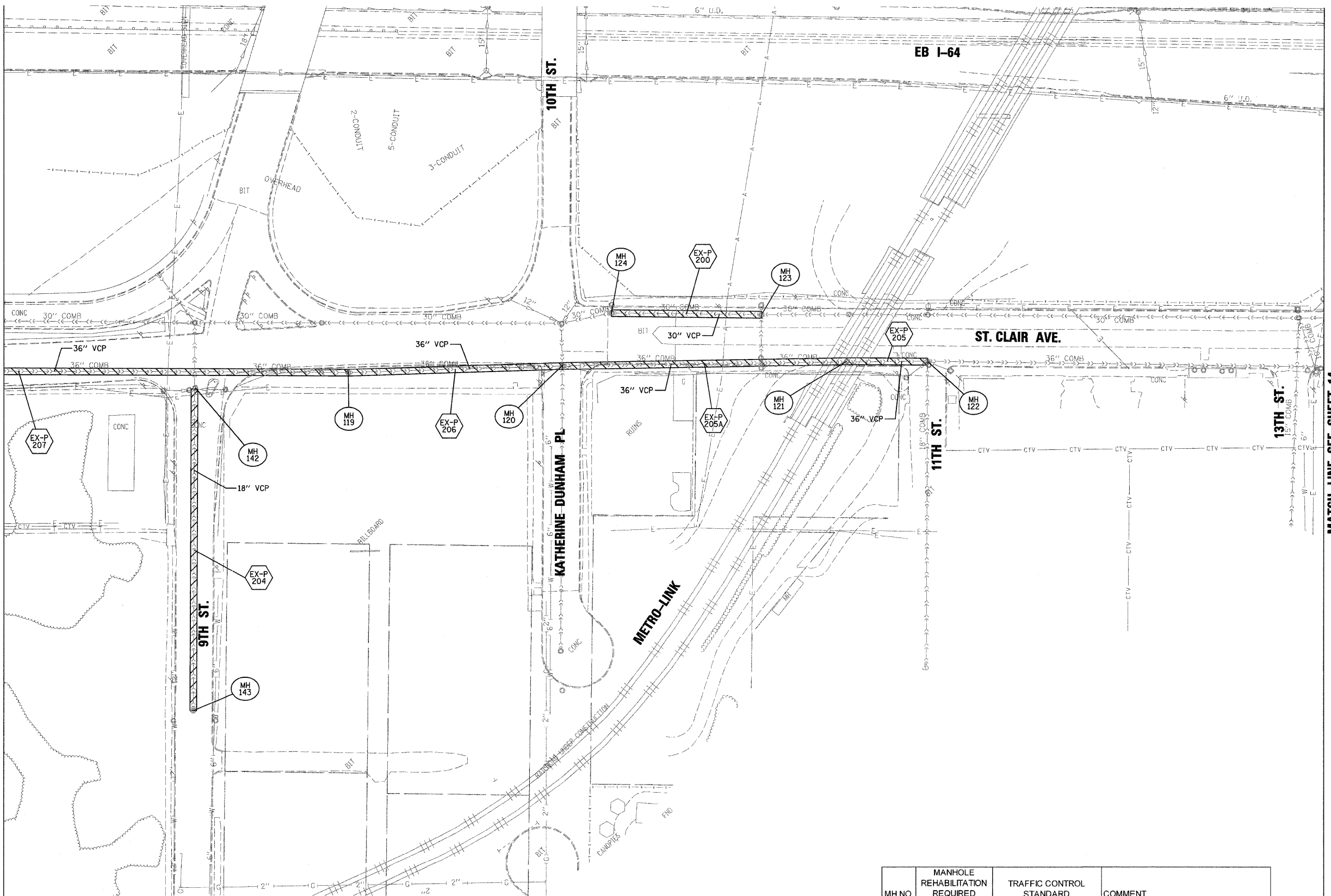

MH NO.	MANHOLE REHABILITATION REQUIRED	TRAFFIC CONTROL STANDARD	COMMENT
MH 119	LEVEL C	701101 & 701801	
MH 120	LEVEL C	701501 & 701701	
MH 121	LEVEL C	701601 & 701801	
MH 122	LEVEL C	701501, 701601, & 701701	
MH 123	LEVEL C	701601	
MH 124	LEVEL C	701601	
MH 142	LEVEL B	701701	
MH 143	LEVEL B	701601	

FILE NAME = DBTRI-76C48-shr-Plan-13.dgn	USER NAME = IDOT	DESIGNED - TTB	REVISED -
		DRAWN - GDO	REVISED -
		CHECKED - JAH	REVISED -
		DATE - 6/16/2009	REVISED -
PLOT SCALE = 50.0000' / IN.			
PLOT DATE = 6/16/2009			

**STATE OF ILLINOIS  
DEPARTMENT OF TRANSPORTATION**

**SEWER LINING PLAN**

SCALE: 1"=50'      SHEET NO. 6 OF 8 SHEETS      STA.      TO STA.

Rev. Sheet 8-26-09

F.A.I. RTE.	SECTION	COUNTY	TOTAL SHEETS	SHEET NO.
64	82-1T	ST. CLAIR	15	13
CONTRACT NO. 76C48				

FED. ROAD DIST. NO. 8 ILLINOIS FED. AID PROJECT



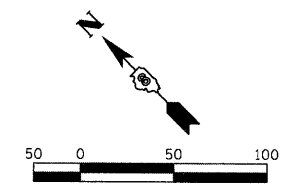
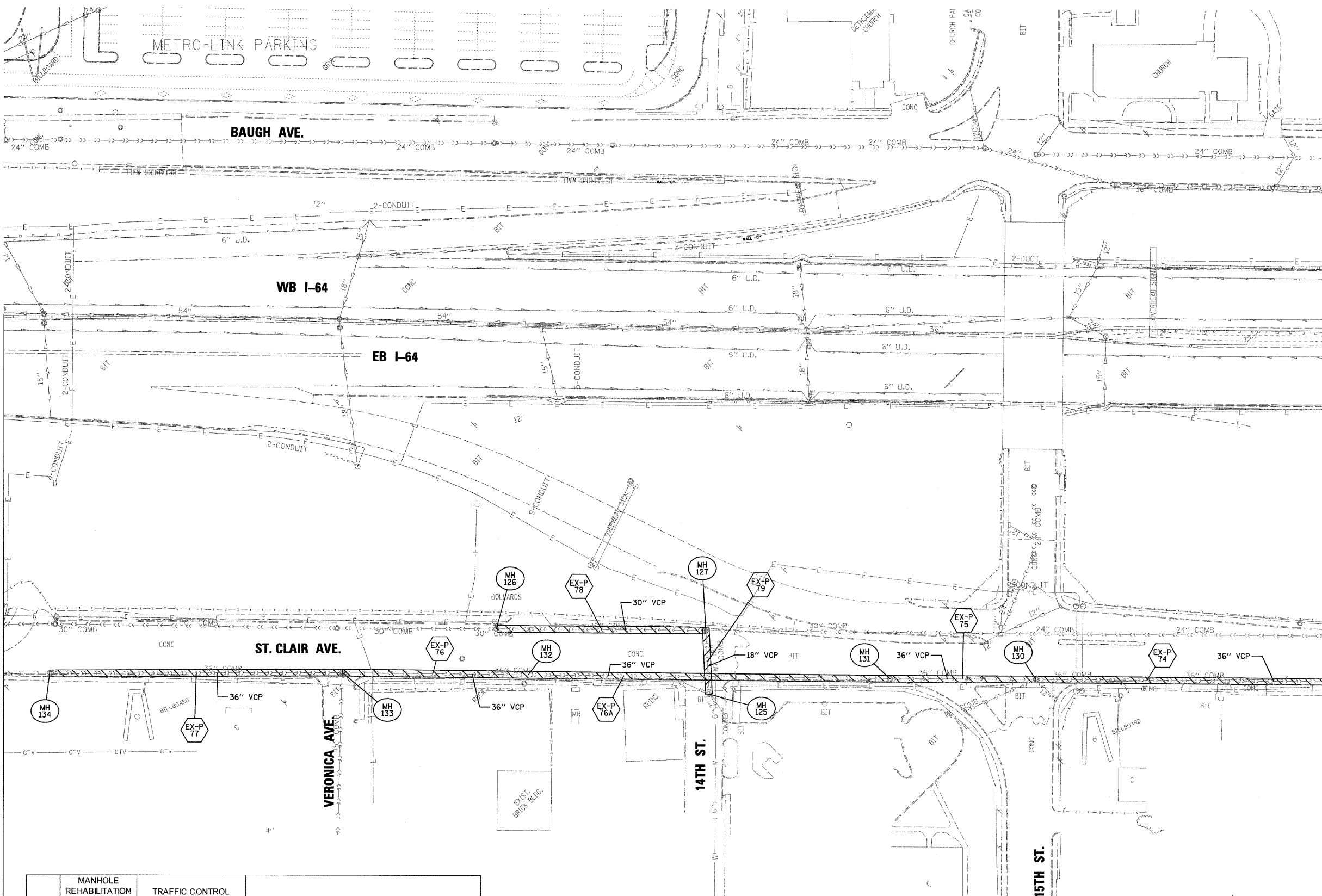

**LEGEND**

- MANHOLE LABEL
- PIPE LABEL
- PIPE LINER

MATCH LINE SEE SHEET 13

MATCH LINE SEE SHEET 15

MH NO.	MANHOLE REHABILITATION REQUIRED	TRAFFIC CONTROL STANDARD	COMMENT
MH 125	LEVEL B	701501, 701601, & 701701	
MH 126	LEVEL C	701601	
MH 127	LEVEL C	701601 & 701801	
MH 130	LEVEL C	701601 & 701701	
MH 131	LEVEL C	701601, 701701, & 701801	
MH 132	RECONSTRUCT	701601 & 701801	MH TO BE LOCATED; CLASS C PATCH NEEDED
MH 133	LEVEL C	701501, 701601, & 701701	
MH 134	RECONSTRUCT	701601 & 701801	MH TO BE LOCATED; CLASS C PATCH NEEDED

FILE NAME = DBTR1-76C48-ah-t-Plan-14.dgn

USER NAME = IDOT  
 PLOT SCALE = 80,000' / IN.  
 PLOT DATE = 6/16/2009

DESIGNED - TTB  
 DRAWN - GDO  
 CHECKED - JAH  
 DATE - 6/16/2009

REVISED -  
 REVISED -  
 REVISED -  
 REVISED -

**STATE OF ILLINOIS  
 DEPARTMENT OF TRANSPORTATION**

**SEWER LINING PLAN**

SCALE: 1"=50' SHEET NO. 7 OF 8 SHEETS STA. TO STA.

Rev. Sheet 8-26-09

F.A.I. RTE.	SECTION	COUNTY	TOTAL SHEETS	SHEET NO.
64	82-1T	ST. CLAIR	15	14
CONTRACT NO. 76C48				
FED. ROAD DIST. NO. 8 ILLINOIS FED. AID PROJECT				

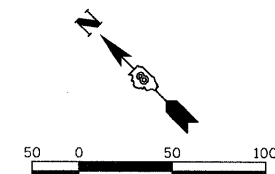

**LEGEND**

- MANHOLE LABEL
- PIPE LABEL
- PIPE LINER

MATCH LINE SEE SHEET 14

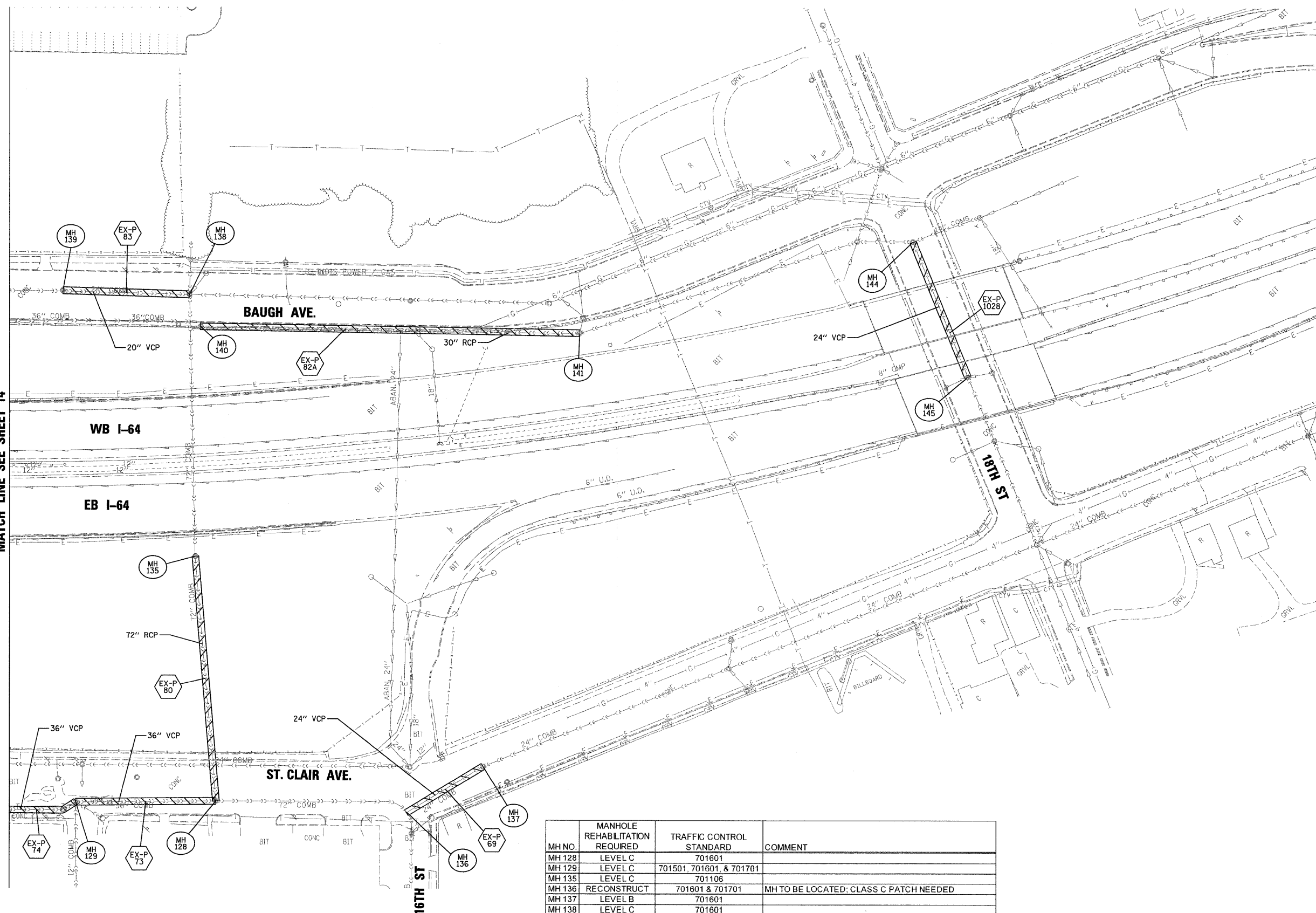

MH NO.	MANHOLE REHABILITATION REQUIRED	TRAFFIC CONTROL STANDARD	COMMENT
MH 128	LEVEL C	701601	
MH 129	LEVEL C	701501, 701601, & 701701	
MH 135	LEVEL C	701106	
MH 136	RECONSTRUCT	701601 & 701701	MH TO BE LOCATED; CLASS C PATCH NEEDED
MH 137	LEVEL B	701601	
MH 138	LEVEL C	701601	
MH 139	LEVEL B	701601	
MH 140	LEVEL C	701101 & 701801	
MH 141	LEVEL C	701106	
MH 144	LEVEL C	701501	
MH 145	LEVEL C	701501	

FILE NAME =	USER NAME = IDOT	DESIGNED -	TTB	REVISED -
D8TRI-76C48-shr-Plan-15.dgn		DRAWN -	GDO	REVISED -
	PLOT SCALE = 50.0000' / IN.	CHECKED -	JAH	REVISED -
	PLOT DATE = 6/16/2009	DATE -	6/16/2009	REVISED -

**STATE OF ILLINOIS  
DEPARTMENT OF TRANSPORTATION**

**SEWER LINING PLAN**

SCALE: 1"=50'    SHEET NO. 8 OF 8 SHEETS    STA.    TO STA.

Rev. Sheet 8-26-09

F.A.I. RTE.	SECTION	COUNTY	TOTAL SHEETS	SHEET NO.
64	82-1T	ST. CLAIR	15	15
CONTRACT NO. 76C48			FED. ROAD DIST. NO. 8 ILLINOIS FED. AID PROJECT	