

STATE OF ILLINOIS  
DEPARTMENT OF TRANSPORTATION  
DIVISION OF HIGHWAYS

**PROPOSED  
HIGHWAY PLANS**

FAP ROUTE 331 (ILLINOIS 13)  
SECTION (1X-1)N-1,TS-2  
PROJECT: HSIP-0331(049)  
INTERSECTION IMPROVEMENT  
WILLIAMSON COUNTY  
C-99-037-08

F.A. RTE.	SECTION	COUNTY	TOTAL SHEETS	SHEET NO.
331	(1X-1)N-1,TS-2	WILLIAMSON	190	1
FED. ROAD DIST. NO.	ILLINOIS	CONTRACT NO. 78053		

★ 190 + 2 = 192

D-99-024-08

FOR INDEX OF SHEETS, SEE SHEET NO. 2  
FOR SUMMARY OF QUANTITIES, SEE SHEET NO. 4-6

APPROACH	ADT(2009)	% TRUCK
WILLIAMSON CO. PARK N OF IL 13	11,100	2.3%
IL 13 E OF WALTON WAY	29,800	5.7%
WALTON WAY S OF IL 13	5,200	3.3%
IL 13 W OF WALTON WAY	29,800	5.7%

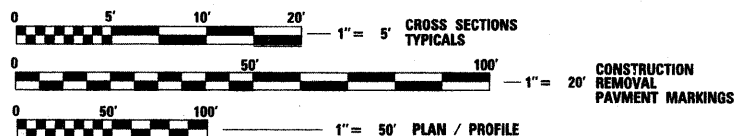
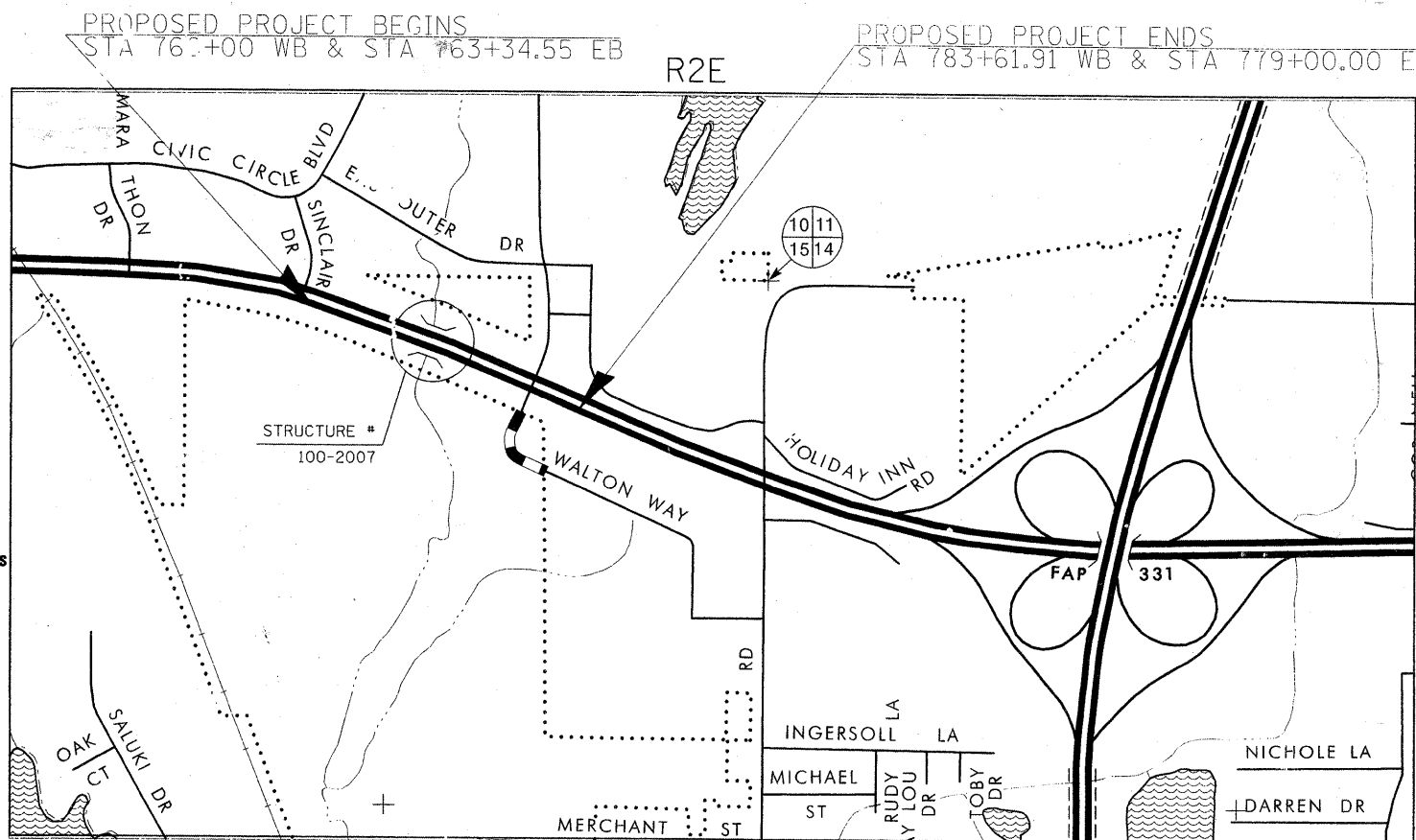
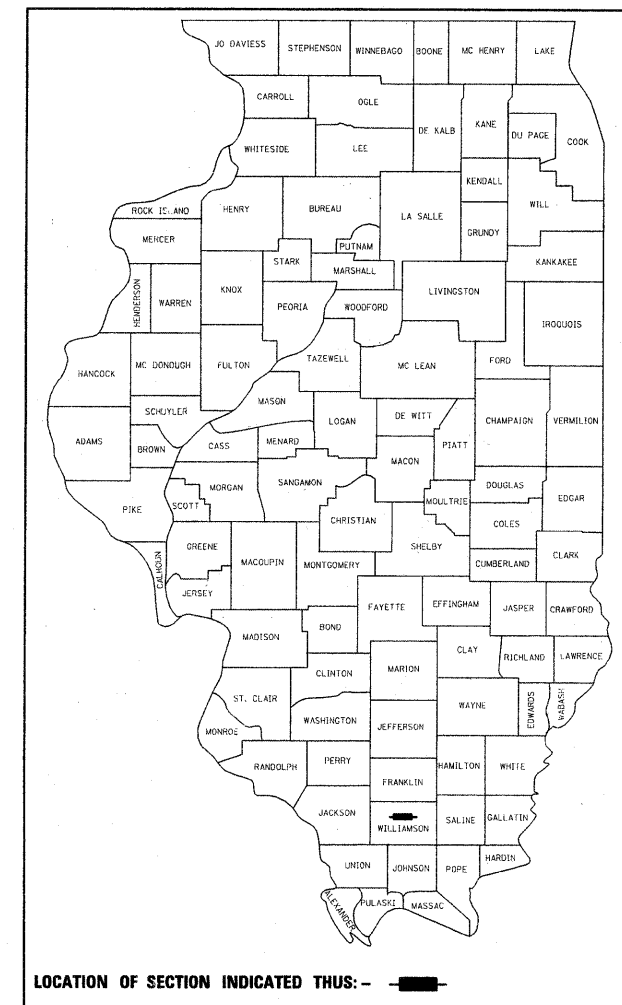

FULL SIZE PLANS HAVE BEEN PREPARED USING STANDARD ENGINEERING SCALES. REDUCED SIZED PLANS WILL NOT CONFORM TO STANDARD SCALES. IN MAKING MEASUREMENTS ON REDUCED PLANS, THE ABOVE SCALES MAY BE USED.

J.U.L.I.E.  
JOINT UTILITY LOCATION INFORMATION FOR EXCAVATION  
1-800-892-0123  
OR 811

PROJECT ENGINEER CHRIS RUSSELL  
PROJECT MANAGER SUSAN POE

CONTRACT NO. 78053

GROSS LENGTH = 1565.45 FT. = 0.296 MILE  
NET LENGTH = 1565.45 FT. = 0.296 MILE

STATE OF ILLINOIS  
DEPARTMENT OF TRANSPORTATION  
DIVISION OF HIGHWAYS

SUBMITTED April 21, 2009  
Max C. Ramo  
DEPUTY DIRECTOR OF HIGHWAYS, REGION ENGINEER

August 14, 2009  
Charles G. Ingersoll  
ENGINEER OF DESIGN AND ENVIRONMENT

August 14, 2009  
Christine M. Reed  
DIRECTOR OF HIGHWAYS, CHIEF ENGINEER

PRINTED BY THE AUTHORITY  
OF THE STATE OF ILLINOIS