

PLAN	SURVEYED	DATE
	ALIGNED	BY
	RT. OF WAY CHECKED	
	NO. OF WAY CHECKED	
	NO.	
	CADD FILE NAME	

PROFILE	SURVEYED	DATE
	GRADES	BY
	NOTED	
	STRUCTURE NOTATIONS	CPKD

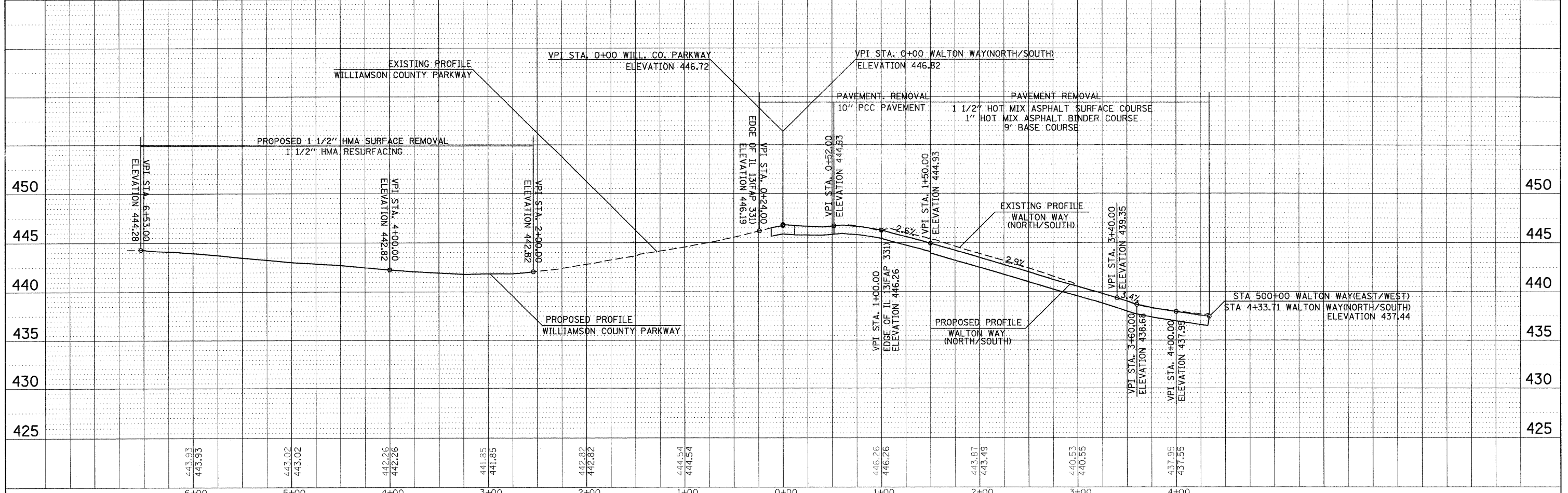
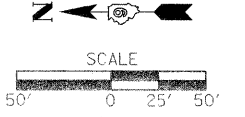
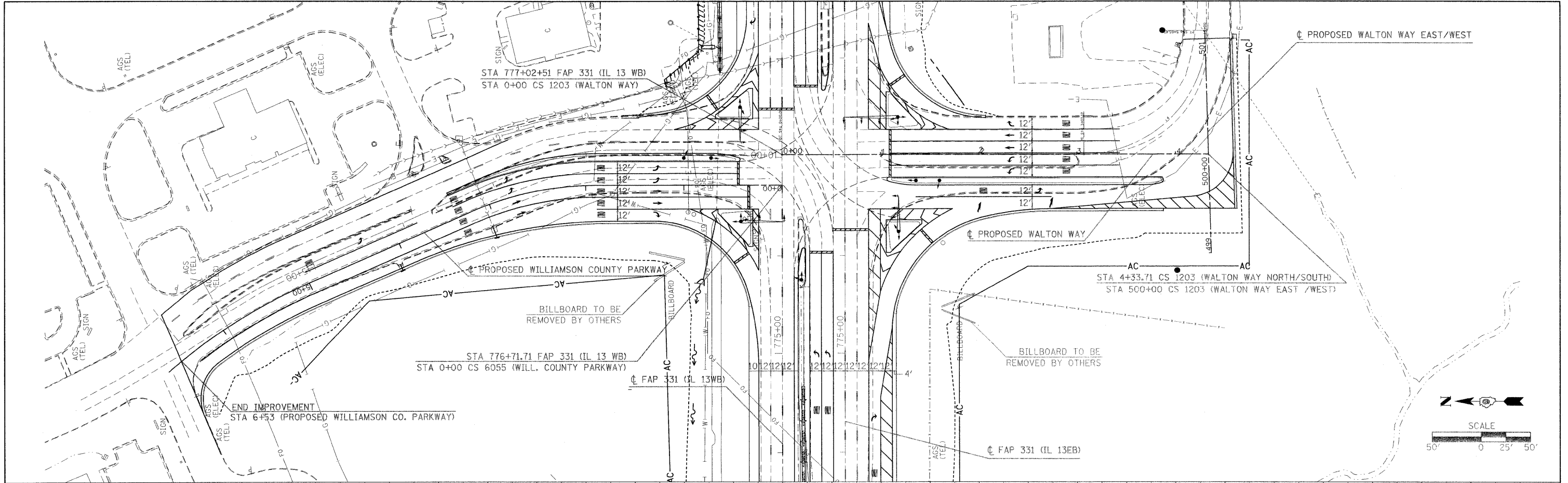

FILE: B:\1998\78053\190\190.DWG	USER NAME = russellr	DESIGNED -	REVISED -	<b>STATE OF ILLINOIS DEPARTMENT OF TRANSPORTATION</b>	<b>PLAN PROFILE - WALTON WAY/WILLIAMSON COUNTY PARKWAY</b>	F.A.P. RTE. 331	SECTION (IX-DN-1, TS-2)	COUNTY WILLIAMSON	TOTAL SHEETS 190	SHEET NO. 40
PLOT SCALE = 50,0000 / IN.	CHECKED -	REVISED -	SCALE: 1"=50'			SHEET NO. OF SHEETS	STA. TO STA.	CONTRACT NO. 78053		
PLOT DATE = 8/3/2009	DATE -	REVISED -				FED. ROAD DIST. NO. ILLINOIS FED. AID PROJECT				