

DATE	
BY	
FINISHED	
SURVEYED	
PLOTTED	
TEMPLATE	
NOTE BOOK	
AREAS CHECKED	
NO.	

DATE	
BY	
ORIGINAL	
SURVEY	
PLOTTED	
TEMPLATE	
NOTE BOOK	
AREAS CHECKED	
NO.	

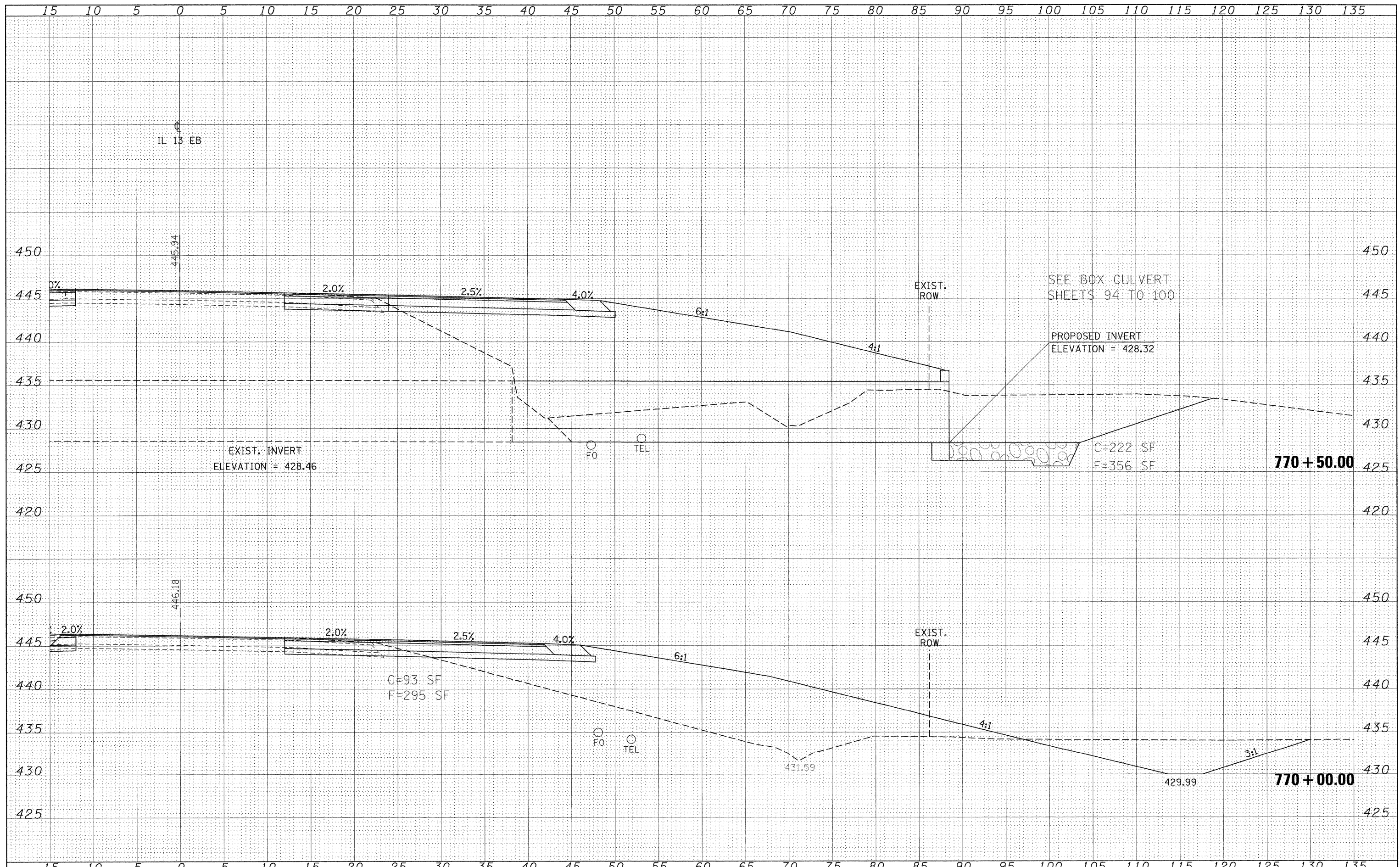

FILE NAME =	USER NAME = russellaf	DESIGNED -	REVISED -	STATE OF ILLINOIS DEPARTMENT OF TRANSPORTATION	ILLINOIS 13 EASTBOUND CROSS SECTIONS	F.A.P. RTE.	SECTION	COUNTY	TOTAL SHEETS	SHEET NO.	
ct:\pw_work\pwi\dot\russellaf\dms43738\vd9-78053_bxsheet.dgn		DRAWN -	REVISED -			331	SEC. NO (IX-1N-1, TS-2)	WILLIAMSON	190	129	
PLOT SCALE = 5.0000' / IN.		CHECKED -	REVISED -			CONTRACT NO. 78053					
PLOT DATE = 5/6/2009		DATE -	REVISED -			FED. ROAD DIST. NO. ILLINOIS FED. AID PROJECT					
SCALE: 1"=5'						SHEET NO.	OF	SHEETS	STA. 770+00.00 TO STA. 770+50.00		