

DATE	
BY	
FINAL SURVEY	
SURVEYED	
PLOTTED	
NOTE BOOK	
AREAS CHECKED	
NO.	

DATE	
BY	
ORIGINAL SURVEY	
SURVEYED	
PLOTTED	
NOTE BOOK	
AREAS CHECKED	
NO.	

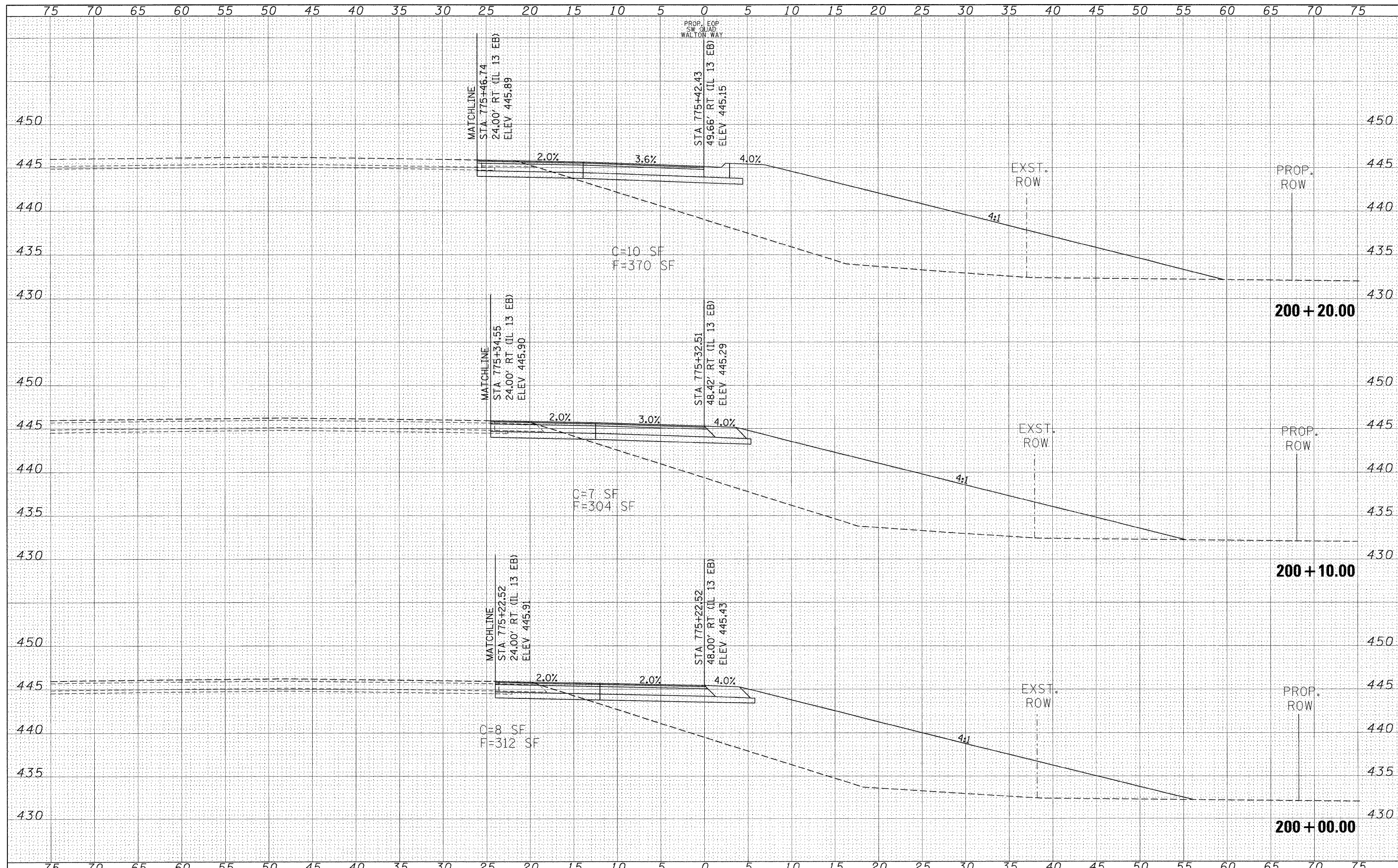

FILE NAME = c:\pw-work\pwidot\russellcf\dms43738\d9_78053...
 USER NAME = russellcf
 PLOT SCALE = 5.0000 "/p>

DESIGNED -
 DRAWN -
 CHECKED -
 DATE -

REVISED -
 REVISED -
 REVISED -
 REVISED -

STATE OF ILLINOIS
 DEPARTMENT OF TRANSPORTATION

WALTON WAY SOUTHWEST QUADRANT CROSS SECTIONS
 SCALE: 1"=5' SHEET NO. OF SHEETS STA. 200+00.00 TO STA. 200+20.00

F.A.P. RTE. 331 SECTION 19-1N-1, TS-2 COUNTY WILLIAMSON TOTAL SHEETS 190 SHEET NO. 145 CONTRACT NO. 78053

FED. ROAD DIST. NO. ILLINOIS FED. AID PROJECT