

DATE _____
 BY _____
 SURVEYED _____
 PLOTTED _____
 TEMPLATE _____
 NO. _____
 ORIGINAL SURVEY _____
 SURVEY _____
 PLOTTED _____
 TEMPLATE _____
 NO. _____

DATE _____
 BY _____
 SURVEYED _____
 PLOTTED _____
 TEMPLATE _____
 NO. _____
 ORIGINAL SURVEY _____
 SURVEY _____
 PLOTTED _____
 TEMPLATE _____
 NO. _____

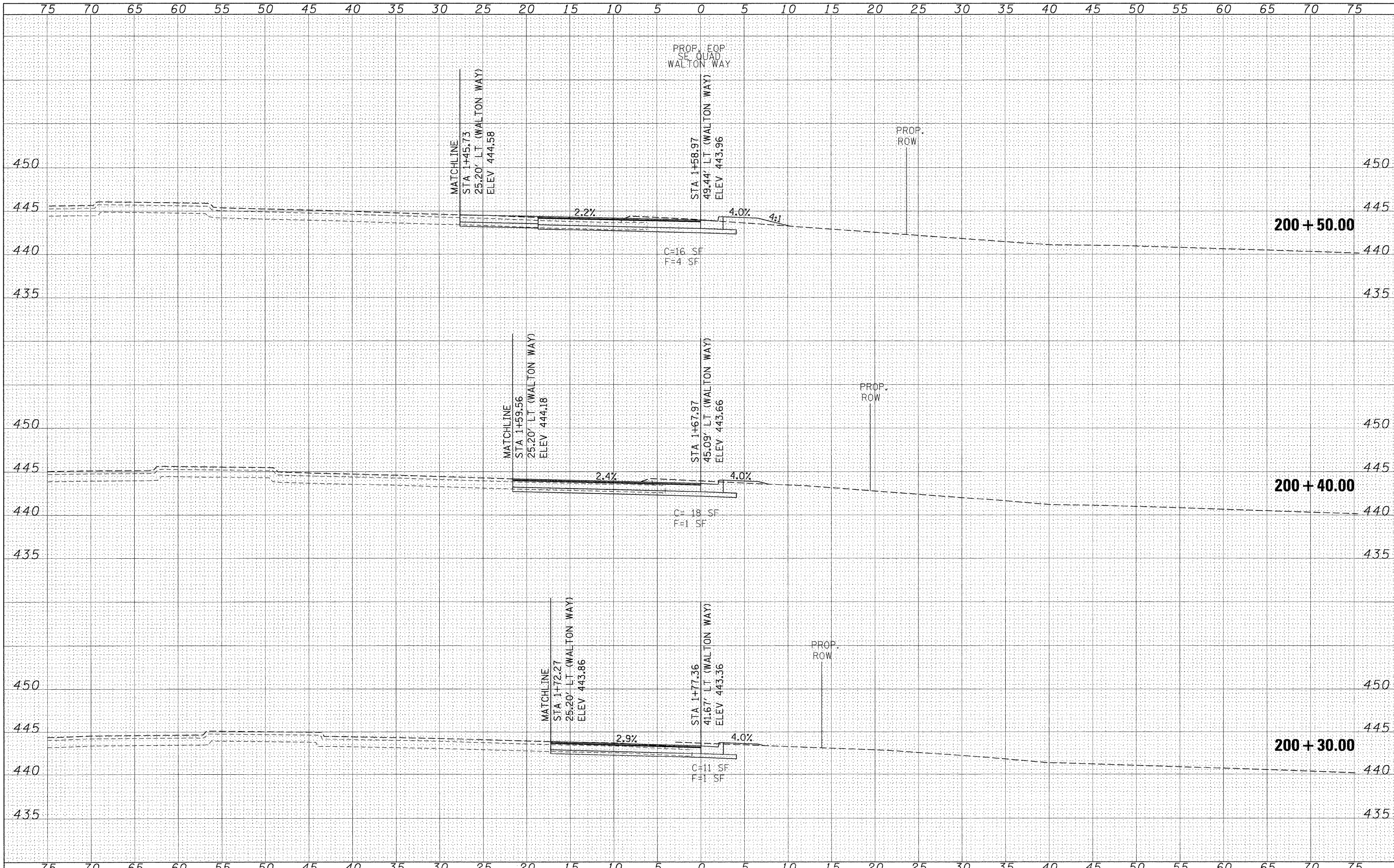

FILE NAME =	USER NAME = russellcf	DESIGNED -	REVISED -	STATE OF ILLINOIS DEPARTMENT OF TRANSPORTATION	WALTON WAY SOUTHEAST QUADRANT CROSS SECTIONS			F.A.P. RTE.	SECTION	COUNTY	TOTAL SHEETS	SHEET NO.	
ct:\pw_work\pwi001\RUSSELLCF\dms43738\d9_78053	quadsheet.dgn	DRAWN -	REVISED -		331	SEC. NO. (IX-1)N-1, TS-2	WILLIAMSON	190	154	CONTRACT NO. 78053			
	PLOT SCALE = 5.0000" / IN.	CHECKED -	REVISED -		SCALE: 1"=5'			SHEET NO.	OF	SHEETS	STA. 200+30.00 TO STA. 200+50.00	FED. ROAD DIST. NO.	ILLINOIS FED. AID PROJECT
	PLOT DATE = 5/6/2009	DATE -	REVISED -										