

BY \_\_\_\_\_ DATE \_\_\_\_\_  
 SURVEYED \_\_\_\_\_  
 PLOTTED \_\_\_\_\_  
 NOTE BOOK \_\_\_\_\_  
 AREAS CHECKED \_\_\_\_\_  
 NO. \_\_\_\_\_

BY \_\_\_\_\_ DATE \_\_\_\_\_  
 SURVEYED \_\_\_\_\_  
 PLOTTED \_\_\_\_\_  
 NOTE BOOK \_\_\_\_\_  
 AREAS CHECKED \_\_\_\_\_  
 NO. \_\_\_\_\_

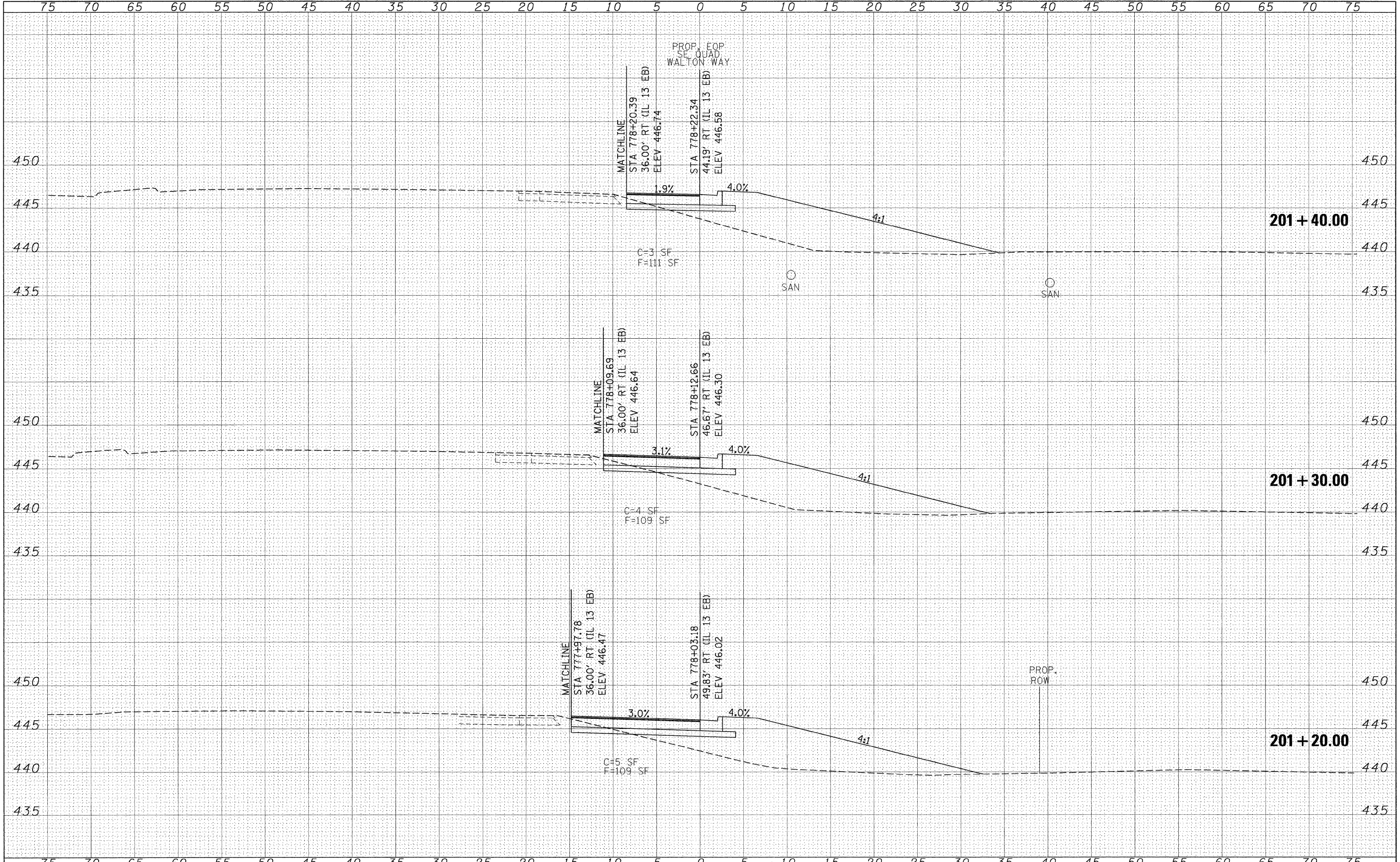

FILE NAME =	USER NAME = russellcf	DESIGNED -	REVISED -	<b>STATE OF ILLINOIS DEPARTMENT OF TRANSPORTATION</b>	<b>WALTON WAY SOUTHEAST QUADRANT CROSS SECTIONS</b>			F.A.P. RTE.	SECTION	COUNTY	TOTAL SHEETS	SHEET NO.	
ci:\pw_work\K\PWIDOT\RUSSELLCF\dms43738\d9_78053	quadxsheet.dgn	DRAWN -	REVISED -		331	SEC. NO. (IX-1N-1, TS-2)	WILLIAMSON	190	157	CONTRACT NO. 78053			
	PLOT SCALE = 5.0000" / IN.	CHECKED -	REVISED -		SCALE: 1"=5'			SHEET NO.	OF	SHEETS	STA. 201+20.00 TO STA. 201+40.00	FED. ROAD DIST. NO.	ILLINOIS FED. AID PROJECT
	PLOT DATE = 5/6/2009	DATE -	REVISED -										