

MATCH LINE STA. 322+00 SEE SHEET 60

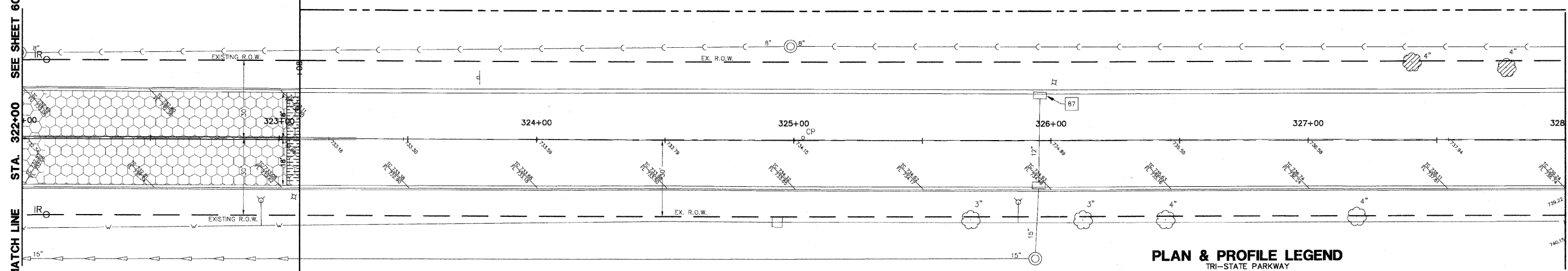

TRI-STATE PARKWAY

PLAN & PROFILE LEGEND
TRI-STATE PARKWAY

- HOT-MIX ASPHALT PAVEMENT (FULL DEPTH), 8"
12" AGGREGATE SUBGRADE
- BITUMINOUS SHARED USE PATH
2" HOT-MIX ASPHALT SURFACE COURSE, MIX 'D', N50
2" HOT-MIX ASPHALT BINDER COURSE, IL-19.0, N50
6" AGGREGATE BASE COURSE, TYPE 'B'
- TYPE B-6.12 COMB. CONC. CURB AND GUTTER
(B-6.24 GRAND AVENUE)
- DEPRESSED SECTION CURB AND GUTTER
- REVERSE PITCH CURB & GUTTER
- CONCRETE MEDIAN SURFACE
4" P.C.C. MEDIAN
6" AGGREGATE BASE COURSE, TYPE 'B'
- OVERLAY BITUMINOUS PAVEMENT
2" HOT-MIX ASPHALT SURFACE COURSE, MIX 'D', N70
1" POLYMERIZED LEVELING BINDER (MACHINE METHOD)
IL-4.75, N50

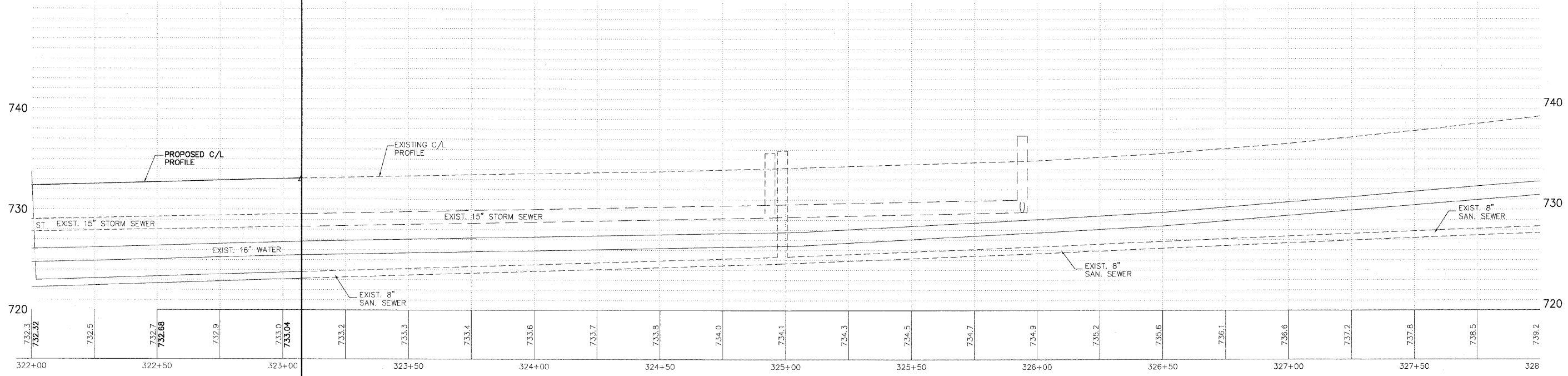

LIMIT OF STAGE 1 IMPROVEMENTS
STA. 323+08

PLANS PREPARED BY:
GEWALT HAMILTON
ASSOCIATES, INC.
Consulting Engineers & Surveyors
850 Forest Edge Drive
Vernon Hills, IL 60061
(847) 478-9700
(847) 478-9700 Fax

REVISIONS	
NAME	DATE
REV.-1 IDOT COMMENTS	02-03-06
REV.-2 PLANS STAGED	06-02-06
REV.-5 PRE-FINAL SUB	02-20-09
PS&S SUBMITTAL	04-10-09

ILLINOIS DEPARTMENT OF TRANSPORTATION

PLAN AND PROFILE
PROPOSED ROADWAY WIDENING
AND INTERSECTION IMPROVEMENTS
TRI-STATE PARKWAY

SCALE: H: 1"=20' V: 1"=5'
DATE: 10-05-04

DRAWN BY: CGP
DESIGNED BY: TPG
CHECKED BY: BLS