

NOTE:  
OFFSETS PROVIDED ARE FROM CENTER LINE  
TO CENTER LINE OF STRUCTURE.

CONTRACTOR SHALL PROVIDE TEMPORARY DRAINAGE, SPECIFICALLY AT  
THE PROFILE LOW POINTS AT STATIONS 107+50 AND 137+20. RIP  
RAP SEDIMENT BASINS, TEMPORARY DITCHING, TEMPORARY UNDERDRAINS  
SHALL BE USED TO FACILITATE POSITIVE DRAINAGE AWAY FROM THE  
PROPOSED AGGREGATE SUBGRADE.  
IT IS RECOMMENDED THAT THE PROPOSED CULVERT EXTENSION  
WORK IS COMPLETED IN DRY CONDITIONS.

F.A.U. R.T.E.	SECTION	COUNTY	TOTAL SHEETS	SHEET NO.
1223	00-00047-00-FP	LAKE	180	63
DRAINAGE - STA 102+00 TO 108+50				
CONTRACT NO. 83845 ILLINOIS				

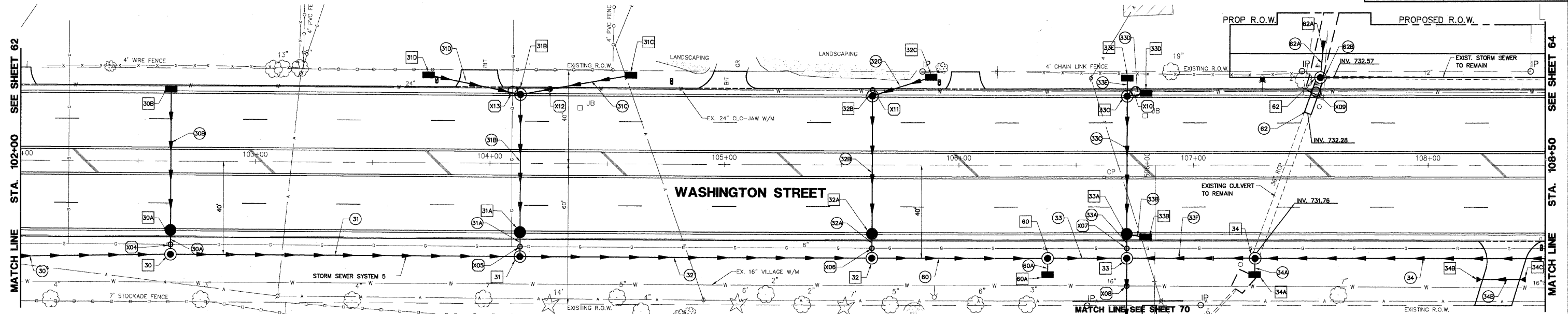

EX. STORM CATCHBASIN RIM: 741.03 INV: 737.78 STA: 102+64 O/S: 22'L TO BE REMOVED	STORM SEWER MANHOLE TY 'A' 48" TY 1 FR & CL RIM: 739.64 INV: 735.22 N INV: 735.47 W INV: 735.52 STA: 102+64 O/S: 40'R	STORM SEWER MANHOLE TY 'A' 48" TY 1 FR & CL RIM: 738.10 INV: 733.18 12" N & W INV: 733.43 12" S INV: 731.93 STA: 104+13 O/S: 40'R	STORM SEWER MANHOLE TY 'A' 48" TY 1 FR & CL RIM: 736.61 INV: 731.83 18" W INV: 732.33 18" S INV: 731.93 STA: 106+39 O/S: 40'R	STORM SEWER INLET TY 'A' 24" TY 24 FR & GR RIM: 736.24 INV: 732.81 107+26 O/S: 47'R	STORM SEWER INLET TY 'A' 24" TY 24 FR & GR RIM: 734.43 INV: 731.93 107+26 O/S: 47'R	121 LF 12" SS, CL A, TY 1, @ 2.50% TBF 0.0 CY	75 LF 18" SS, CL A, TY 1, @ 0.60% TBF 0.0 CY	7 LF 12" SS, CL A, TY 1, @ 1.00%
EX. STORM MANHOLE RIM: 740.80 INV: 737.90 STA: 102+66 O/S: 31'R TO BE REMOVED	STORM SEWER INLET TY 'A' 24" TY 8 GR RIM: 737.15 INV: 734.28 STA: 103+73 O/S: 38'L	STORM SEWER MANHOLE TY 'A' 48" TY 1 FR & CL RIM: 737.09 INV: 732.28 12" N INV: 732.78 STA: 105+63 O/S: 40'R	STORM SEWER INLET TY 'A' 24" TY 8 GR RIM: 734.00 INV: 732.00 STA: 106+38 O/S: 47'R	12" RCP FLARED END SECTION INV: 735.18 108+21 O/S: 49'R	12" RCP FLARED END SECTION INV: 735.26 108+42 O/S: 49'R	62 LF 12" SS, CL A, TY 1, @ 0.50% TBF 5.0 CY	33 LF 18" SS, CL A, TY 1, @ 0.75% TBF 0.0 CY	17 LF 12" SS, CL A, TY 1, @ 0.40%
EX. 15" ROP FES INV: 737.40 STA: 102+64 O/S: 40'R TO BE REMOVED	STORM SEWER INLET TY 'A' 24" TY 8 GR RIM: 736.30 INV: 734.32 STA: 104+61 O/S: 38'L	STORM SEWER CATCHBASIN TY 'A' 48" TY 24 FR & CL RIM: 736.64 N&S INV: 732.96 STA: 105+63 O/S: 30'R	STORM SEWER MANHOLE TY 'A' 72" TY 1 FR & CL RIM: 736.51 S INV: 731.00 E&W INV: 731.58 18" N INV: 732.40 STA: 106+72 O/S: 40'R	STORM SEWER MANHOLE TY 'A' 60" TY 1 FR & CL RIM: 737.00 S INV: 732.40 12" E INV: 733.12 36" N INV: 733.02 STA: 107+54 O/S: 38'L	STORM SEWER MANHOLE TY 'A' 60" TY 1 FR & CL RIM: 737.00 S INV: 732.40 12" E INV: 733.12 36" N INV: 733.02 STA: 107+54 O/S: 38'L	149 LF 15" SS, CL A, TY 1, @ 1.20% TBF 0.0 CY	8 LF 12" SS, CL A, TY 1, @ 1.00% TBF 0.4 CY	EXISTING SANITARY STRUCTURE
EX. STORM MANHOLE RIM: 739.11 INV: 735.67 STA: 102+64 O/S: 31'L	STORM SEWER INLET TY 'A' 24" TY 8 GR RIM: 739.11 INV: 735.67 STA: 102+64 O/S: 31'L	STORM SEWER MANHOLE TY 'A' 48" TY 24 FR & GR RIM: 737.39 E,W,S INV: 734.08 STA: 104+13 O/S: 31'L	STORM SEWER INLET TY 'A' 24" TY 8 GR RIM: 735.50 INV: 732.90 STA: 106+72 O/S: 37'	STORM SEWER MANHOLE TY 'A' 72" TY 1 FR & CL RIM: 736.24 INV: 732.81 107+55 O/S: 53'L	STORM SEWER MANHOLE TY 'A' 72" TY 1 FR & CL RIM: 736.24 W INV: 731.76 18" E INV: 732.49 12" S INV: 731.86 STA: 107+26 O/S: 40'R	47 LF 12" SS, CL A, TY 1, @ 0.50% TBF 7.4 CY	8 LF 12" SS, CL A, TY 1, @ 1.00% TBF 1.6 CY	EXISTING SANITARY SEWER
STORM SEWER CATCH BASIN TY 'A' 48" TY 24 FR & GR RIM: 739.11 N&S INV: 735.56 STA: 102+64 O/S: 32'R	STORM SEWER CATCH BASIN TY 'A' 48" TY 24 FR & GR RIM: 739.11 N&S INV: 735.56 STA: 102+64 O/S: 32'R	STORM SEWER MANHOLE TY 'A' 48" TY 24 FR & GR RIM: 737.39 E,W,S INV: 734.08 STA: 104+13 O/S: 31'L	STORM SEWER INLET TY 'A' 24" TY 8 GR RIM: 735.80 INV: 733.40 STA: 105+89 O/S: 37'L	STORM SEWER INLET TY 'A' 24" TY 8 GR RIM: 735.50 INV: 732.90 STA: 106+72 O/S: 37'	STORM SEWER MANHOLE TY 'A' 72" TY 1 FR & CL RIM: 736.56 W INV: 731.76 18" E INV: 732.49 12" S INV: 731.86 STA: 107+26 O/S: 40'R	40 LF 12" SS, CL A, TY 1, @ 0.50% TBF 8.2 CY	54 LF 36" SS, CL A, TY 1, @ 0.33% TBF 0.0 CY	EXISTING WATERMAIN STRUCTURE
						150 LF 18" SS, CL A, TY 1, @ 0.60% TBF 0.0 CY	7 LF 12" SS, CL A, TY 1, @ 1.00% TBF 0.0 CY	EXISTING WATERMAIN
						9 LF 12" SS, CL A, TY 1, @ 2.00% TBF 2.7 CY	127 LF 18" SS, CL A, TY 1, @ 0.83% TBF 0.0 CY	EXISTING STORM SEWER STRUCTURE
						62 LF 12" SS, CL A, TY 1, @ 0.50% TBF 5.7 CY	16 LF 36" SS, CL A, TY 1, @ 0.75% TBF 1.3 CY	EXISTING STORM SEWER
						26 LF 12" SS, CL A, TY 1, @ 0.50% TBF 4.8 CY	8 LF 36" SS, CL A, TY 1, @ 1.00% TBF 1.8 CY	PROPOSED STORM SEWER STRUCTURE
								PROPOSED STORM SEWER
								PROPOSED STORM SEWER PIPE
								PROPOSED STORM SEWER MANHOLE
								PROPOSED STORM SEWER CATCHBASIN
								PROPOSED STORM SEWER INLET
								PROPOSED UTILITY CROSSING

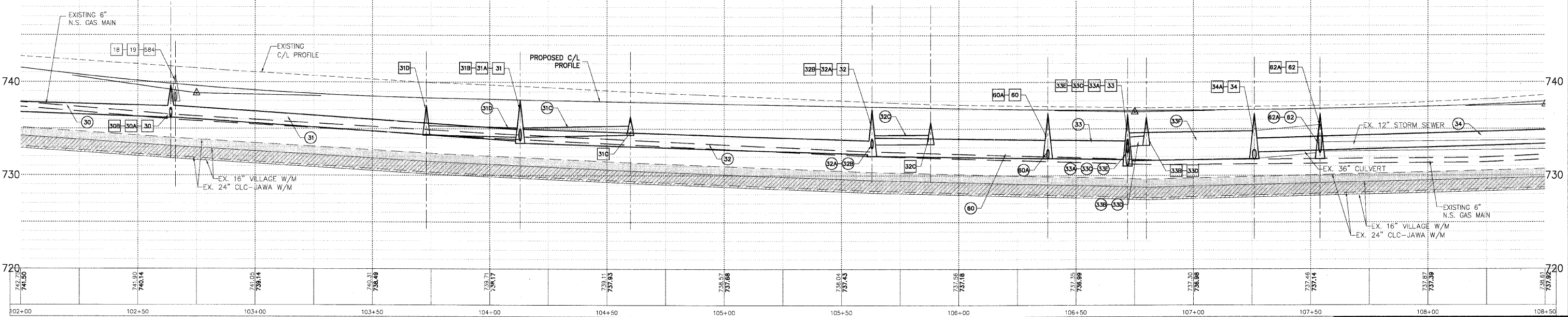
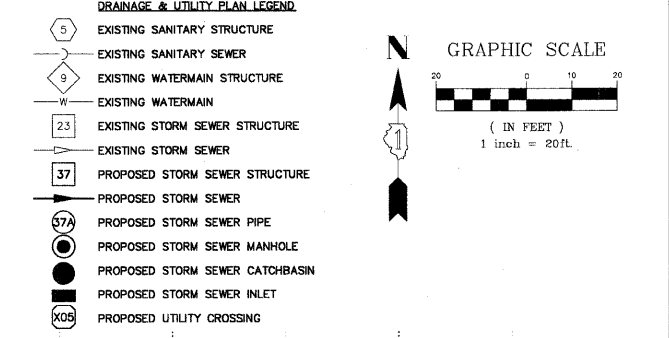

GAS OVER STORM B/GAS = 737.60 T/STORM = 736.90	WATER OVER STORM B/STORM = 730.71 T/WATER = 728.80	STORM OVER WATER B/STORM = 733.90 T/WATER = 731.70	
GAS OVER STORM B/GAS = 735.80 T/STORM = 734.80	STORM OVER WATER B/STORM = 732.00 T/WATER = 730.00	STORM OVER GAS & WATER B/STORM = 733.90 T/GAS = 732.90 T/WATER = 731.90	
GAS OVER STORM B/GAS = 735.10 T/STORM = 734.20	STORM MH & INLET OVER WATER B/STORM = 732.10 T/WATER = 730.10		
STORM OVER GAS B/STORM = 732.25 T/GAS = 731.25	STORM MH OVER WATER B/STORM MH = 732.90 T/WATER = 730.90		

PLANS PREPARED BY:  
**GEWALT HAMILTON**  
ASSOCIATES, INC.  
Consulting Engineers & Surveyors  
800 Forest Edge Drive  
Vernon Hills, IL 60061  
(815) 478-9700  
(815) 478-9700 Fax

REVISIONS	
NAME	DATE
REV.-1 IDOT COMMENTS	02-03-06
REV.-2 PLANS STAGED	06-02-06
REV.-5 PRE-FINAL SUB	02-20-09
PS&S SUBMITTAL	04-10-09

ILLINOIS DEPARTMENT OF TRANSPORTATION  
**DRAINAGE AND UTILITY PLAN**  
STA 102+00 TO 108+50

**PROPOSED ROADWAY RECONSTRUCTION**  
**WASHINGTON STREET**

SCALE: H: 1"=20' V: 1"=5'  
DATE: 10-05-04

DRAWN BY: CGP  
DESIGNED BY: TPG  
CHECKED BY: BLS