

PLAN REFERENCE SEE PLANS TITLED  
 "PLANS FOR PROPOSED HIGHWAY  
 FAU ROUTE 1016 (WASHINGTON STREET)"  
 PROJECT NUMBER M-8003(506)  
 BY: CRAWFORD, MURPHY & TILLY, INC.  
 LATEST DATE: 02-06-09

- |   |   |  |   |
|---|---|--|---|
| <p>49B STORM SEWER INLET<br/>         TY 'A' 24" TY 24 FR &amp; GR<br/>         RIM: 719.11 INV: 716.17<br/>         STA: 133+95, O/S: 32.5'L</p> <p>49A STORM SEWER CATCHBASIN<br/>         TY 'A' 48" TY 24 FR &amp; GR<br/>         RIM: 719.19 INV: 715.18<br/>         STA: 133+95, O/S: 30'R</p> <p>49 STORM SEWER MANHOLE<br/>         TY 'A' 48" TY B GR<br/>         RIM: 720.44 INV: 714.25<br/>         18" W INV: 714.75<br/>         12" N INV: 715.00<br/>         STA: 134+00, O/S: 40'R</p> | <p>CONTRACTOR SHALL PROVIDE TEMPORARY DRAINAGE, SPECIFICALLY AT THE PROFILE LOW POINTS AT STATIONS 107+50 AND 137+20. RIP RAP SEDIMENT BASINS, TEMPORARY DITCHING, TEMPORARY UNDERDRAINS SHALL BE USED TO FACILITATE POSITIVE DRAINAGE AWAY FROM THE PROPOSED AGGREGATE SUBGRADE. IT IS RECOMMENDED THAT THE PROPOSED CULVERT EXTENSION WORK IS COMPLETED INDRY CONDITIONS.</p> <p>NOTE: OFFSETS PROVIDED ARE FROM CENTER LINE TO CENTER LINE OF STRUCTURE.</p> | <p>51F STORM SEWER HEADWALL<br/>         48" RCP INV: 705.55<br/>         STA: 137+20, O/S: 52'L</p> <p>51 STORM SEWER MANHOLE<br/>         TY 'A' 72" TY 1 FR &amp; CL<br/>         RIM: 712.70 INV: 706.69<br/>         24" W INV: 706.70<br/>         STA: 137+18, O/S: 37'R</p> <p>51D STORM SEWER HEADWALL<br/>         48" RCP INV: 706.75<br/>         STA: 137+18, O/S: 42.2'R</p> | <p>49B 62 LF 12" SS, CL A, TY 1, @ 1.60%, TBF 5.5 CY</p> <p>49A 14 LF 12" SS, CL A, TY 1, @ 1.30%, TBF 2.6 CY</p> <p>50 156 LF 18" SS, CL A, TY 1, @ 2.40%, TBF 63.5 CY</p> <p>51 156 LF 24" SS, CL A, TY 1, @ 0.91%, TBF 88.8 CY</p> <p>51F 24 LF 48" SS, CL A, TY 1, @ X.XXX%, TBF 25.1 CY</p> <p>51E 13 LF 48" SS, CL A, TY 1, @ X.XXX%, TBF 9.5 CY</p> <p>51D 4 LF 48" SS, CL A, TY 1, @ X.XXX%, TBF 2.9 CY</p> |
|---|---|--|---|

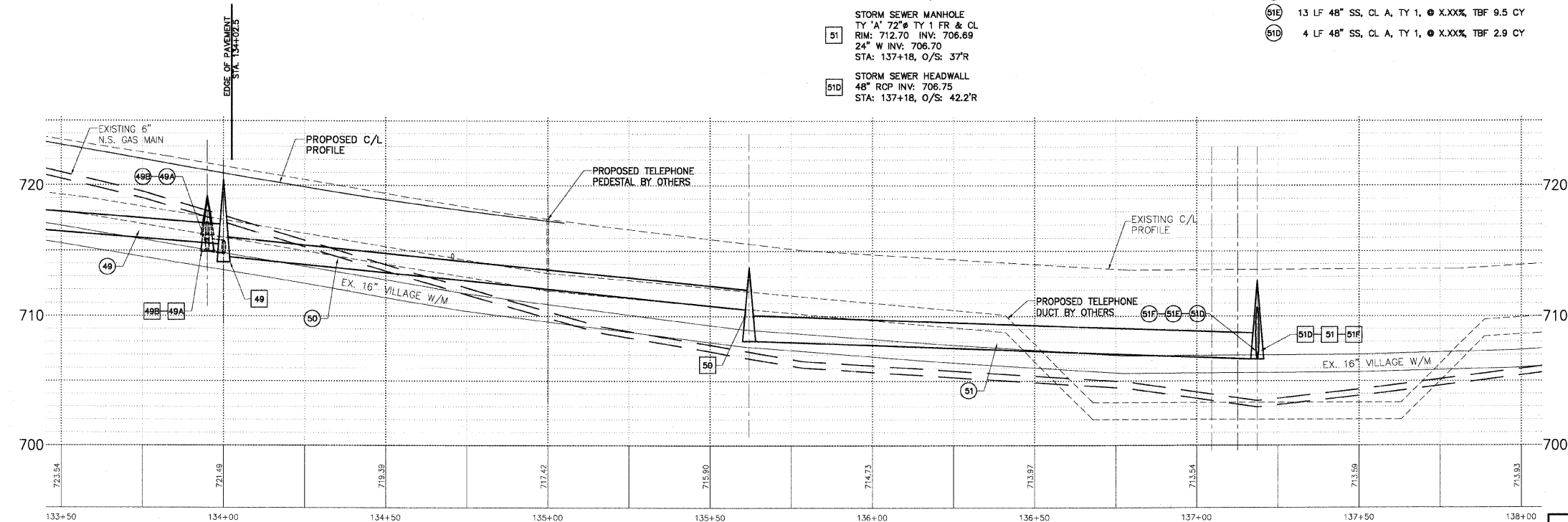
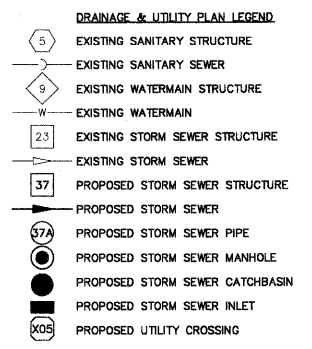

GAS OVER STORM B/GAS = 717.50 T/STORM = 716.50	X50	HEADWALL OVER WATER B/HEADWALL = 705.05 T/WATER = 703.00	X5B
STORM MH OVER GAS B/STORM MH = 706.00 T/GAS = 705.00	X5C		
INLET OVER WATER B/INLET = 715.50 T/WATER = 713.70	X53		

PLANS PREPARED BY:  
**GEWALT HAMILTON**  
 ASSOCIATES, INC.  
 Consulting Engineers & Surveyors  
 850 Forest Ridge Drive  
 Vernon Hills, IL 60061  
 (847) 478-9700  
 (847) 478-9701 Fax

REVISIONS	
NAME	DATE
REV.-1 IDOT COMMENTS	02-05-06
REV.-2 PLANS STAGED	06-02-06
REV.-5 PRE-FINAL SUB	02-20-09
PS&S SUBMITTAL	04-10-09

ILLINOIS DEPARTMENT OF TRANSPORTATION  
**DRAINAGE AND UTILITY PLAN**  
 STA. 133+50 TO 138+00

**PROPOSED ROADWAY RECONSTRUCTION**  
**WASHINGTON STREET**

SCALE: H: 1"=20' V: 1"=5'  
 DATE: 10-05-04

DRAWN BY: CGP  
 DESIGNED BY: TPG  
 CHECKED BY: BLS