

TRI STATE PARKWAY

F.A.U. R.T.E.	SECTION	COUNTY	TOTAL SHEETS	SHEET NO.
1223	00-0047-00-FP	LAKE	180	69
DRAINAGE - STA. 138+00 TO 141+75				
CONTRACT NO. 83845		ILLINOIS		

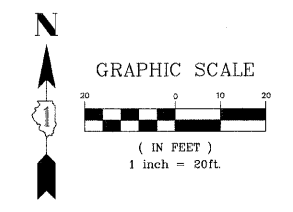
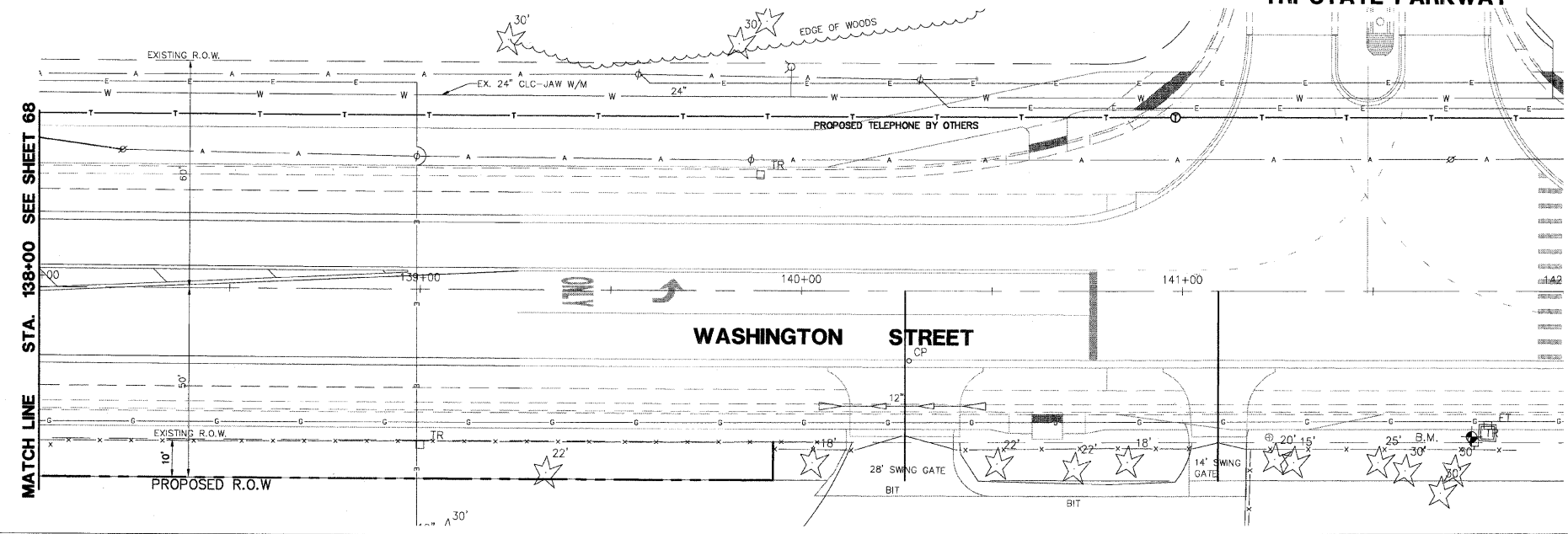

NOTE:
OFFSETS PROVIDED ARE FROM CENTER LINE
TO CENTER LINE OF STRUCTURE.

DRAINAGE & UTILITY PLAN LEGEND

- EXISTING SANITARY STRUCTURE
- EXISTING SANITARY SEWER
- EXISTING WATERMAIN STRUCTURE
- EXISTING WATERMAIN
- EXISTING STORM SEWER STRUCTURE
- EXISTING STORM SEWER
- PROPOSED STORM SEWER STRUCTURE
- PROPOSED STORM SEWER
- PROPOSED STORM SEWER PIPE
- PROPOSED STORM SEWER MANHOLE
- PROPOSED STORM SEWER CATCHBASIN
- PROPOSED STORM SEWER INLET

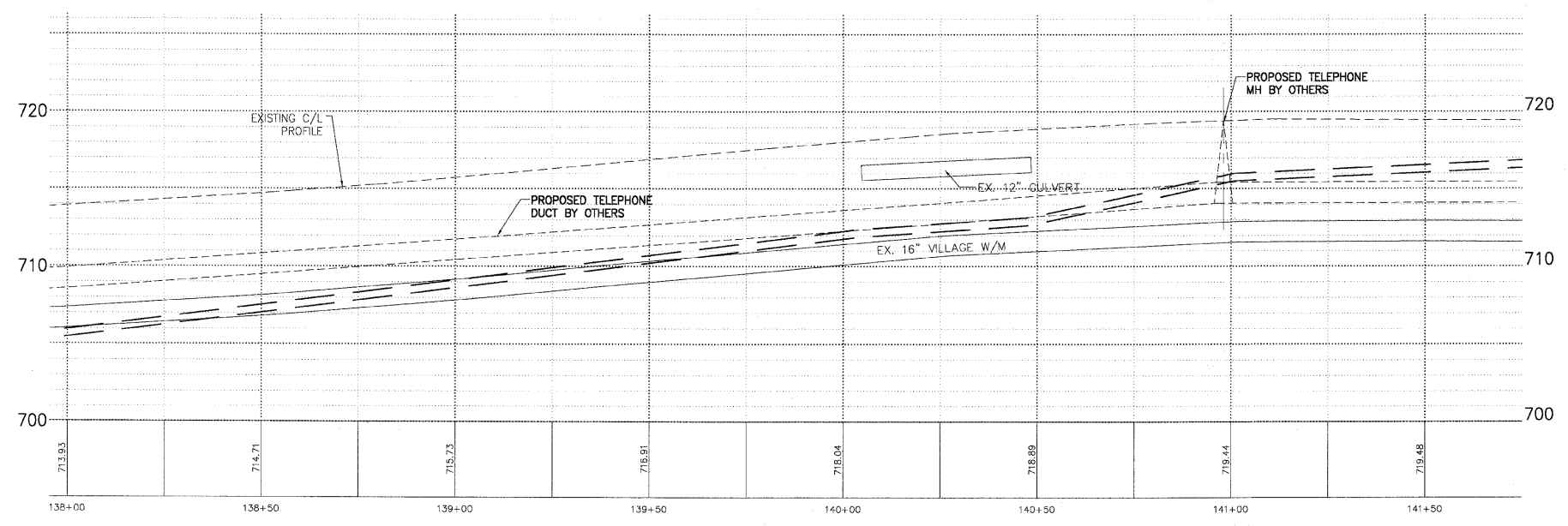

PLANS PREPARED BY:
GEWALT HAMILTON
ASSOCIATES, INC.
Consulting Engineers & Surveyors
850 Forest Edge Drive
Vernon Hills, IL 60061
(847) 478-9700
(817) 478-9700 Fax

REVISIONS	
NAME	DATE
REV.-1 IDOT COMMENTS	02-03-06
REV.-2 PLANS STAGED	06-02-06
REV.-5 PRE-FINAL SUB	02-20-09
PS&S SUBMITAL	04-10-09

ILLINOIS DEPARTMENT OF TRANSPORTATION
DRAINAGE AND UTILITY PLAN
STA. 138+00 TO 141+75
PROPOSED ROADWAY RECONSTRUCTION
WASHINGTON STREET
SCALE: H: 1"=20' V: 1"=5'
DATE: 10-05-04
DRAWN BY: CGP
DESIGNED BY: TPG
CHECKED BY: BLS