

- 84 EX. SANITARY MANHOLE
RIM: 735.86
8" N&S INV: 724.66
- 85 EX. STORM MANHOLE
RIM: 737.34
15" S&W INV: 729.74
- 86 EX. STORM INLET
RIM: 734.36
15" E&W INV: 730.36
- 87 EX. STORM INLET
RIM: 734.29
12" E INV: 730.72
TO BE REMOVED
- 88 EX. W/M VALVE VAULT
RIM: 735.64
16" T/P 730.20

NOTE:
OFFSETS PROVIDED ARE FROM CENTER LINE
TO CENTER LINE OF STRUCTURE.

- DRAINAGE & UTILITY PLAN LEGEND**
- 5 EXISTING SANITARY STRUCTURE
 - 7 EXISTING SANITARY SEWER
 - 9 EXISTING WATERMAIN STRUCTURE
 - W EXISTING WATERMAIN
 - 23 EXISTING STORM SEWER STRUCTURE
 - EX EXISTING STORM SEWER
 - 37 PROPOSED STORM SEWER STRUCTURE
 - PS PROPOSED STORM SEWER
 - 57A PROPOSED STORM SEWER PIPE
 - MS PROPOSED STORM SEWER MANHOLE
 - CS PROPOSED STORM SEWER CATCHBASIN
 - IS PROPOSED STORM SEWER INLET
 - X05 PROPOSED UTILITY CROSSING

NOTE: ALL CURB INLET FRAMES ON CEMETERY ROAD
AND TRI STATE PARKWAY SHALL BE IDOT TYPE 11
FRAME AND GRATE, WITH THE FISH LOGO AND
"DUMP NO WASTE DRAINS TO RIVER" IMPRINTED
ON THE TOP.

LIMIT OF STAGE 1 IMPROVEMENTS
STA. 323+08

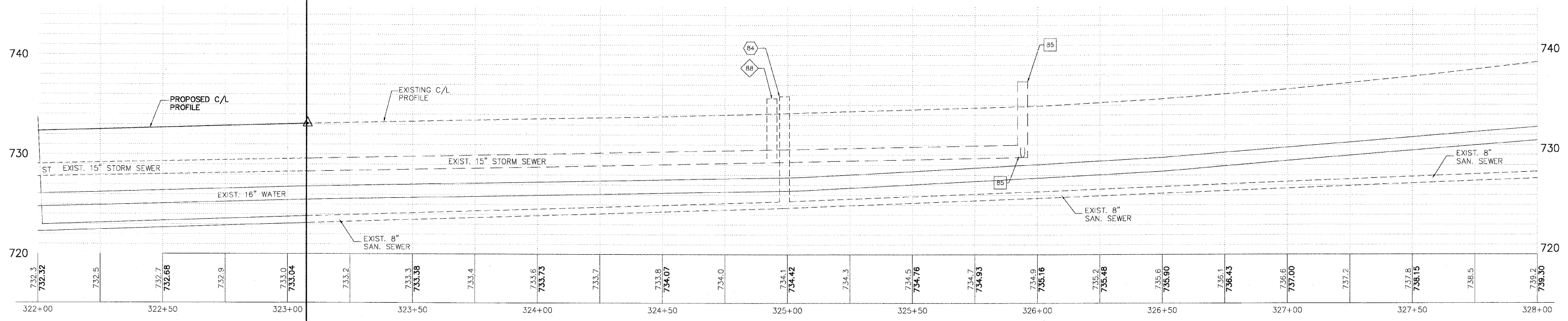

PLANS PREPARED BY:
GEWALT HAMILTON
ASSOCIATES, INC.
Consulting Engineers & Surveyors
850 Forest Edge Drive
Vernon Hills, IL 60061
(847) 478-9700
(847) 478-9701 Fax

REVISIONS	
NAME	DATE
REV.-1 IDOT COMMENTS	02-05-06
REV.-2 PLANS STAGED	06-02-06
REV.-5 PRE-FINAL SUB	02-20-09
PS&S SUBMITTAL	04-10-09

ILLINOIS DEPARTMENT OF TRANSPORTATION
DRAINAGE AND UTILITY PLAN
STA 322+00 TO 328+00
PROPOSED ROADWAY WIDENING
AND INTERSECTION IMPROVEMENTS
TRI STATE PARKWAY

SCALE: H: 1"=20' V: 1"=5'
DATE: 10-05-04

DRAWN BY: CGP
DESIGNED BY: TPG
CHECKED BY: BLS