

F.A.U. R.T.E.	SECTION	COUNTY	TOTAL SHEETS	SHEET NO.
1223	00-00047-00-FP	LAKE	180	160
CONTRACT NO. 83845			ILLINOIS	

**TEMPORARY INTERCONNECT PLAN**

**TEMPORARY INTERCONNECT NOTES**

1. THE EXISTING INTERCONNECT CABLE SHALL BE REMOVED FROM THE EXISTING TEMPORARY WOOD POLES FROM CEMETERY ROAD TO TRI-STATE PARKWAY AND THE EXISTING INTERCONNECT CONDUIT FROM CEMETERY ROAD TO HUNT CLUB ROAD AND REINSTALLED ON THE PROPOSED TEMPORARY WOOD POLES. THE RELOCATION OF THE EXISTING INTERCONNECT FROM HUNT CLUB ROAD TO TRI-STATE PARKWAY SHALL BE CONSIDERED INCIDENTAL TO THE PAY ITEM "TEMPORARY TRAFFIC SIGNAL INSTALLATION". THE OPERATION MUST BE COMPLETED IN ONE(1) WORKING DAY DURING NONE PEAK HOURS OR AS DIRECTED BY THE RESIDENT ENGINEER. ANY ADDITIONAL INTERCONNECT CABLE REQUIRED SHALL BE SPLICED ABOVE GROUND ON THE TEMPORARY WOOD POLE.
2. AFTER THE PROPOSED INTERCONNECT IS OPERATIONAL, TEMPORARY INTERCONNECT CABLE SHALL BE REMOVED AND NOT REUSED.
3. THE 2" G.S. CONDUIT USED FOR THE TEMPORARY INTERCONNECT SHALL BE REMOVED TO BELOW GROUND LEVEL AND CAPPED AT THE TIME THE TEMPORARY TRAFFIC SIGNAL IS REMOVED. ALL CONDUIT, ADDITIONAL CABLE, AS WELL AS ALL WORK ASSOCIATED WITH THE INSTALLATION AND REMOVAL OF THESE ITEMS, SHALL BE CONSIDERED INCIDENTAL TO THE PAY ITEM, "TEMPORARY TRAFFIC SIGNAL INSTALLATION".
4. THE CONTRACTOR MUST NOTIFY L.C.D.O.T. SIGNAL SYSTEM ENGINEER A MINIMUM OF SEVEN(7) WORKING DAYS PRIOR TO THE START OF ANY WORK ON THE INTERCONNECT SYSTEM.

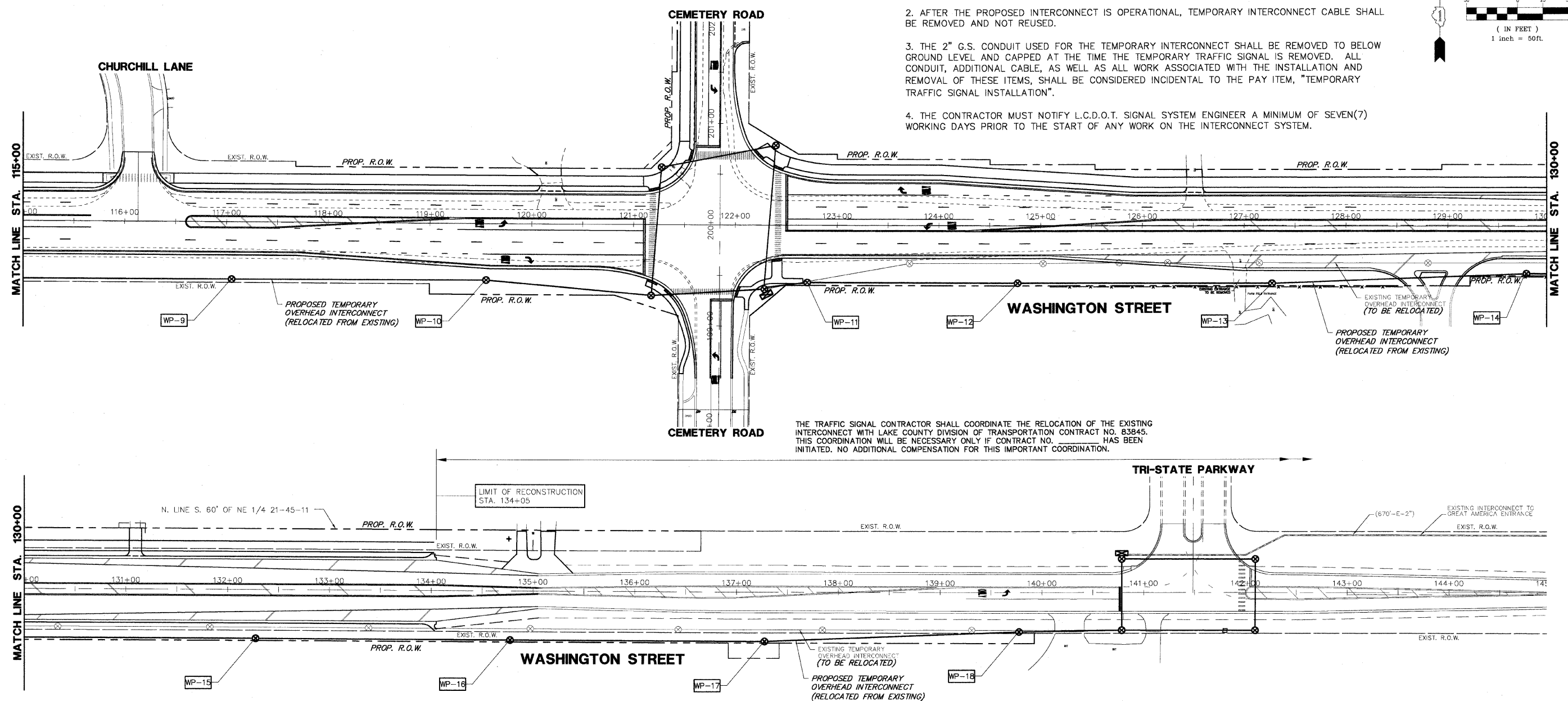
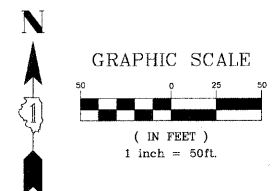

THE TRAFFIC SIGNAL CONTRACTOR SHALL COORDINATE THE RELOCATION OF THE EXISTING INTERCONNECT WITH LAKE COUNTY DIVISION OF TRANSPORTATION CONTRACT NO. 83845. THIS COORDINATION WILL BE NECESSARY ONLY IF CONTRACT NO. \_\_\_\_\_ HAS BEEN INITIATED. NO ADDITIONAL COMPENSATION FOR THIS IMPORTANT COORDINATION.

**INTERCONNECT PLAN LEGEND**

	PROPOSED	EXISTING
CONTROLLER		
HANDHOLE		
DOUBLE HANDHOLE		
HEAVY-DUTY HANDHOLE		
G.S. CONDUIT IN TRENCH (T) OR PUSHED (P)		
DETECTOR LOOP		
UNIT DUCT	U.D.	
SYSTEM	S	
INTERSECTION	IP	I
TEMPORARY WOOD POLE		

STRUCTURE	STATION	OFFSET	UTILITY CONFLICTS
WP-9	117+05	57' R	AERIAL & UNDERGROUND COMED
WP-10	119+55	57' R	16" WATERMAIN, VILLAGE OF GURNEE & SBC
WP-11	122+71	57' R	NONE
WP-12	124+78	57' R	NONE
WP-13	127+28	57' R	NONE
WP-14	129+78	47' R	NONE
WP-15	132+28	47' R	NONE
WP-16	134+78	47' R	NONE
WP-17	137+28	47' R	NONE
WP-18	139+78	37' R	6" GAS MAIN, PEOPLE'S ENERGY

PLANS PREPARED BY:  
**GEWALT HAMILTON**  
 ASSOCIATES, INC.  
 Consulting Engineers & Surveyors  
 850 Forest Edge Drive  
 Vernon Hills, IL 60061  
 (847) 478-9700  
 (847) 478-9701 Fax

REVISIONS	
NAME	DATE
PER IDOT/LCDOT REVIEW	02-15-05
PER LCDOT REVIEW	09-01-05
R-2 PLANS STAGED	06-02-06
REV.-5 PRE-FINAL SUB	02-20-09
PS&E SUBMITTAL	04-10-09

LAKE COUNTY DIVISION OF TRANSPORTATION  
**TEMPORARY INTERCONNECT PLAN**  
 SHEET 2 OF 2

**WASHINGTON STREET**  
 STA 115+00 TO 145+00

SCALE: 1"=50'  
 DATE: 10-25-04

DESIGNED BY: JRD  
 CHECKED BY: BLS