

SCHEDULE OF QUANTITIES
WASHINGTON STREET AT CEMETERY ROAD

QUANT.	UNIT	ITEM
36	SQ.FT.	L.E.D. INTERNALLY ILLUMINATED STREET NAME SIGN
75	FOOT	CONDUIT IN TRENCH, 2 1/2" DIA., GALVANIZED STEEL
83	FOOT	CONDUIT IN TRENCH, 3" DIA., GALVANIZED STEEL
10	FOOT	CONDUIT IN TRENCH, 5" DIA., GALVANIZED STEEL
153	FOOT	CONDUIT PUSHED, 2" DIA., GALVANIZED STEEL
200	FOOT	CONDUIT PUSHED, 4" DIA., GALVANIZED STEEL
141	FOOT	CONDUIT PUSHED, 5" DIA., GALVANIZED STEEL
2	EACH	HANDHOLE
2	EACH	DOUBLE HANDHOLE
700	FOOT	ELECTRIC CABLE IN CONDUIT, GROUNDING, NO.6 1C
2415	FOOT	ELECTRIC CABLE IN CONDUIT, SIGNAL NO.14 2C
1904	FOOT	ELECTRIC CABLE IN CONDUIT, SIGNAL NO.14 3C
1717	FOOT	ELECTRIC CABLE IN CONDUIT, SIGNAL NO.14 5C
1717	FOOT	ELECTRIC CABLE IN CONDUIT, SIGNAL NO.14 7C
169	FOOT	ELECTRIC CABLE IN CONDUIT, SERVICE NO.6 2C
450	FOOT	ELECTRIC CABLE IN CONDUIT NO.20 3/C, TWISTED, SHIELDED
961	FOOT	ELECTRIC CABLE IN CONDUIT, COMMUNICATION, NO. 16 6 PAIR
4	EACH	TRAFFIC SIGNAL POST, GALVANIZED STEEL 16 FT. (SPECIAL)
1	EACH	STEEL COMBINATION MAST ARM ASSEMBLY AND POLE, 30 FT. (SPECIAL)
1	EACH	STEEL COMBINATION MAST ARM ASSEMBLY AND POLE, 34 FT. (SPECIAL)
1	EACH	STEEL COMBINATION MAST ARM ASSEMBLY AND POLE, 40 FT. (SPECIAL)
1	EACH	STEEL COMBINATION MAST ARM ASSEMBLY AND POLE, 42 FT. (SPECIAL)
12	FOOT	CONCRETE FOUNDATION, TYPE A
4	FOOT	CONCRETE FOUNDATION, TYPE C
27	FOOT	CONCRETE FOUNDATION, TYPE E, 30-INCH DIAMETER
26	FOOT	CONCRETE FOUNDATION, TYPE E, 36-INCH DIAMETER
4	EACH	SIGNAL HEAD, L.E.D., 1-FACE, 3-SECTION, MAST ARM MOUNTED
4	EACH	SIGNAL HEAD, L.E.D., 1-FACE, 5-SECTION, MAST ARM MOUNTED
4	EACH	SIGNAL HEAD, L.E.D., 2-FACE, 1-3 SECTION, 1-5 SECTION, BRACKET MOUNTED
8	EACH	PEDESTRIAN SIGNAL HEAD, L.E.D., 1-FACE, BRACKET MOUNTED WITH COUNTDOWN TIMER
8	EACH	TRAFFIC SIGNAL BACKPLATE
2	EACH	LIGHT DETECTOR
1	EACH	LIGHT DETECTOR AMPLIFIER
1	EACH	FULL-ACTIVATED CONTROLLER AND TYPE IV CABINET, SPECIAL
1	EACH	UNINTERRUPTIBLE POWER SUPPLY (UPS)
8	EACH	PEDESTRIAN PUSH-BUTTON
1	EACH	TRANSCEIVER-FIBER OPTIC
1	EACH	SERVICE INSTALLATION, POLE MOUNT
173	FOOT	TRENCH AND BACKFILL FOR ELECTRICAL WORK
1	EACH	VIDEO DETECTION SYSTEM, (COMPLETE INTERSECTION)
1	EACH	REMOTE-CONTROLLED VIDEO SYSTEM
1	EACH	TEMPORARY TRAFFIC SIGNAL INSTALLATION
1	EACH	REMOVE EXISTING TRAFFIC SIGNAL EQUIPMENT
6	EACH	REMOVE EXISTING HANDHOLE
9	EACH	REMOVE EXISTING CONCRETE FOUNDATION
1	EACH	LAYER II (DATA LINK) SWITCH
961	FOOT	ELECTRICAL CABLE IN CONDUIT, 600V (EPR-TYPE RHW) 2-1/C NO. 10
4	EACH	LUMINAIRE, SODIUM VAPOR, HORIZONTAL MOUNT, PHOTO-CELL CONTROL, 250 WATT
1	EACH	TEMPORARY TRAFFIC SIGNAL TIMINGS

L.C.D.O.T. TRAFFIC SIGNAL INSTALLATION ELECTRICAL SERVICE REQUIREMENTS					TOTAL WATTAGE
TYPE	NO LAMPS	WATTAGE INCAND. L.E.D.	% OPERATION		
SIGNAL (RED)	16	10	0.50	80.00	
SIGNAL (YELLOW)	16	19	0.25	76.00	
SIGNAL (GREEN)	16	11	0.25	44.00	
ARROW	16	9	0.10	14.00	
PED.SIGNAL	8	9	1.00	72.00	
CONTROLLER	1	100	1.00	100.00	
BATTERY BACKUP	1	25	1.00	25.00	
VIDEO SYSTEMS	1	150	1.00	150.00	
ILLUM. ST NAME SIGN	4	64	0.50	128.00	
LUMINAIRE	4	250	0.50	500.00	
FLASHER					
TOTAL =				1189.00	

FOUNDATION (DEPTH) (FT.)	CABLE SLACK (FT.)	VERTICAL (FT.)
TYPE E - M.ARM POLE		
30" (16"-30")	HANDHOLE 6.5	ALL FOUNDATIONS 3.5
30" (30"-40")	DOUBLE HANDHOLE 13	MAST ARM (L) POLE 20'+L-2'
36" (40"-48")	SIGNAL POST 2	BRACKET MOUNTED 1.5
36" (40"-48")	CONTROLLER CAB. 1	PED. PUSHBUTTON 4
36" (50"-55")	FIBER OPTIC 1.3	ELECTRIC SERVICE 13.5
	ELECTRIC SERVICE 1	SERVICE TO GROUND 13.5
	GROUND CABLE 1	POST MOUNTED

ENERGY COSTS - BILLED TO: VILLAGE OF GURNEE (ADDRESS) 325 N. O'PLAINE RD
 ENERGY SUPPLY - CONTACT: MS. TERRI BLECK (PHONE) 847-816-5234 (COMPANY) ComEd

F.A.U. R.T.E.	SECTION	COUNTY	TOTAL SHEETS	SHEET NO.
1223	00-00047-00-FP	LAKE	180	163

CABLE PLAN, PHASE DESIGNATION DIAGRAM
 CONTRACT NO. 83845 ILLINOIS

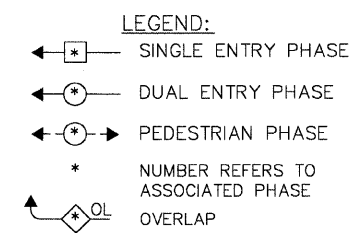
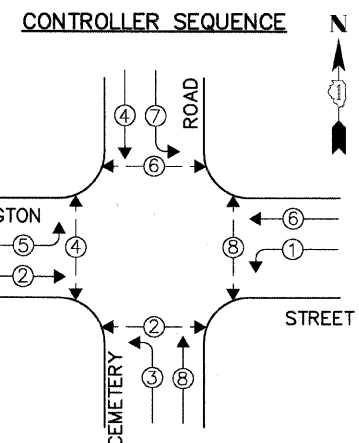
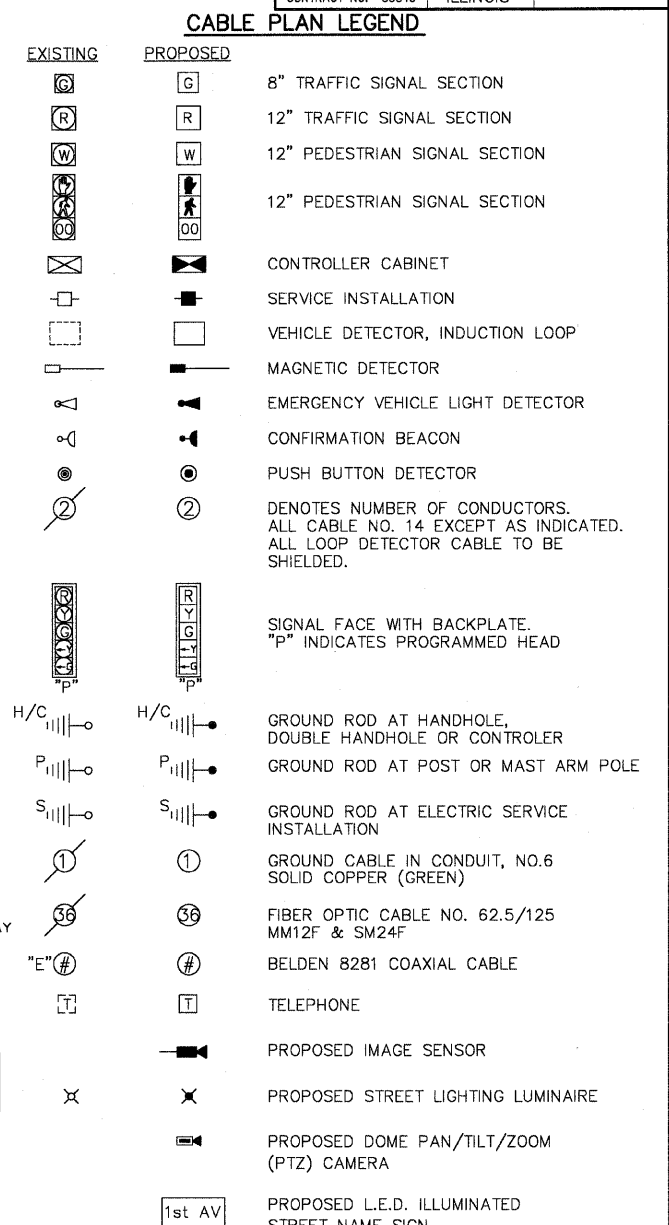
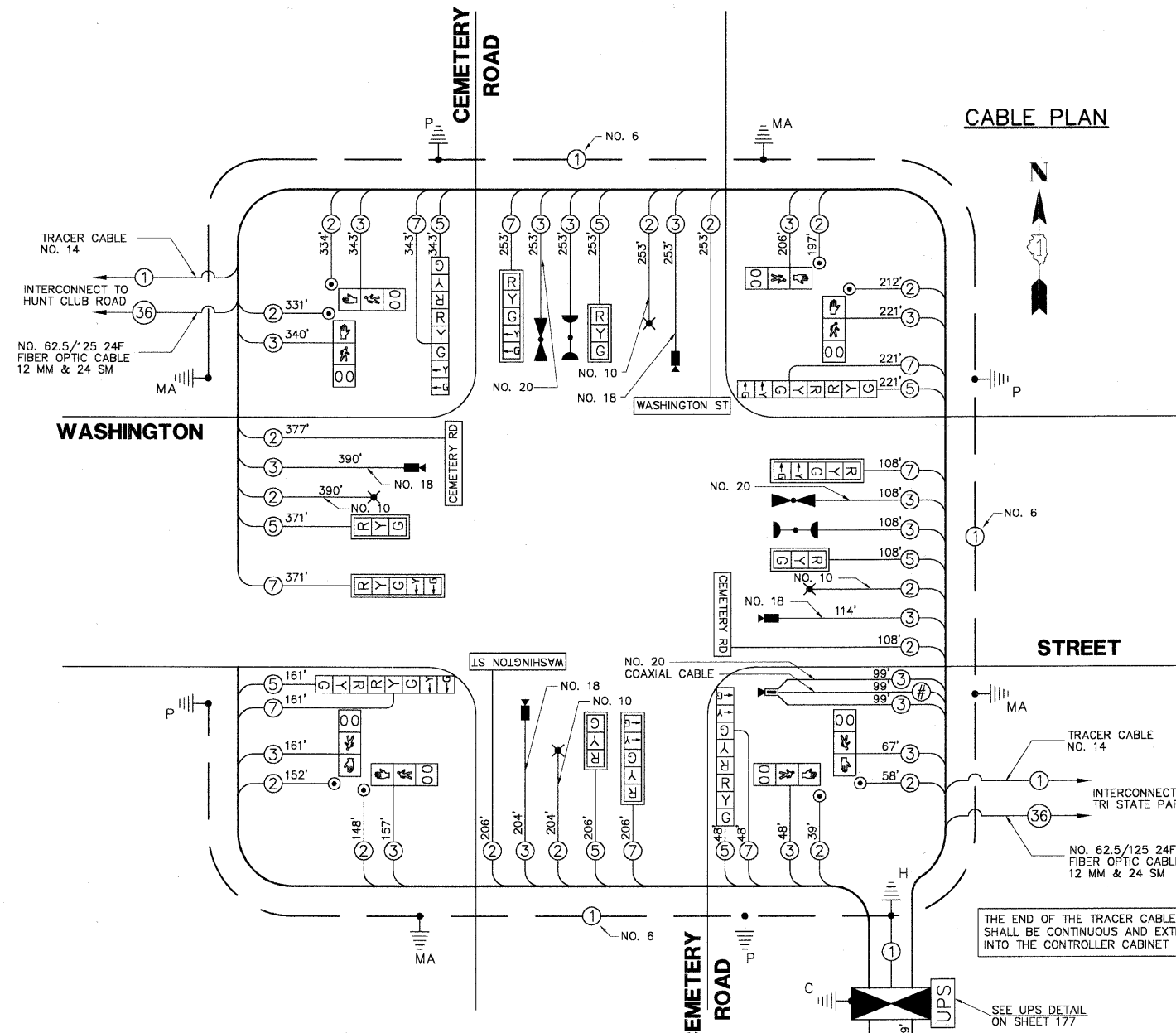

PHASE DESIGNATION DIAGRAM

THE TRAFFIC SIGNAL CONTROL EQUIPMENT FOR THIS PROJECT SHALL BE "ECONOLITE" TO MATCH THE EXISTING ADJACENT SYSTEM.

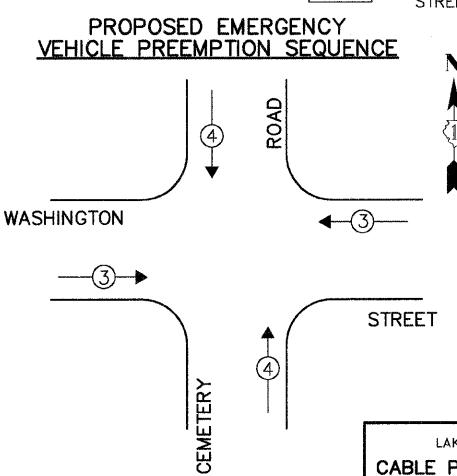

PROPOSED EMERGENCY VEHICLE PREEMPTORS		
EMERGENCY VEHICLE PREEMPTOR	3	4
MOVEMENT	←	→

PLANS PREPARED BY:
GEWALT HAMILTON ASSOCIATES, INC.
 Consulting Engineers & Surveyors
 850 Forest Ridge Drive
 Vernon Hills, IL 60061
 (847) 478-9700
 (847) 478-9701 Fax

REVISIONS	
NAME	DATE
PER IDOT/LCDOT REVIEW	02-15-05
PER LCDOT REVIEW	09-01-05
R-2 PLANS STAGED	06-02-06
REV.-5 PRE-FINAL SUB	02-20-09
PS&E SUBMITTAL	04-10-09

LAKE COUNTY DIVISION OF TRANSPORTATION
CABLE PLAN, PHASE DESIGNATION DIAGRAM AND SCHEDULE OF QUANTITIES
 WASHINGTON STREET AT CEMETERY ROAD
 SCALE: NONE DATE: 11-15-04
 DRAWN BY: CGP
 DESIGNED BY: JRD
 CHECKED BY: BLS