

CONTRACT NO.				
F.A. RTE.	SECTION	COUNTY	TOTAL SHEETS	SHEET NO.
07	00421-00-BR	WINNEBAGO	18	3
STA. 302+00 TO STA. 317+00			ILLINOIS	
CONTRACT NO. 85451				

EXISTING CURVE DATA
(FOR INFORMATION ONLY)

PI STA. = 303+00.64	PI STA. = 316+32.73
Δ = 29° 24'	Δ = 31° 53'
D = 5° 00'	D = 5° 00'
R = 1,146.00'	R = 1,146.28'
T = 300.64'	T = 327.32'
L = 588.00'	L = 637.66'
E = 38.70'	E = 45.84'

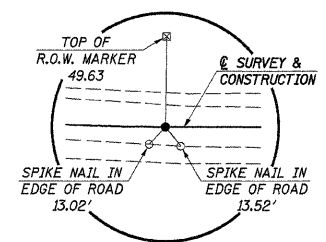

P.O.T. STA. 305+88.03
NAIL & BOTTLE CAP (FLUSH)

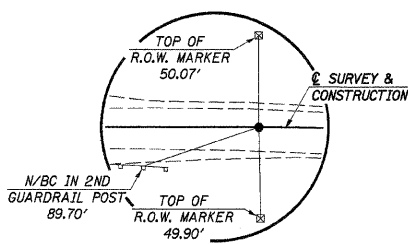

P.O.T. STA. 313+05.50
NAIL AND BOTTLE CAP (FLUSH)

EXISTING STRUCTURE NO. 101-3070

STA. 310+20 THREE SPAN PRESTRESSED CONCRETE DECK BEAM (27") BRIDGE ON R.C. PIERS AND PILE BENT ABUTMENTS WITH CONCRETE SLOPE WALL (6") BK.-BK. 173'-3 3/4", 0-0.33'-0", SKEW = 30°
REMOVAL OF EXISTING STRUCTURES = 1 EACH

SEE SHEET 4 FOR GUARDRAIL AND SHOULDER DETAIL

CHANNEL EXCAVATION

THE CHANNEL SHALL BE EXCAVATED AS SHOWN WITHIN THE LIMITS OF THE PROPOSED STRUCTURE THEN TAPER TO THE EXISTING CHANNEL AT THE R.O.W. LINES. SUITABLE EXCAVATED MATERIAL TO BE USED IN THE EMBANKMENT AS DIRECTED BY THE ENGINEER.

CHANNEL EXCAVATION = 210 CU. YD.

STA. 310+19.92 - SPECIAL BRIDGE DESIGN
FOUR SPAN P.P.C. DECK BEAM (21" DEPTH)
FOUR SPANS @ 46'-0", 186'-1 1/4" BK.-BK. ABUTS.
30'-0" ROADWAY, 30° SKEW RT.
PROPOSED S.N. 101-3069

UTILITIES

- SBC DAVE CONOVER 309-686-3314
- VERIZON NORTH, INC. JONNA FRICKE 309-663-3422
- NICOR GAS UTILITY CONSULTANT G03W 630-388-2362
- COM ED TOM STUTZMAN 630-437-2236
- COMCAST COMMUNICATIONS MICHAEL OWENS 815-509-7876 SCOTT SCHROEDER 815-284-2257

H.M.A. SURFACE REMOVAL - BUTT JOINT

PAVEMENT REMOVAL

NE. 1/4, SECTION 34, T. 43 N., R. 1 E., 3RD P.M.

SE. 1/4, SECTION 27, T. 43 N., R. 1 E., 3RD P.M.

DATE	
BY	
PLAN	
NO.	

DATE	
BY	
PROFILE	
NO.	

PLOT DATE = 05/11/07
FILE NAME = 46466P.PLOT
PLOT SCALE = S. PRICE
USER NAME = S. PRICE

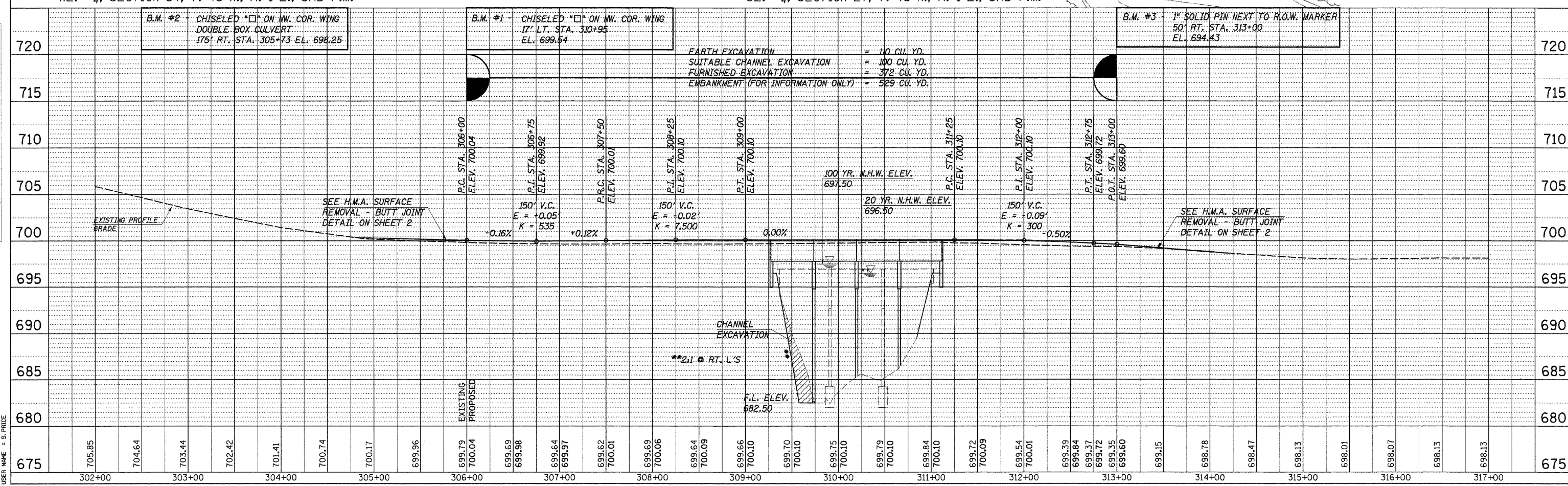

EARTH EXCAVATION = 110 CU. YD.
SUITABLE CHANNEL EXCAVATION = 100 CU. YD.
FURNISHED EXCAVATION = 372 CU. YD.
EMBANKMENT (FOR INFORMATION ONLY) = 529 CU. YD.

CHANNEL EXCAVATION
**2:1 RT. L'S
F.L. ELEV. 682.50