

**BENCHMARK:**  
 BM N.E. BONNET BOLT  
 F.H. N.W. CORNER HUDSON  
 & QUEEN  
 ELEV. 998.54

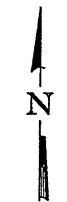
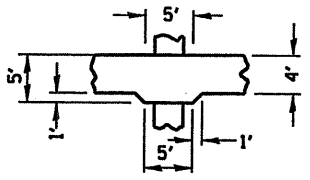

DATE	
BY	
REVISIONS	
NO.	
DESCRIPTION	
DATE	
BY	
NO.	
DESCRIPTION	
DATE	
BY	
NO.	
DESCRIPTION	

DATE	
BY	
REVISIONS	
NO.	
DESCRIPTION	
DATE	
BY	
NO.	
DESCRIPTION	
DATE	
BY	
NO.	
DESCRIPTION	

**LOCATION #7**  
**BEGINS STA. 700+02**

**ORIGINAL TOWN**  
**BLOCK 7, LOT 5**

**LOT 5 - 10'X5'**  
**(WORK PERMIT**  
**AREA)**

**LOCATION #7**  
**ENDS STA. 705+14**

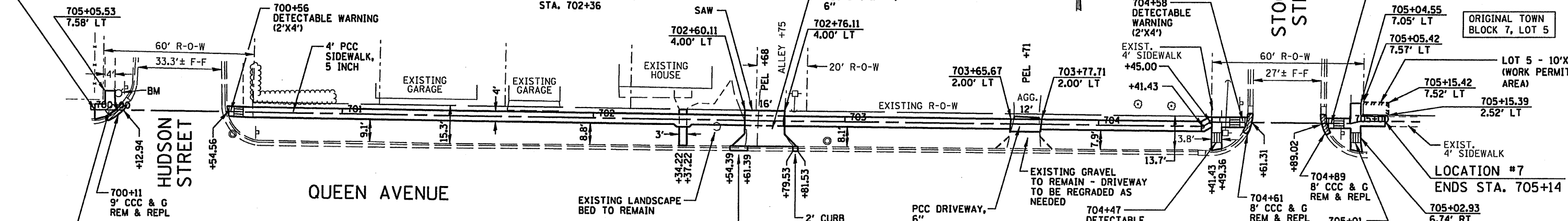

**QUEEN AVENUE**

STATION	ELEV	GRADE	STATION	ELEV	GRADE
700+02.00	996.35		703+65.00	985.77	-1.23
700+10.00	995.73	-7.75	704+46.00	985.84	0.09
700+11.00	995.67	-6.00	704+50.00	985.82	-0.50
700+13.00	995.51	-8.00	704+59.00	985.10	-8.00
700+22.00	994.65	-2.21	704+59.50	985.06	-8.00
700+34.00	994.50	-7.50	704+61.31	985.12	3.31
700+46.00	994.45	-5.00	704+89.00	984.96	-0.58
700+58.00	994.88	7.17	704+90.50	984.87	-6.00
701+00.00	994.96	2.00	705+00.00	985.62	7.88
701+12.00	987.73	-4.23	705+04.00	985.70	2.02
701+24.00	987.06	-2.77	705+14.00	986.16	4.63

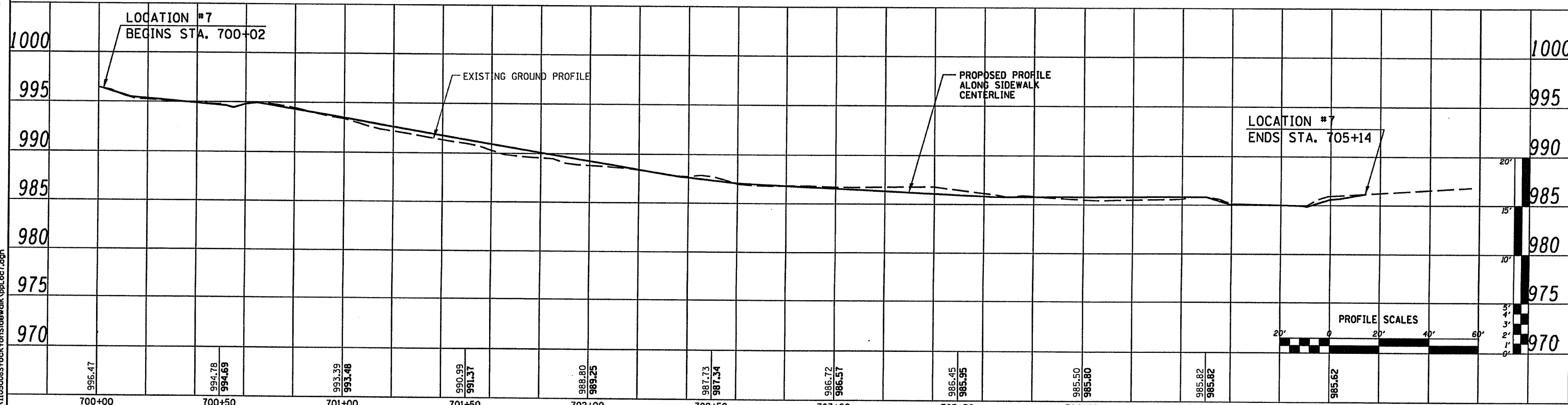
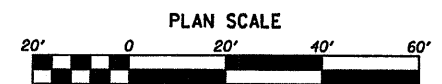

S:\F:\report\1105d085\stockton\sidewalk\pp1.cct.dgn

**WILLET, HOFMANN & ASSOCIATES, INC.**  
**CONSULTING ENGINEERS**  
 809 East Second Street, Dixon, IL 61021  
 Phone 815.294.3381 Fax 815.294.3388  
 Design Firm # 184-00918  
 www.willettthofmann.com

USER NAME =	DESIGNED - M.L.W.	REVISED - 6/3/09
PLOT SCALE =	DRAWN - D.L.B.	REVISED -
PLOT DATE =	CHECKED - J.L.H.	REVISED -
	DATE - 3/18/09	REVISED -

**STOCKTON, IL.**  
**SAFER ROUTES TO SCHOOL PROGRAM**

**LOCATION #7 - QUEEN AVENUE**  
**PLAN AND PROFILE**

F.A. RTE.	SECTION	COUNTY	TOTAL SHEETS	SHEET NO.
	08-00033-00-SW	JO DAVIESS	20	10
STA. 700+02 TO STA. 705+14			CONTRACT 85457	
FED. ROAD DIST. NO. - [ILLINOIS] FED. AID PROJECT				