

INDEX OF SHEETS

1	COVER SHEET, INDEX OF SHEETS AND SUMMARY OF QUANTITIES
2	TYPICAL SECTIONS
3-5	SCHEDULE OF QUANTITIES
6-10	PLAN AND PROFILES - LOCATIONS #1-#5, #7
11-20	CROSS SECTIONS - LOCATIONS #1-#5, #7

STANDARDS

280001-04	TEMPORARY EROSION CONTROL SYSTEMS
424001-05	CURB RAMPS FOR SIDEWALKS
606001-04	CONCRETE CURB TYPE B AND COMBINATION CONCRETE CURB AND GUTTER
701501-05	URBAN LANE CLOSURE, 2L, 2W, UNDIVIDED
701801-04	LANE CLOSURE, MULTILANE 1W OR 2W CROSSWALK OR SIDEWALK CLOSURE
701901-01	TRAFFIC CONTROL DEVICES
720011-01	METAL POSTS FOR SIGNS, MARKERS, AND DELINEATORS
728001-01	TELESCOPING STEEL SIGN SUPPORT
729001-01	APPLICATIONS OF TYPE A AND B METAL POSTS (FOR SIGNS & MARKERS)

DATE	
BY	
PLAN	
NOTE BOOK NO.	
DATE	
BY	
PROFILE	
NOTE BOOK NO.	

NAME AND ADDRESS OF UTILITY	TYPE
VERIZON DAVID KAMKE, ENGINEER 2239 NEWBURG ROAD BELVIDERE, IL 61108 (815) 544-6445	TELEPHONE
NICOR GAS COMPANY JINA BURNS 4651 LINDEN ROAD ROCKFORD, IL 61109 (815) 965-5415 x215	GAS
ComEd 123 ENERGY AVENUE ROCKFORD, IL 61109 (815) 490-2320	ELECTRIC
MEDIACOM Mr. PAT ALDERMAN, Op. Supervisor 2726 STATE ROAD 213 ORFORDVILLE, WI 53576 (563) 590-6200	CABLE
VILLAGE OF STOCKTON 155 W. FRONT AVENUE P.O. BOX 186 STOCKTON, IL 61085 (815) 947-2738	WATER
VILLAGE OF STOCKTON 155 W. FRONT AVENUE P.O. BOX 186 STOCKTON, IL 61085 (815) 947-2738	SEWER

SUMMARY OF QUANTITIES  
CONSTRUCTION TYPE CODE: Y051

ITEM NO.	ITEM	UNIT	QUANTITY
20100110	TREE REMOVAL (6 TO 15 UNITS DIAMETER)	UNIT	12
XX0038	RELOCATE HEDGE	FOOT	132
20200410	EARTH EXCAVATION (SPECIAL)	CU YD	171
25000900	SEEDING, CLASS 1 (SPECIAL)	ACRE	0.31
40200800	AGGREGATE SURFACE COURSE, TYPE B	TON	12
42300710	PORTLAND CEMENT CONCRETE DRIVEWAY PAVEMENT, 6 INCH, SPECIAL	SQ YD	305
42400200	PORTLAND CEMENT CONCRETE SIDEWALK 5 INCH	SQ FT	5,363
42400800	DETECTABLE WARNINGS	SQ FT	112
44001700	COMBINATION CONCRETE CURB AND GUTTER REMOVAL AND REPLACEMENT	FOOT	61
44002400	CURB REMOVAL (SPECIAL)	FOOT	95
56109210	WATER VALVES TO BE ADJUSTED	EACH	1
60255500	MANHOLES TO BE ADJUSTED	EACH	1
67100100	MOBILIZATION	L SUM	1
70101700	TRAFFIC CONTROL AND PROTECTION	L SUM	1

\* INDICATES A SPECIAL PROVISION HAS BEEN PROVIDED

STATE OF ILLINOIS  
DEPARTMENT OF TRANSPORTATION

PLANS FOR  
PROPOSED LOCAL AGENCY IMPROVEMENT  
SAFER ROUTES TO SCHOOL PROGRAM

SECTION 08-00033-00-SW  
VARIOUS LOCATIONS  
JO DAVIESS COUNTY

VILLAGE OF STOCKTON  
PROJECT NO. SRTS-4008(038)  
JOB NO. C-40-020-08  
CONTRACT NO. 85459

2009

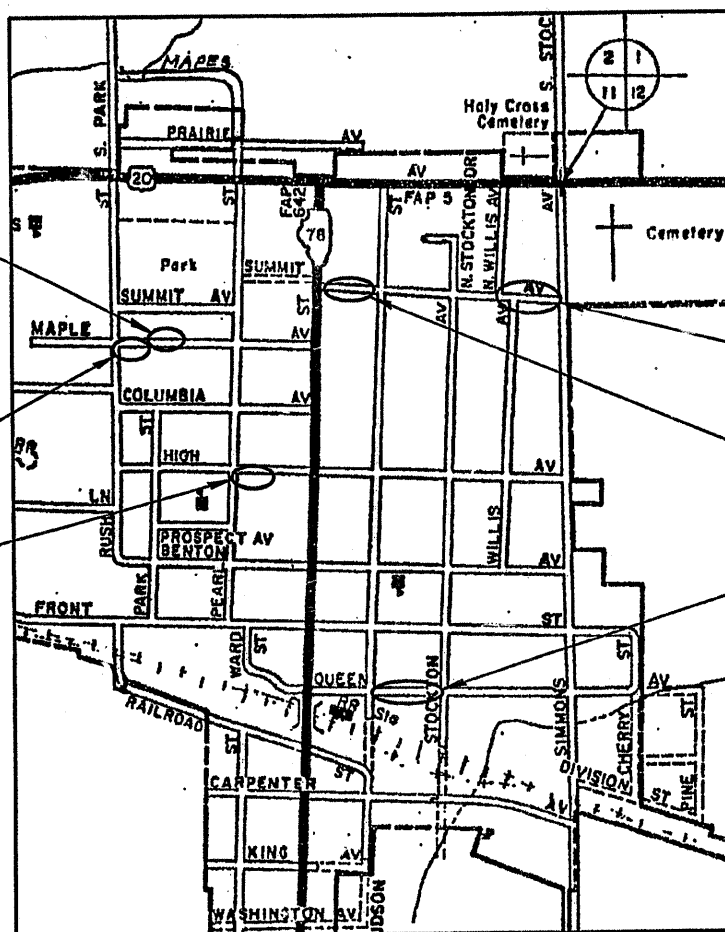

NET LENGTH = 1,604 FEET = 0.30 MILES

SCALES: PLAN 1" = 20'  
PROFILE HORZ. 1" = 20'  
PROFILE VERT. 1" = 5'  
CROSS SECTIONS 1" = 5'

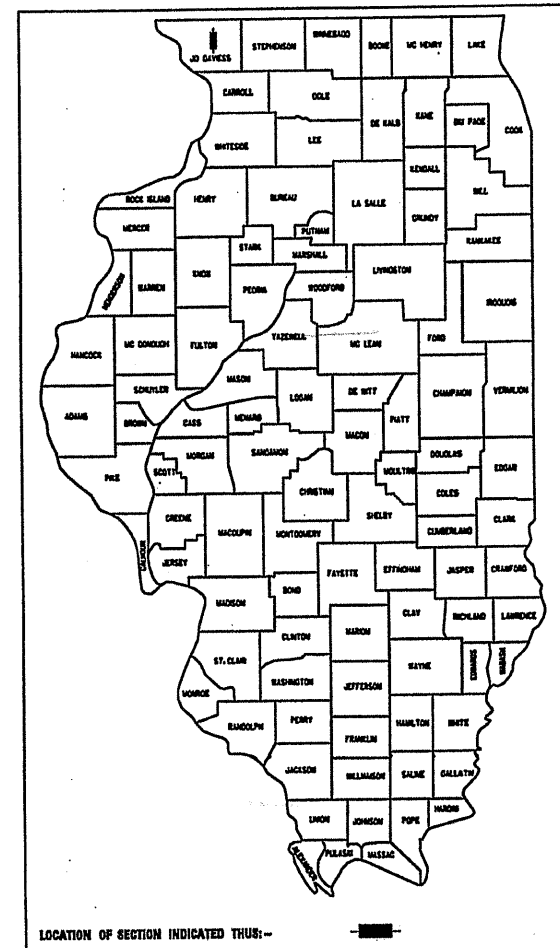

LOCATION OF SECTION INDICATED THUS: [Symbol]

APPROVED: Robert A. [Signature] 2009  
LOCAL AGENCY OFFICIAL  
Village President

PASSED: June 30 2009  
DISTRICT ENGINEER OF LOCAL ROADS & STREETS

RELEASING FOR BID: June 30 2009  
BASED ON LIMITED REVIEW: [Signature]  
DEPUTY DIRECTOR OF HIGHWAYS, REGION 2 ENGINEER

STATE OF ILLINOIS  
DEPARTMENT OF TRANSPORTATION



6/15/09  
Matthew I. Wagner  
Lic Exp 1/30/09



S:\Freport\11050085StocktonSidewalk\Cover.dgn

**WILLET, HOFMANN & ASSOCIATES, INC.**  
CONSULTING ENGINEERS  
809 East Second Street Dixon, IL 61021  
Phone 815.294.3301 Fax 815.294.3388  
Design Firm # 184-0088  
www.willett-hofmann.com

DESIGNED - M.L.W.	REVISED - 6/3/09
DRAWN - J.D.H.	REVISED -
CHECKED - J.L.H.	REVISED -
DATE - 3/18/09	REVISED -

STOCKTON, IL.  
SAFER ROUTES TO SCHOOL PROGRAM

COVER SHEET / SUMMARY OF QUANTITIES

F.A. R.T.E.	SECTION	COUNTY	TOTAL SHEETS	SHEET NO.
	08-00033-00-SW	JO DAVIESS	20	1
STA.	TO STA.	CONTRACT	85459	
FED. ROAD DIST. NO. - ILLINOIS FED. AID PROJECT				

# TYPICAL SECTIONS

DATE	
BY	
DESIGNED	
CHECKED	
IN CHARGE	
NO.	

DATE	
BY	
DESIGNED	
CHECKED	
IN CHARGE	
NO.	

S:\F\9909\1105\0085\stockton\sidewalk\Typical Sections.dgn

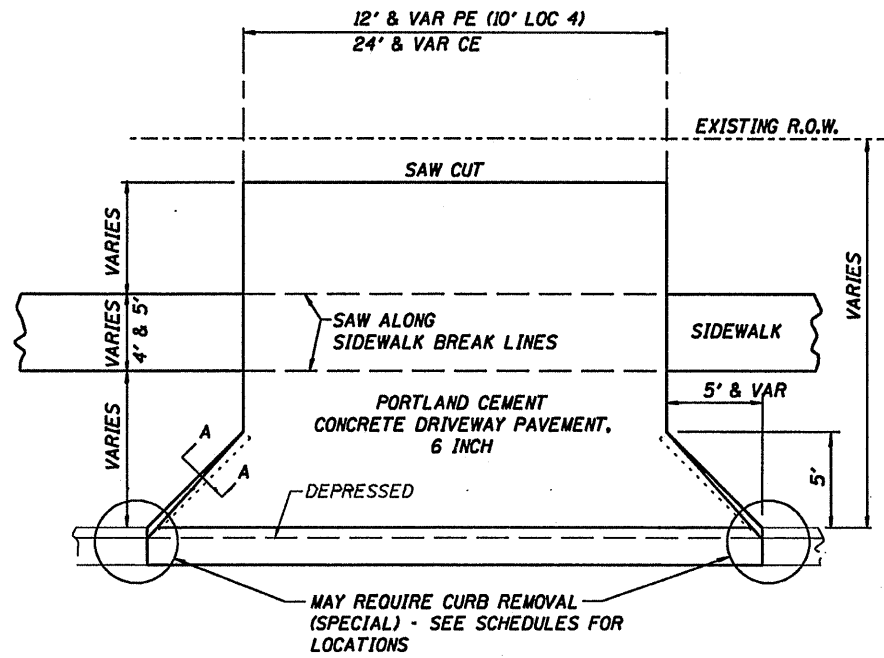

**TYPICAL ENTRANCE**

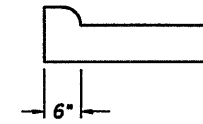

**SECTION A-A**

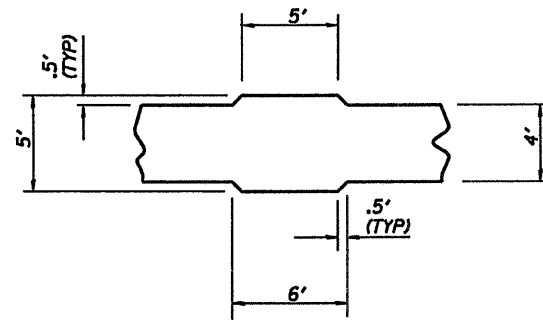

**TYPICAL WHEELCHAIR TURN-OUT  
STA. 205+25**

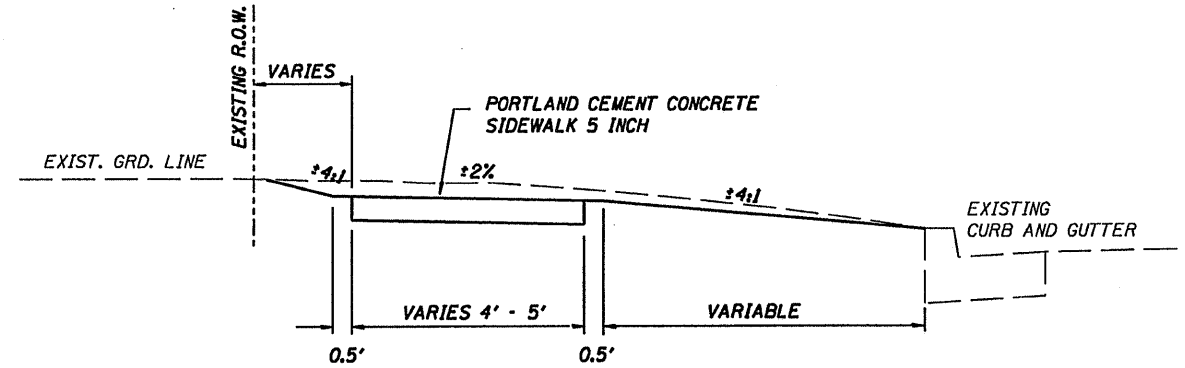

**TYPICAL CROSS SECTION THRU SIDEWALK**

- LOCATION #1 - SUMMIT AVE. (WEST)  
STA. 100+00 TO 103+82
- LOCATION #2 - SUMMIT AVE. (EAST)  
STA. 200+30 TO 203+21
- LOCATION #4 - MAPLE AVE. (NORTH)  
STA. 400+32 TO 401+60
- LOCATION #7 - QUEEN AVE.  
STA. 700+02 TO 705+14

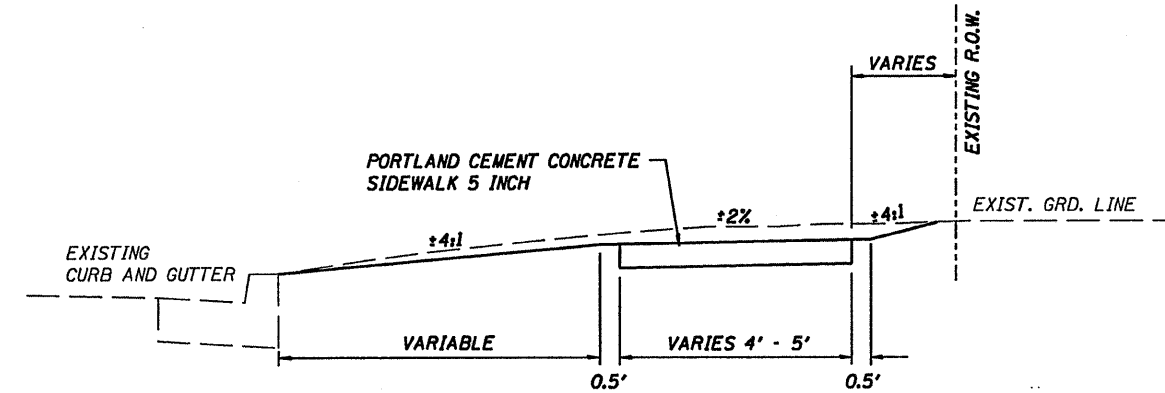

**TYPICAL CROSS SECTION THRU SIDEWALK**

- LOCATION #3 - MAPLE AVE. (SOUTH)  
STA. 300+62 TO 301+72
- LOCATION #5 - HIGH AVE.  
STA. 500+49 TO 502+30

**WILLET, HOFMANN & ASSOCIATES, INC.**  
CONSULTING ENGINEERS  
809 East Second Street Dixon, IL 61021  
Phone 815.284.3381 Fax 815.284.3386  
Design Firm # 184-00918  
www.willett-hofmann.com

USER NAME =	DESIGNED - M.L.W.	REVISED - 6/3/09
	DRAWN - K.B.A.	REVISED -
PLOT SCALE =	CHECKED - J.L.H.	REVISED -
PLOT DATE =	DATE - 3/18/09	REVISED -

**STOCKTON, IL.  
SAFER ROUTES TO SCHOOL PROGRAM**

**TYPICAL SECTIONS**

F.A. RTE.	SECTION	COUNTY	TOTAL SHEETS	SHEET NO.
	08-00033-00-SW	JO DAVIESS	20	2
STA.	TO STA.	CONTRACT	85459	
FED. ROAD DIST. NO. - [ILLINOIS] FED. AID PROJECT				

# SCHEDULES

PLAN	SURVEYED	DATE
	PLOTTED	
NOTE BOOK NO.	CHECKED	
	RT. OF WAY CHECKED	
	CADD FILE NAME	

PROFILE	GRADES CHECKED	DATE
	STRUCTURE NOTATIONS CHECKED	
NOTE BOOK NO.	GRADES CHECKED	
	STRUCTURE NOTATIONS CHECKED	

LOCATION	EARTH EXCAVATION (SPECIAL) 20200410* C.Y.	EARTH EXCAVATION ADJUSTED FOR SHRINKAGE 25%	EMBANKMENT	EARTHWORK BALANCE WASTE (+) OR SHORTAGE (-)
SUMMIT AVE. (WEST) - LOC #1 STA. 100+00 TO 103+82	33	25	3	22
SUMMIT AVE. (EAST) - LOC #2 STA. 200+30 TO 203+21	25	19	0	19
MAPLE AVE. (SOUTH) - LOC #3 STA. 300+62 TO 301+72	40	30	0	30
MAPLE AVE. (NORTH) - LOC #4 STA. 400+32 TO 401+60	5	4	12	-8
HIGH AVE. - LOC #5 STA. 500+49 TO 502+30	25	18	0	18
QUEEN AVE. - LOC #7 STA. 700+02 TO 705+14	43	32	17	15
TOTALS	171	128	32	96

TREE REMOVAL (6 TO 15 UNITS DIAMETER)		
STATION	UNIT	REMARKS
SUMMIT AVENUE - WEST (LOC. #1) 102+82 LT 3'	12	
PROJECT TOTAL	12	

20100110

AGGREGATE SURFACE COURSE, TYPE B		
STATION	TON	REMARKS
QUEEN AVENUE (LOC #7) PEL 703+71	12	CONTINGENCY ITEM - DRESS AGG. DRIVEWAY
PROJECT TOTAL	12	

40200800

SEEDING, CLASS 1 (SPECIAL)		
STATION	ACRE	REMARKS
SUMMIT AVENUE - WEST (LOC #1) 100+00 TO 103+82 LT	0.03	
100+00 TO 103+82 RT	0.04	
SUBTOTAL	0.07	
SUMMIT AVENUE - EAST (LOC #2) 200+30 TO 203+21 LT	0.01	
200+30 TO 203+21 RT	0.04	
SUBTOTAL	0.05	
MAPLE AVENUE - SOUTH (LOC #3) 300+12 TO 301+72 LT	0.03	
300+12 TO 301+72 RT	0.01	
SUBTOTAL	0.04	
MAPLE AVENUE - NORTH (LOC #4) 400+32 TO 401+60 LT	0.01	
400+32 TO 401+60 RT	0.01	
SUBTOTAL	0.02	
HIGH AVENUE - (LOC #5) 500+49 TO 502+30 LT	0.02	
500+49 TO 502+30 RT	0.01	
SUBTOTAL	0.03	
QUEEN AVENUE - (LOC #7) 700+02 TO 705+14 LT	0.02	
700+02 TO 705+14 RT	0.08	
SUBTOTAL	0.10	
PROJECT TOTAL	0.31	

25000900

PORTLAND CEMENT CONCRETE DRIVEWAY PAVEMENT, 6 INCH, SPECIAL		
STATION	SO YD	REMARKS
SUMMIT AVENUE - WEST (LOC #1) CEL 100+88	32	
PEL 102+32	22	
SUBTOTAL	54	
SUMMIT AVENUE - EAST (LOC #2) PEL 201+50	32	
PEL 202+34	22	
SUBTOTAL	54	
MAPLE AVENUE - SOUTH (LOC #3) PER 301+54	67	
SUBTOTAL	67	
MAPLE AVENUE - NORTH (LOC #4) PEL 401+49	16	
SUBTOTAL	16	
HIGH AVENUE (LOC #5) PEL 501+29	43	
PEL 501+75	38	
SUBTOTAL	81	
QUEEN AVENUE (LOC #7) PEL 702+68	28	
PEL 703+71	5	
SUBTOTAL	33	
PROJECT TOTAL	305	

42300710

SA\Fepop\F1105d085\stocktonSidewalk\Typical Sections.dgn



**WILLET, HOFMANN & ASSOCIATES, INC.**  
CONSULTING ENGINEERS  
809 East Second Street Dixon, IL 61021  
Phone 815.284.3381 Fax 815.284.3388  
Design Firm # 184-00918  
www.willett-hofmann.com

USER NAME =	DESIGNED - M.L.W.	REVISED - 6/3/09
	DRAWN - K.B.A.	REVISED -
PLOT SCALE =	CHECKED - J.L.H.	REVISED -
PLOT DATE =	DATE - 3/18/09	REVISED -

STOCKTON, IL.  
SAFER ROUTES TO SCHOOL PROGRAM

SCHEDULES

F.A. RTE.	SECTION	COUNTY	TOTAL SHEETS	SHEET NO.
	08-00033-00-SW	JO DAVIESS	20	3
STA.	TO STA.	CONTRACT 85459		
FED. ROAD DIST. NO.	ILLINOIS FED. AID PROJECT			

# SCHEDULES

DATE	
BY	
PLANNED	
CHECKED	
NO. OF WAY CHECKED	
DATE FILE NAME	
PLAN	
NO.	

DATE	
BY	
DESIGNED	
CHECKED	
NO. OF WAY CHECKED	
DATE FILE NAME	
PROFILE	
NO.	

PORTLAND CEMENT CONCRETE SIDEWALK 5 INCH		
STATION	SO FT	REMARKS
<b>SUMMIT AVENUE - WEST (LOC #1)</b>		
99+98 TO 100+00	25	4' W
100+00 TO 100+75.95	304	4' W
101+02.90 TO 102+27.80	512	4' - 5' W
102+39.98 TO 103+00.35	229	4' W
103+03.35 TO 103+17.56	57	4' W
103+50.90 TO 103+82	166	3.8' W
<b>SUBTOTAL</b>	<b>1,293</b>	
<b>SUMMIT AVENUE - EAST (LOC #2)</b>		
200+30 TO 200+36.12	27	4' W
200+54.01 TO 201+41.30	348	4' W
201+59.15 TO 202+28.04	275	4' W
202+11.25 TO 202+17.04	14	4' W
202+40.04 TO 203+21.31	325	4' W
<b>SUBTOTAL</b>	<b>989</b>	
<b>MAPLE AVENUE - SOUTH (LOC #3)</b>		
300+64.66 TO 301+43.92	317	4' W
301+10.42 TO 301+13.37	9	2.8' W
301+63.76 TO 301+72	34	4' W
<b>SUBTOTAL</b>	<b>360</b>	
<b>MAPLE AVENUE - NORTH (LOC #4)</b>		
400+32 TO 400+73.48	168	4' W
400+95.97 TO 401+44.05	188	4' W
401+54.05 TO 401+60	18	4' W
<b>SUBTOTAL</b>	<b>374</b>	
<b>HIGH AVENUE - (LOC #5)</b>		
500+51.96 TO 501+18.12	275	4' W
501+39.12 TO 501+66.19	103	4' W
501+84.19 TO 502+30	182	4' W
<b>SUBTOTAL</b>	<b>560</b>	
<b>QUEEN AVENUE (LOC #7)</b>		
700+01.54 TO 700+09.53	61	4' & VAR W
700+54.56 TO 702+60.11	822	4' W
702+34.22 TO 702+37.22	31	3' W
702+76.11 TO 703+65.67	358	4' W
703+77.41 TO 704+45.00	272	4' W
704+45 TO 704+49.36	51	4' W
704+49.36 TO 704+59.23	40	4' W
704+91.03 TO 705+14	152	4' W
<b>SUBTOTAL</b>	<b>1,787</b>	
<b>PROJECT TOTAL</b>	<b>5,363</b>	

DETECTABLE WARNINGS		
STATION	SO FT	REMARKS
<b>SUMMIT AVENUE - WEST (LOC #1)</b>		
99+98	8	2'X4'
103+16	8	2'X4'
103+53	8	2'X4'
<b>SUBTOTAL</b>	<b>24</b>	
<b>SUMMIT AVENUE - EAST (LOC #2)</b>		
200+34	8	2'X4'
200+55	8	2'X4'
203+19	8	2'X4'
<b>SUBTOTAL</b>	<b>24</b>	
<b>MAPLE AVENUE - SOUTH (LOC #3)</b>		
300+62	8	2'X4'
<b>SUBTOTAL</b>	<b>8</b>	
<b>HIGH AVENUE - (LOC #5)</b>		
500+53	8	2'X4'
<b>SUBTOTAL</b>	<b>8</b>	
<b>QUEEN AVENUE (LOC #7)</b>		
700+08	8	2'X4'
700+56	8	2'X4'
704+47	8	2'X4'
704+58	8	2'X4'
704+93	8	2'X4'
705+01	8	2'X4'
<b>SUBTOTAL</b>	<b>48</b>	
<b>PROJECT TOTAL</b>	<b>112</b>	

COMBINATION CONCRETE CURB AND GUTTER REMOVAL AND REPLACEMENT		
STATION	FOOT	REMARKS
<b>SUMMIT AVENUE - WEST (LOC #1)</b>		
103+18	8	
103+49	8	
<b>SUBTOTAL</b>	<b>16</b>	
<b>MAPLE AVENUE - SOUTH (LOC #3)</b>		
300+62	11	
<b>SUBTOTAL</b>	<b>11</b>	
<b>HIGH AVENUE - (LOC #5)</b>		
500+53	9	
<b>SUBTOTAL</b>	<b>9</b>	
<b>QUEEN AVENUE (LOC #7)</b>		
700+11	9	
704+61	8	
704+89	8	
<b>SUBTOTAL</b>	<b>25</b>	
<b>PROJECT TOTAL</b>	<b>61</b>	

S:\Fr\report\1105d085\stockton\sidewalk\Typical Schedules.dgn

**WILLET, HOFMANN & ASSOCIATES, INC.**  
**CONSULTING ENGINEERS**  
 809 East Second Street Dixon, IL 61021  
 Phone 815-294-3381 Fax 815-294-3388  
 Design Firm # 184-00918  
 www.willettthofmann.com

USER NAME =	DESIGNED - M.L.W.	REVISED - 6/3/09
PLOT SCALE =	DRAWN - K.B.A.	REVISED -
PLOT DATE =	CHECKED - J.L.H.	REVISED -
	DATE - 3/16/09	REVISED -

**STOCKTON, IL.**  
**SAFER ROUTES TO SCHOOL PROGRAM**

**SCHEDULES**

F.A. RTE.	SECTION	COUNTY	TOTAL SHEETS	SHEET NO.
	08-00033-00-SW	JO DAVIESS	20	4
STA.	TO STA.	CONTRACT	85459	
FED. ROAD DIST. NO. ILLINOIS FED. AID PROJECT				

# SCHEDULES

PLAN	SURVEYED	DATE
NOTE BOOK NO.	PLOTTED	
	GRADES CHECKED	
	STRUCTURE NOTATIONS CHKD	
	FILE NAME	

PROFILE	SURVEYED	DATE
NOTE BOOK NO.	PLOTTED	
	GRADES CHECKED	
	STRUCTURE NOTATIONS CHKD	
	FILE NAME	

CURB REMOVAL (SPECIAL)		
STATION	FOOT	REMARKS
<b>SUMMIT AVENUE - WEST (LOC #1)</b>		
101+02.64 TO 101+08.64	6	
102+23.20 TO 102+28.20	5	
102+44.80 TO 102+47.80	3	
<b>SUBTOTAL</b>	<b>14</b>	
<b>SUMMIT AVENUE - EAST (LOC #2)</b>		
201+36.94 TO 201+41.58	6	
201+60.34 TO 201+65.34	5	
202+24.23 TO 202+28.40	6	
202+39.35 TO 202+45.35	6	
<b>SUBTOTAL</b>	<b>23</b>	
<b>MAPLE AVENUE - SOUTH (LOC #3)</b>		
301+38.52 TO 301+43.52	5	
301+63.14 TO 301+69.14	6	
<b>SUBTOTAL</b>	<b>11</b>	
<b>MAPLE AVENUE - NORTH (LOC #4)</b>		
401+38.83 TO 401+44.83	6	
401+55.20 TO 401+59.20	4	
<b>SUBTOTAL</b>	<b>10</b>	
<b>HIGH AVENUE - (LOC #5)</b>		
501+12.90 TO 501+20.90	8	
501+37.37 TO 501+44.37	7	
501+60.87 TO 501+67.87	7	
501+83.58 TO 501+87.78	6	
<b>SUBTOTAL</b>	<b>28</b>	
<b>QUEEN AVENUE (LOC #7)</b>		
702+54.39 TO 702+61.39	7	
702+79.53 TO 702+81.53	2	
<b>SUBTOTAL</b>	<b>9</b>	
<b>PROJECT TOTAL</b>	<b>95</b>	

WATER VALVES TO BE ADJUSTED		
STATION	EACH	REMARKS
<b>SUMMIT AVENUE - EAST (LOC #2)</b>		
200+96	1	
<b>PROJECT TOTAL</b>	<b>1</b>	

MANHOLES TO BE ADJUSTED		
STATION	EACH	REMARKS
<b>SUMMIT AVENUE - EAST (LOC #2)</b>		
203+16	1	
<b>PROJECT TOTAL</b>	<b>1</b>	

RELOCATE HEDGE		
STATION	FOOT	REMARKS
<b>SUMMIT AVENUE - WEST (LOC #1)</b>		
101+18	6	
101+35 TO 102+20	85	
102+47 TO 102+88	41	
<b>PROJECT TOTAL</b>	<b>132</b>	

S:\Freepor\1105d08\Stockton\SideWalk\Typical Sections.dgn

**WILLET, HOFMANN & ASSOCIATES, INC.**  
**CONSULTING ENGINEERS**  
 809 East Second Street Dixon, IL 61021  
 Phone 815.284.3381 Fax 815.284.3385  
 Design Firm # 184-00018  
 www.willett-hofmann.com

USER NAME =	DESIGNED - M.L.W.	REVISED - 6/3/09
	DRAWN - K.B.A.	REVISED -
PLOT SCALE =	CHECKED - J.L.H.	REVISED -
PLOT DATE =	DATE - 3/16/09	REVISED -

**STOCKTON, IL.**  
**SAFER ROUTES TO SCHOOL PROGRAM**

**SCHEDULES**

F.A. RTE.	SECTION	COUNTY	TOTAL SHEETS	SHEET NO.
	08-00033-00-SW	JO DAVIESS	20	5
STA.	TO STA.	CONTRACT	85459	
FED. ROAD DIST. NO.	ILLINOIS FED. AID PROJECT			

DATE	
BY	
PLAN	
SURVEYED	
PLOTTED	
NOTE BOOK	
NO.	

DATE	
BY	
PROFILE	
SURVEYED	
PLOTTED	
NOTE BOOK	
NO.	

BENCHMARK:  
 BM "0" IN OPEN  
 F.H. S.W. CORNER SUMMIT & HUDSON  
 ELEV. 999.85

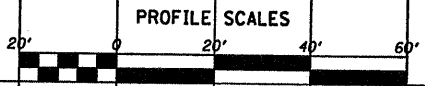
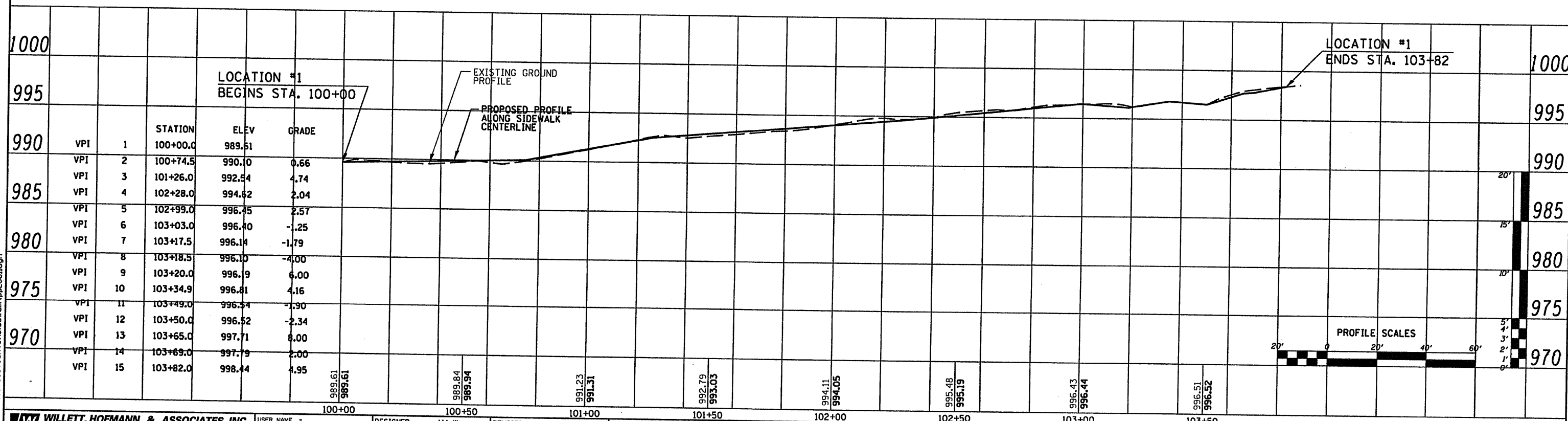
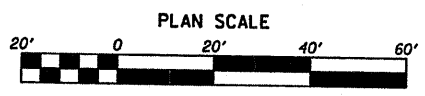
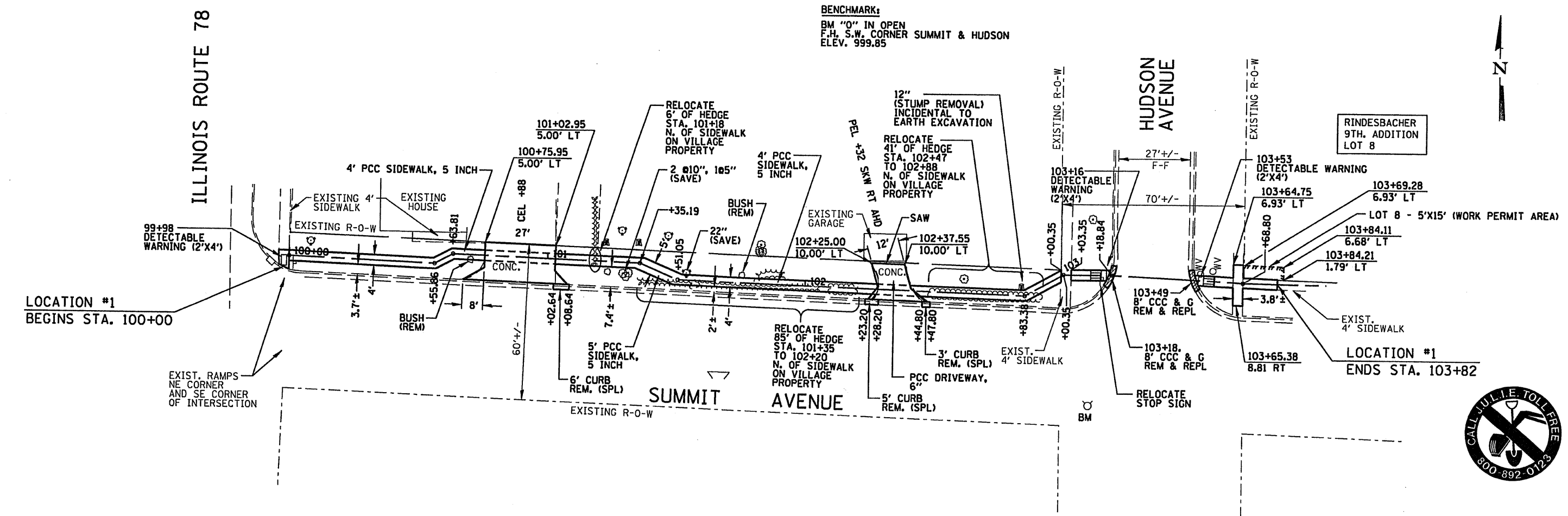

**WILLETT, HOFMANN & ASSOCIATES, INC.**  
 CONSULTING ENGINEERS  
 809 East Second Street Dixon, IL 61021  
 Phone 815.294.3361 Fax 815.294.3385  
 Design Firm # 154-00916  
 www.willett-hofmann.com

USER NAME =	DESIGNED - M.L.W.	REVISED - 6/3/09
PLOT SCALE =	DRAWN - D.L.B.	REVISED -
PLOT DATE =	CHECKED - J.L.H.	REVISED -
	DATE - 3/16/09	REVISED -

**STOCKTON, IL.**  
**SAFER ROUTES TO SCHOOL PROGRAM**

**LOCATION #1 - SUMMIT AVENUE (WEST)**  
**PLAN AND PROFILE**

F.A. RTE.	SECTION	COUNTY	TOTAL SHEETS	SHEET NO.
	08-00033-00-SW	JO DAVIEST	20	6
STA. 100+00 TO 103+82			CONTRACT 85459	
FED. ROAD DIST. NO. - ILLINOIS FED. AID PROJECT				

BENCHMARK:  
 BM "M" IN MUELLER  
 F.H. S.W. CORNER STOCKTON  
 & SUMMIT  
 ELEV. 1002.58

RINDESBACHER  
 9TH. ADDITION  
 LOT 15

RINDESBACHER  
 9TH. ADDITION  
 LOT 16

RINDESBACHER  
 9TH. ADDITION  
 LOT 22

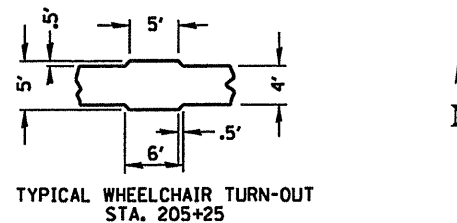

DATE	
BY	
PLAN	
SURVEYED	
PLOTTED	
NOTED	
NO.	

DATE	
BY	
PROFILE	
SURVEYED	
PLOTTED	
NOTED	
NO.	

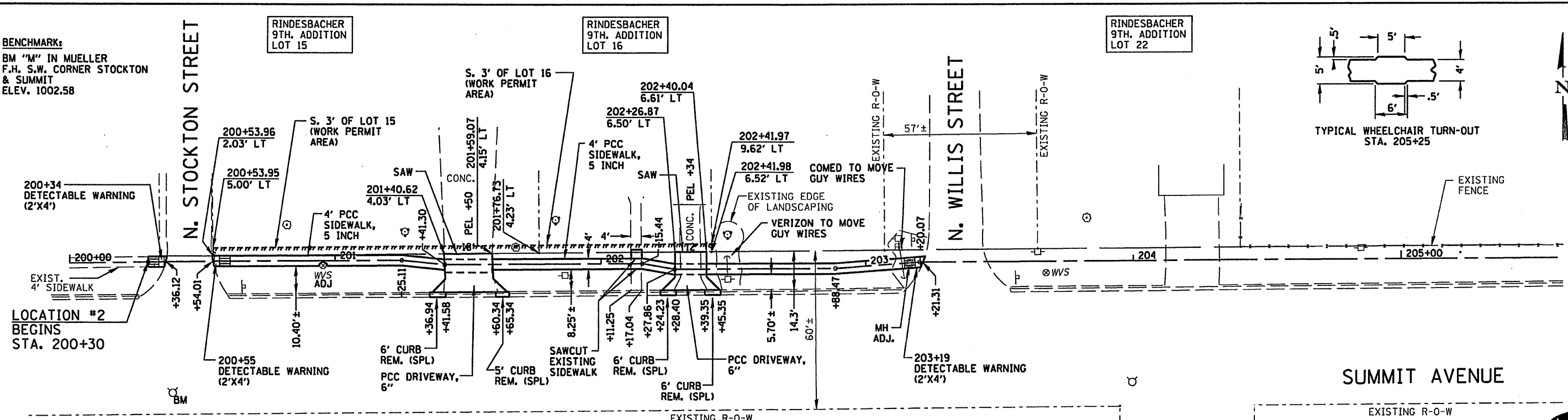

VPI	STATION	ELEV	GRADE	VPI	STATION	ELEV	GRADE
VPI 1	200+30.00	1,000.88		VPI 10	203+21.31	997.60	-7.98
VPI 2	200+36.12	1,000.52	-5.88				
VPI 3	200+54.01	1,000.52	0.00				
VPI 4	200+81.00	1,001.19	2.49				
VPI 5	201+59.00	999.80	-1.78				
VPI 6	202+13.00	1,000.10	0.56				
VPI 7	202+40.00	999.70	-1.48				
VPI 8	202+90.00	999.20	-1.00				
VPI 9	203+09.04	998.58	-3.26				

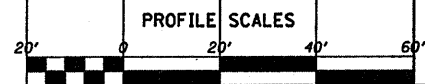
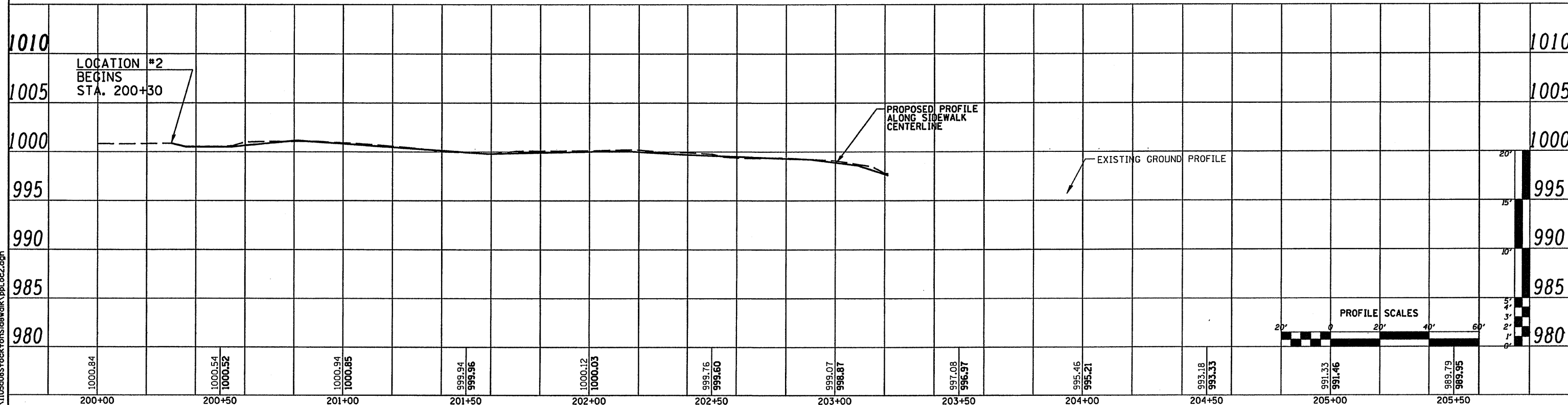
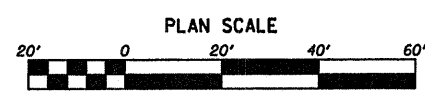

SA:\Fr\epor\1105c085\stockton\sidewalk\lpp\loc2.dgn

<b>WILLET, HOFMANN &amp; ASSOCIATES, INC.</b> CONSULTING ENGINEERS 809 East Second Street Dixon, IL 61021 Phone 815.284.3381 Fax 815.284.3385 Design Firm # 184-00918 www.willett-hofmann.com	USER NAME =	DESIGNED - M.L.W.	REVISED - 6/3/09	<b>STOCKTON, IL.</b> <b>SAFER ROUTES TO SCHOOL PROGRAM</b>	<b>LOCATION #2 - SUMMIT AVENUE (EAST)</b> <b>PLAN AND PROFILE</b>	F.A. RTE.	SECTION	COUNTY	TOTAL SHEETS	SHEET NO.
	PLOT SCALE =	DRAWN - D.L.B.	REVISED -			08-00033-00-SW	JO DAVIESS	20	7	
	PLOT DATE =	CHECKED - J.L.H.	REVISED -			STA. 200+30 TO STA. 205+60	CONTRACT	85459		
		DATE - 3/18/09	REVISED -			FED. ROAD DIST. NO. -	ILLINOIS FED. AID PROJECT			

DATE	
BY	
REVISIONS	
NO.	
DATE	
BY	
REVISIONS	
NO.	
DATE	
BY	
REVISIONS	
NO.	

DATE	
BY	
REVISIONS	
NO.	
DATE	
BY	
REVISIONS	
NO.	
DATE	
BY	
REVISIONS	
NO.	

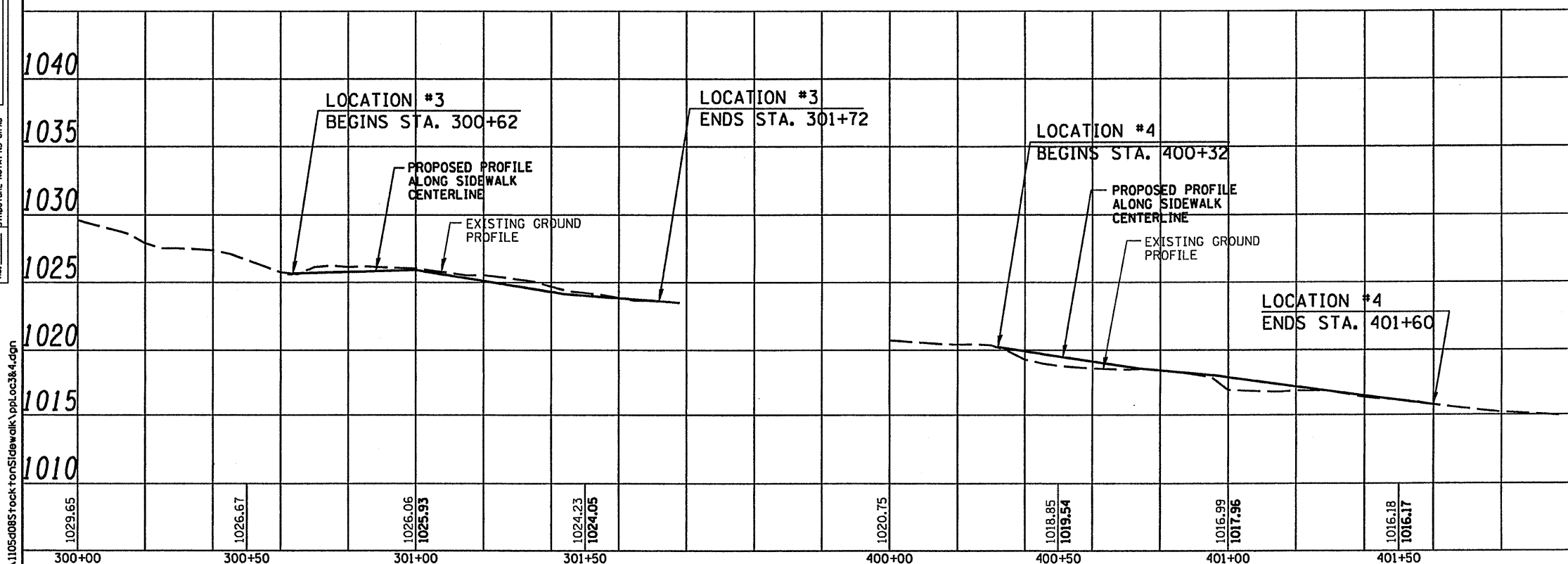
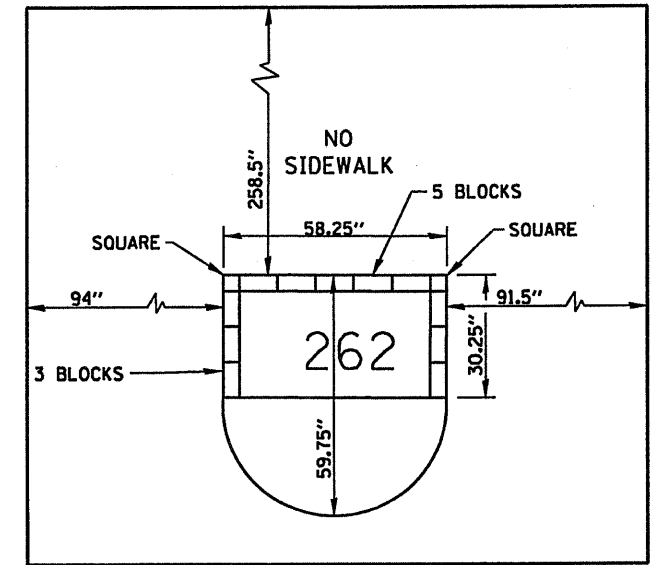
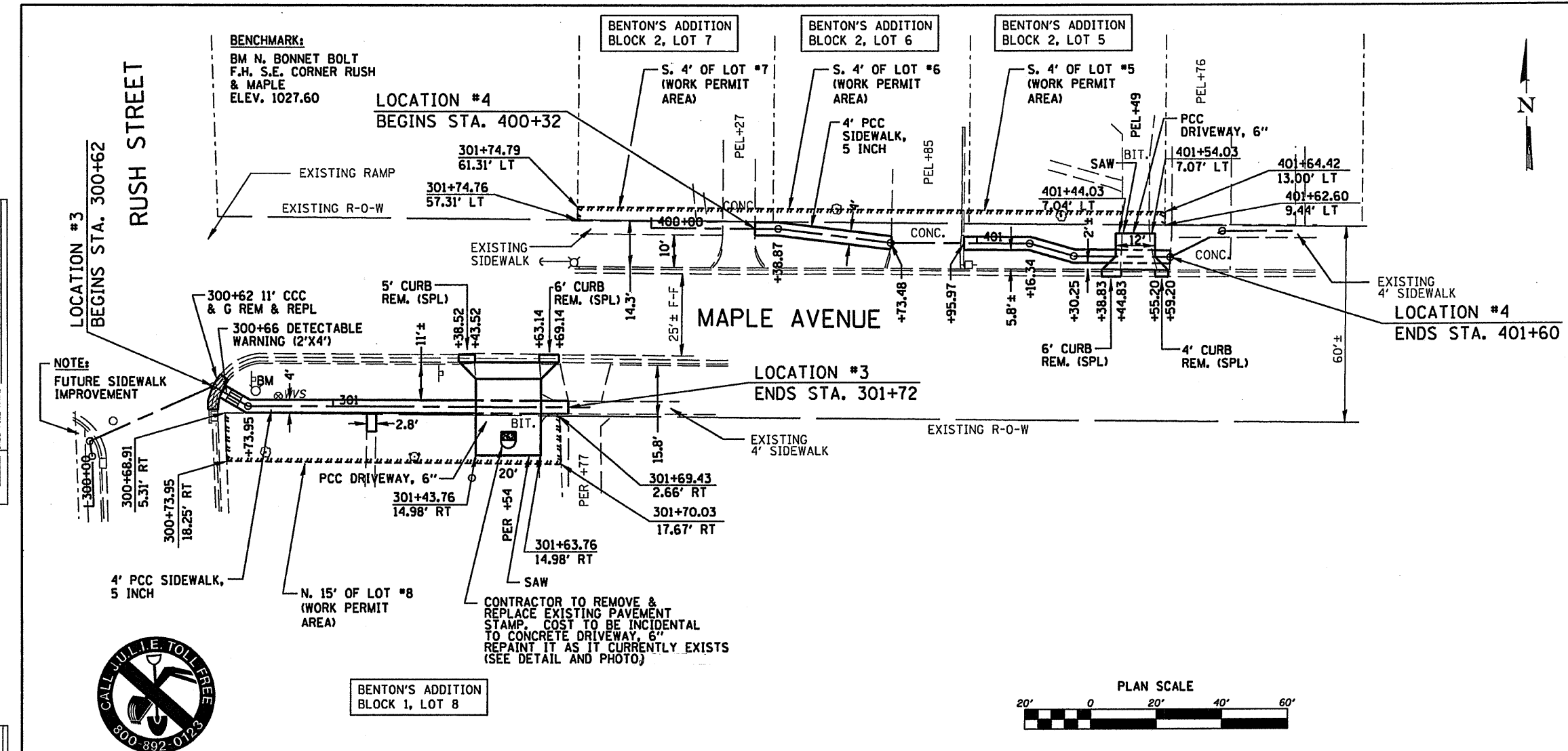

STATION	ELEV	GRADE
VPI 1	300+61.62	1,025.63
VPI 2	300+63.10	1,025.64
VPI 3	300+63.60	1,025.68
VPI 4	301+00.00	1,025.93
VPI 5	301+44.00	1,024.16
VPI 6	301+72.00	1,023.64
VPI 1	400+32.00	1,020.23
VPI 2	400+73.48	1,018.65
VPI 3	400+95.97	1,018.10
VPI 4	401+60.00	1,015.81

**WILLET, HOFMANN & ASSOCIATES, INC.**  
CONSULTING ENGINEERS  
809 East Second Street Dixon, IL 61021  
Phone 815.294.3361 Fax 815.294.3366  
Design Firm # 184-00978  
www.willetthofmann.com

USER NAME =	DESIGNED - M.L.W.	REVISED - 6/3/09
DESIGNED - M.L.W.	DRAWN - D.L.B.	REVISED -
DRAWN - D.L.B.	CHECKED - J.L.H.	REVISED -
CHECKED - J.L.H.	DATE - 3/18/09	REVISED -
DATE - 3/18/09		

**STOCKTON, IL.**  
**SAFER ROUTES TO SCHOOL PROGRAM**

**LOCATIONS #3 & #4 - MAPLE AVENUE**  
**PLAN AND PROFILE**

F.A. RTE.	SECTION	COUNTY	TOTAL SHEETS	SHEET NO.
	08-00033-00-SW	JO DAVIESS	20	8
STA. 300+62 TO STA. 401+60			CONTRACT 85459	
FED. ROAD DIST. NO. - [ILLINOIS] FED. AID PROJECT				



**BENCHMARK:**  
 BM N. BONNET BOLT  
 F.H. S.E. CORNER PEARL  
 & HIGH  
 ELEV. 1024.43

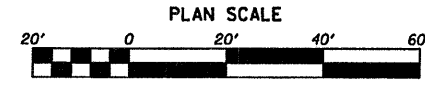
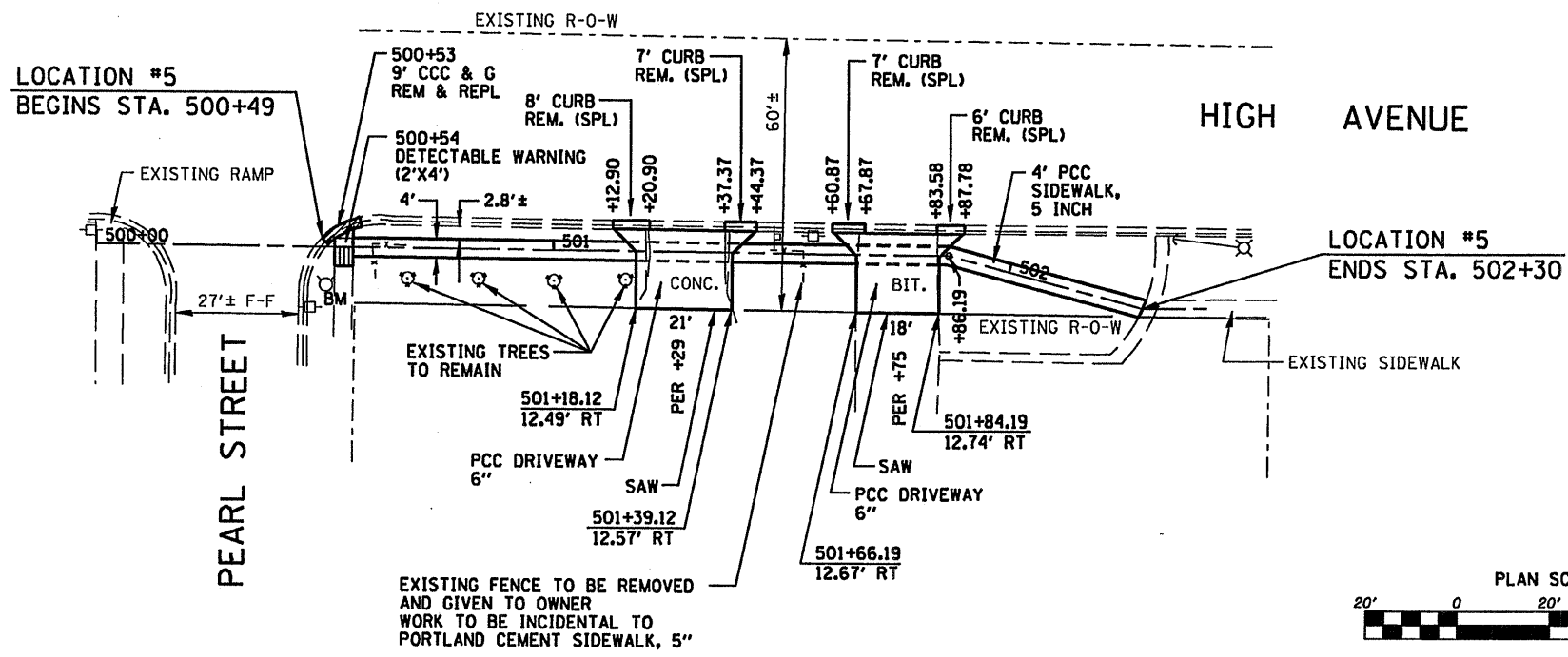

DATE	
BY	
REVIEWED	
PLANNED	
NOTED	
ALIGNED	
CHECKED	
NO. _____	
PLAN	
NO. _____	
NOTE BOOK	
NO. _____	
FILE NAME	
FILE NO.	

DATE	
BY	
REVIEWED	
PLANNED	
NOTED	
ALIGNED	
CHECKED	
NO. _____	
PROFILE	
NO. _____	
NOTE BOOK	
NO. _____	
FILE NAME	
FILE NO.	

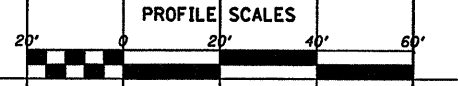
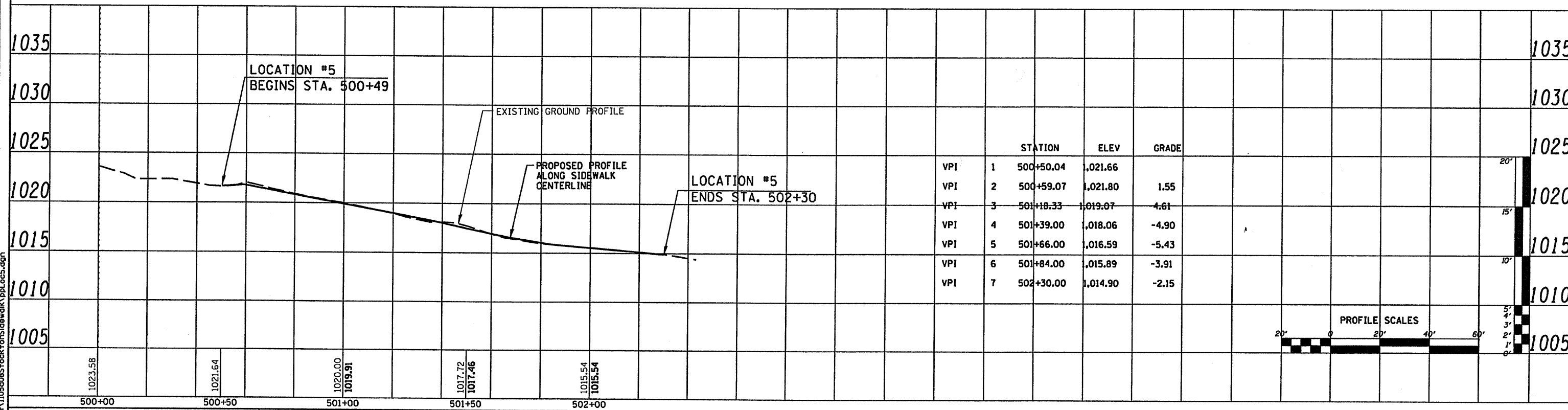

**WILLET, HOFMANN & ASSOCIATES, INC.**  
 CONSULTING ENGINEERS  
 809 East Second Street Dixon, IL 61021  
 Phone 815.284.3381 Fax 815.284.3388  
 Design Firm # 184-00918  
 www.willett-hofmann.com

USER NAME =	DESIGNED - M.L.W.	REVISED - 6/3/09
PLLOT SCALE =	DRAWN - D.L.B.	REVISED -
PLLOT DATE =	CHECKED - J.L.H.	REVISED -
	DATE - 3/18/09	REVISED -

**STOCKTON, IL.**  
**SAFER ROUTES TO SCHOOL PROGRAM**

**LOCATION #5 - HIGH AVENUE**  
**PLAN AND PROFILE**

F.A. RTE.	SECTION	COUNTY	TOTAL SHEETS	SHEET NO.
	08-00033-00-SW	JO DAVIESS	20	9
STA. 500+49 TO STA. 502+30			CONTRACT 85459	
FED. ROAD DIST. NO. - ILLINOIS FED. AID PROJECT				

S:\r\epor-r1105-d085\rockton\sidewalk\ppl\oc5.dgn

**BENCHMARK:**  
 BM N.E. BONNET BOLT  
 F.H. N.W. CORNER HUDSON  
 & QUEEN  
 ELEV. 998.54

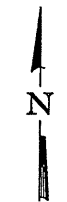
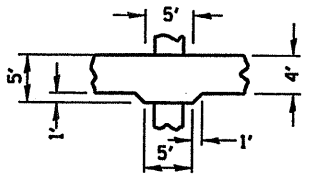

DATE	
BY	
REVISIONS	
NO.	
DATE	
BY	
REVISIONS	
NO.	
DATE	
BY	
REVISIONS	
NO.	
DATE	
BY	
REVISIONS	
NO.	

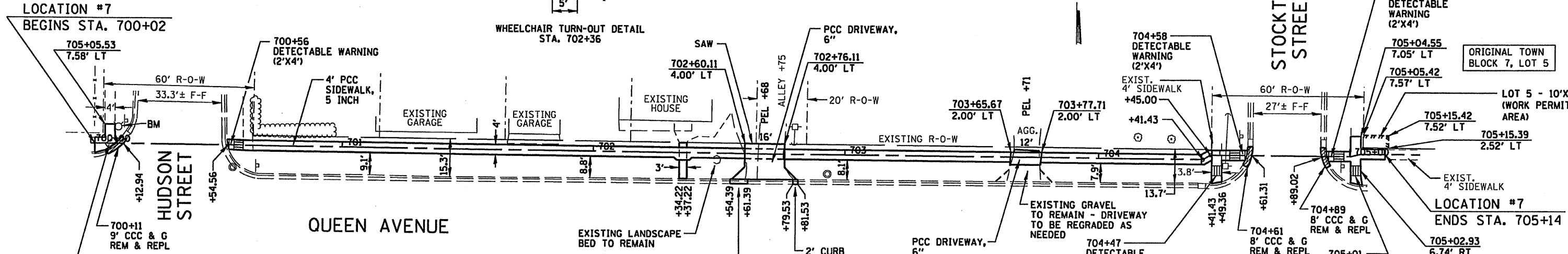

**QUEEN AVENUE**

STATION	ELEV	GRADE	STATION	ELEV	GRADE
700+02.00	996.35		703+65.00	985.77	-1.23
700+10.00	995.73	-7.75	704+46.00	985.84	0.09
700+11.00	995.67	-6.00	704+50.00	985.82	-0.50
700+13.00	995.51	-8.00	704+59.00	985.10	-8.00
700+22.00	994.65	-2.21	704+59.50	985.06	-8.00
700+34.00	994.50	-7.50	704+61.31	985.12	3.31
700+45.00	994.45	-5.00	704+89.00	984.96	-0.58
700+55.00	994.88	7.17	704+90.50	984.87	-6.00
701+05.00	994.96	2.00	705+00.00	985.62	7.88
702+36.00	987.73	-4.23	705+04.00	985.70	2.02
702+60.00	987.06	-2.77	705+14.00	986.16	4.63

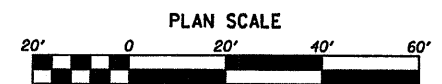

DATE	
BY	
REVISIONS	
NO.	
DATE	
BY	
REVISIONS	
NO.	
DATE	
BY	
REVISIONS	
NO.	

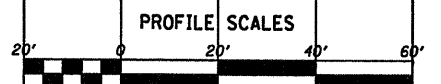
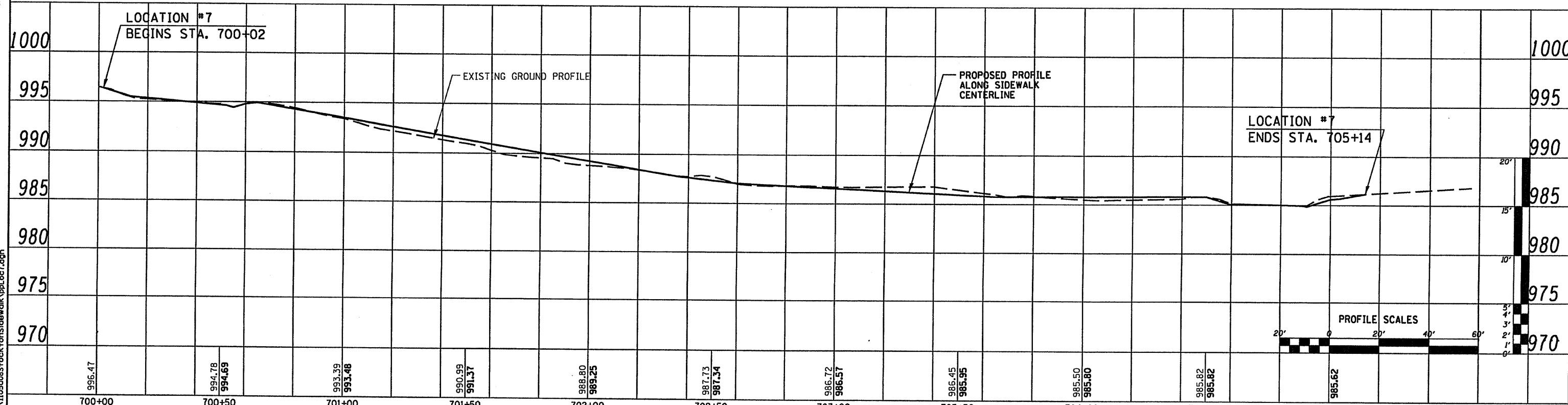

S:\F:\report\1105d085\stockton\sidewalk\pp1.cct.dgn

<p>809 East Second Street, Dixon, IL 61021        Phone 815.294.3381 Fax 815.294.3388        Design Firm # 184-00918        www.willettthofmann.com</p>	USER NAME =	DESIGNED - M.L.W.	REVISED - 6/3/09	<b>STOCKTON, IL.</b> <b>SAFER ROUTES TO SCHOOL PROGRAM</b>	<b>LOCATION #7 - QUEEN AVENUE</b> <b>PLAN AND PROFILE</b>	F.A. RTE.	SECTION	COUNTY	TOTAL SHEETS	SHEET NO.
	PLOT SCALE =	DRAWN - D.L.B.	REVISED -			08-00033-00-SW	JO DAVIESS	20	10	
	PLOT DATE =	CHECKED - J.L.H.	REVISED -			STA. 700+02 TO STA. 705+14	CONTRACT	85457		
		DATE - 3/18/09	REVISED -			FED. ROAD DIST. NO. -	ILLINOIS	FED. AID PROJECT		

FINAL SURVEY	SURVEYED	BY	DATE
NOTE BOOK	PLOTTED		
AREAS CHECKED	TEMPLATE		
	AREAS CHECKED		

ORIGINAL SURVEY	SURVEYED	BY	DATE
NOTE BOOK	PLOTTED		
AREAS CHECKED	TEMPLATE		
	AREAS CHECKED		

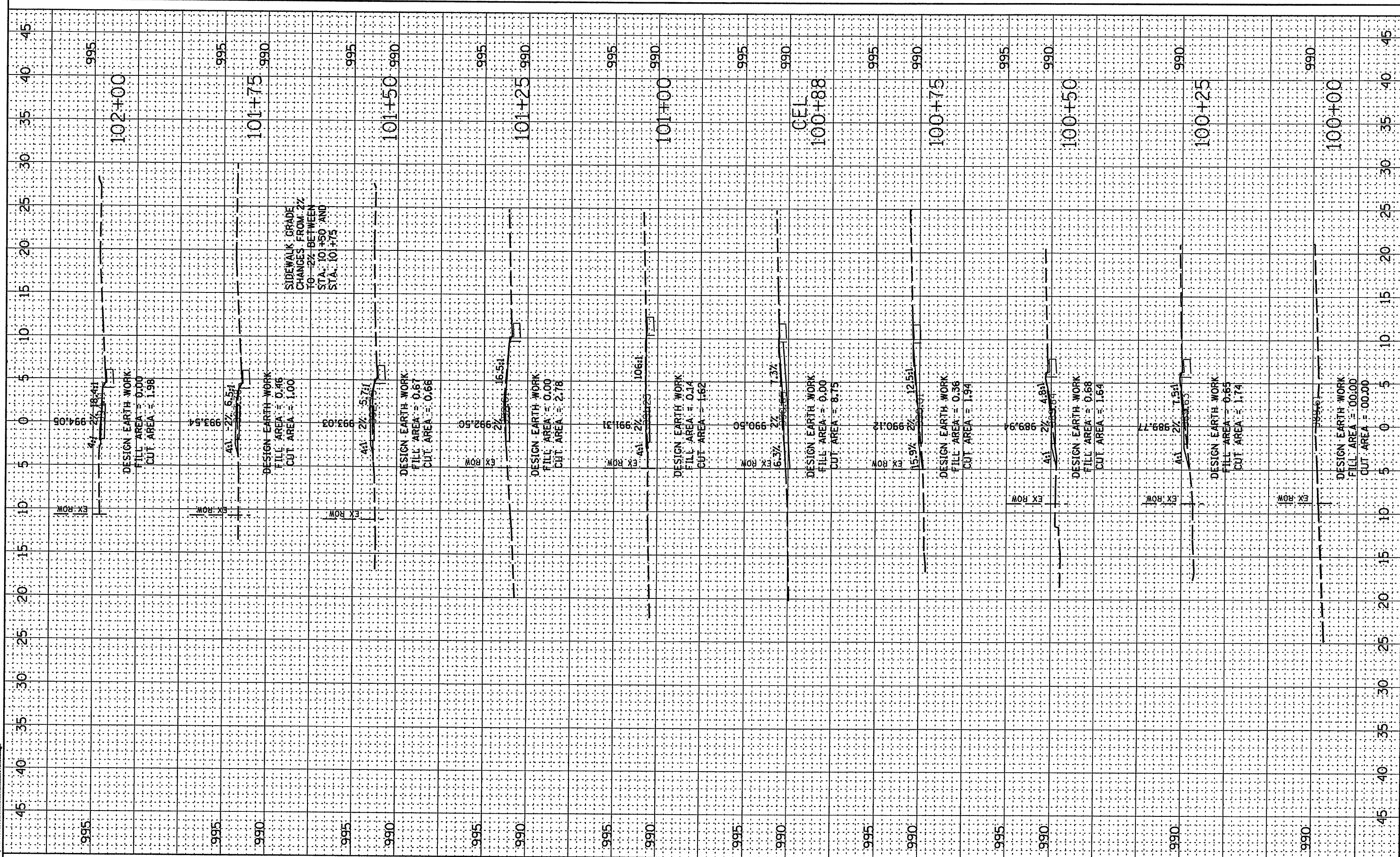

**WILLET, HOFMANN & ASSOCIATES, INC.**  
 CONSULTING ENGINEERS  
 809 East Second Street Dixon, IL 61021  
 Phone 815-234-3391 Fax 815-234-3395  
 Design Firm # 184-00318  
 www.willett-hofmann.com

USER NAME =	DESIGNED - M.L.W.	REVISED - 6/3/09
PLOT SCALE =	DRAWN - D.L.B.	REVISED -
PLOT DATE =	CHECKED - J.L.H.	REVISED -
	DATE - 3/16/09	REVISED -

**STOCKTON, IL**  
**SAFER ROUTES TO SCHOOL PROGRAM**

**LOCATION #1 - SUMMIT AVENUE (WEST)**  
**CROSS SECTIONS**

F.A. RTE.	SECTION	COUNTY	TOTAL SHEETS	SHEET NO.
	08-00033-00-SW	Jo Davless	20	11
STA. 100+00	TO STA. 102+00	CONTRACT NO. 85459		
FED. ROAD DIST. NO. - ILLINOIS FED. AID PROJECT				

FINAL SURVEY	SURVEYED	BY	DATE
NOTE BOOK	PLOTTED		
NO.	TEMPLATE		
	AREAS CHECKED		

ORIGINAL SURVEY	SURVEYED	BY	DATE
NOTE BOOK	PLOTTED		
NO.	TEMPLATE		
	AREAS CHECKED		

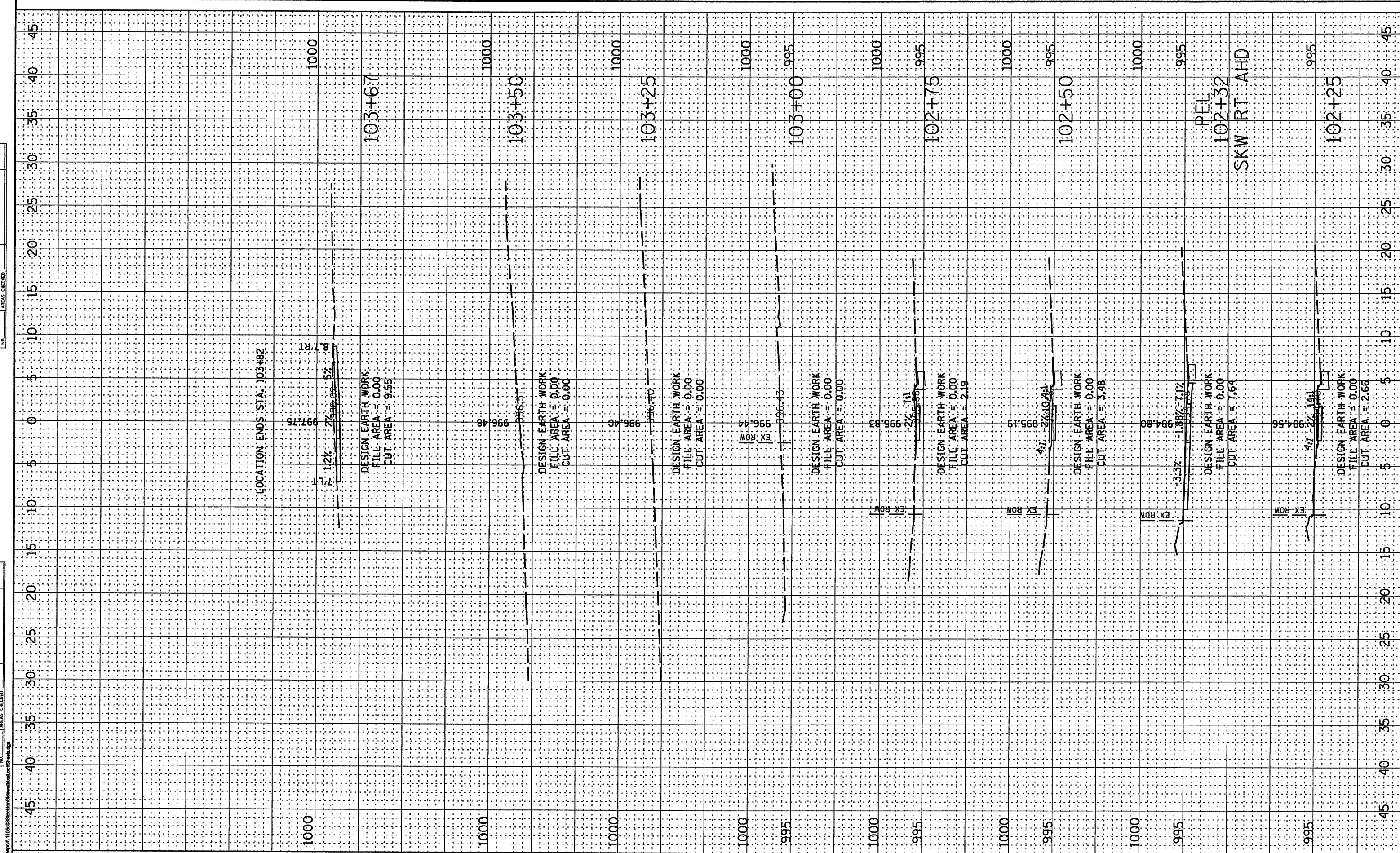

**WILLET, HOFMANN & ASSOCIATES, INC.**  
 CONSULTING ENGINEERS  
 809 East Second Street Dixon, IL 61021  
 Phone 815-284-5361 Fax 815-284-3386  
 Design Firm # 194-00918  
 www.willettthofmann.com

USER NAME *	DESIGNED - M.L.W.	REVISED - 6/3/09
PLOT SCALE *	DRAWN - D.L.B.	REVISED -
PLOT DATE *	CHECKED - J.L.H.	REVISED -
	DATE - 3/16/09	REVISED -

**STOCKTON, IL**  
**SAFER ROUTES TO SCHOOL PROGRAM**

**LOCATION #1 - SUMMIT AVENUE (WEST)**  
**CROSS SECTIONS**

F.A. RTE.	SECTION	COUNTY	TOTAL SHEETS	SHEET NO.
	08-00033-00-SW	Jo Davless	20	12
STA. 102+25 TO STA. 103+50		CONTRACT NO. 85459		
FED. ROAD DIST. NO. ILLINOIS FED. AID PROJECT				

FINAL SURVEY  
NOTE BOOK  
NO. \_\_\_\_\_  
DATE \_\_\_\_\_

ORIGINAL SURVEY  
NOTE BOOK  
NO. \_\_\_\_\_  
DATE \_\_\_\_\_

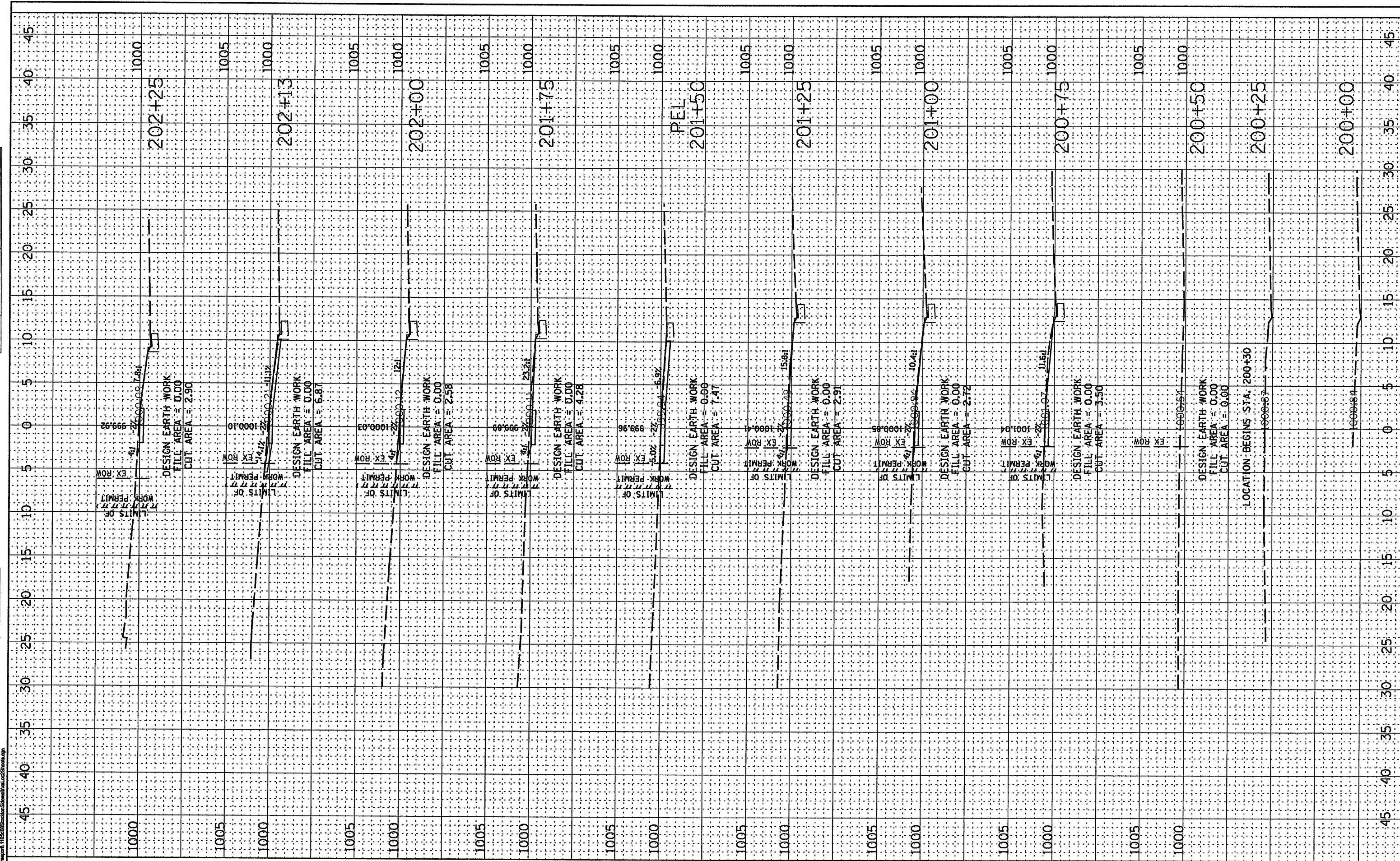

**WILLET, HOFMANN & ASSOCIATES, INC.**  
CONSULTING ENGINEERS  
809 East Second Street Dixon, IL 61021  
Phone 815.284.3381 Fax 815.284.3385  
Design Firm 815-284-00918  
www.willett-hofmann.com

USER NAME =	DESIGNED - M.L.W.	REVISED - 6/3/09
PLOT SCALE =	DRAWN - D.L.B.	REVISED -
PLOT DATE =	CHECKED - J.L.H.	REVISED -
	DATE - 3/16/09	REVISED -

**STOCKTON, IL.**  
**SAFER ROUTES TO SCHOOL PROGRAM**

**LOCATION #2 - SUMMIT AVENUE (EAST)**  
**CROSS SECTIONS**

F.A. RTE.	SECTION	COUNTY	TOTAL SHEETS	SHEET NO.
	08-00033-00-SW	Jo Daviess	20	13
STA. 200+00	TO STA. 202+25	CONTRACT NO. 85459		
FED. ROAD DIST. NO. ILLINOIS FED. AID PROJECT				

FINAL SURVEY	SURVEYED	DATE
NOTE BOOK	PLOTTED	BY
AREAS CHECKED	AREAS	
NO.		

ORIGINAL SURVEY	SURVEYED	DATE
NOTE BOOK	PLOTTED	BY
AREAS CHECKED	AREAS	
NO.		

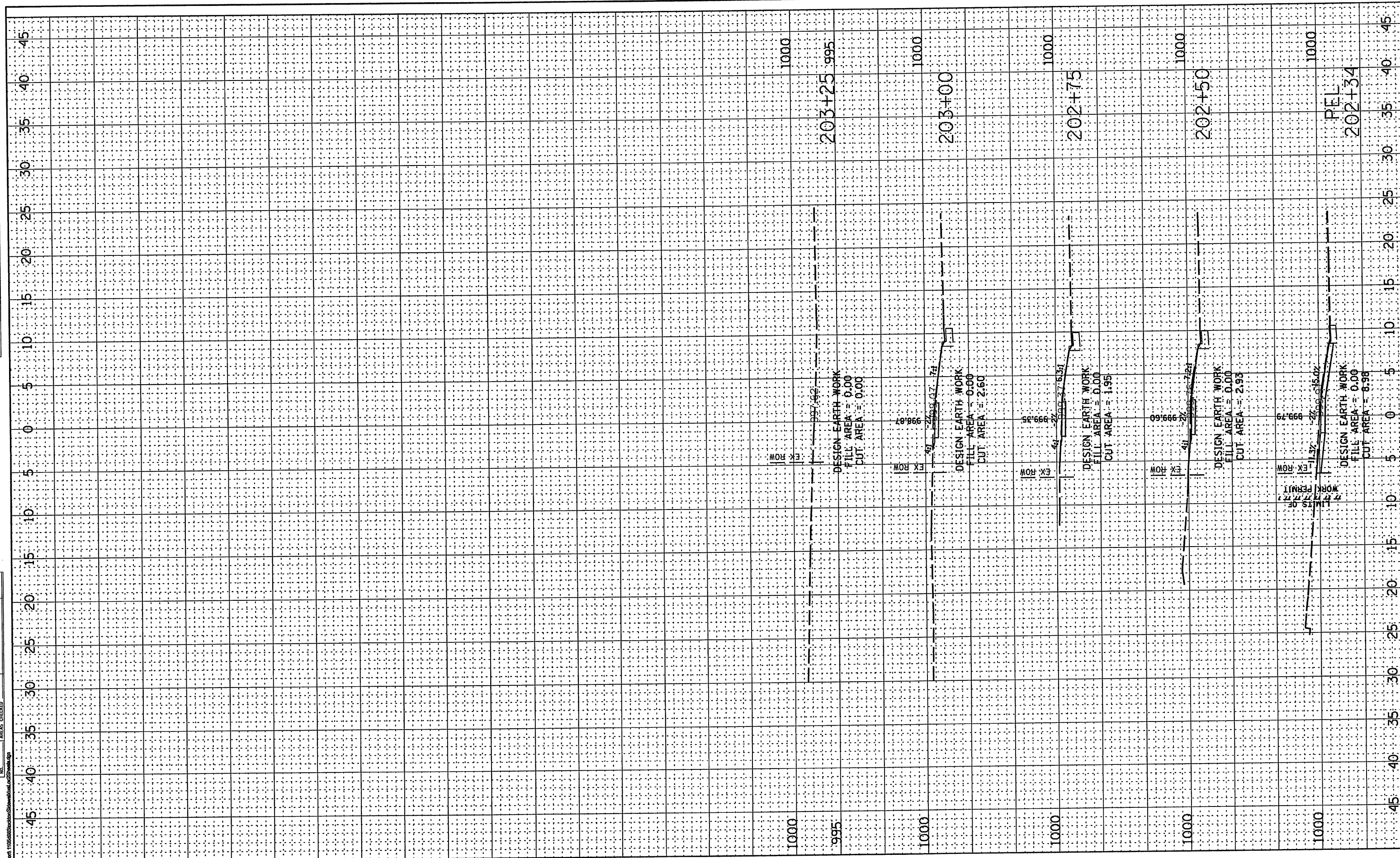

**WILLET, HOFMANN & ASSOCIATES, INC.**  
**CONSULTING ENGINEERS**  
 809 East Second Street Dixon, IL 61021  
 Phone 815.284.3381 Fax 815.284.3385  
 Design Firm # 184-00818  
 www.willettthofmann.com

USER NAME =	DESIGNED - M.L.W.	REVISED - 6/3/09
PLOT SCALE =	DRAWN - D.L.B.	REVISED -
PLOT DATE =	CHECKED - J.L.H.	REVISED -
	DATE - 3/16/09	REVISED -

**STOCKTON, IL.**  
**SAFER ROUTES TO SCHOOL PROGRAM**

**LOCATION #2 - SUMMIT AVENUE (EAST)**  
**CROSS SECTIONS**

F.A. RTE.	SECTION	COUNTY	TOTAL SHEETS	SHEET NO.
	08-00033-00-SW	Jo Davless	20	14
STA. 202+34	TO STA. 204+50	CONTRACT NO. 85459		
FED. ROAD DIST. NO. - ILLINOIS FED. AID PROJECT				

FINAL SURVEY	SURVEYED	BY	DATE
NOTE BOOK	PLOTTED		
NO.	TEMPLATE		
	AREAS		
	CHECKED		

ORIGINAL SURVEY	SURVEYED	BY	DATE
NOTE BOOK	PLOTTED		
NO.	TEMPLATE		
	AREAS		
	CHECKED		

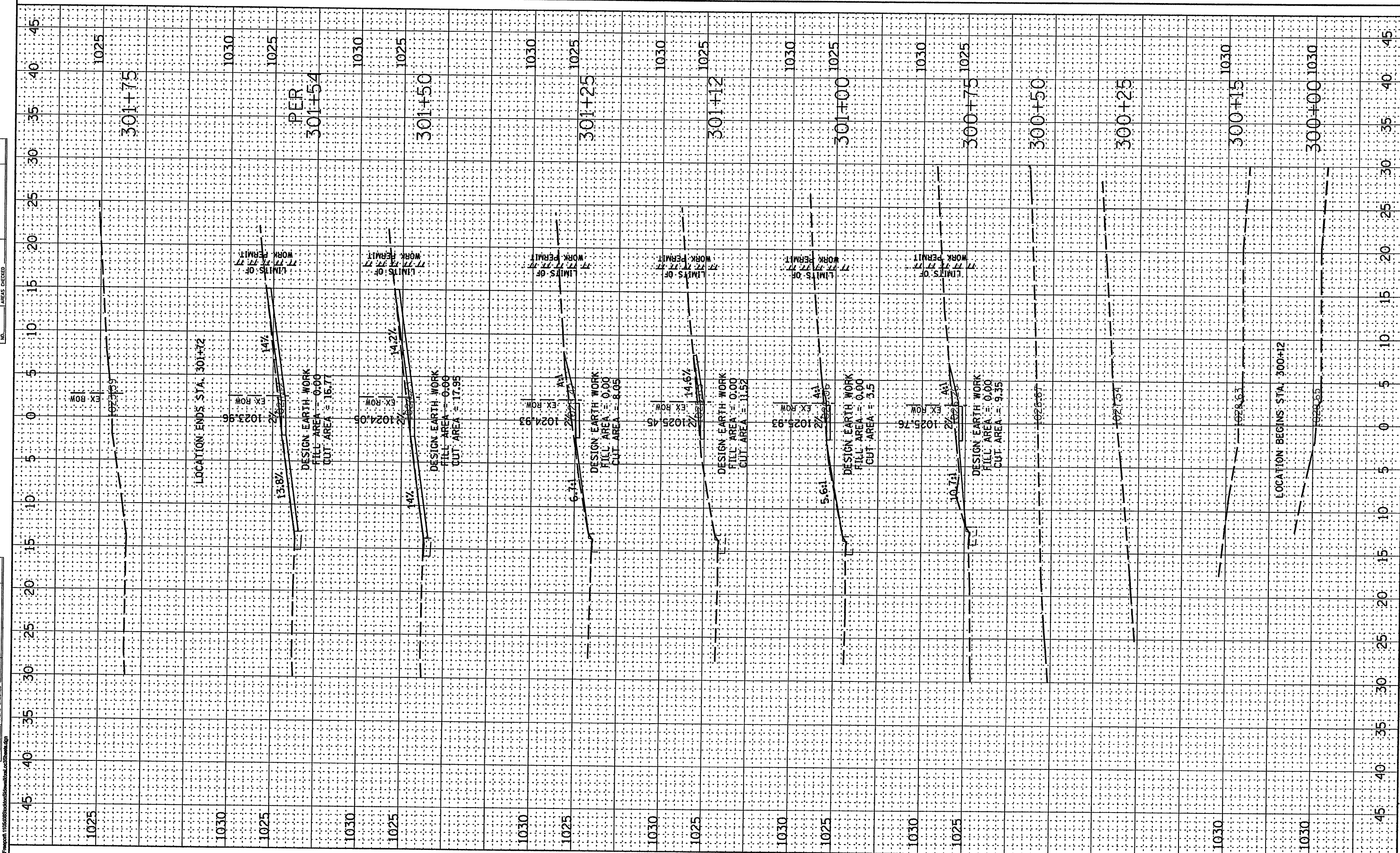

**WILLET, HOFMANN & ASSOCIATES, INC.**  
**CONSULTING ENGINEERS**  
 809 East Second Street Dixon, IL 61021  
 Phone 815.294.3381 Fax 815.294.3385  
 Design Firm 184-00918  
 www.willett-hofmann.com

USER NAME =	DESIGNED - M.L.W.	REVISED - 6/3/09
PLOT SCALE =	DRAWN - D.L.B.	REVISED -
PLOT DATE =	CHECKED - J.L.H.	REVISED -
	DATE - 3/16/09	REVISED -

**STOCKTON, IL.**  
**SAFER ROUTES TO SCHOOL PROGRAM**

**LOCATION #3 - MAPLE AVENUE (SOUTH)**  
**CROSS SECTIONS**

F.A. RTE.	SECTION	COUNTY	TOTAL SHEETS	SHEET NO.
	08-00033-00-SW	Jo Daviess	20	15
STA. 300+00 TO STA. 301+75	CONTRACT NO. 85459			
FED. ROAD DIST. NO. - ILLINOIS FED. AID PROJECT				

FINAL SURVEY	BY	DATE
SURVEYED		
PLOTTED		
TEMPLATE		
AREAS CHECKED		
NO.		

ORIGINAL SURVEY	BY	DATE
SURVEYED		
PLOTTED		
TEMPLATE		
AREAS CHECKED		
NO.		

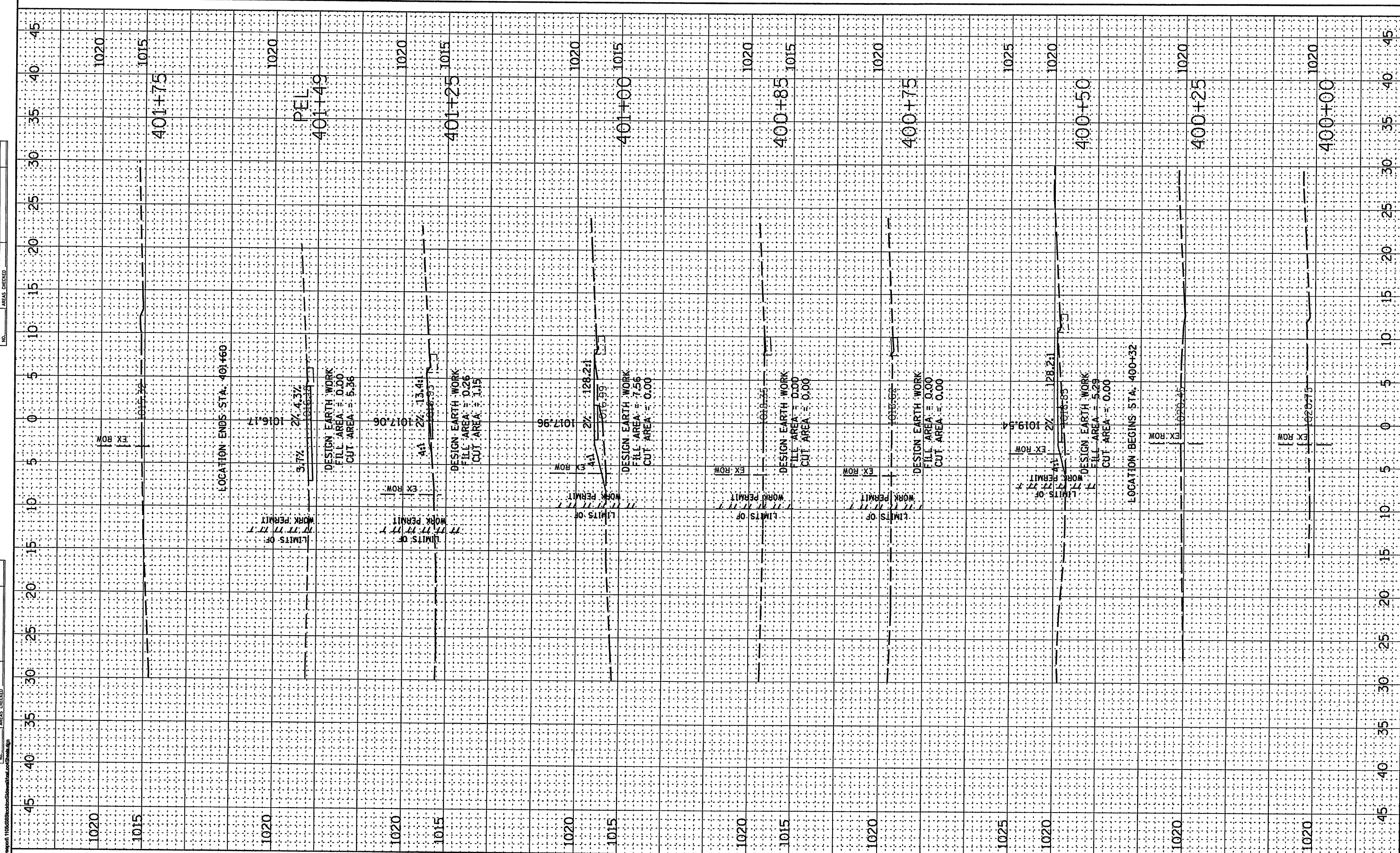

**WILLET, HOFMANN & ASSOCIATES, INC.**  
**CONSULTING ENGINEERS**  
 809 East Second Street, Dixon, IL 61021  
 Phone: 815-284-3301 Fax: 815-284-3309  
 Design Firm # 184-00918  
 www.willettthofmann.com

USER NAME =	DESIGNED - M.L.W.	REVISED - 6/3/09
PLOT SCALE =	DRAWN - D.L.B.	REVISED -
PLOT DATE =	CHECKED - J.L.H.	REVISED -
	DATE - 3/16/09	REVISED -

**STOCKTON, IL**  
**SAFER ROUTES TO SCHOOL PROGRAM**

**LOCATION #4 - MAPLE AVENUE (NORTH)**  
**CROSS SECTIONS**

F.A. RTE.	SECTION	COUNTY	TOTAL SHEETS	SHEET NO.
	08-00033-00-SW	Jo Daviess	20	16
STA. 400+00 TO STA. 401+75		CONTRACT NO. 85459		
FED. ROAD DIST. NO. - ILLINOIS FED. AID PROJECT				



FINAL SURVEY	SURVEYED	BY	DATE
NOTE BOOK	PLOTTED		
NO.	AREAS CHECKED		

ORIGINAL SURVEY	SURVEYED	BY	DATE
NOTE BOOK	PLOTTED		
NO.	AREAS CHECKED		

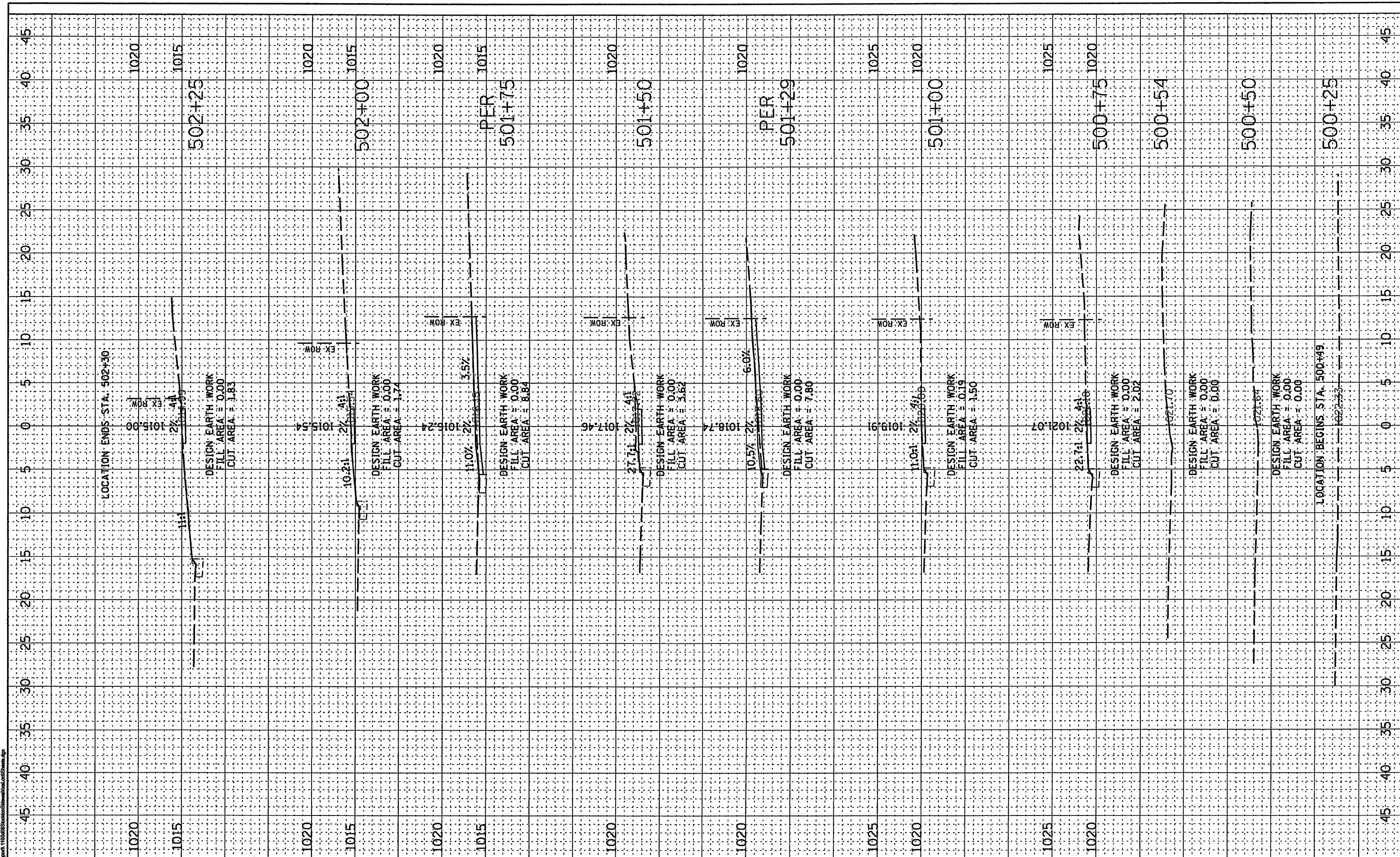

**WILLET, HOFMANN & ASSOCIATES, INC.**  
**CONSULTING ENGINEERS**  
 808 East Second Street Dixon, IL 61021  
 Phone 815.284.3381 Fax 815.284.3385  
 Design Firm # 194-00918  
 www.willett-hofmann.com

USER NAME =	DESIGNED - M.L.W.	REVISED - 6/3/09
PLOT SCALE =	DRAWN - D.L.B.	REVISED -
PLOT DATE =	CHECKED - J.L.H.	REVISED -
	DATE - 3/16/09	REVISED -

**STOCKTON, IL**  
**SAFER ROUTES TO SCHOOL PROGRAM**

**LOCATION #5 - HIGH AVENUE**  
**CROSS SECTIONS**

F.A. RTE.	SECTION	COUNTY	TOTAL SHEETS	SHEET NO.
	08-00033-00-SW	Jo Davless	20	17
STA. 500+25 TO STA. 502+25		CONTRACT NO. 85459		
FED. ROAD DIST. NO. [ILLINOIS] FED. AID PROJECT				

FINAL SURVEY	SURVEYED	BY	DATE
NOTE BOOK	PLOTTED		
NO.	TEMPLATE		
	AREAS CHECKED		

ORIGINAL SURVEY	SURVEYED	BY	DATE
NOTE BOOK	PLOTTED		
NO.	TEMPLATE		
	AREAS CHECKED		

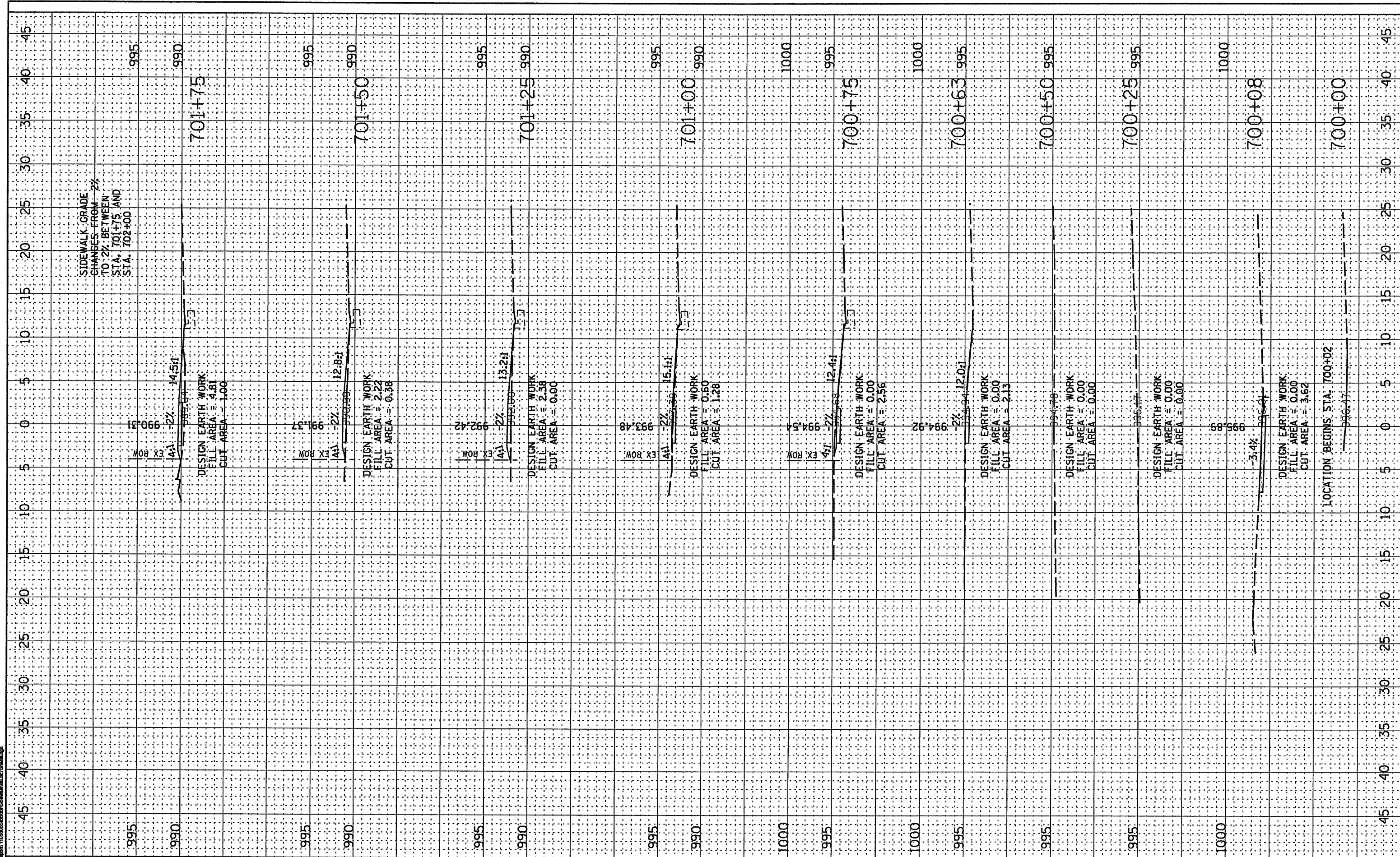

**WILLET, HOFMANN & ASSOCIATES, INC.**  
 CONSULTING ENGINEERS  
 809 East Second Street, Dixon, IL 61021  
 Phone 815.294.3381 Fax 815.294.3385  
 Design Firm 184-0018  
 www.willett-hofmann.com

USER NAME =	DESIGNED - M.L.W.	REVISED - 6/3/09
PLOT SCALE =	DRAWN - D.L.B.	REVISED -
PLOT DATE =	CHECKED - J.L.H.	REVISED -
	DATE - 3/16/09	REVISED -

**STOCKTON, IL.**  
**SAFER ROUTES TO SCHOOL PROGRAM**

**LOCATION #7 - QUEEN AVENUE**  
**CROSS SECTIONS**

F.A. RTE.	SECTION	COUNTY	TOTAL SHEETS	SHEET NO.
	08-00033-00-SW	Jo Davless	20	18
STA. 700+00 TO STA. 701+75			CONTRACT NO. 85459	
FED. ROAD DIST. NO. - ILLINOIS FED. AID PROJECT				

FINAL SURVEY PLOTTED NOTE BOOK NO. BY DATE

ORIGINAL SURVEY PLOTTED NOTE BOOK NO. BY DATE

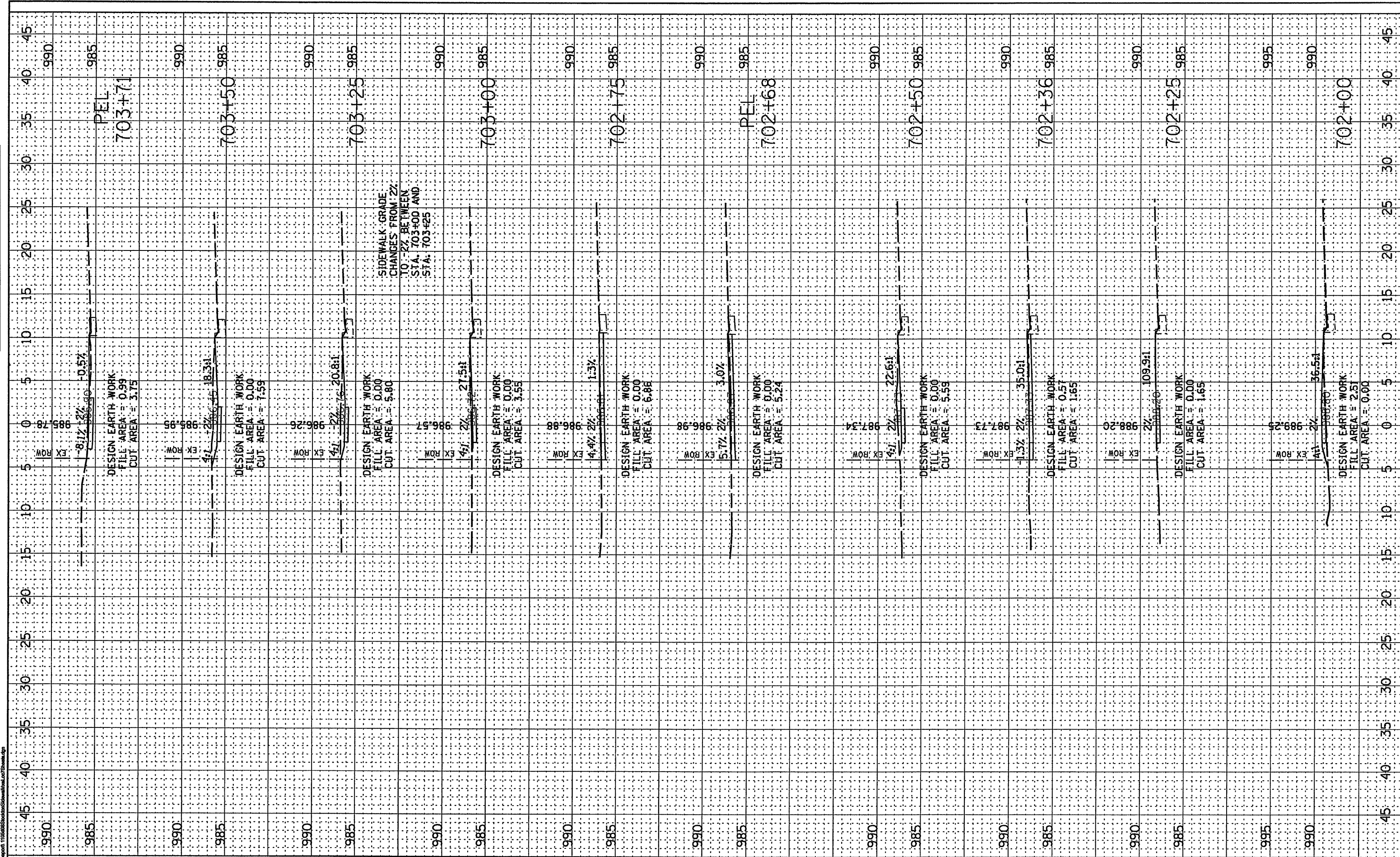

**WILLET, HOFMANN & ASSOCIATES, INC.**  
 CONSULTING ENGINEERS  
 809 East Second Street Dixon, IL 61021  
 Phone 815.284.3381 Fax 815.284.3385  
 Design Firm # 184-0018  
 www.willett-hofmann.com

USER NAME =	DESIGNED - M.L.W.	REVISED - 6/3/09
PLOT SCALE =	DRAWN - D.L.B.	REVISED -
PLOT DATE =	CHECKED - J.L.H.	REVISED -
	DATE - 3/16/09	REVISED -

**STOCKTON, IL.**  
**SAFER ROUTES TO SCHOOL PROGRAM**

**LOCATION #7 - QUEEN AVENUE**  
**CROSS SECTIONS**

F.A. RTE.	SECTION	COUNTY	TOTAL SHEETS	SHEET NO.
	08-00033-00-SW	Jo Daviess	20	19
STA. 702+00 TO STA. 703+75		CONTRACT NO. 85459		
FED. ROAD DIST. NO. ILLINOIS FED. AID PROJECT				

FINAL SURVEY	SURVEYED	BY	DATE
NOTE BOOK	PLOTTED		
AREAS CHECKED	AREAS CHECKED		

ORIGINAL SURVEY	SURVEYED	BY	DATE
NOTE BOOK	PLOTTED		
AREAS CHECKED	AREAS CHECKED		

FILE NAME = s:\fwork\1006003\Stockton\Stockton.dwg

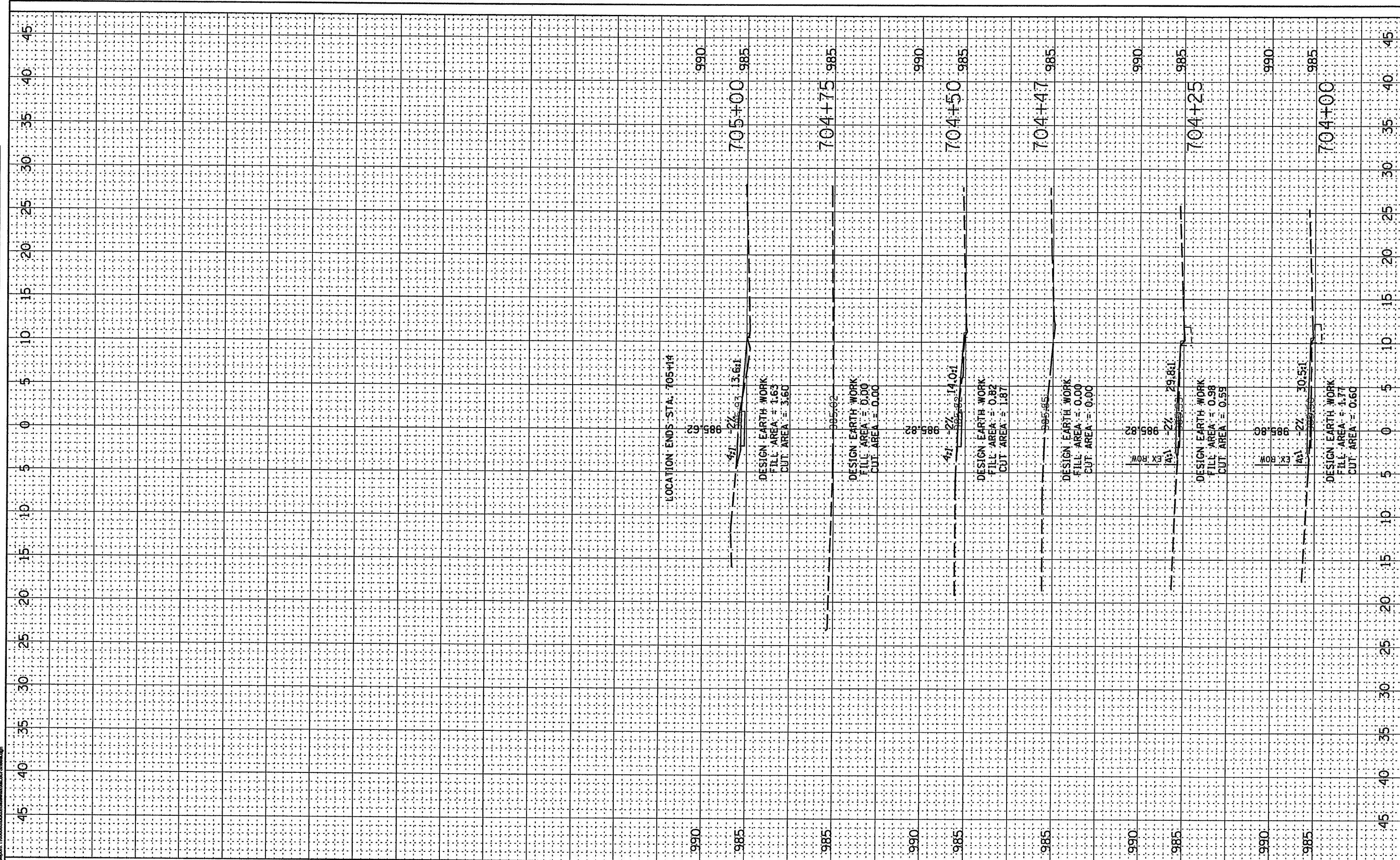

**WILLET, HOFMANN & ASSOCIATES, INC.**  
 CONSULTING ENGINEERS  
 809 East Second Street Dixon, IL 61021  
 Phone 815-294-5381 Fax 815-294-5385  
 Design Firm # 184-00918  
 www.willett-hofmann.com

USER NAME =	DESIGNED - M.L.W.	REVISED - 6/3/09
PLOT SCALE =	DRAWN - D.L.B.	REVISED -
PLOT DATE =	CHECKED - J.L.H.	REVISED -
	DATE - 3/16/09	REVISED -

**STOCKTON, IL.**  
**SAFER ROUTES TO SCHOOL PROGRAM**

**LOCATION #7 - QUEEN AVENUE**  
**CROSS SECTIONS**

F.A. RTE.	SECTION	COUNTY	TOTAL SHEETS	SHEET NO.
	08-00033-00-SW	Jo Daviess	20	20
STA. 704+00 TO STA. 705+00	CONTRACT NO. 85459			
FED. ROAD DIST. NO. - ILLINOIS FED. AID PROJECT				