



# Illinois Department of Transportation

2300 South Dirksen Parkway / Springfield, Illinois / 62764

September 9, 2009

SUBJECT: Various Routes  
Project ARA-5024(026)  
Section 09-00148-00-RS (Freeport)  
Stephenson County  
Contract No. 85470  
Item 77  
September 18, 2009 Letting  
Addendum (A)

TO PROSPECTIVE BIDDERS:

Due to clarify information necessary to revise the following:

**Fold Up Plans – Revised page 1**  
**Added pages 36a, 36b, 37a, 37b & 37c**  
**Deleted pages 36 & 37**

Prime contractors must utilize the enclosed material when preparing their bid and must include any Schedule of Prices changes in their bidding proposal.

Bidders using computer-generated bids are cautioned to reflect any and all Schedule of Prices changes, if involved, into their computer programs.

Very truly yours,

Charles Ingersoll  
Engineer of Design and Environment

A handwritten signature in cursive script, reading "Ted B. Walschleger" followed by "P.E." to the right.

By: Ted B. Walschleger  
Engineer of Project Development  
and Implementation

**STATE OF ILLINOIS  
DEPARTMENT OF TRANSPORTATION  
PLANS FOR  
PROPOSED LOCAL AGENCY PAVEMENT PRESERVATION  
(LAPP)**

**FEDERAL AID URBAN PROJECT  
F.A.U. ROUTE 5240 (EMPIRE ST), F.A.U. ROUTE 5253 (MCKINLEY AV)  
F.A.U. ROUTE 5260 (CARROLL AV)  
SECTION 09-00148-00-RS  
PROJECT ARA-5024 (026)  
CITY OF FREEPORT**

NET LENGTH OF SECTION= 9486' = 1.797 MILES

<u>INDEX OF SHEETS</u>	
COVER SHEET	1
SUMMARY OF QUANTITIES	2
SCHEDULE OF QUANTITIES	3-9
TYPICAL SECTIONS	10-12
INTERSECTION IMPROVEMENTS	13-30
WATER VALVE ADJUST DETAIL	31
MANHOLE ADJUST DETAILS	32
TYPICAL BUTT JOINT	33
SIGN DETAIL	34
"T" INTERSECTION TRAFFIC CNTRL	35
EMPIRE @ WEST AV TRAFFIC CNTRL	36a-36b
CARROLL @ GALENA TRAFFIC CNTRL	37a-37c
STANDARDS	
442201-03	38
606001-04	39-40
701006-03	41
701306-02	42
701331-03	43
701501-05	44
701502-03	45-46
701801-04	47
701901-01	48-50
720011-01	51
728001-01	52
729001-01	53
780001-02	54-55

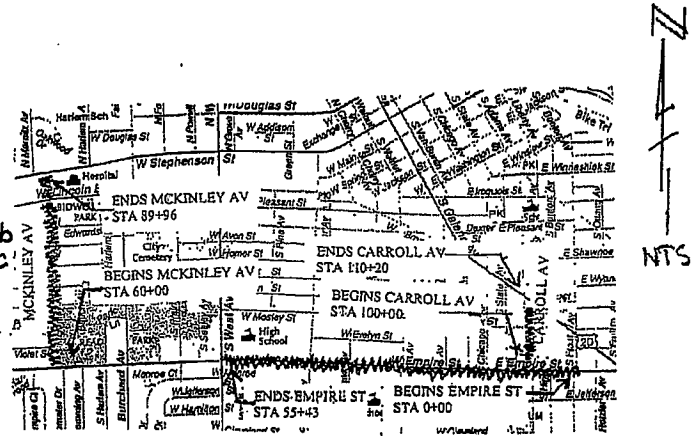

**CALL J.ULLIE  
BEFORE YOU DIG  
(800) 892-0123**

**LOCATION MAP  
Empire St, McKinley Av, Carroll Av**

APPROVED 6/18 2009

LOCAL AGENCY OFFICIAL

PASSED JUL 23 2009

DIST. ENG. OF LOCAL RD & ST

RELEASING JUL 23 2009

FOR BID  
BASED ON LIMITED REVIEW

DEPUTY DIRECTOR OF HIGHWAYS  
REGION 2 ENGINEER

By   
Adam G. Holder



JOB NO. C-92-164-09  
CONTRACT NO. 85470  
URBAN MINOR ARTERIAL  
ADT = VAR. 3950-2650 E-W (2008); 1% TRUCKS: Empire St  
ADT = VAR. 1450-1600 N-S (2008); 1% TRUCKS: McKinley Av  
ADT = 1900 N-S (2008); 1% TRUCKS: Carroll Av

STATE of ILLINOIS  
DEPARTMENT OF TRANSPORTATION

Revised 9-9-08

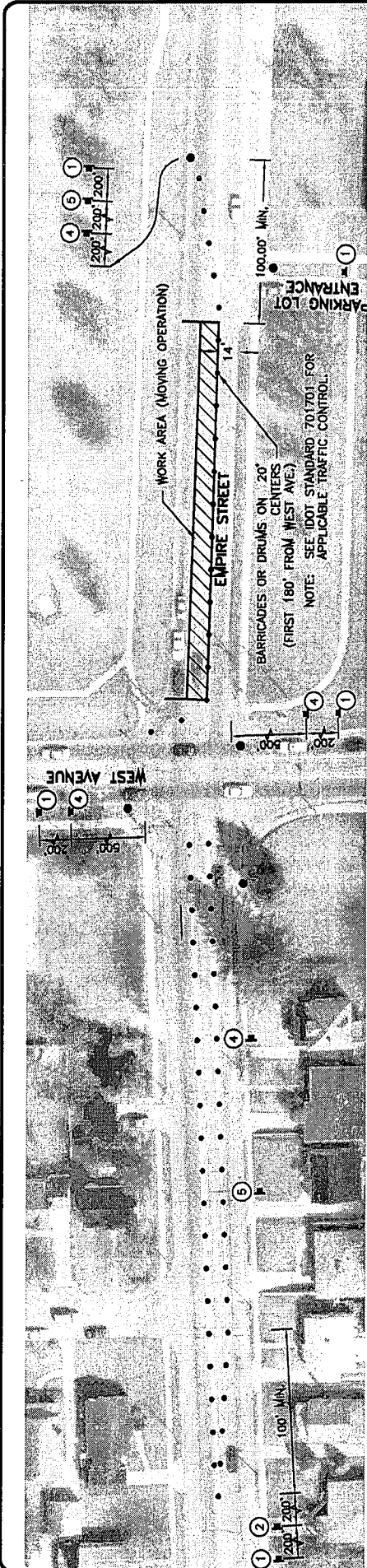

MIDDLE LANE CLOSURE - EMPIRE STREET

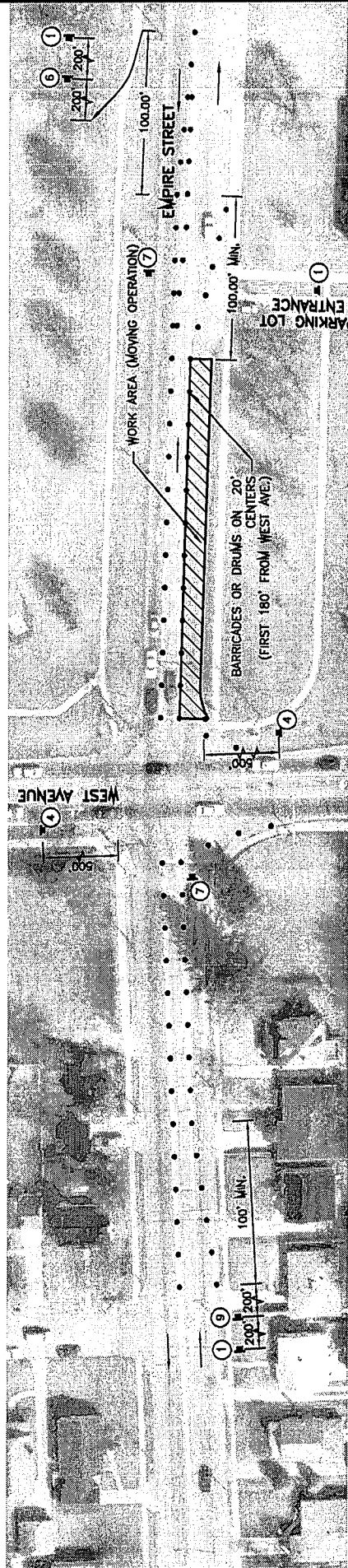

SOUTH LANE CLOSURE - EMPIRE STREET

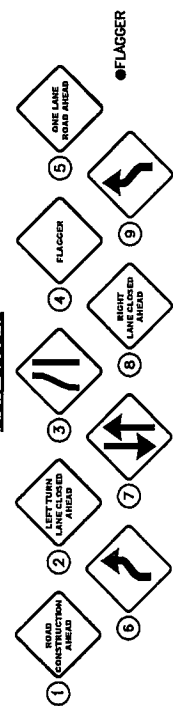

EMPIRE STREET AT WEST AVENUE  
FAU 5240



08/21/09

**FEHR-GRAHAM & ASSOCIATES, LLC**  
ENGINEERING AND SCIENCE CONSULTANTS  
FREEPORT, IL ROCKFORD, IL ROCKFELLE, IL SPRINGFIELD, IL WAUKEGON, WI  
© 2009 FEHR-GRAHAM & ASSOCIATES

Added 9-9-08

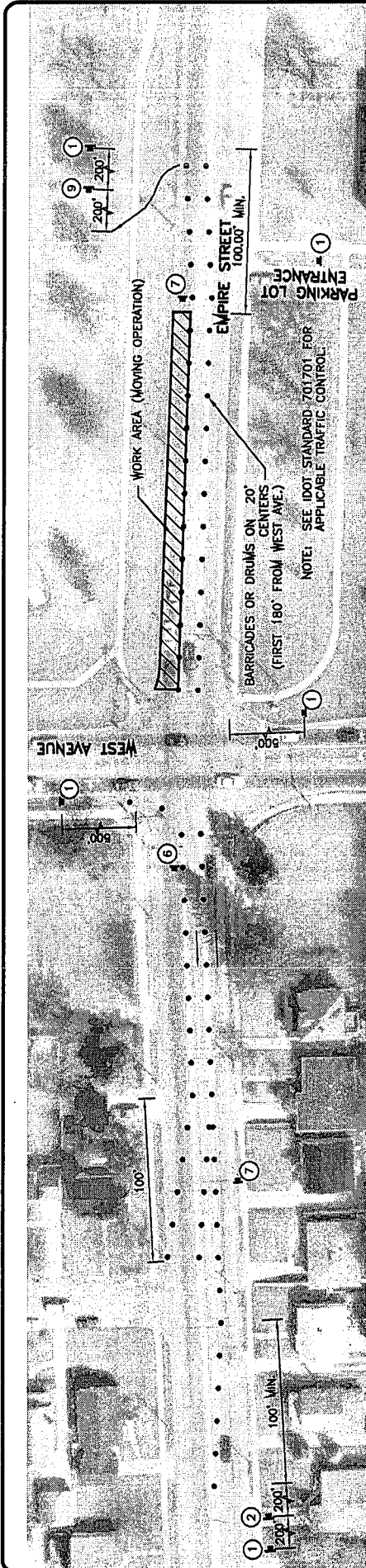

**NORTH LANE CLOSURE - EMPIRE STREET**

**SIGN LEGEND**

- ① ROAD AHEAD CLOSED AHEAD
- ② LEFT TURN LANE CLOSED AHEAD
- ③ RIGHT TURN LANE CLOSED AHEAD
- ④ FLAGGER
- ⑤ ONE LANE ROAD AHEAD
- ⑥ ROAD AHEAD CLOSED
- ⑦ RIGHT LANE CLOSED AHEAD
- ⑧ LEFT LANE CLOSED AHEAD
- ⑨ RIGHT TURN LANE CLOSED AHEAD
- FLAGGER

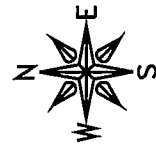

SCALE: 1" = 60'

EMPIRE STREET AT WEST AVENUE  
FAU 5240

08/21/09

**FEHR-GRAHAM & ASSOCIATES, LLC**  
ENGINEERING AND SCIENCE CONSULTANTS  
FREEPORT, IL ROCKFORD, IL SPRINGFIELD, IL WAUKEGON, WI

C:\EGLPT\09\09-286 LAPP\09-286-Bases.dwg, Layout28b

© 2009 FEHR-GRAHAM & ASSOCIATES

Added 9-9-08

NOTE: MAINTAIN SOUTHBOUND TRAFFIC AT ALL TIMES.  
 DURING NON-WORK HOURS, OPEN UP STREET TO 2 WAY TRAFFIC & COVER SIGNAGE.

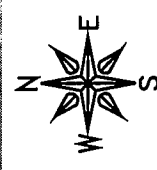
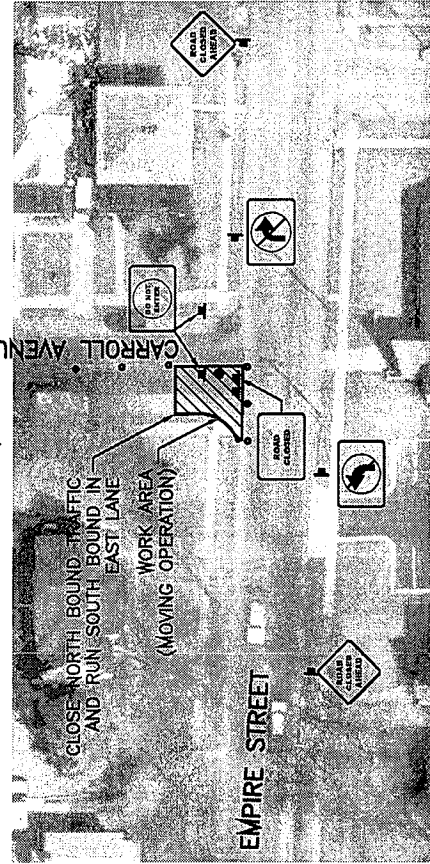
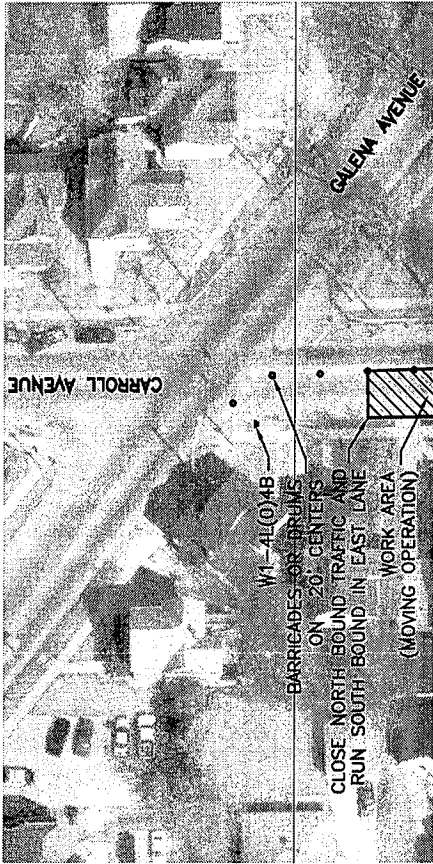

SCALE: 1" = 50'

● FLAGGER

CARROLL AVE & GALENA AVE  
 FAU 5260  
 INTERSECTION IMPROVEMENTS 08/21/09

**FEHR-GRAHAM & ASSOCIATES, LLC**  
 ENGINEERING AND SCIENCE CONSULTANTS  
 FERRISVILLE, PA 15201  
 ROCKEFELLER, L. SPRINGFIELD, L. MORRIS, W.  
 © 2009 FEHR-GRAHAM & ASSOCIATES

c:\EGLP\09\09-288 LAPP\09-288-Bene.dwg, Layout25a

Added 9-9-08

NOTE: MAINTAIN SOUTHBOUND TRAFFIC AT ALL TIMES.  
 DURING NON-WORK HOURS, OPEN UP STREET TO 2 WAY TRAFFIC & COVER SIGNAGE.

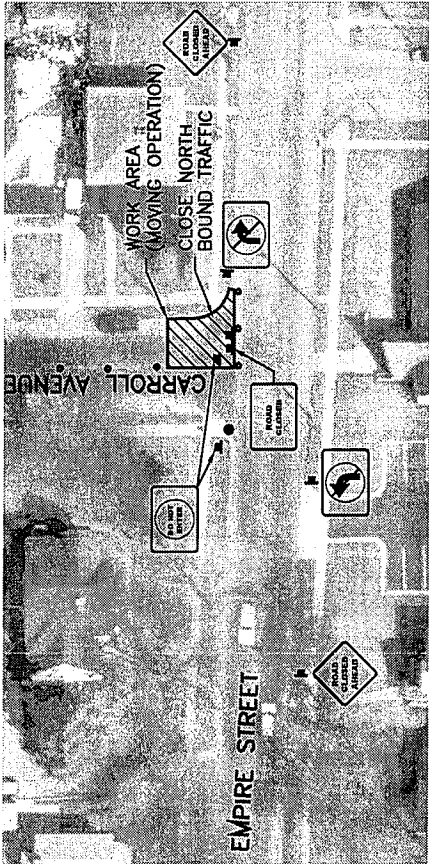
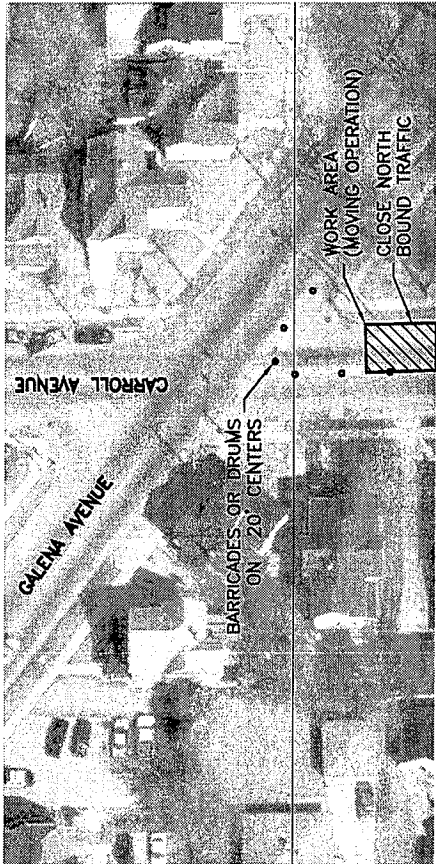

SCALE: 1" = 50'

● FLAGGER

CARROLL AVE & GALENA AVE  
 FAU 5260  
 INTERSECTION IMPROVEMENTS 08/21/09

**FEHR-GRAHAM & ASSOCIATES, LLC**  
 ENGINEERING AND SCIENCE CONSULTANTS  
 FREEPORT, IL ROCKFORD, IL ROCKFELLE, IL SPRINGFIELD, IL WARRE, IN  
 © 2009 FEHR-GRAHAM & ASSOCIATES



Added 9-9-08

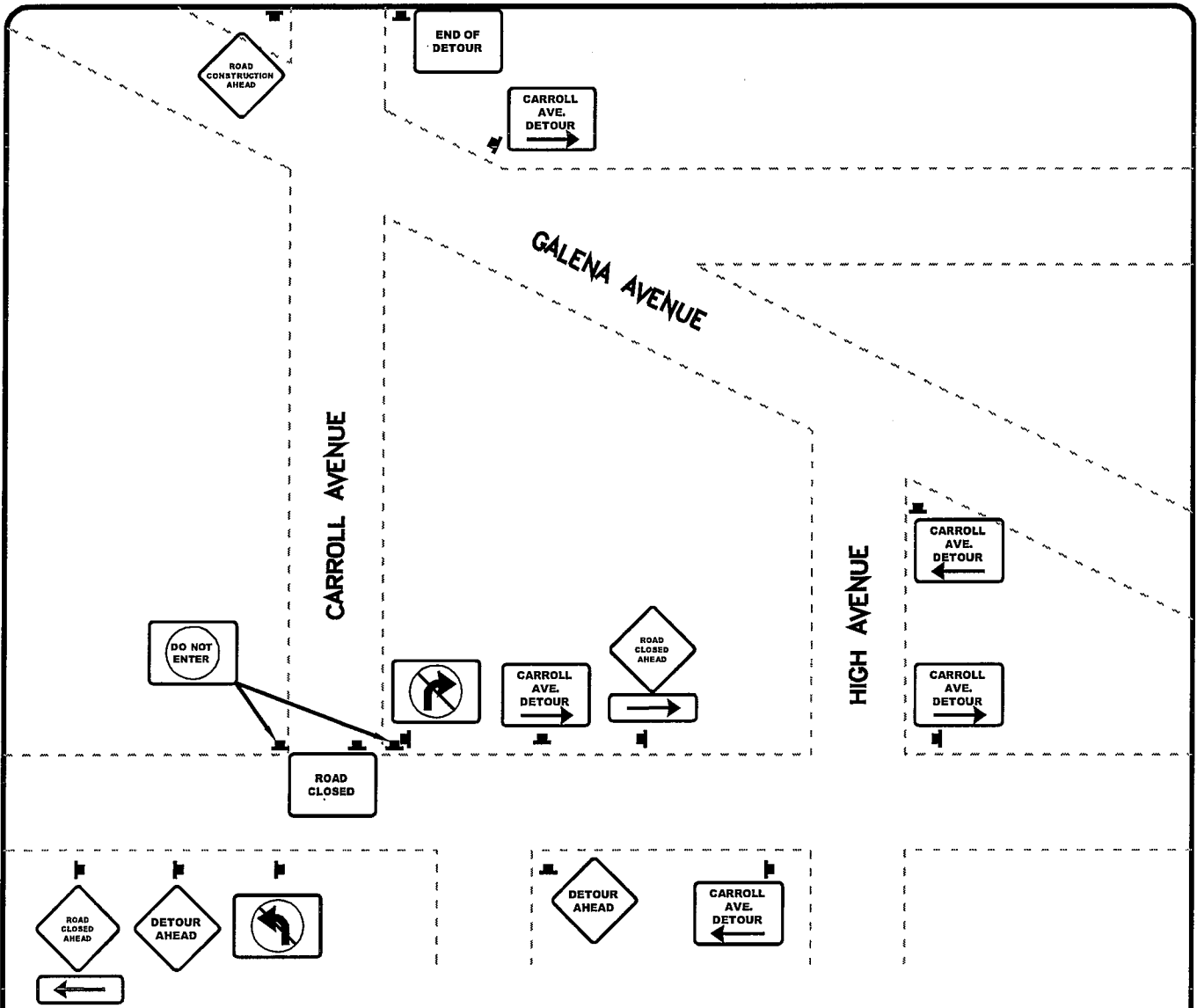

NOTE: SIGNS TO BE COVERED WHEN NO WORK IS BEING DONE ON CARROLL AVENUE.

# CARROLL AVE. DETOUR

## CARROLL & GALENA AVE.

### FAU 5260

## INTERSECTION IMPROVEMENTS

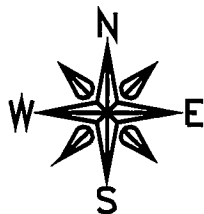

N.T.S.

09/02/09

**FEHR-GRAHAM & ASSOCIATES, LLC**  
 ENGINEERING AND SCIENCE CONSULTANTS  
 FREEPORT, IL ROCKFORD, IL ROCHELLE, IL SPRINGFIELD, IL MONROE, WI  
ILLINOIS DESIGN FIRM NO. 184-003825

*Added 9-9-08*

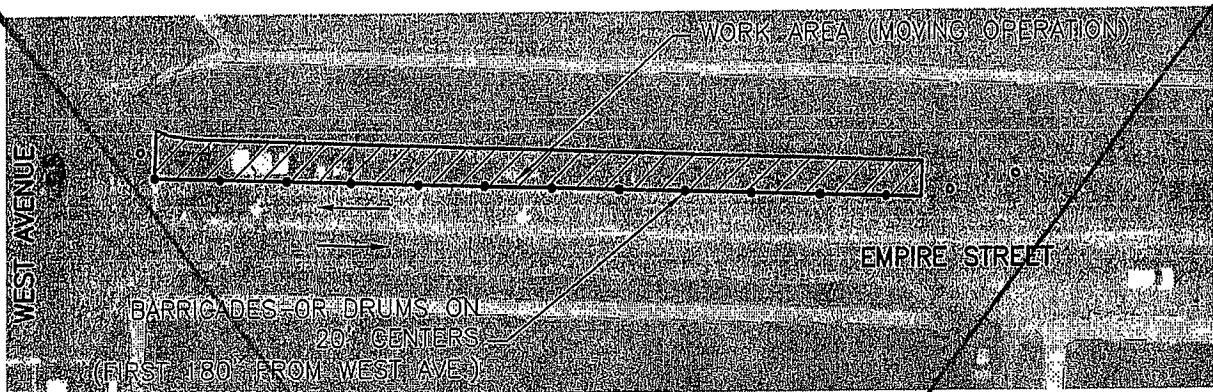

NORTH LANE CLOSURE - EMPIRE STREET

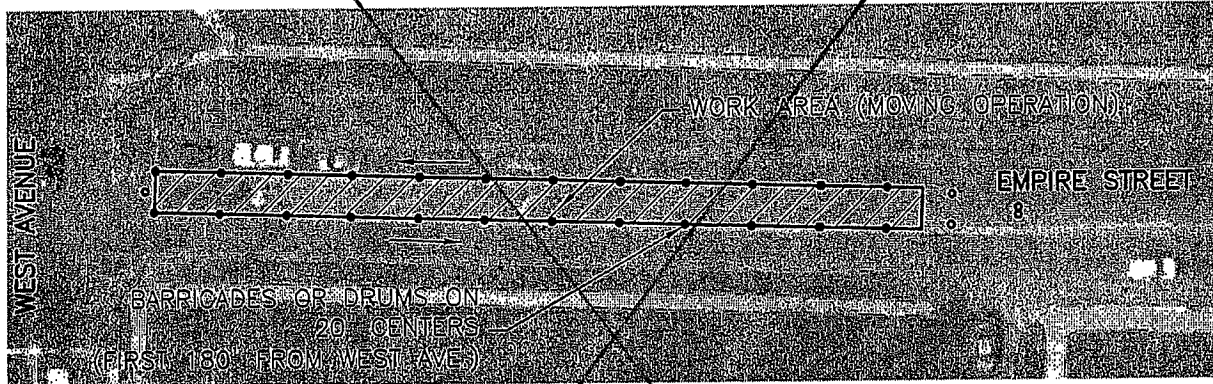

MIDDLE LANE CLOSURE - EMPIRE STREET

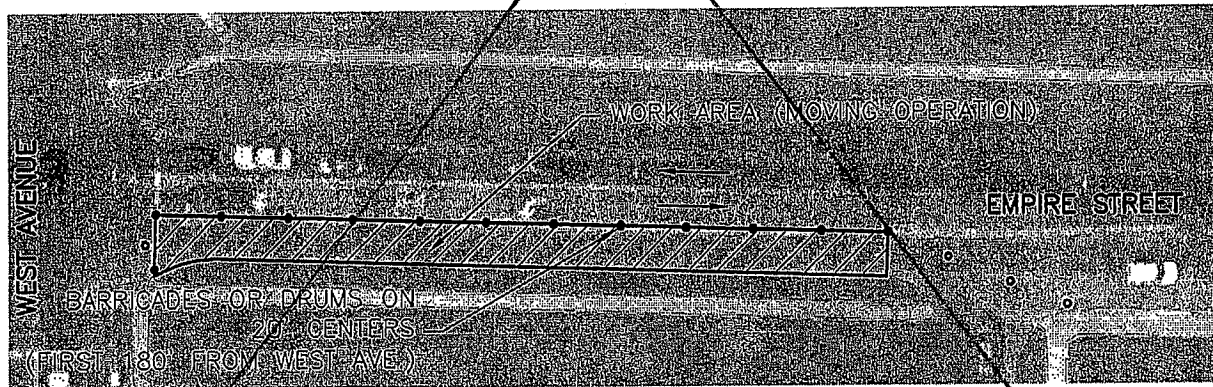

SOUTH LANE CLOSURE - EMPIRE STREET

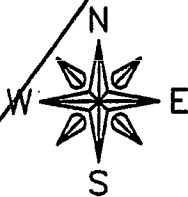

SCALE: 1" = 50'

EMPIRE STREET AT WEST AVENUE  
FAU 5240

7/15/09



**FEHR-GRAHAM & ASSOCIATES, LLC**

ENGINEERING AND SCIENCE CONSULTANTS

FREEPORT, IL ROCKFORD, IL ROCHELLE, IL SPRINGFIELD, IL MONROE, WI  
ILLINOIS DESIGN FIRM NO. 184-003525

© 2009 FEHR-GRAHAM & ASSOCIATES

G:\EGLPT\09\09-286 LAPP\09-286-Base.DWG, Layout26

Deleted 9-9-09



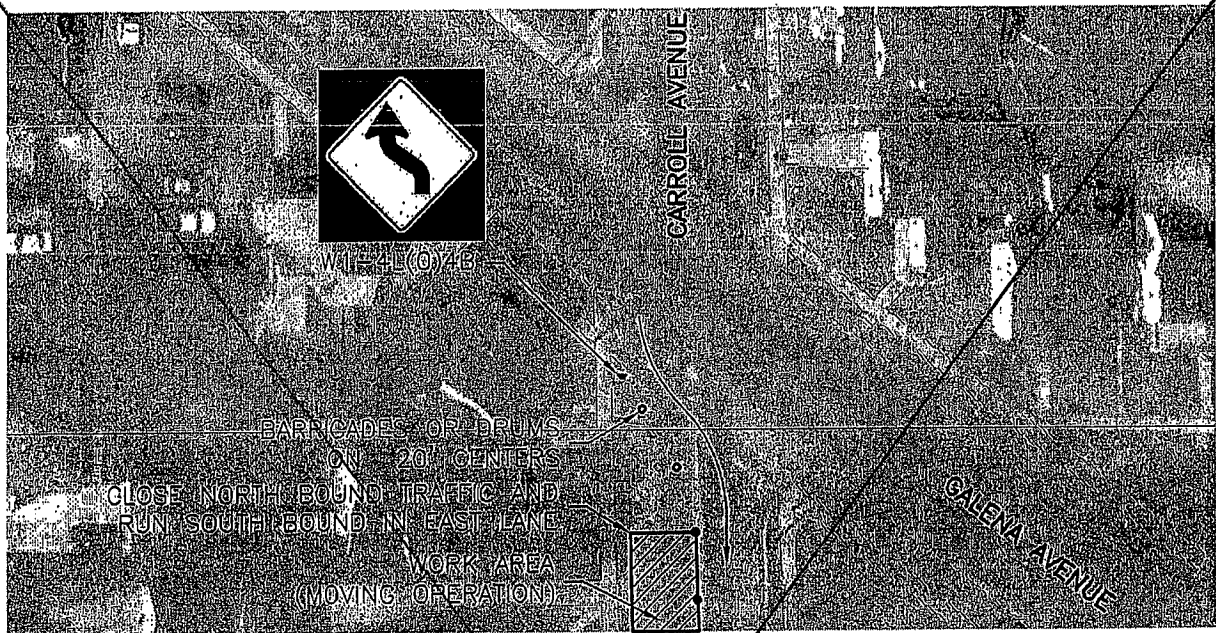

WEST LANE CARROLL AVENUE

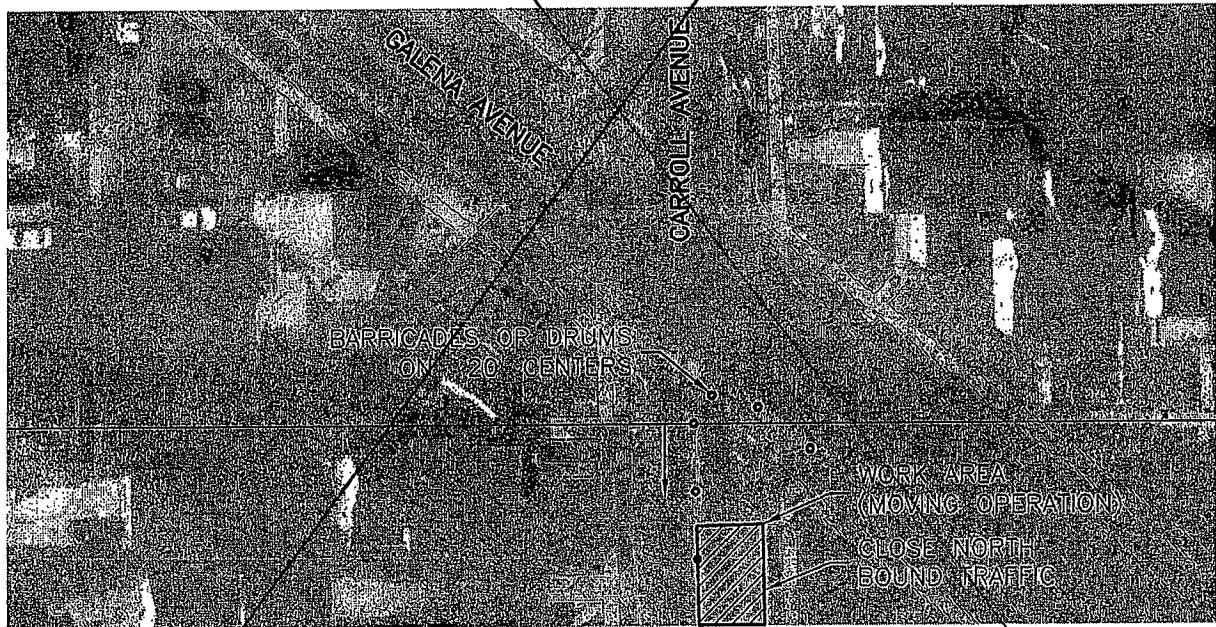

EAST LANE CARROLL AVENUE

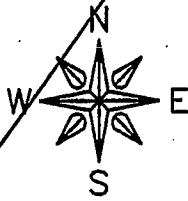

SCALE: 1" = 50'

C:\EGLPT\09\09-286 LAPP\09-286-Bose.DWG, Layout25

CARROLL AVE & GALENA AVE  
FAU 5260

INTERSECTION IMPROVEMENTS 7/15/09



**FEHR-GRAHAM & ASSOCIATES, LLC**

ENGINEERING AND SCIENCE CONSULTANTS

FREEPORT, IL ROCKFORD, IL ROCHELLE, IL SPRINGFIELD, IL MONROE, WI

ILLINOIS DESIGN FIRM NO. 184-003525

© 2009 FEHR-GRAHAM & ASSOCIATES

Deleted 9-9-09