

STATE OF ILLINOIS  
**WINNEBAGO COUNTY HIGHWAY DEPARTMENT**  
 PLANS FOR PROPOSED IMPROVEMENT

**PRAIRIE HILL ROAD WIDENING & RESURFACING**

FAU 9876 - COUNTY HIGHWAY 76

SECTION 06-00388-00-WR

PROJECT NO. M - 5291 (014)

JOB NO. C - 92 - 100 - 09

CONTRACT NO. 85482

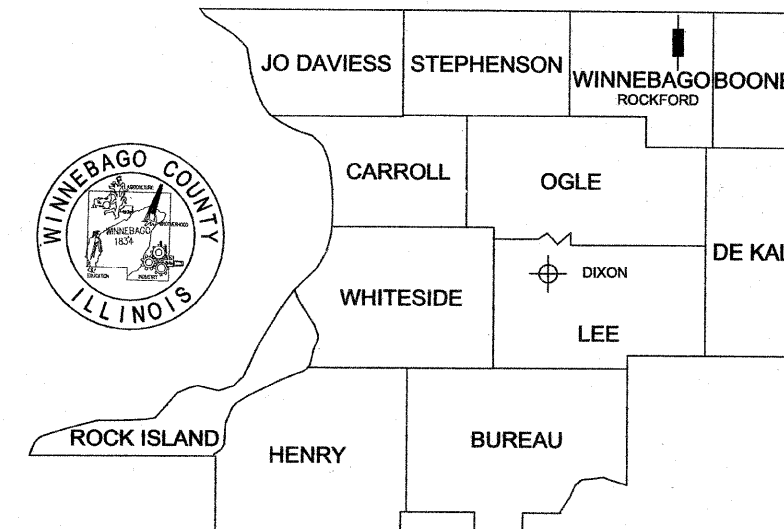

⊕ DISTRICT HEADQUARTER | PROJECT LOCATION

**INDEX OF SHEETS**

SHEET NO.	SHEET NAME
1	COVER SHEET
2	SUMMARY OF QUANTITIES GENERAL NOTES SCHEDULE OF QUANTITIES
3-4	LAYOUT PLAN
5	CROSS SECTIONS
6	STAGING PLAN
7-10	DISTRICT 2 STANDARD DETAILS

**STANDARDS**

STAND. NO.	STAND. NAME
442201-03	CLASS C&D PATCHES
606001-04	CONCRETE CURB TYPE B AND COMBINATION CONCRETE CURB AND GUTTER
606301-04	PC CONCRETE ISLANDS AND MEDIANS
701006-03	OFF ROAD OPERATIONS 2L, 2W, 15' TO 24" FROM PAVEMENT EDGE
701301-03	LANE CLOSURE, 2L, 2W, SHORT TIME OPERATIONS
701311-03	LANE CLOSURE, 2L, 2W, MOVING OPERATIONS - DAY ONLY
701331-03	LANE CLOSURE, 2L, 2W, WITH RUN-AROUND FOR SPEEDS > 45 MPH
701421-02	LANE CLOSURE MULTI LANE, DAY OPERATIONS ONLY FOR SPEEDS ≥ 45 MPH TO 55 MPH
701901-01	TRAFFIC CONTROL DEVICES
728001-01	TELESCOPING STEEL SIGN SUPPORT
729001-01	APPLICATIONS OF TYPES A & B METAL POSTS
780001-02	TYPICAL PAVEMENT MARKINGS
781001-03	TYPICAL APPLICATIONS RAISED REFLECTIVE PAVEMENT MARKERS

**SUMMARY OF QUANTITIES**

CONSTRUCTION TYPE CODE: 1000

Item No	Item	Unit	QTY
20200500	EARTH EXCAVATION (WIDENING)	CU YD	599
28000300	TEMP DITCH CHECKS	EACH	18
35101400	AGGREGATE BASE COURSE, TYPE B	TON	65
35600712	HOT-MIX ASPHALT BASE COURSE WIDENING 9"	SQ YD	2395
40600200	BITUMINOUS MATERIALS (PRIME COAT)	TON	7.13
40600300	AGGREGATE (PRIME COAT)	TON	21.74
40600982	HOT-MIX ASPHALT SURFACE REMOVAL BUTT JOINT	SQ YD	43
40600990	TEMPORARY RAMP	SQ YD	36
40603080	HOT-MIX ASPHALT BINDER COURSE, IL 19.0, N50	TON	1320.9
40603310	HOT-MIX ASPHALT SURFACE COURSE, MIX "C", N50	TON	1336.1
40800050	INCIDENTAL HOT-MIX ASPHALT SURFACING	TON	82.91
44000000	HOT-MIX ASPHALT SURFACE CORRECTION	SQ YD	4955
44000500	COMBINATION CONCRETE CURB & GUTTER REMOVAL	FOOT	721
44003800	MEDIAN SURFACE REMOVAL	SQ FT	1674
44201978	CLASS D PATCHES, TYPE III	SQ YD	16
44400100	FIBERGLASS FABRIC REPAIR SYSTEM	SQ YD	1209
48101200	AGGREGATE SHOULDERS TYPE B	TON	390
48203100	HOT MIX ASPHALT SHOULDERS	TON	126.8
60603800	COMBINATION CONCRETE CURB AND GUTTER - TYPE B6.12	FOOT	721
60618300	CONCRETE MEDIAN SURFACE, 4 INCH	SQ FT	1674
67100100	MOBILIZATION	L SUM	1
70101700	TRAFFIC CONTROL AND PROTECTION	L SUM	1
70300100	SHORT-TERM PAVEMENT MARKING	FOOT	444
70300200	TEMPORARY PAVEMENT MARKING	FOOT	9146
70301000	WORK ZONE PAVEMENT MARKING REMOVAL	SQ FT	790
* 78004230	PERFORMED PLASTIC PAVEMENT MARKING, TYPE B - INLAID - LINE 6"	FOOT	9760
* 78004250	PERFORMED PLASTIC PAVEMENT MARKING, TYPE B - INLAID - LINE 12"	FOOT	50
Z0075310	TIE BARS 3/4"	EACH	288
X0323644	PAVEMENT MARKING GROOVING	FOOT	9860

\* SPECIALTY ITEMS  
 POSTED SPEED = DESIGN SPEED = 55 MPH  
 ADT: 2800 (2008) 2% TRUCKS  
 URBAN ARTERIAL

PRAIRIE HILL RD. BEGINS  
 STA 100+00

PRAIRIE HILL RD. ENDS  
 STA 140+62

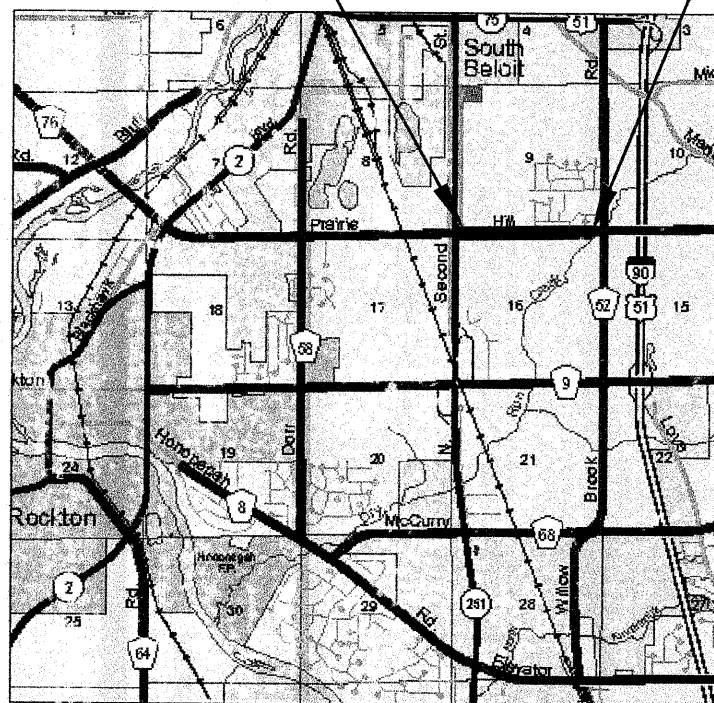

**LOCATION MAP**

PRAIRIE HILLS RD:  
 NET LENGTH: 4062.00 FT (0.769 MILES)

**CALL J.U.L.I.E.**  
**BEFORE YOU DIG**  
 1-800-892-0123  
 T.46 N. - R.2 E. SEC. 8, 9, 16 & 17

THESE SHEETS PREPARED BY:  
 WINNEBAGO COUNTY HIGHWAY DEPARTMENT

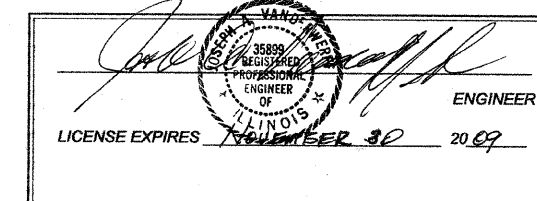

STATE OF ILLINOIS  
 DEPARTMENT OF TRANSPORTATION  
 DIVISION OF HIGHWAYS

APPROVED July 20, 2009 20 09  
 [Signature]  
 WINNEBAGO COUNTY ENGINEER

PASSED July 22, 2009 20 09  
 [Signature]  
 DISTRICT 2 ENGINEER OF LOCAL ROADS & STREETS

RELEASING FOR BID  
 BASED ON LIMITED  
 REVIEW July 22, 2009 20 09  
 [Signature]  
 DEPUTY DIRECTOR OF HIGHWAYS, REGION 2 ENGINEER



**GENERAL NOTES:**

The earth removed in shaping the subgrade of the pavement and not needed to complete the earth shoulders within the project limits shall be disposed of by the Contractor as directed by the Engineer, without additional compensation, it being understood that the cost of performing such work is included in the contract unit price Per Cubic Yard for Earth Excavation (Widening).

The final top four inches of soil in any right of way area disturbed by the Contractor must be a cohesive soil capable of supporting vegetation.

The Contractor shall be responsible for protecting utility property during construction operations as outlined in Article 107.31 of the Standard Specifications. The JULIE number is 800-892-0123. These utilities located within the project limits or immediately adjacent to the project construction limits are members of JULIE.

- ATT
- IL AMERICAN WATER
- CHARTER COMMUNICATIONS
- NICOR
- ROCK ENERGY COOPERATIVE
- ROCK RIVER WATER RECLAMATION

A minimum of 48 hours advance notice is required for non-emergency work.

A contingency quantity of 359 tons of Aggregate Shoulders Type B has been included if additional materials are needed to build up the shoulders to conform with the Typical Sections.

A contingency quantity of 65 tons of Aggregate Base Course Type B has been included for the purpose of raising median elevation to proposed grade.

Fiberglass Fabric Repair System shall be placed on the existing surface prior to any resurfacing.

If, during the widening resurfacing operations, the existing mailboxes become a hindrance, the Contractor shall be required to carefully remove and reinstall the mailboxes as directed by the Engineer. This work shall be included in the contract unit price for Earth Excavation Widening.

**SCHEDULE OF QUANTITIES**

EARTH EXCAVATION, WIDENING (CY)	
L & R 108+30 - 140+62	599
<b>TOTAL</b>	<b>599</b>

TEMP DITCH CHECKS (EA)	
107+40 R	1
110+00 L & R	2
116+30 L & R	2
120+00 L & R	2
122+90 L	1
123+40 R	1
125+20 L & R	2
135+00 R	1
137+25 L	1
137+80 R	1
139+30 L & R	2
140+50 L & R	2
<b>TOTAL</b>	<b>18</b>

HOT-MIX ASPHALT BASE COURSE WIDENING 9" (SY)	
L & R 108+30 - 140+62	2395
<b>TOTAL</b>	<b>2395</b>

COMBINATION CONCRETE CURB & GUTTER REMOVAL (FT)	
100+00 - 103+40	721
<b>TOTAL</b>	<b>721</b>

MEDIAN SURFACE REMOVAL (SF)	
100+00-103+40	1674
<b>TOTAL</b>	<b>1674</b>

CONCRETE MEDIAN SURFACE, 4" (SF)	
100+00-103+40	1674
<b>TOTAL</b>	<b>1674</b>

COMBINATION CONCRETE CURB AND GUTTER TYPE B-6.12 (FT)	
100+00 - 103+40	721
<b>TOTAL</b>	<b>721</b>

CLASS D PATCHES, TYPE III (SY)	
100+45	16
<b>TOTAL</b>	<b>16</b>

TEMPORARY RAMP (SY)	
100+00-100+15	27
141+37-141+42	9
<b>TOTAL</b>	<b>36</b>

FIBERGLASS FAB REP (SY)	
100+00-108+30±	306
108+30±-140+62	903
<b>TOTAL</b>	<b>1209</b>

AGGREGATE SHOULDERS TYPE-B (TON)	
100+00-105+02 L	15
100+00-105+45 R	16
CONTINGENCY	359
<b>TOTAL</b>	<b>390</b>

HOT MIX ASPHALT SHOULDERS (TON)	
100+00-105+02 L	62
100+00-105+45 R	64.8
<b>TOTAL</b>	<b>126.8</b>

HOT-MIX ASPHALT BINDER COURSE, IL 19.0, N50 (TON)	
108+05 - 140+62	1320.9
<b>TOTAL</b>	<b>1320.9</b>

HOT MIX ASPHALT SURFACE COURSE, MIX "C", N50 (TON)	
100+00 - 107+60	434.8
107+60 - 140+62	901.3
<b>TOTAL</b>	<b>1336.1</b>

HOT MIX ASPHALT SURFACE CORRECTION (SY)	
100+00-107+60	4955
<b>TOTAL</b>	<b>4955</b>

HOT-MIX ASPHALT SURFACE REMOVAL - BUTT JOINT (SY)	
141+27-141+42	43
<b>TOTAL</b>	<b>43</b>

MIXTURE USE (S):	SURFACE	BINDER
PG:	PG 64-22	PG 64-22
DESIGN AIR VOIDS:	4.0 @ N50	4.0 @ N50
MIXTURE COMPOSITION (GRADATION MIXTURE):	IL 9.5 or 12.5	IL 19.0
FRICITION AGGREGATE:	C	N/A
20 YEAR ESAL:	0.3	0.3
MIX UNIT WEIGHT:	112 lbs/sy/in	

**TYPICAL SECTIONS & DETAILS**

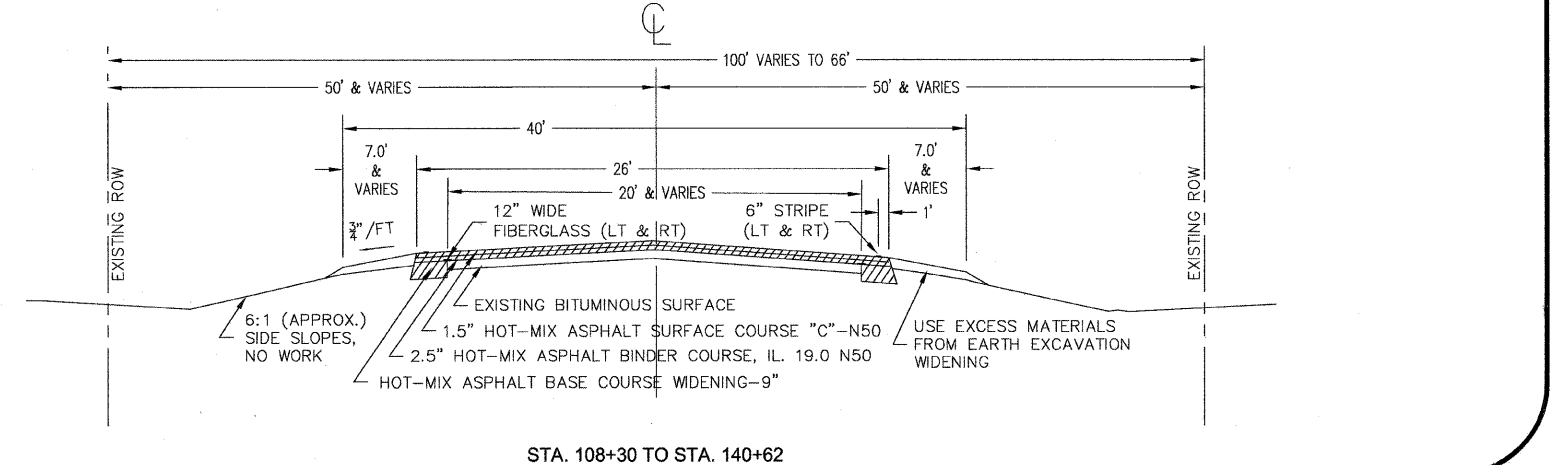
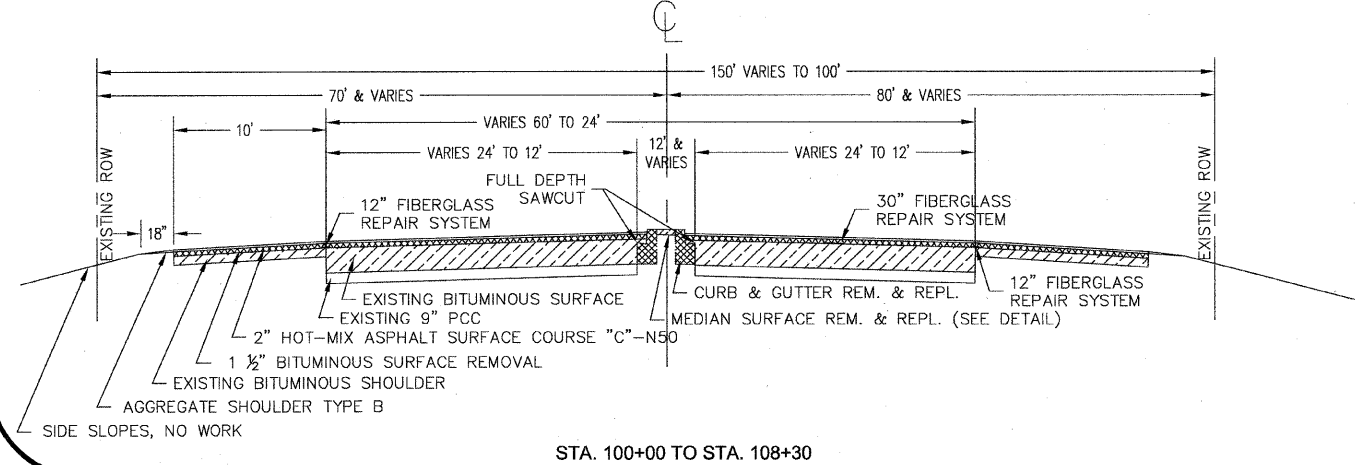
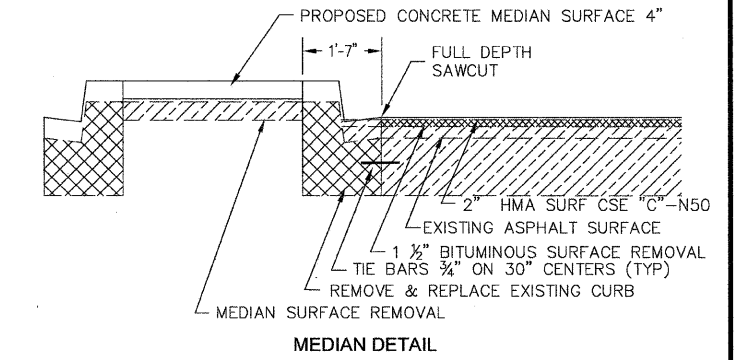
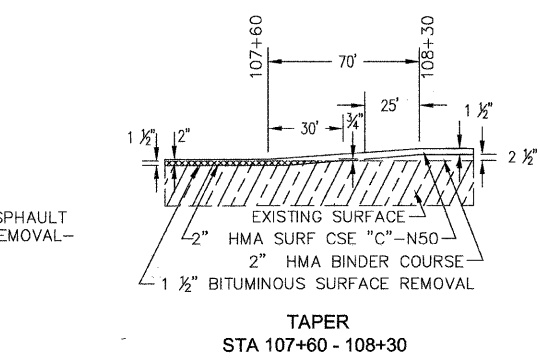
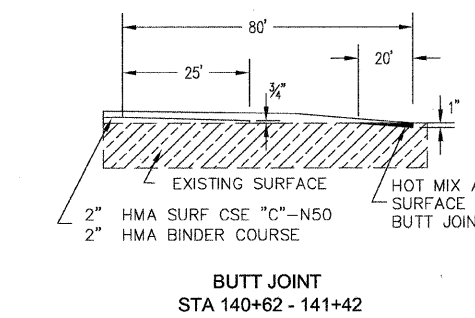
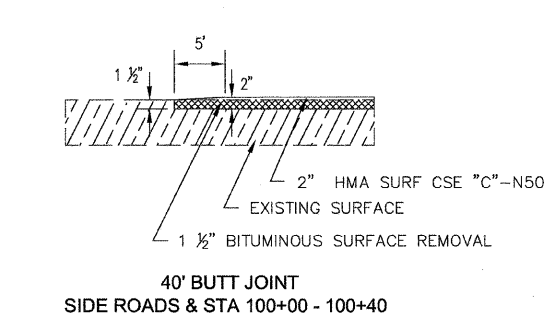
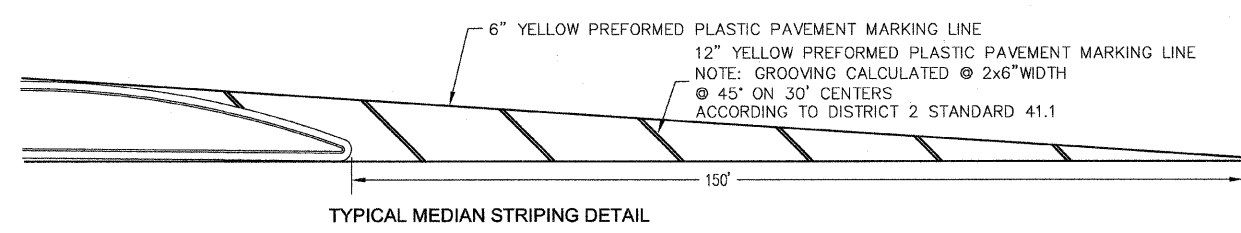
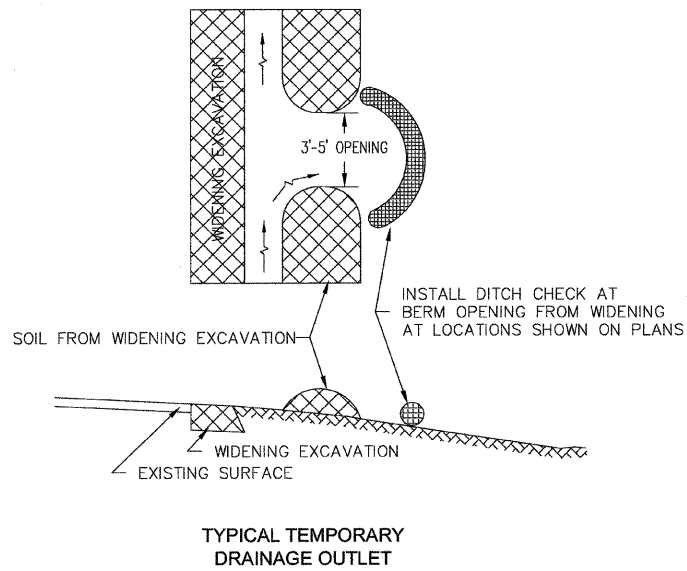

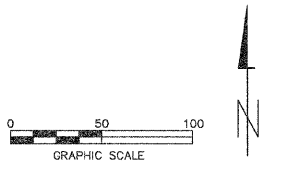
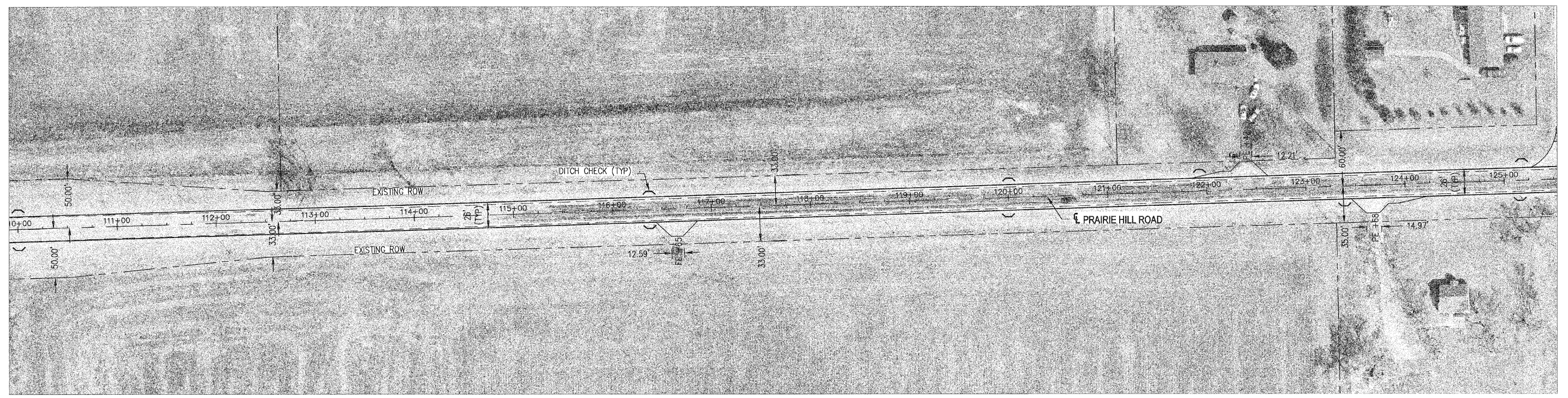
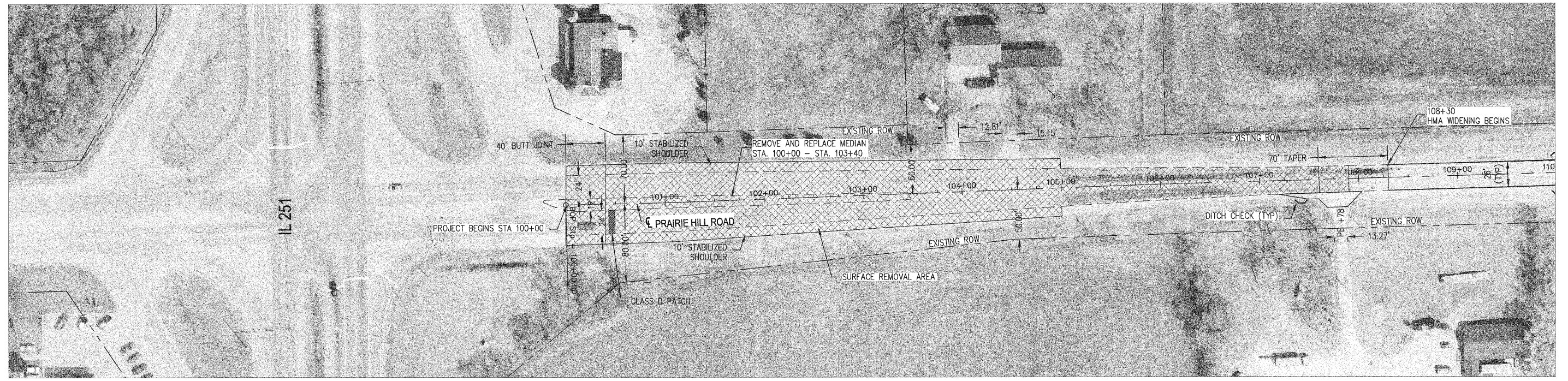

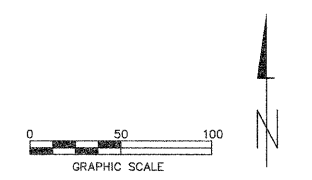
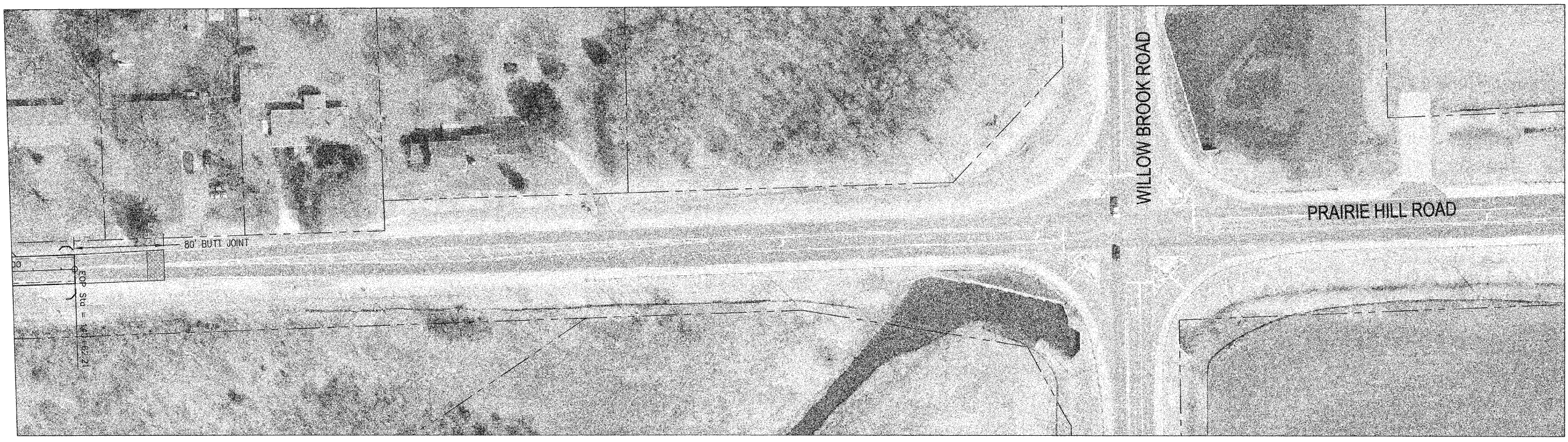
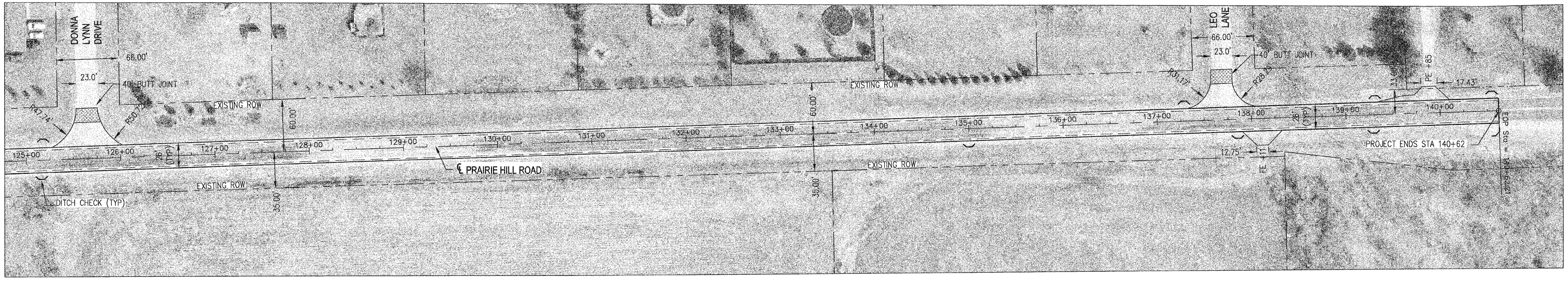

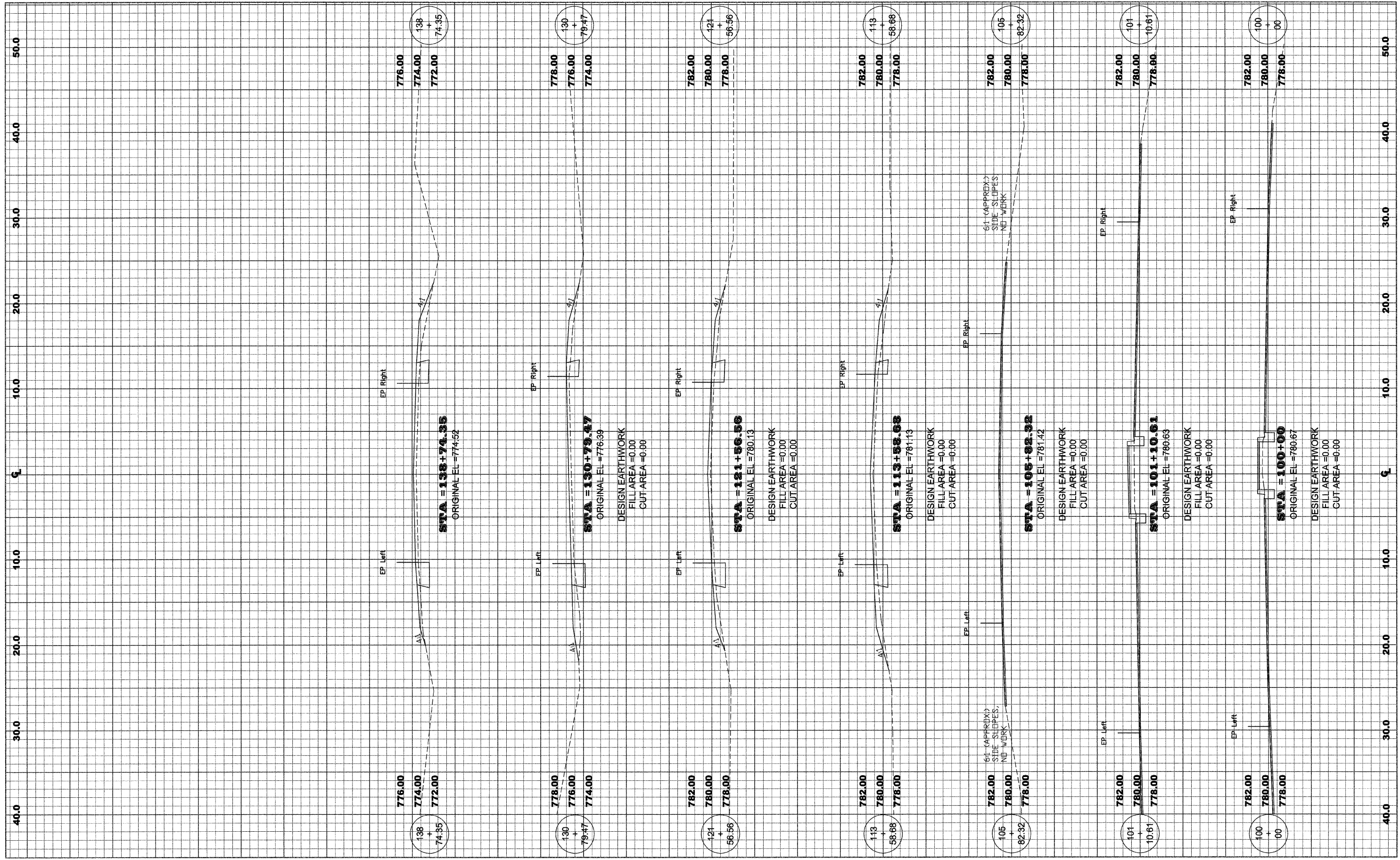

CROSS-SECTION

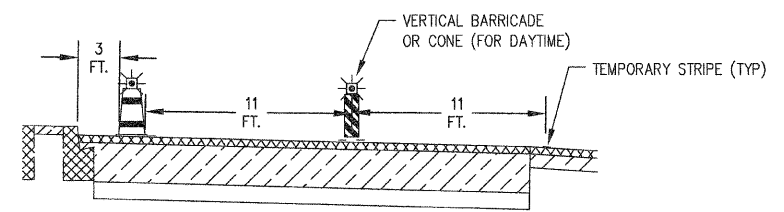
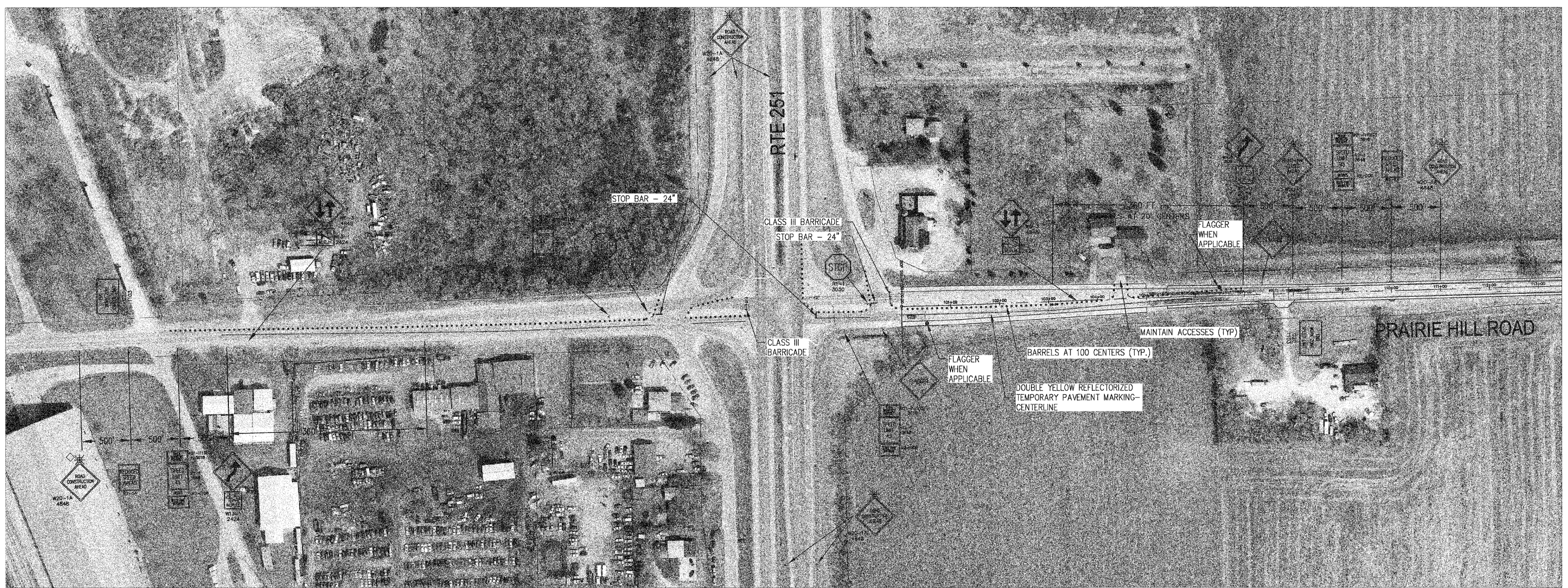

TYPICAL

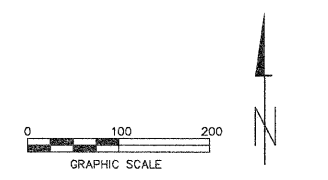



# TYPICAL PAVEMENT MARKINGS

## TYPICAL PAVEMENT MARKING FOR FLUSH MEDIAN AT LEFT TURN LANE

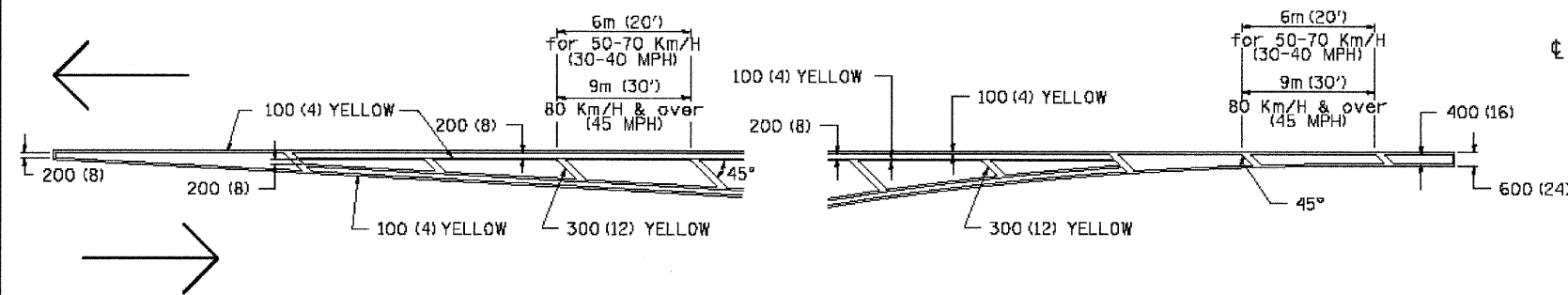

## MEDIAN PAVEMENT MARKING

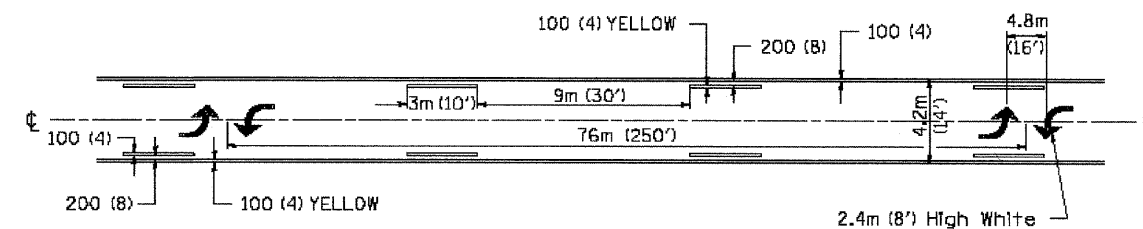

\*\* ALL DIMENSIONS ARE IN MILLIMETERS (INCHES) UNLESS OTHERWISE NOTED.

## TYPICAL ISLAND OFFSET SHOULDER WIDTH

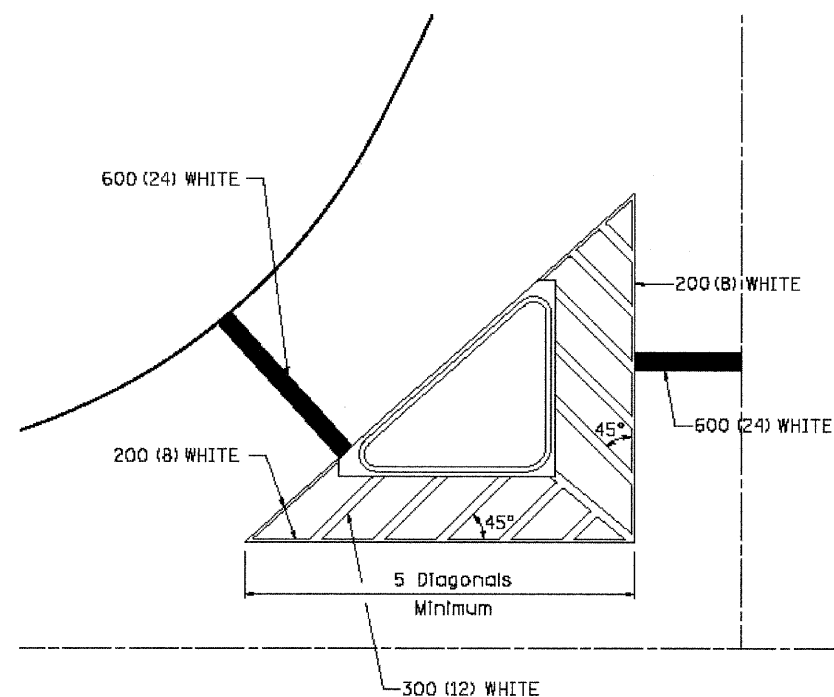

## TYPICAL PARKING SPACING

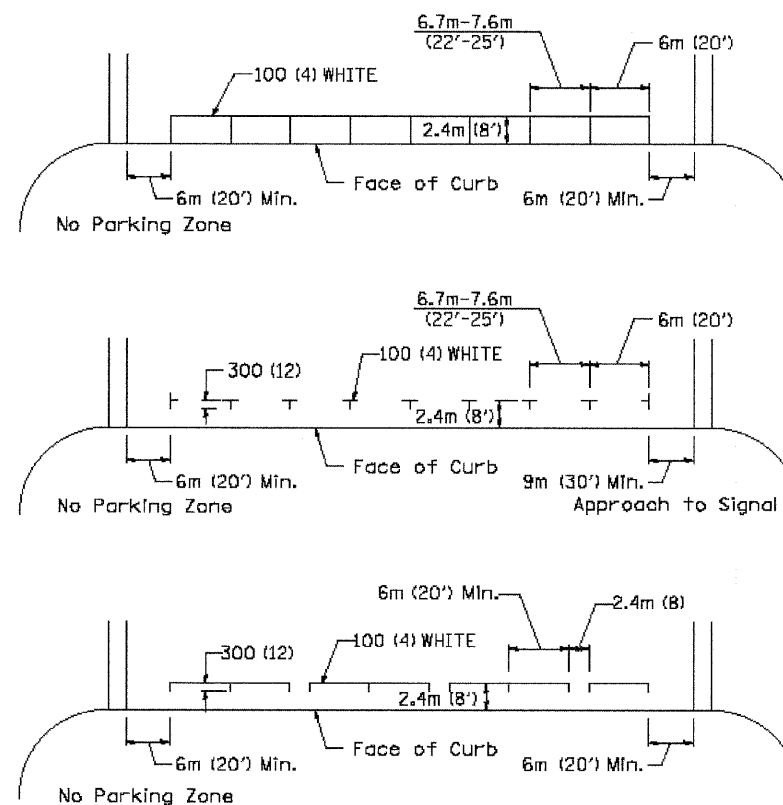

## STANDARD CROSSWALK MARKING

See Schedules for Locations

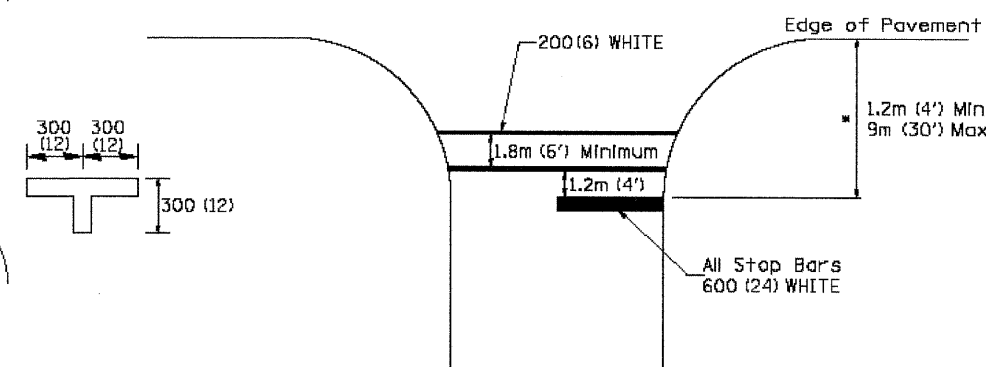

• Distance to the nearest edge of the intersecting roadway in the absence of a marked crosswalk.

FILE NAME = D:\Projects\2008\200806\Full\85482.dwg	USER NAME = #USER#	DESIGNED -	REVISED - 10-21-08
		DRAWN -	REVISED -
		CHECKED -	REVISED -
		DATE -	REVISED -

STATE OF ILLINOIS DEPARTMENT OF TRANSPORTATION

REGION 2 / DISTRICT 2 STANDARD

SCALE:	SHEET NO.	OF SHEETS	STA.	TD STA.	F.A.R.T.E.	SECTION	COUNTY	TOTAL SHEETS	SHEET NO.
--------	-----------	-----------	------	---------	------------	---------	--------	--------------	-----------



# TYPICAL PAVEMENT MARKINGS

## ARROW LAYOUT

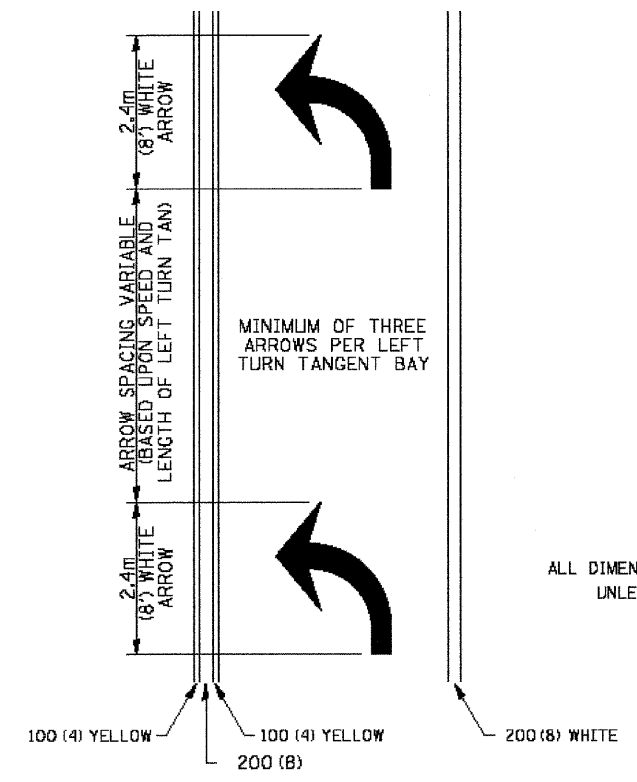

- ◀ ONE-WAY AMBER MARKER
- ◁ ONE-WAY CRYSTAL MARKER
- ◆ TWO-WAY AMBER MARKER

ALL DIMENSIONS ARE IN MILLIMETERS (INCHES) UNLESS OTHERWISE NOTED.

## TYPICAL PAVEMENT MARKING FOR FLUSH MEDIAN

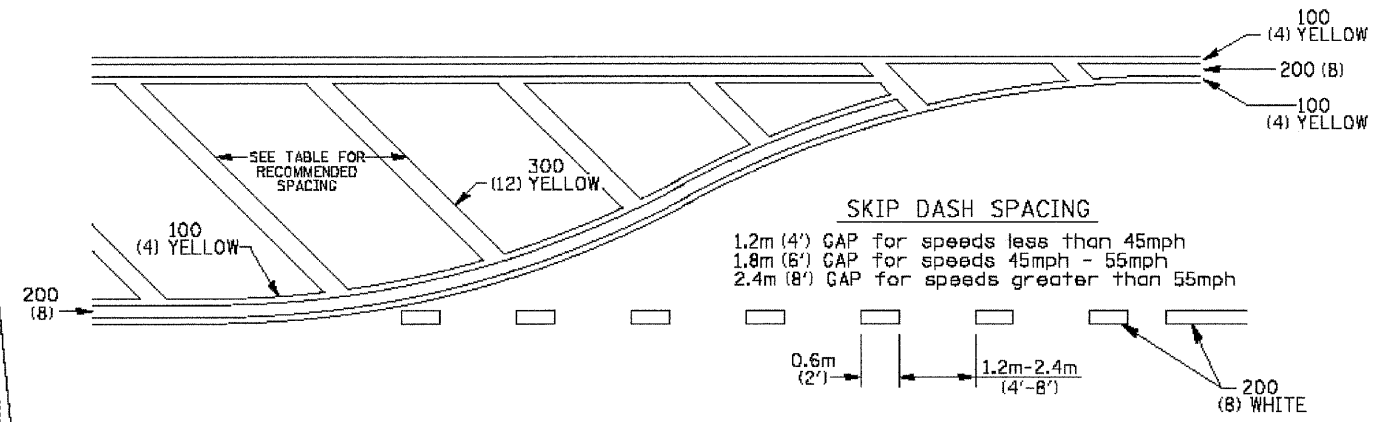

### RECOMMENDED SPACING BETWEEN DIAGONALS (IN FEET)

Speed Limit Range	Continuous Median Area	Intersection Channelization	Objects (Islands)
less than 50Km/H (30MPH)	15.3m (50')	4.53m (15')	3.05m (10')
50-60Km/H (30-40MPH)	22.9m (75')	6.1m (20')	4.53m (15')
70Km/H (45MPH) & over	22.9m (75')	9.05m (30')	6.1m (20')

NOTE: If the spacing recommended in the Table does not permit at least five diagonal lines in the area being marked, the spacing from the next lowest speed range should be used. The recommended spacing is measured parallel to the pavement center line.

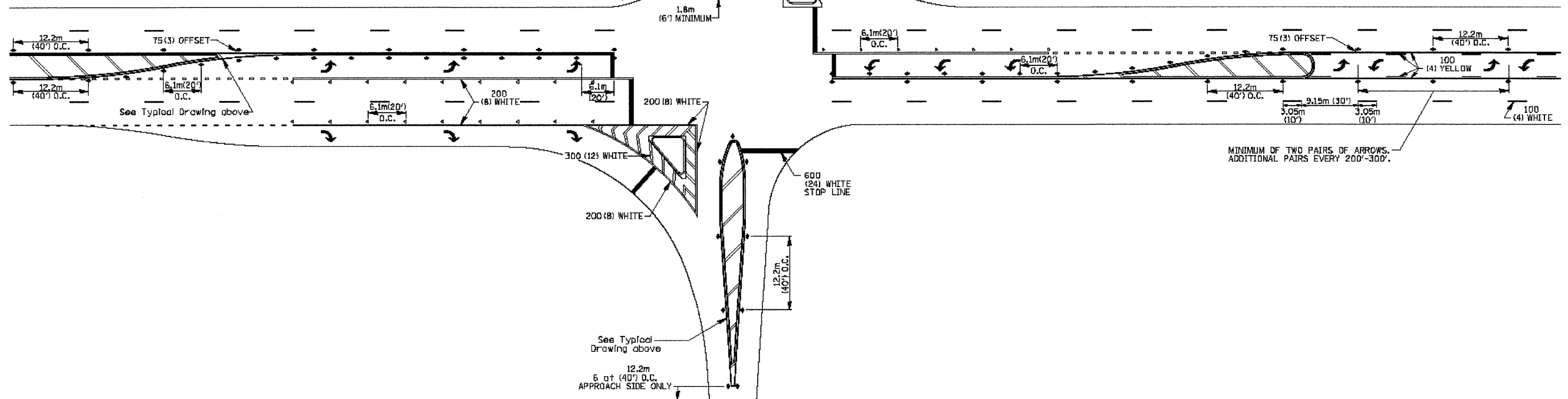

FILE NAME = D:\Projects\Carroll\Fall19\ca1	USER NAME = MUSER	DESIGNED -	REVISED - 10-21-08	<b>STATE OF ILLINOIS DEPARTMENT OF TRANSPORTATION</b>	<b>REGION 2 / DISTRICT 2 STANDARD</b>			F.A. RTE.	SECTION	COUNTY	TOTAL SHEETS	SHEET NO.	
		DRAWN -	REVISED -		SCALE:	SHEET NO.	OF	SHEETS	STA.	TD STA.	FED. ROAD DIST. NO.	ILLINOIS FED. AID PROJECT	CONTRACT NO.
		CHECKED -	REVISED -		<b>TYPICAL PAVEMENT MARKINGS SHEET 2 OF 3 41.1</b>								
		DATE -	REVISED -		IDOT DIST. 2 STANDARD DETAILS								





# TYPICAL PAVEMENT MARKINGS

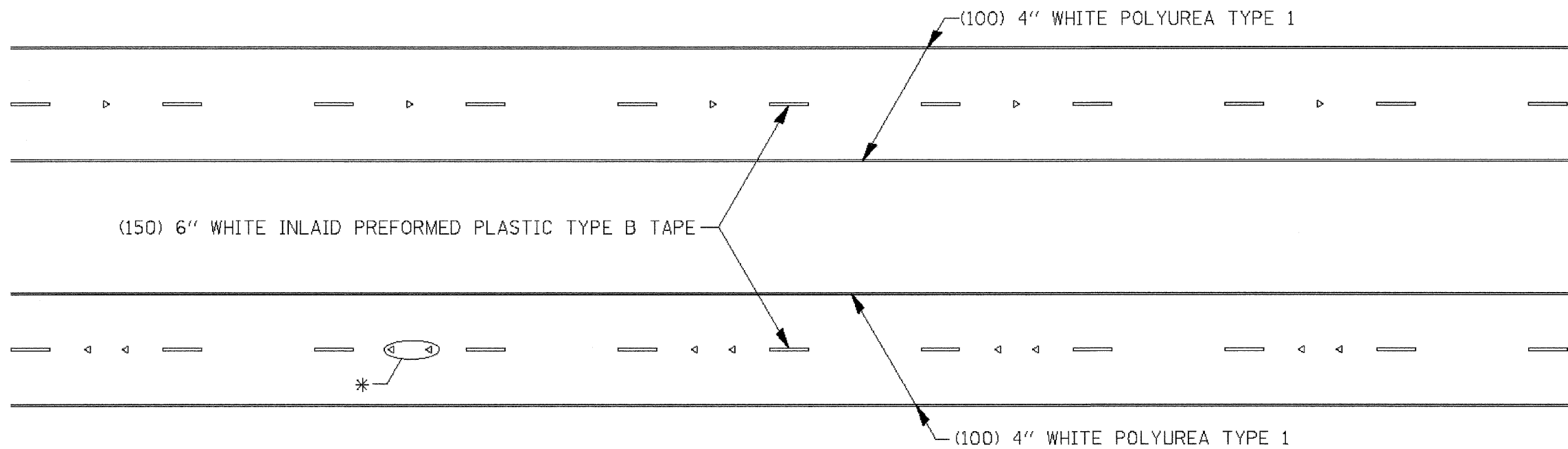

\* SEE HIGHWAY STANDARD 781001 FOR SPACING DETAILS.  
 USE DOUBLE MARKERS WHEN ADT ≥ 25,000.

## MULTI-LANE / DIVIDED

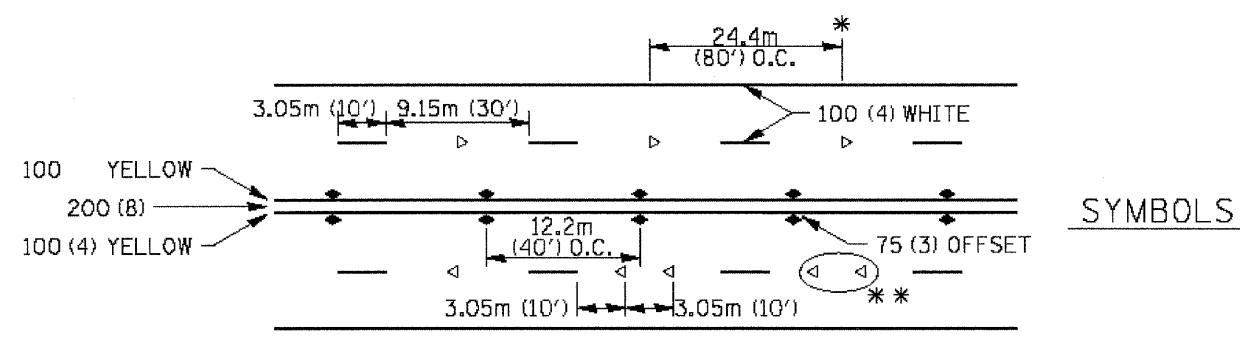

\* REDUCE TO 12.2m (40') O.C. ON CURVES WHERE ADVISORY SPEEDS ARE 15Km/H (10MPH) LOWER THAN POSTED SPEEDS.  
 \*\* USE DOUBLE MARKERS WHEN ADT ≥ 25,000

## MULTI-LANE / UNDIVIDED

## TYPICAL PAVEMENT MARKING FOR TWO LANE SECTION - NO PASSING ZONES

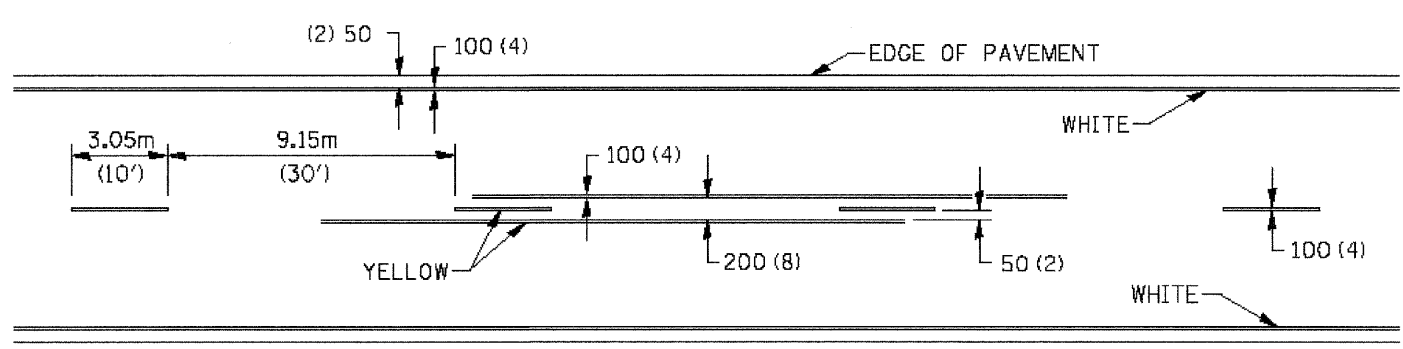

FILE NAME =	USER NAME = #USER#	DESIGNED -	REVISED - 10-21-08	<b>STATE OF ILLINOIS DEPARTMENT OF TRANSPORTATION</b>	<b>REGION 2 / DISTRICT 2 STANDARD</b>			F.A. RTE.	SECTION	COUNTY	TOTAL SHEETS	SHEET NO.	
DA\Projects\2008\FullSize.cad		DRAWN -	REVISED -		SCALE:	SHEET NO.	OF	SHEETS	STA.	TO STA.	FED. ROAD DIST. NO.	ILLINOIS FED. AID PROJECT	
		PLOT SCALE = 1/8" = 1' / 3/4"	CHECKED -		REVISED -	CONTRACT NO.							
		PLOT DATE = Mon Oct 27 15:53:40 2008	DATE -		REVISED -	<b>TYPICAL PAVEMENT MARKINGS SHEET 3 OF 3 41.1</b>							



# ROUGH GROOVED SURFACE SIGN

ILLINOIS STANDARD W8-I107  
SIGN PANEL TYPE 1



COLOR: LEGEND AND BORDER - BLACK NON-REFLECTIVE  
BACKGROUND - ORANGE REFLECTORIZED

### GENERAL NOTES

SIGN PANELS AND FACE MATERIALS SHALL BE ACCORDING TO SECTION 720 OF THE STANDARD SPECIFICATIONS  
METAL POSTS SHALL BE IN ACCORDANCE WITH STD. 720011.

ALL MOUNTING HARDWARE SHALL BE ALUMINUM, STAINLESS STEEL, ZINC OR CADMIUM PLATED STEEL AND SHALL BE INCLUDED TO THE COST OF THE INSTALLATION.

ALL DIMENSIONS ARE IN MILLIMETERS (INCHES) UNLESS OTHERWISE NOTED.

SIGN SIZE	DIMENSIONS							
	A	B	C	D	E	F	G	H
1200x1200 (48x48)	1200 (48.0)	600 (24.1)	75 (3.0)	850 (34.0)	825 (33.0)	150 (6.0)	325 (13.0)	88 (3.5)

SIGN SIZE	SERIES			MARGIN	BORDER	BLANK STD.
	LINES					
	1	2	3			
1200x1200 (48x48)	7C	7C	7C	20 (0.8)	30 (1.2)	B4-48D

ALL DIMENSIONS IN INCHES.

REVISED - 1-09-08	<b>REGION 2 / DISTRICT 2 STANDARD</b>	F.A. RTE.	SECTION	COUNTY	TOTAL SHEETS	SHEET NO.
REVISED -						
REVISED -		CONTRACT NO.				
REVISED -		SCALE: 1/8" = 1'-0"	SHEET NO.	OF	SHEETS	STA.
PLOT DATE = Mon Oct 27 11:51:52 2008		FED. ROAD DIST. NO.	ILLINOIS FED. AID PROJECT			