



**LEGEND**

-  COMBINATION CONCRETE CURB AND GUTTER, TYPE M-6.12
-  PORTLAND CEMENT CONCRETE SIDEWALK, 4 INCH
-  DETECTABLE WARNINGS



- NOTE:**
- 1) - COMBINATION CURB AND GUTTER REMOVAL
  - 2) - COMBINATION CONCRETE CURB AND GUTTER, TYPE M-6.12 (ABUTTING EXISTING PAVEMENT)
  - 3) - EXISTING CROSSWALK MARKINGS TO BE REMOVED
  - 4) - NEW THERMOPLASTIC CROSSWALK MARKINGS PER DETAIL
  - 5) - THE CONTRACTOR SHALL CONTACT THE KANKAKEE COUNTY HIGHWAY DEPARTMENT AT (815)939-1731 A MINIMUM OF 72 HOURS PRIOR TO REQUESTING THE EXISTING SIGNS TO BE REMOVED.
  - 6) - ANY SIGNS DAMAGED BY CONSTRUCTION ACTIVITIES, INCLUDING THE SIGNS TO BE REMOVED BY OTHERS, SHALL BE REPLACED WITH NEW SIGNS AT THE CONTRACTOR'S EXPENSE. THE CONTRACTOR SHALL IMMEDIATELY REPORT ANY DAMAGED SIGNS TO THE KANKAKEE COUNTY HIGHWAY DEPARTMENT.

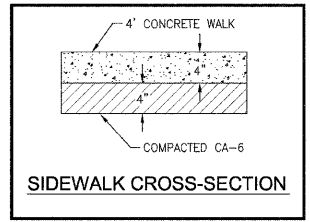
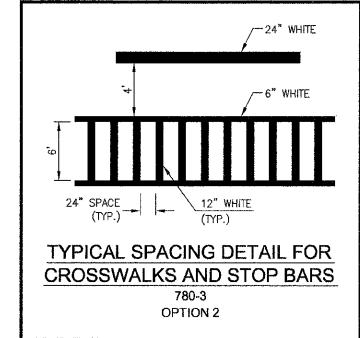
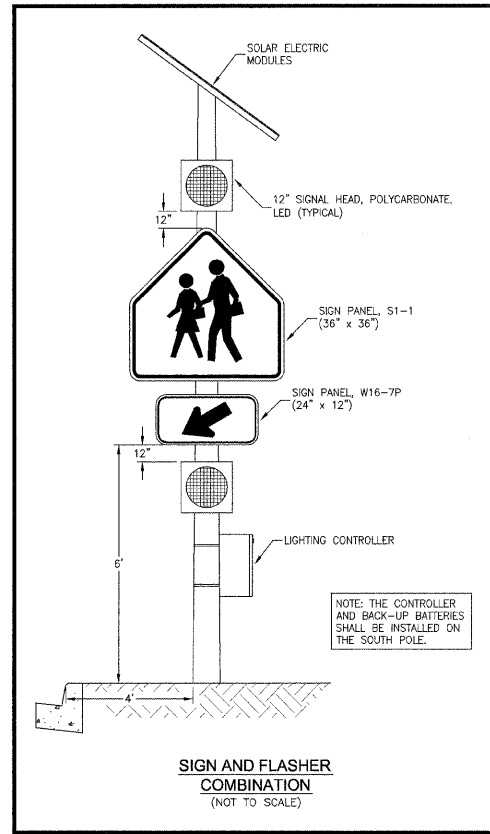
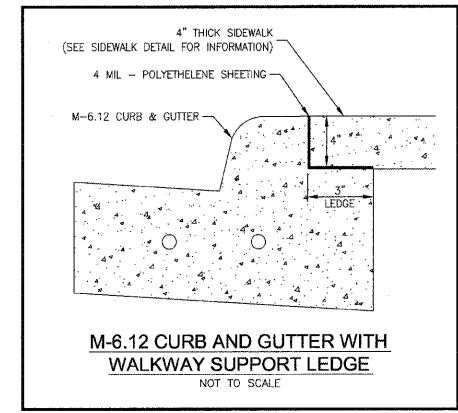
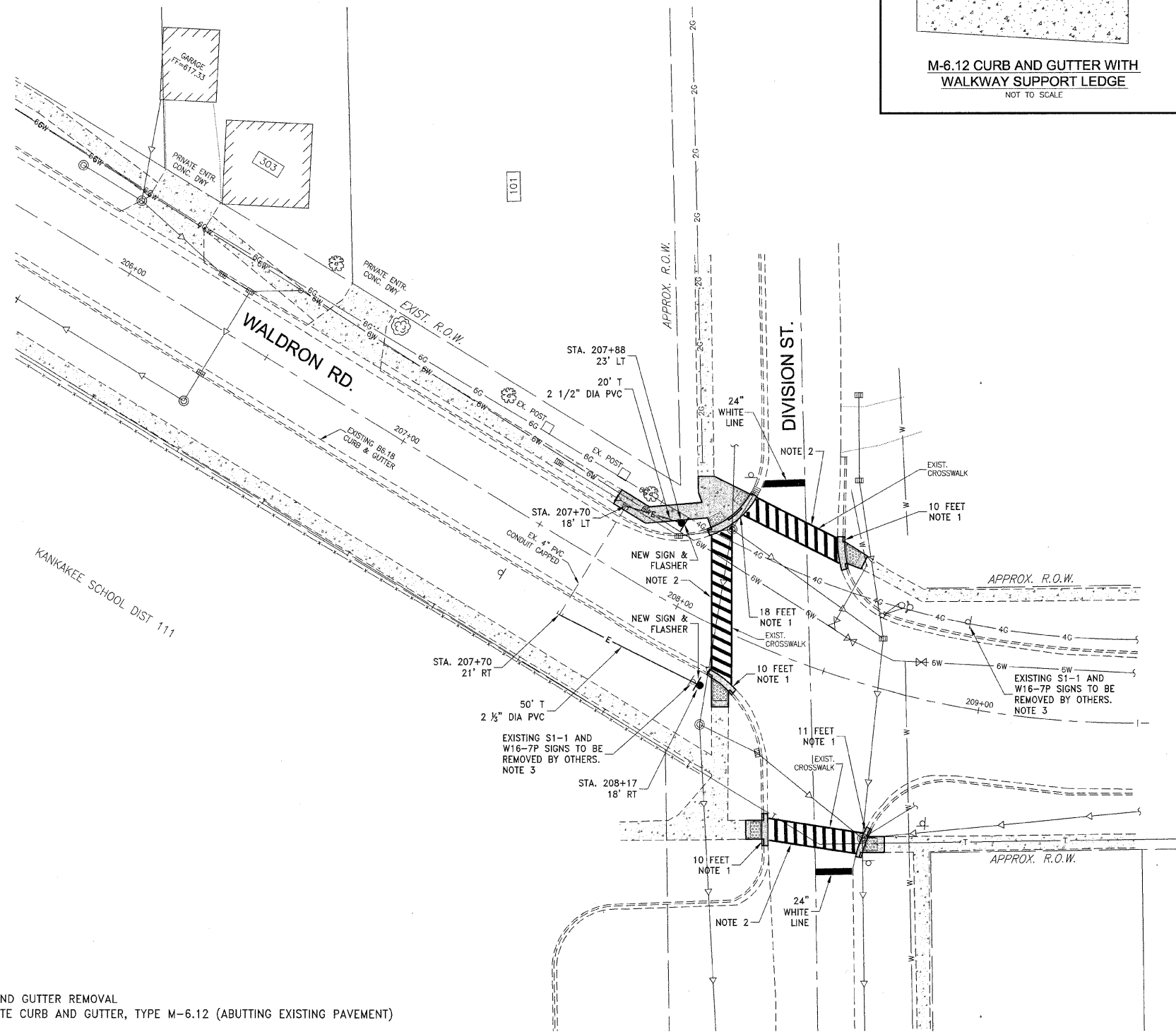
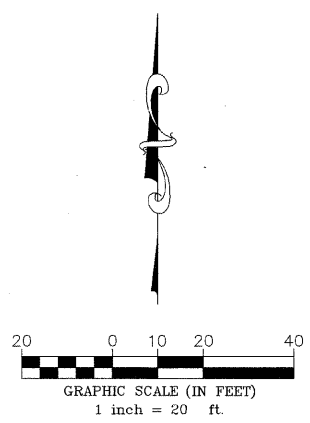

FAU. R/O.	SECTION	COUNTY	TOTAL SHEETS	SHEET NO.
*	**	KANKAKEE	3	3

CONTRACT NO. 87369  
 FED. ROAD DIST. NO. ILLINOIS FED. AID PROJECT  
 \* WALDRON RD. FAU 6184  
 \*\* 08-00018-00-SP

**TYSON ENGINEERING, INC.**  
 Consulting Civil Engineers  
 Land Surveyors  
 Design Firm License #184-001136  
 367 South Schuyler Avenue  
 Kankakee, Illinois 60901  
 Phone (815) 932-7406

This document and the ideas and designs incorporated herein, as an instrument of professional service, is the property of Tyson Engineering Inc. and is not to be used in whole or in part, for any other project without written authorization of Tyson Engineering Inc.  
 Do not scale drawings. Use dimensions only.  
 Contractor shall be responsible for verifying all dimensions.  
 Information hereon and herein is confidential.

**revisions**

no.	date	by	description
1	6/19/09	MRG	PER IDOT REVIEW

date 4/21/09  
 file no.  
 scale **HORZ.: 1"=20'**  
**VERT.: N/A**  
 drawn by **NRG**  
 checked by **KTM**

THE VILLAGE OF  
 OF  
 AROMA PARK

**PROPOSED FLASHING SCHOOL CROSSING SIGN INSTALLATION**  
 AT THE INTERSECTION OF  
 WALDRON ROAD AND DIVISION STREET  
 AROMA PARK, ILLINOIS

PLAN VIEW  
 (WALDRON ROAD & DIVISION STREET)  
 sheet **3**  
 job no. E08063