

SECTION	COUNTY	TOTAL SHEETS	SHEET NO.
08-00037-02-BR	PEORIA	21	9
ILLINOIS		CONTRACT # 89372	

SEE SHEET 4 FOR QUANTITIES NOT SHOWN ON THIS SHEET

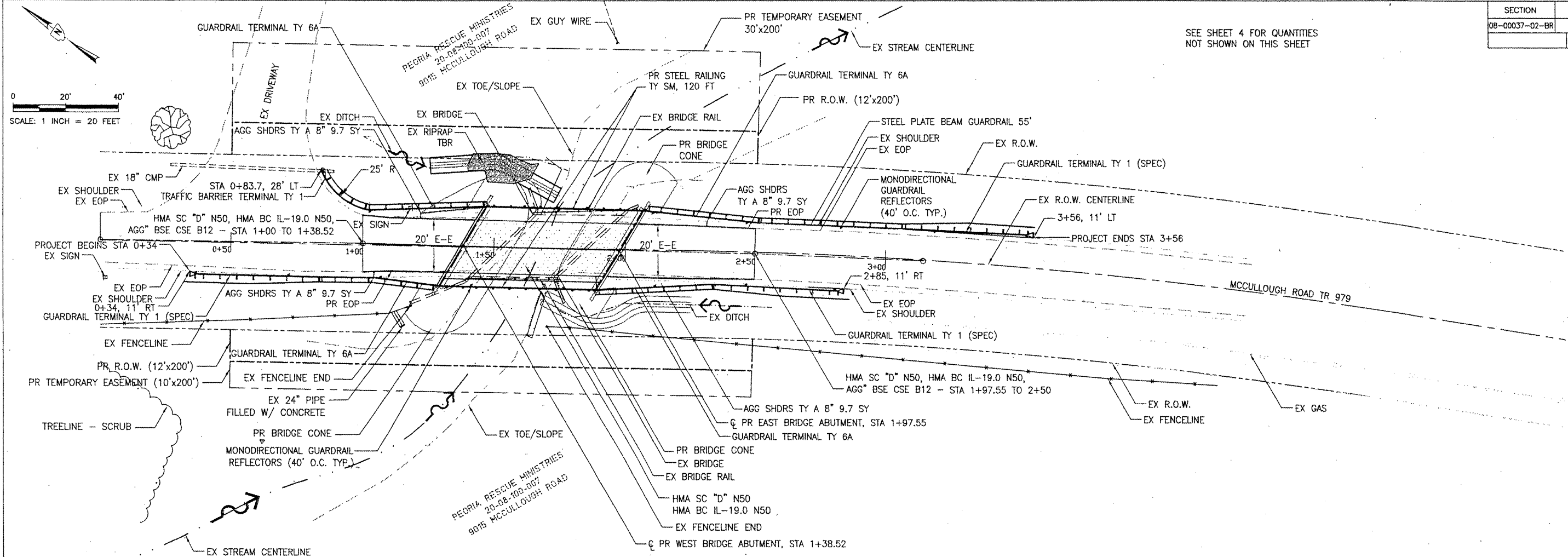

SCALES:
1" = 20' HOR
1" = 5' VER

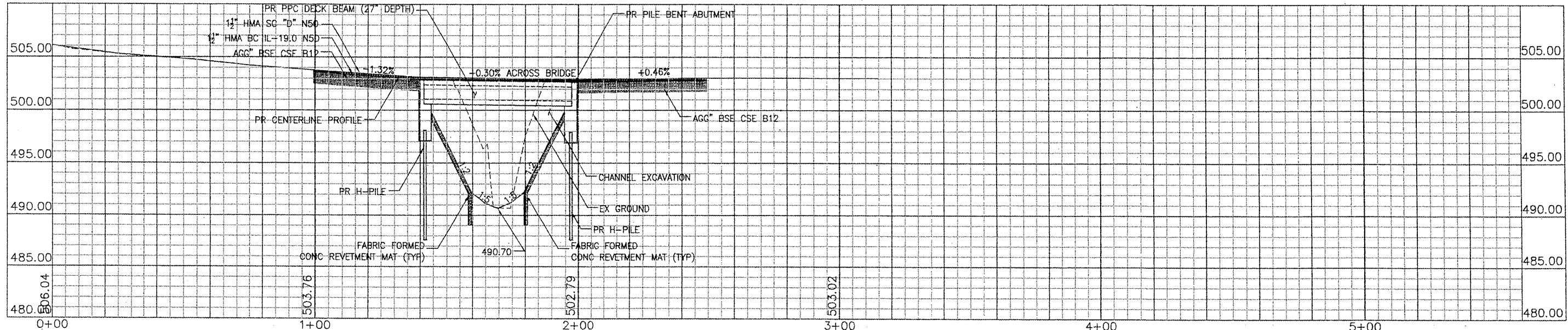

REVISIONS

NO.	DATE	DESCRIPTION	APPROVED

DESIGNED: AJS
DRAWN: AJS, JLA
CHECKED: EEA
DATE: 06/10/08



**MCCULLOUGH ROAD BRIDGE
PLAN & PROFILE**
PEORIA COUNTY HIGHWAY DEPT.
MCCULLOUGH ROAD BRIDGE #072-3063
6915 W. PLANK ROAD
PEORIA, ILLINOIS 61604

P:\316008007\EP99\5HT-9_RCP01001_VER08.dwg, 7/6/2009 11:34:15 AM