

F.A. RTE.	SECTION	COUNTY	TOTAL SHEETS	SHEET NO.
	08-00001-00-SW	PEORIA	33	1
FED. ROAD DIST. NO.	ILLINOIS	CONTRACT NO. 89507		

**STATE OF ILLINOIS
CITY OF ELMWOOD**

MORGAN STREET AREA IMPROVEMENT

**PROPOSED
HIGHWAY PLANS**

**VARIOUS ROUTES
SECTION 08-00001-00-SW
PROJECT HD-0557 (144)
JOB NO. C-94-124-08
PEORIA COUNTY**

INDEX OF SHEETS

- 1 COVER SHEET
- 2 GENERAL NOTES AND DETAILS
- 3 SUMMARY OF QUANTITIES
- 4-6 SCHEDULE OF QUANTITIES
- 7-12 TYPICAL SECTIONS
- 13 HORIZONTAL AND VERTICAL CONTROL
- 14-17 PLAN & PROFILES
- 18-26 DISTRICT STANDARDS
- 27-33 CROSS SECTIONS

LIST OF STANDARDS

- 000001-05 STANDARD SYMBOLS, ABBREVIATIONS AND PATTERNS
- 280001-04 TEMPORARY EROSION CONTROL SYSTEMS
- 424001-05 CURB RAMPS FOR SIDEWALKS
- 602301-02 INLET - TYPE A
- 602306-02 INLET - TYPE B
- 606001-04 CONCRETE CURB TYPE B AND COMBINATION CONCRETE CURB AND GUTTER
- 701501-05 URBAN LANE CLOSURE, 2L, 2W, UNDIVIDED
- 701901-01 TRAFFIC CONTROL DEVICES

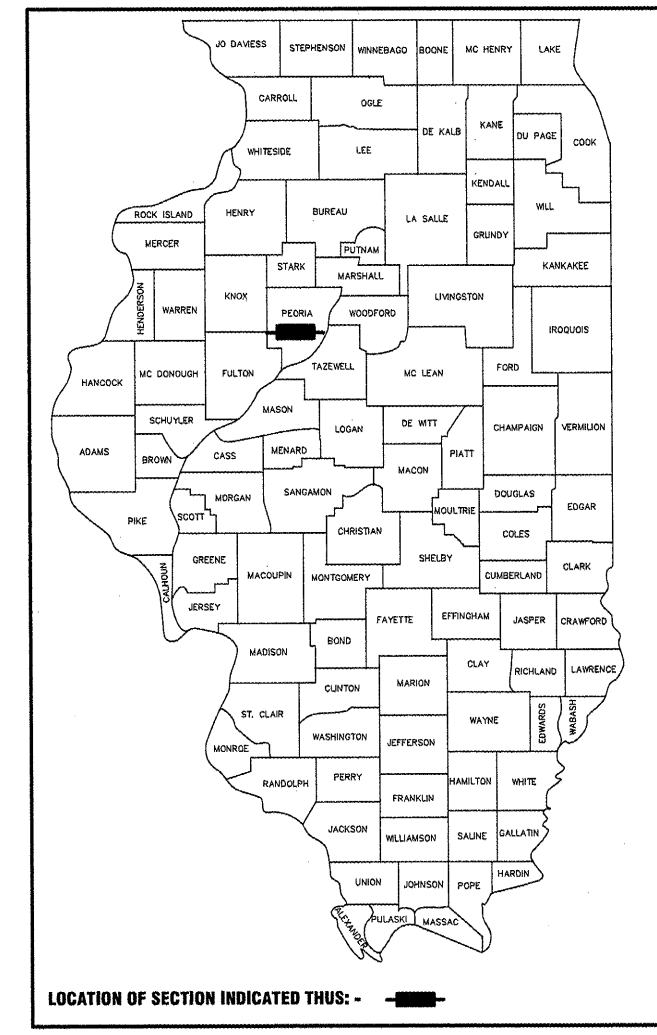

LOCATION OF SECTION INDICATED THUS: - -
DESCRIPTION: THE PROPOSED IMPROVEMENT INCLUDES HOT-MIX ASPHALT BASE COURSE WIDENING, COMBINATION CONCRETE CURB AND GUTTER, SIDEWALK, INLET REPLACEMENT, SEEDING, ETC.

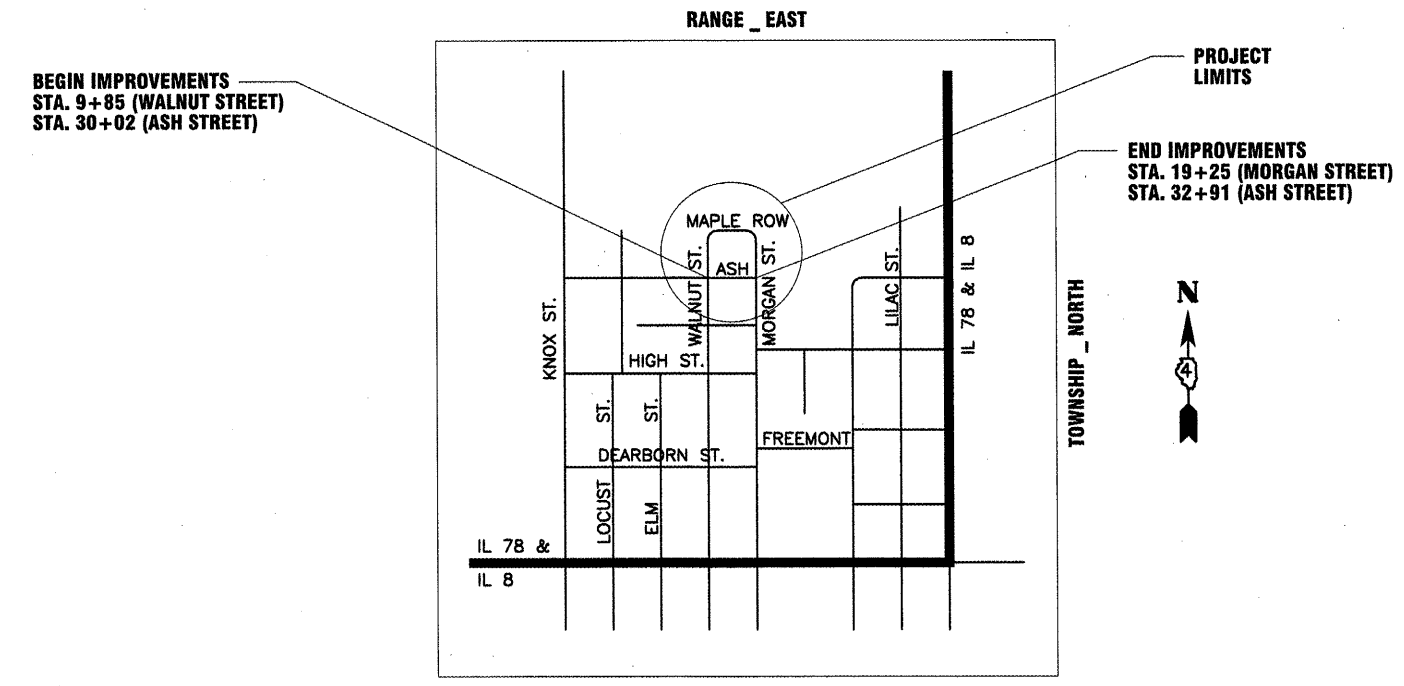

LOCATION MAP
NOT TO SCALE

LENGTH OF PROJECT = 1100 FT = 0.21 MILES

ROADWAY CLASSIFICATION: LOCAL ROADS
CURRENT ADT = ESTIMATED AT 200
DESIGN ADT = 200
DESIGN SPEED = 30 MPH
DESIGN GUIDELINES: 3R
VARIANCES: NONE
COMMITMENTS: NONE



Patrick N. Meyer
6/26/09
EXPIRES: 11/30/2009

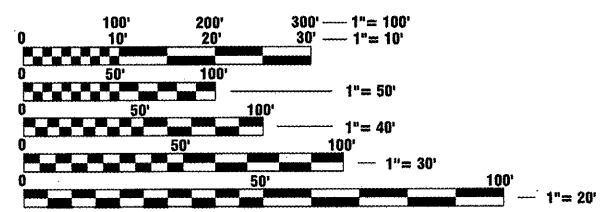

FULL SIZE PLANS HAVE BEEN PREPARED USING STANDARD ENGINEERING SCALES. REDUCED SIZED PLANS WILL NOT CONFORM TO STANDARD SCALES. IN MAKING MEASUREMENTS ON REDUCED PLANS, THE ABOVE SCALES MAY BE USED.

J.U.L.I.E.
JOINT UTILITY LOCATION INFORMATION FOR EXCAVATION
1-800-892-0123
OR 811

**PROJECT ENGINEER
PROJECT MANAGER**

CONTRACT NO. 89507

APPROVED	<i>[Signature]</i>	20 09
	LOCAL AGENCY OFFICIAL	
PASSED	<i>[Signature]</i>	20 09
	DISTRICT FOUR ENGINEER OF LOCAL ROADS & STREETS	
Releasing For Bid Based On Limited Review	<i>[Signature]</i>	20 09
	DEPUTY DIRECTOR OF HIGHWAYS, REGION THREE ENGINEER	
	STATE OF ILLINOIS DEPARTMENT OF TRANSPORTATION	

**PRINTED BY THE AUTHORITY
OF THE STATE OF ILLINOIS**