

McClure
 Engineering Associates, Inc.
 Macomb, Illinois 61455
 13091 833-4594 FAX 13091 837-9309
 714 East Jackson Street
 Design Firm License #184-008816 Copyright 2009 by McClure Engineering Associates, Inc.

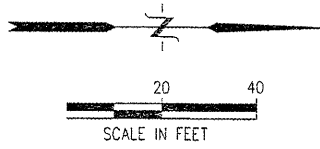

ITEM LEGEND

- ① PCC DRIVEWAY PAVEMENT, 6"
- ② PCC DRIVEWAY PAVEMENT, 7"
- ③ AGGREGATE SURFACE COURSE, TYPE A, 6"
- ④ PC CONCRETE SIDEWALK, 4"
- ⑤ COMB. CONC. CURB & GUTTER, TYPE B6.18
- ⑥ SIDEWALK RAMP W/ DETECTABLE WARNING
- ⑦ AGGREGATE SURFACE COURSE, TYPE A, 8"
- A MANHOLE, VALVE BOX, WATER SERVICE BOX OR METER VAULT TO BE ADJUSTED

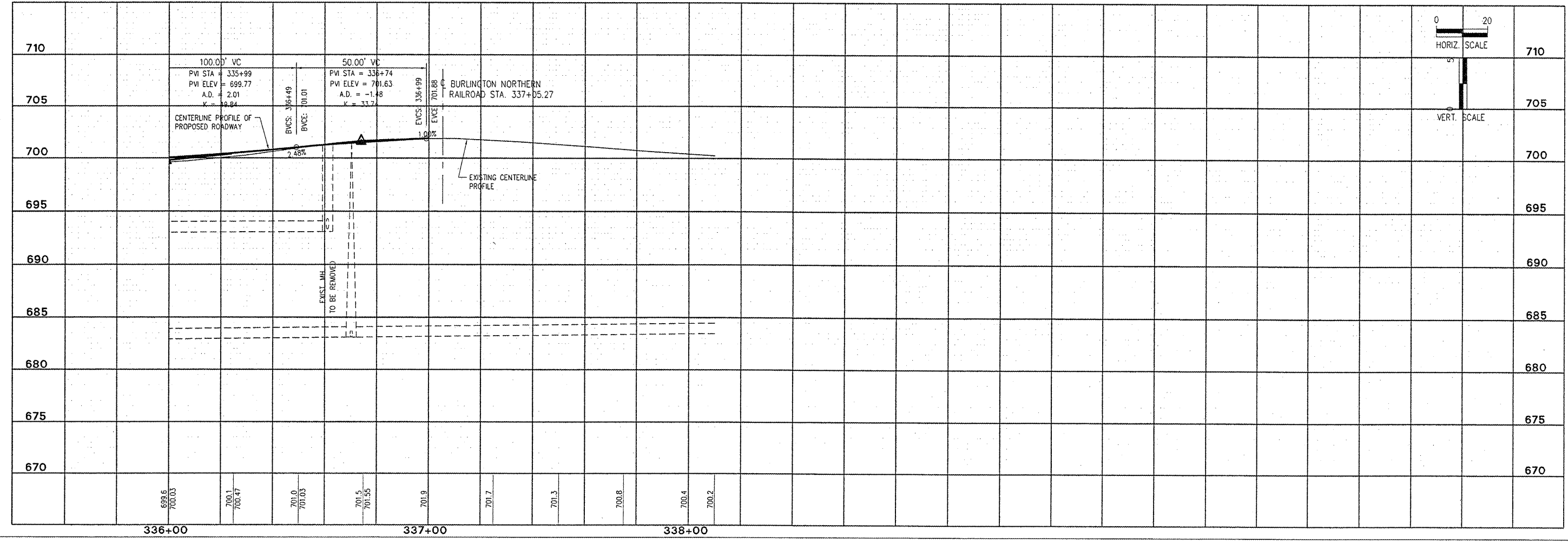
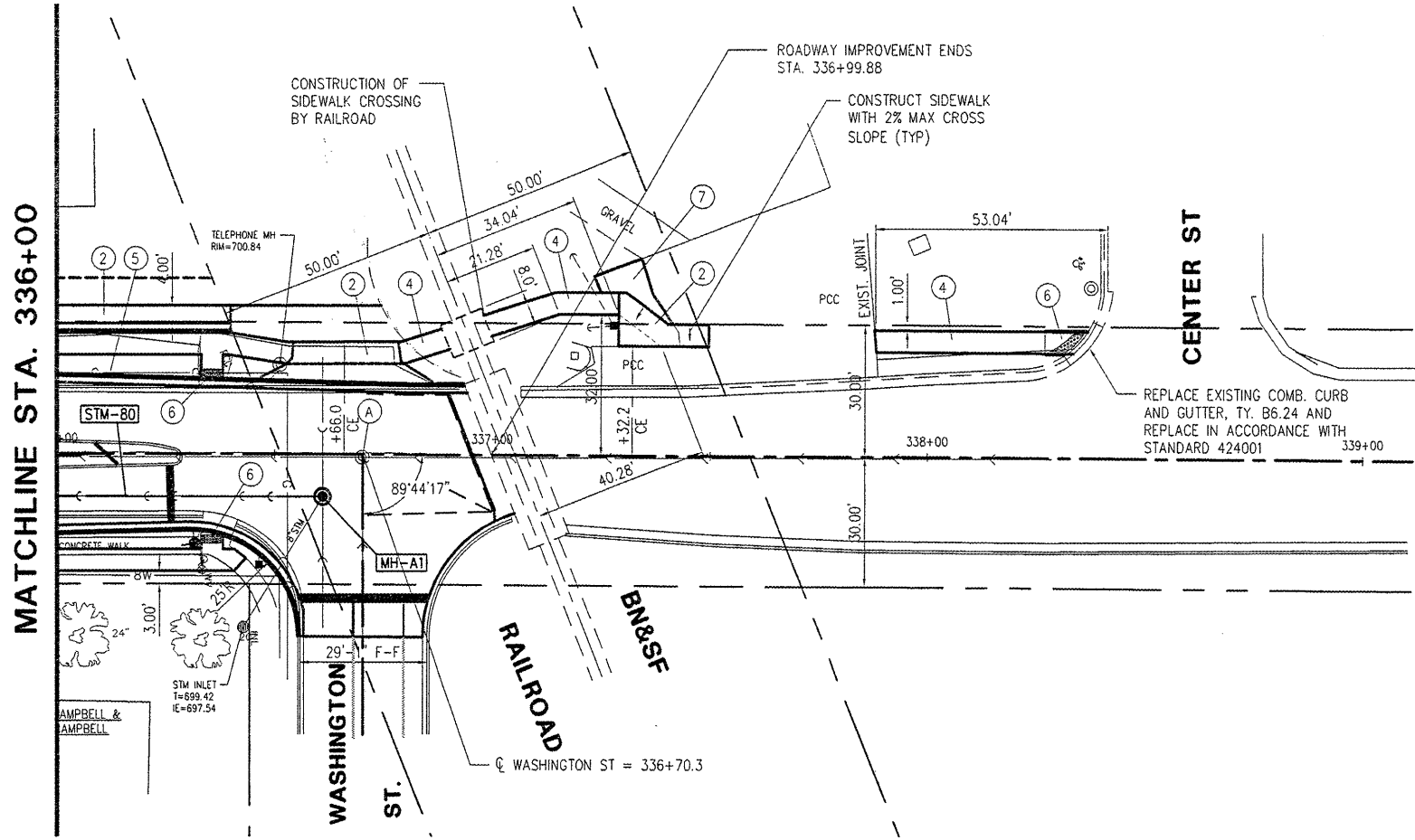

PLOTTING SCALE: 1" = 20'

DRAWN BY:	TAB
CHECKED BY:	JAR
DATE:	MARCH 2009

NO.	REVISIONS	DATE

WARD STREET IMPROVEMENTS - PHASE 2
PLAN AND PROFILE-STA. 336+00 TO 336+99.88
 CITY OF MACOMB
 SOUTH WARD ST.
 FILE NAME: \MACOMB\WARDST\PHASE 2\WARD-ST-PH2.DWG FIELD BOOK No. 2257 JOB NUMBER: 03-20-000908
 MACOMB, ILLINOIS