

| | | | |
|--|--------|--------------|-----------|
| SECTION | COUNTY | TOTAL SHEETS | SHEET NO. |
| 08-00072-00-RS | WABASH | 8 | 4 |
| FAU ROUTES 8655 & 8659 | | | |
| PROJECT M-ARA-5048(020) CONTRACT 95597 | | | |

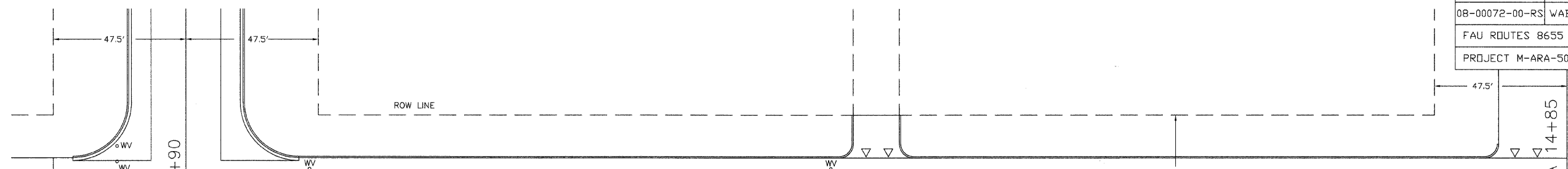

| PAY ITEM | ESTIMATED QUANTITY |
|--|--------------------|
| HOT-MIX ASPHALT SURFACE COURSE, MIX "C", N70 | 535 TON |
| HOT-MIX ASPHALT SURFACE REMOVAL, 2" | 4279 SQ YD |

MARKET STREET

(4279 SY)

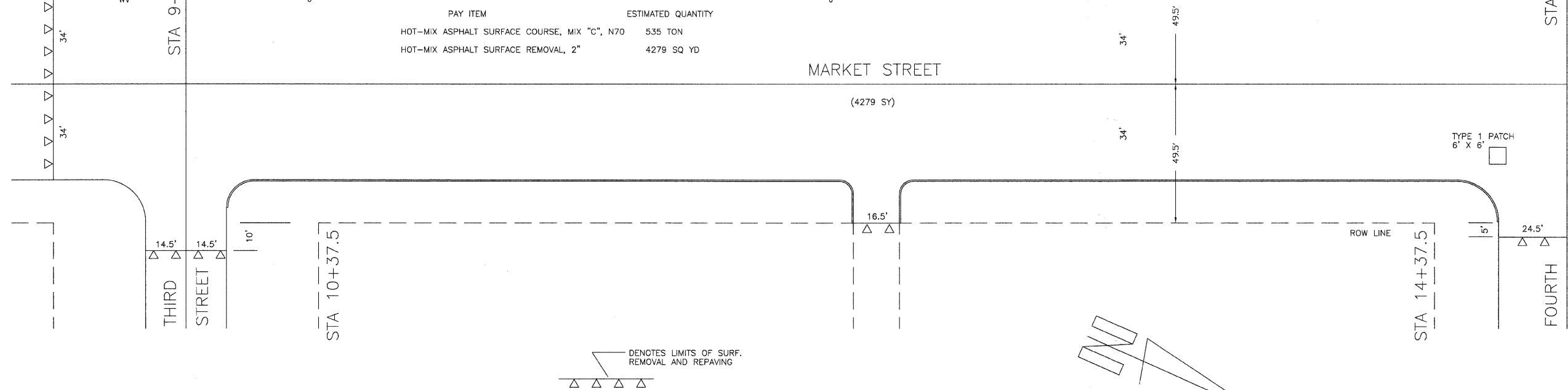

DENOTES LIMITS OF SURF. REMOVAL AND REPAVING

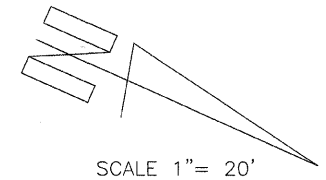

SCALE 1" = 20'

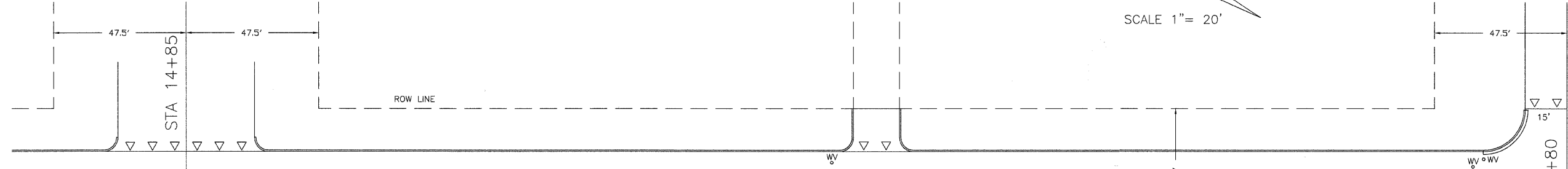

| PAY ITEM | ESTIMATED QUANTITY |
|--|--------------------|
| HOT-MIX ASPHALT SURFACE COURSE, MIX "C", N70 | 489 TON |
| HOT-MIX ASPHALT SURFACE REMOVAL, 2" | 3909 SQ YD |

MARKET STREET

(3909 SY)

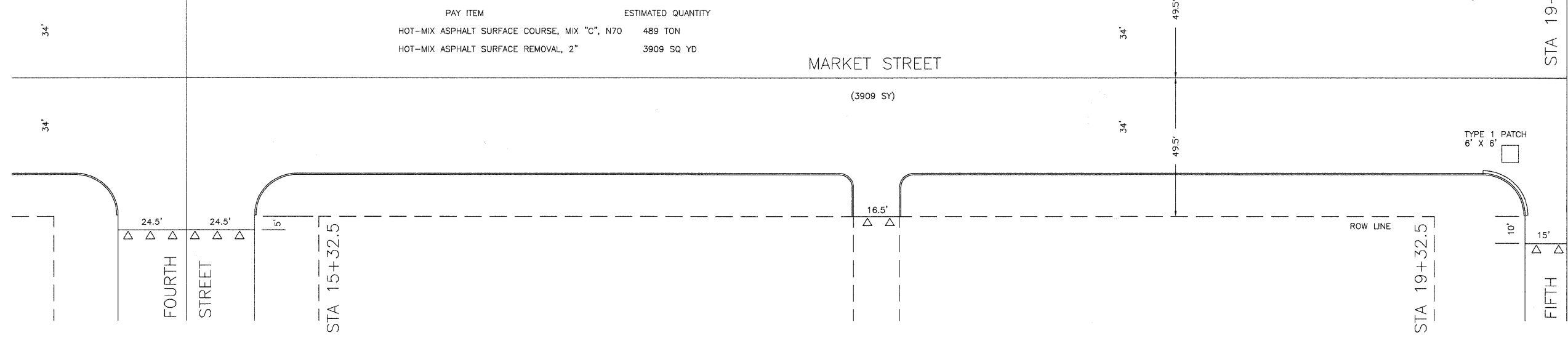

TYPE 1 PATCH 6' X 6'