

**CURVE 2**  
R = 300.00'  
L = 174.55'  
CB = N 79°05'30"E  
CH = 172.10'  
Δ = 33°20'12"

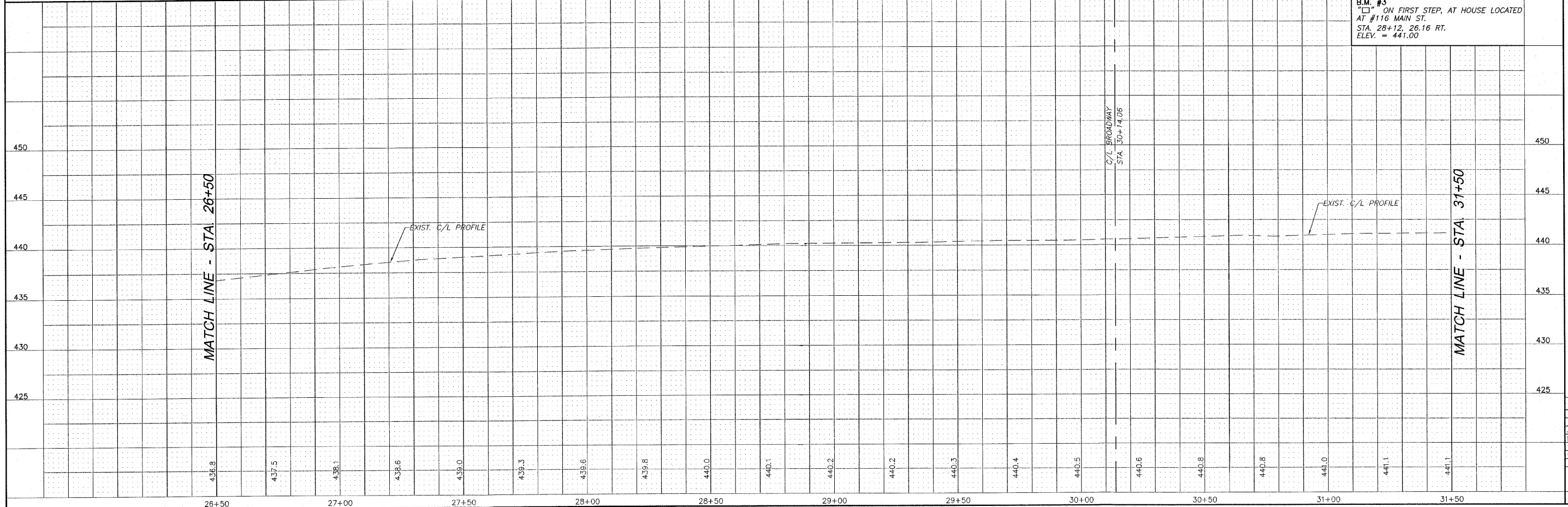
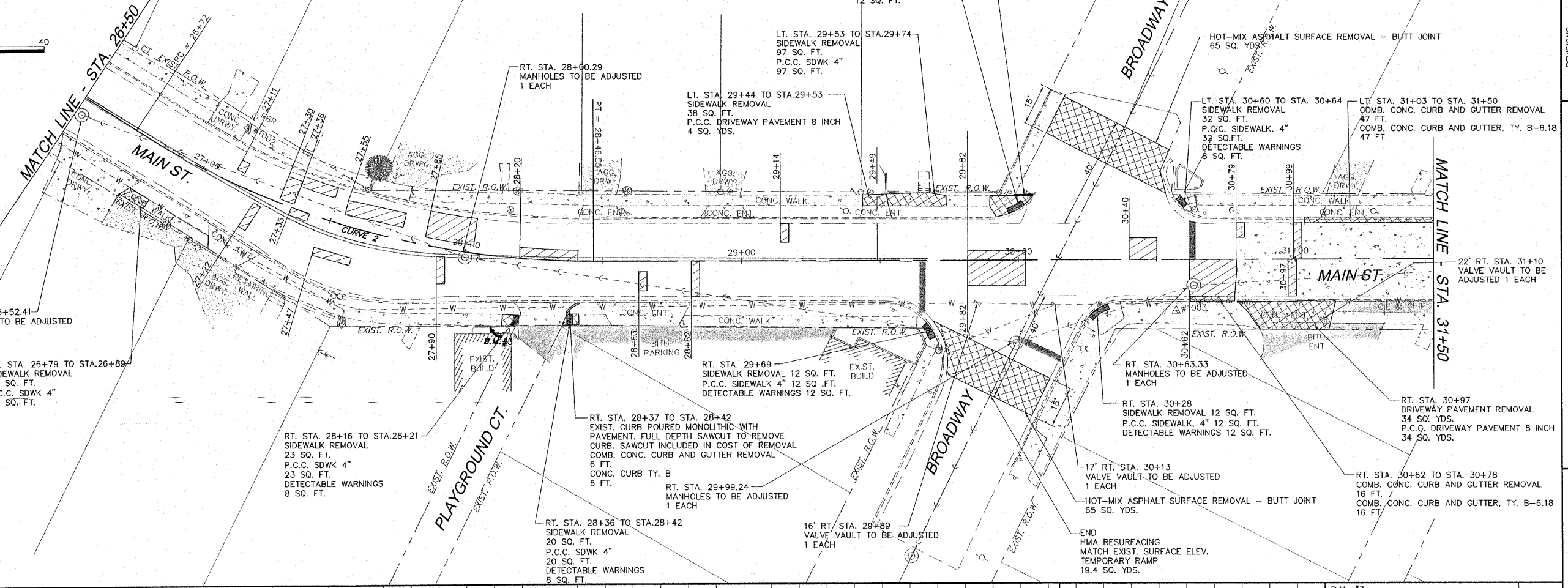

B.M. #3  
ON FIRST STEP, AT HOUSE LOCATED  
AT #116 MAIN ST.  
STA. 28+12, 26.16 RT.  
ELEV. = 441.00

REVISIONS

**SMS ENGINEERS**  
Sheppard, Morgan & Schwaab, Inc.  
CONSULTING ENGINEERS AND LAND SURVEYORS  
215 Market Street, P.O. Box E, Alton, IL 62002 618/462-9755 E-mail: mail@smsengineers.com  
10 Central Industrial Drive, Suite 3, Granite City, IL 62040 618/877-2700 E-mail: mail@smsengineers.com  
DESIGN FIRM # 184-000992

**EAST ALTON, ILLINOIS - MAIN STREET IMPROVEMENTS**  
**SECTION 09-00045-01-RS**  
**FAU ROUTE 8967**  
**PLAN AND PROFILE**

E ALTON MAIN ST PP3.DWG

REF. BK.	PG.
JOB NO. 227624.1	
DSN. BY: LDA	
DWN. BY: CDP	
CHK. BY: DEG	
DATE: MAY, 2009	
HORIZ: 1"=20'	
SCALE: VERT: 1"=5'	
SHEET 6	OF 9