

F.A.P. RTE.	SECTION	COUNTY	TOTAL SHEETS	SHEET NO.
06-00216-00-SW		ST. CLAIR	31	8

STA. 15+00.00	TO STA. 21+00.00
FED. ROAD DIST. NO. ILLINOIS	FED. AID PROJECT

EAST ST. LOUIS
PLAN AND PROFILE

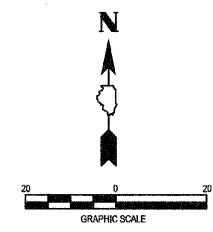

SECTION A
N.T.S.

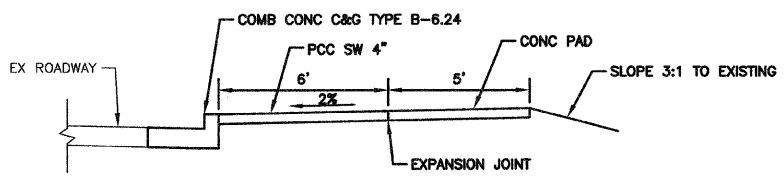

CURVE 1

PI =	19+35.44
DI =	30°39'39"
D =	1737'46"
R =	325.00'
T =	89.09'
L =	173.92'
E =	11.99'
PC =	18+46.34
PT =	20+20.26

DATE: _____ BY: _____

REVISIONS:

NO.	DATE	DESCRIPTION
-----	------	-------------

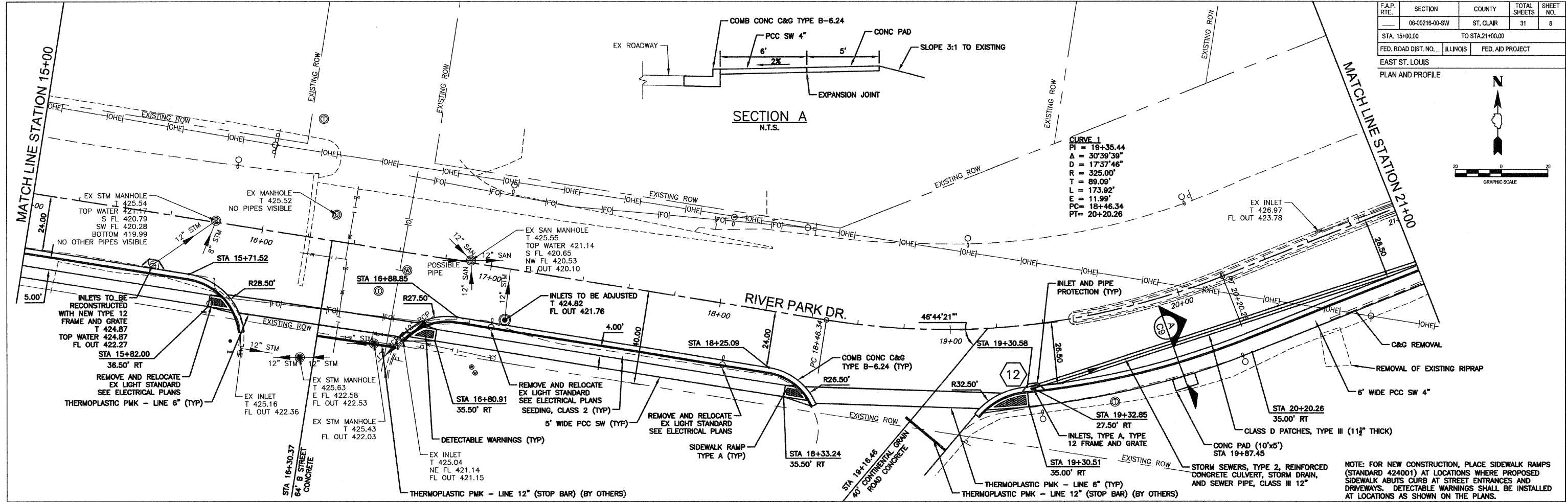

NOTE: FOR NEW CONSTRUCTION, PLACE SIDEWALK RAMPS (STANDARD 424001) AT LOCATIONS WHERE PROPOSED SIDEWALK ABUTS CURB AT STREET ENTRANCES AND DRIVEWAYS. DETECTABLE WARNINGS SHALL BE INSTALLED AT LOCATIONS AS SHOWN ON THE PLANS.

DATE: _____ BY: _____

REVISIONS:

NO.	DATE	DESCRIPTION
-----	------	-------------

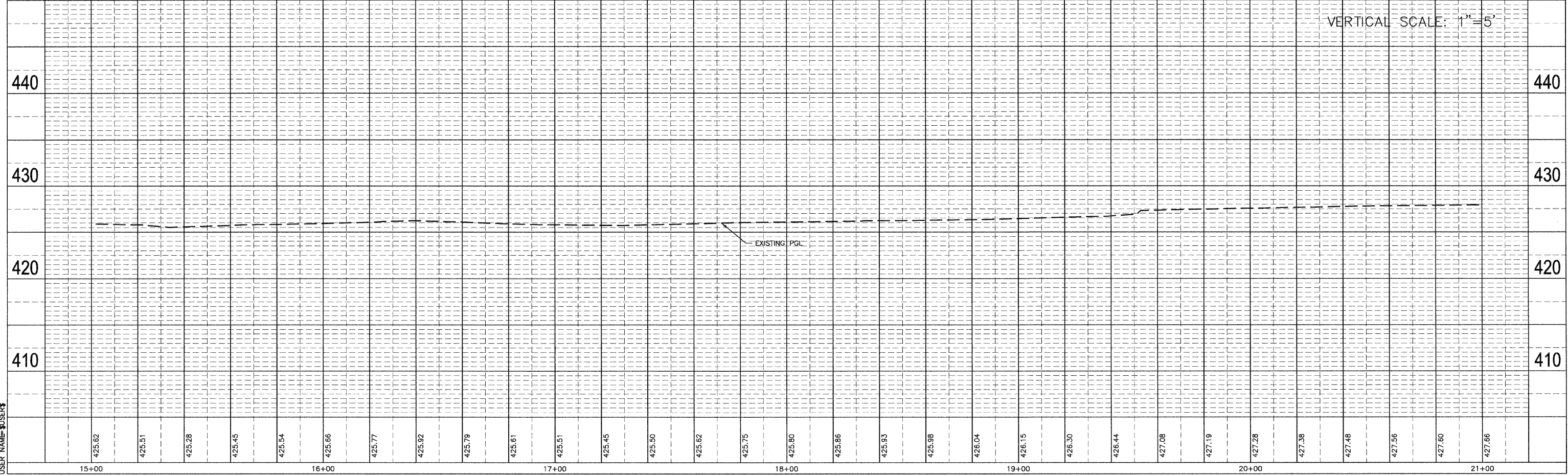

VERTICAL SCALE: 1" = 5'

PLOT DATE = \$DATE\$
FILE NAME = \$FILE\$
PLOT SCALE = \$SCALE\$
USER NAME = \$USER\$