

**STATE OF ILLINOIS  
DEPARTMENT OF TRANSPORTATION  
DIVISION OF HIGHWAYS**

# PLANS FOR PROPOSED ARRAMOTOR FUEL TAX PROJECT

**SECTION 09-00088-00-RS, CITY OF CARMI, WHITE COUNTY  
JOB NUMBER C-99-552-09 FEDERAL PROJECT NO. ARA-5010(010)**

SECTION	COUNTY	TOTAL SHEETS	SHEET NO.
09-00088-00-RS	WHITE	3	1
CITY OF CARMI	VARIOUS CITY STREETS		
FED. RD. DIST. NO. 9	LEC JOB NO. H091010CA		

CONTRACT 99402

323 W. 3RD ST.  
P.O. BOX 160  
MT. CARMEL, IL  
62863  
PHONE:  
(618)-262-8651  
FAX:  
(618)-263-3327

405 W. STATE ST.  
SUITE 1  
PRINCETON, IN  
47670  
PHONE:  
(812)-386-7611  
FAX:  
(812)-385-2812



PROFESSIONAL  
DESIGN FIRM  
LAND SURVEY &  
PROFESSIONAL  
ENGINEERING  
CORPORATION  
184-000887  
(62-032435)(35-002769)



AARON M. MEFFORD  
NAME  
*Aaron Mefford*  
SIGNATURE  
7-16-09  
DATE  
11-30-09  
EXPIRES

**INDEX OF SHEETS**

SHEET NO.	DESCRIPTION
1	TITLE SHEET, SUMMARY OF QUANTITIES
2	GENERAL NOTES, SCHEDULES, AND MISCELLANEOUS DETAILS
3	TYPICAL SECTIONS AND DETAILS OF INTERSECTIONS

**THE FOLLOWING STANDARDS ARE A PART OF THESE PLANS AND ARE INCLUDED IN THE PROPOSAL.**

000001-05	STANDARD SYMBOLS, ABBREVIATIONS & PATTERNS
701501-05	URBAN LANE CLOSURE 2L, 2W UNDIVIDED
701901-01	TRAFFIC CONTROL DEVICES

**SUMMARY OF QUANTITIES**

CODE NO.	ITEM	UNIT	QUANTITY
40600100	BITUMINOUS MATERIALS (PRIME COAT)	GALLON	596.00
40603310	HOT-MIX ASPHALT SURFACE COURSE, MIX "C", N50	TON	1700.00
44300100	AREA REFLECTIVE CRACK CONTROL TREATMENT	SQ YD	6055.00
48101200	AGGREGATE SHOULDERS, TYPE B	TON	50.00
60266600	VALVE BOXES TO BE ADJUSTED	EACH	3.00
60300305	FRAMES AND LIDS TO BE ADJUSTED	EACH	9.00
*67100100	MOBILIZATION	L SUM	1.00

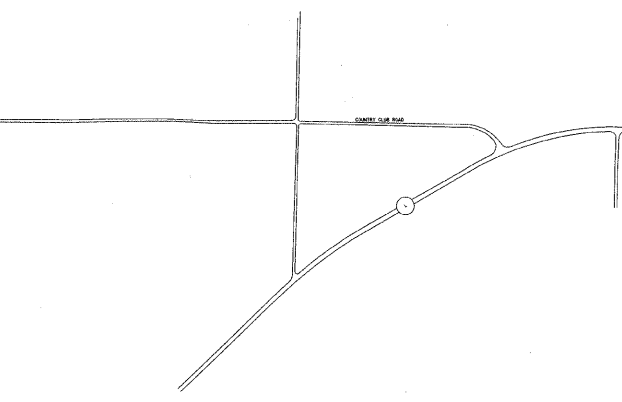
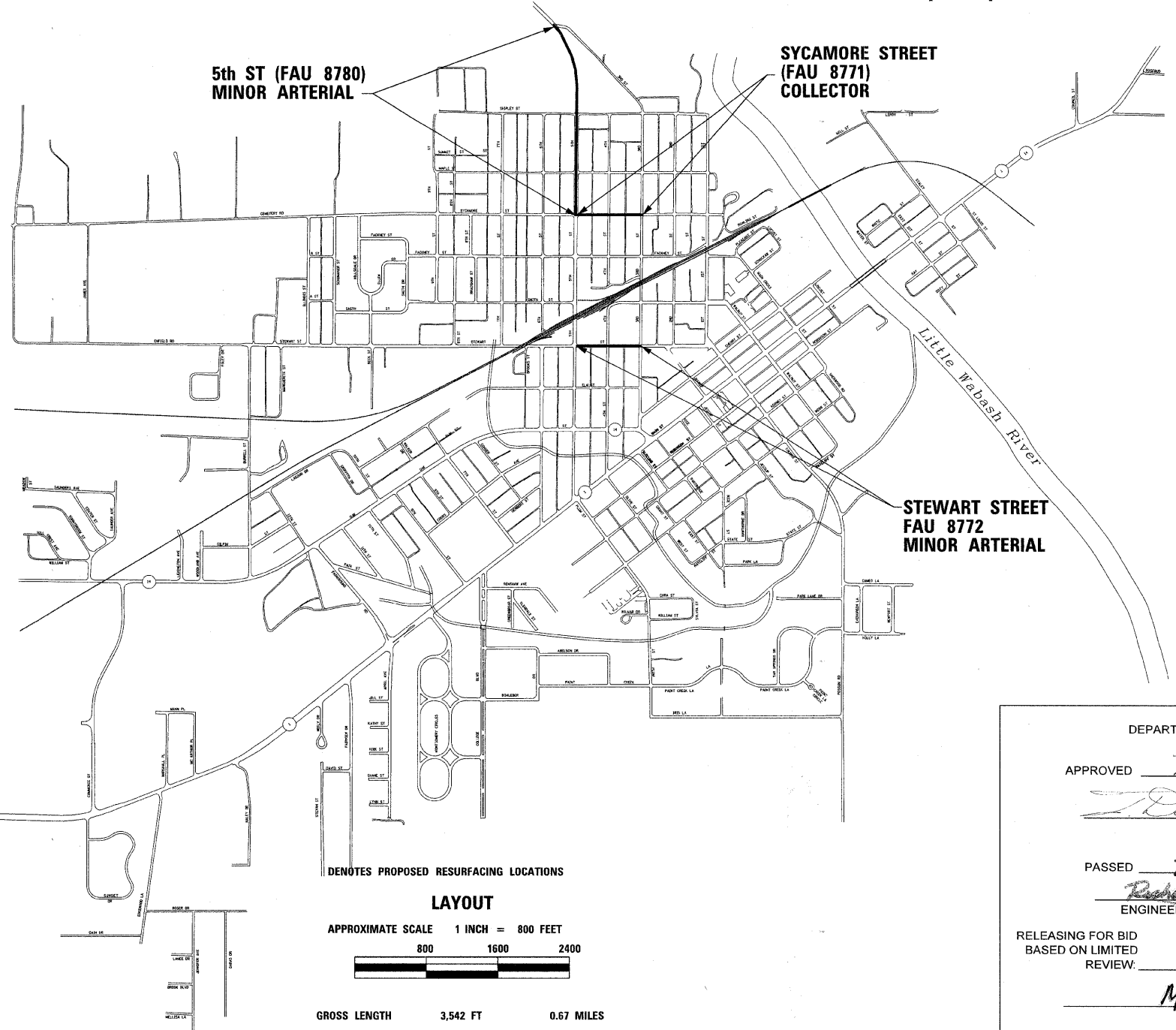

CONTRACT# 99402  
DESIGN CLASS - LOCAL ROAD  
CURRENT A.D.T. = VARIES (PER STREET)

DENOTES PROPOSED RESURFACING LOCATIONS

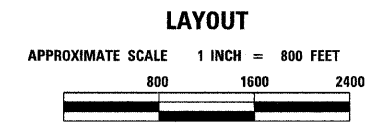

GROSS LENGTH	3,542 FT	0.67 MILES
OMISSION	0 FT	0 MILES
NET LENGTH	3,542 FT	0.67 MILES

STATE OF ILLINOIS  
DEPARTMENT OF TRANSPORTATION

APPROVED 7-16-09  
*David R. ...*  
MAYOR

PASSED 7-22-2009  
*Richard W. ...*  
ENGINEER OF LOCAL ROADS AND STREETS

RELEASING FOR BID  
BASED ON LIMITED  
REVIEW: 7-22-09  
*Mary C. Lamie*  
MARY C. LAMIE, P.E.  
DEPUTY DIRECTOR OF HIGHWAYS  
REGION FIVE ENGINEER

SECTION	COUNTY	TOTAL SHEETS	SHEET NO.
09-00088-00-RS	WHITE	3	2
CITY OF CARM	VARIOUS CITY STREETS		
FED. RD. DIST. NO. 9	LEC JOB NO. H091010CA		

CONTRACT 99402

**TYPICAL ENTRANCE DETAILS PROPOSED**

ALLEY, DRIVEWAY & SIDE STREET INTERSECTIONS

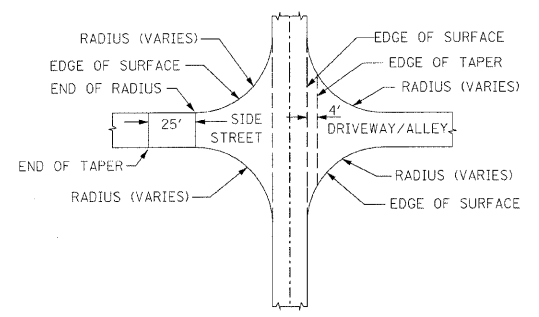

**GENERAL NOTES:**

THIS SECTION CONSISTS OF RESURFACING, AND OTHER MISCELLANEOUS ITEMS NECESSARY TO COMPLETE THE PROJECT. ALL IN ACCORDANCE WITH THE PLANS, SPECIAL PROVISIONS AND "STANDARD SPECIFICATIONS FOR ROAD AND BRIDGE CONSTRUCTION" ADOPTED JANUARY 1, 2007.

THE QUANTITY SHOWN IN THE SUMMARY OF QUANTITIES FOR HOT-MIX ASPHALT SURFACE COURSE, MIX "C", N50, WAS CALCULATED USING 112 POUNDS PER SQUARE YARD FOR ONE INCH OF THICKNESS.

THE HOT-MIX ASPHALT SURFACE COURSE MIX "C", N50 SHALL HAVE A NOMINAL THICKNESS OF 2 1/2" ON SYCAMORE AND STEWART STREETS AND A NOMINAL THICKNESS OF 2" ON 5th STREET. THE HOT-MIX ASPHALT SURFACE COURSE MIX "C", N50 SHALL BE PLACED IN TWO LIFTS WITH THE TOP LIFT HAVING MINIMUM THICKNESS OF 1 1/4" ON ALL STREETS.

HOT-MIX ASPHALT TAPERS FROM 2 1/2" TO 0" SHALL BE CONSTRUCTED FROM THE END OF EACH RADIUS ON EACH OF THE SIDE ROADS AS SHOWN ON THIS PAGE OR AS DIRECTED BY THE ENGINEER ON SYCAMORE AND STEWART STREETS SIDE ROADS.

HOT-MIX ASPHALT TAPERS FROM 2" TO 0" SHALL BE CONSTRUCTED FROM THE END OF EACH RADIUS ON EACH OF THE SIDE ROADS AS SHOWN ON THIS PAGE OR AS DIRECTED BY THE ENGINEER ON 5th STREETS SIDE ROADS.

THE QUANTITY SHOWN IN THE SUMMARY OF QUANTITIES FOR BITUMINOUS MATERIALS (PRIME COAT) ALLOWS FOR A COVERAGE OF 0.05 GAL/SQ YD.

**TYPICAL SIDE STREET TAPER DETAIL**

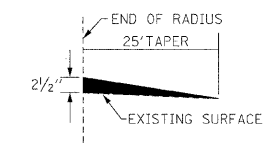

323 W. 3RD ST.  
P.O. BOX 160  
MT. CARMEL, IL  
62863  
PHONE:  
(618)-282-8651  
FAX:  
(618)-263-3327

405 W. STATE ST.  
SUITE 1  
PRINCETON, IN  
47670  
PHONE:  
(812)-386-7611  
FAX:  
(812)-385-2812



PROFESSIONAL DESIGN FIRM  
LAND SURVEY & PROFESSIONAL ENGINEERING CORPORATION  
184-000887  
(62-032435)(35-002769)

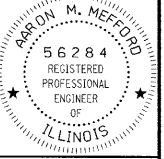

AARON M. MEFFORD  
NAME  
*Aaron Mefford*  
SIGNATURE  
7-16-09  
DATE  
11-30-09  
EXPIRES

**UTILITIES TO BE ADJUSTED**

STREET	QUANTITY & DESCRIPTION
SYCAMORE STREET	4 MH
STEWART STREET	1 MH
STEWART STREET	1 WV
5TH STREET	4 MH
5TH STREET	2 WV

NOTE: THE SCHEDULE ABOVE INCLUDES KNOWN MANHOLES, WATER VALVE BOXES, AND STORM INLETS AND WILL BE PAID FOR AT THE CONTRACT UNIT PRICE FOR THE RESPECTIVE ITEM. THE ABOVE QUANTITIES ARE SHOWN IN THE RESPECTIVE PAY ITEMS TO BE ADJUSTED IN THE SUMMARY OF QUANTITIES.

**SCHEDULE OF NET LENGTH**

STREET	FAU ROUTE	FROM	TO	NET LENGTH (FT)
SYCAMORE ST	FAU 8771	5th ST	4th ST	356'
SYCAMORE ST	FAU 8771	4th ST	3rd ST	367'
STEWART ST	FAU 8772	5th ST	4th ST	347'
STEWART ST	FAU 8772	4th ST	3rd ST	370'
5th ST	FAU 8780	3rd ST	SHIPLEY ST	966'
5th ST	FAU 8780	SHIPLEY ST	MAPLE ST	754'
5th ST	FAU 8780	MAPLE ST	SYCAMORE ST	382'

**UTILITIES**

CENTRAL ILLINOIS PUBLIC SERVICE 207 N. WALNUT ST. ONLEY, IL 62450 618-383-2121	CITY OF CARM MUNICIPAL BUILDING 225 E. MAIN CARM, IL 62821 618-382-5555	CONSUMERS GAS 328 INDUSTRIAL AVE. CARM, IL 62821 618-382-4158	GENERAL TELEPHONE CO. 208 WEST UNION ST. MARION, IL 62959 800-232-2544	CAPITAL CABLE 7246 MAIN ST. WADESVILLE, IN 47638 800-729-5660	J.U.L.I.E. 800-892-0123
---	---	--	---	--	----------------------------

**TYPICAL SURFACE TO GUTTER TAPER DETAIL**

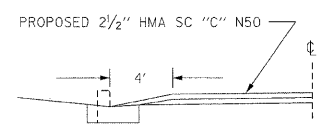

SECTION	COUNTY	TOTAL SHEETS	SHEET NO.
09-00088-00-RS	WHITE	3	3
CITY OF CARMEL	VARIOUS CITY STREETS		
FED. RD. DIST. NO. 9	LEC JOB NO. H091010CA		

CONTRACT 99402

323 W. 3RD ST.  
P.O. BOX 160  
MT. CARMEL, IL  
62863  
PHONE: (618)-262-8651  
FAX: (618)-263-3327

405 W. STATE ST.  
SUITE 1  
PRINCETON, IN  
47570  
PHONE: (812)-386-7611  
FAX: (812)-385-2812



PROFESSIONAL DESIGN FIRM  
LAND SURVEY & PROFESSIONAL ENGINEERING CORPORATION  
184-000887  
(62-032435)(35-002769)

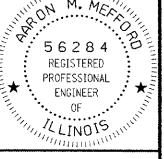

AARON M. MEFFORD  
NAME  
*Aaron Mefford*  
SIGNATURE  
7-16-09  
DATE  
11-30-09  
EXPIRES

SYCAMORE FROM THIRD TO FIFTH ST

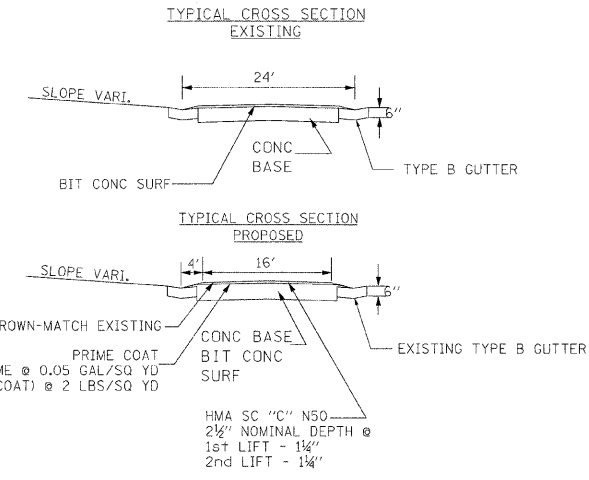
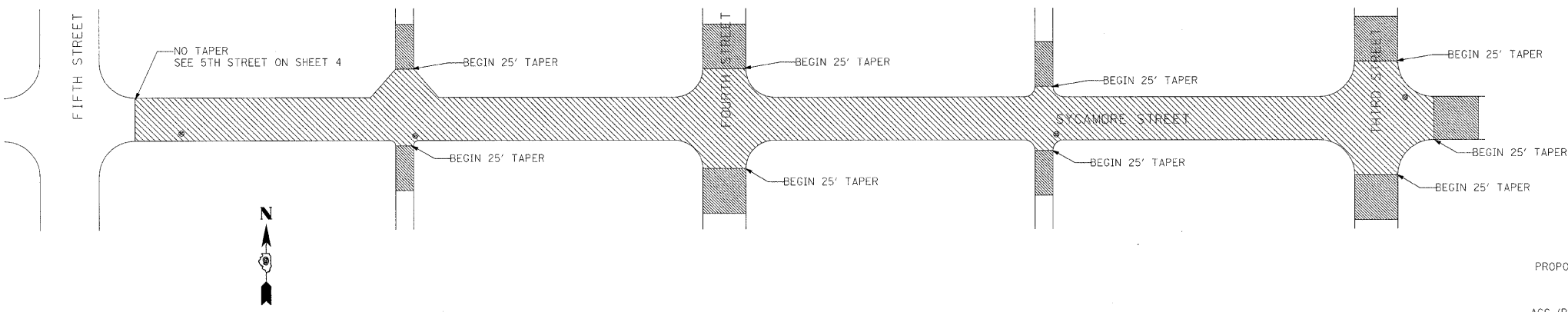

STEWART STREET FROM THIRD TO FIFTH ST

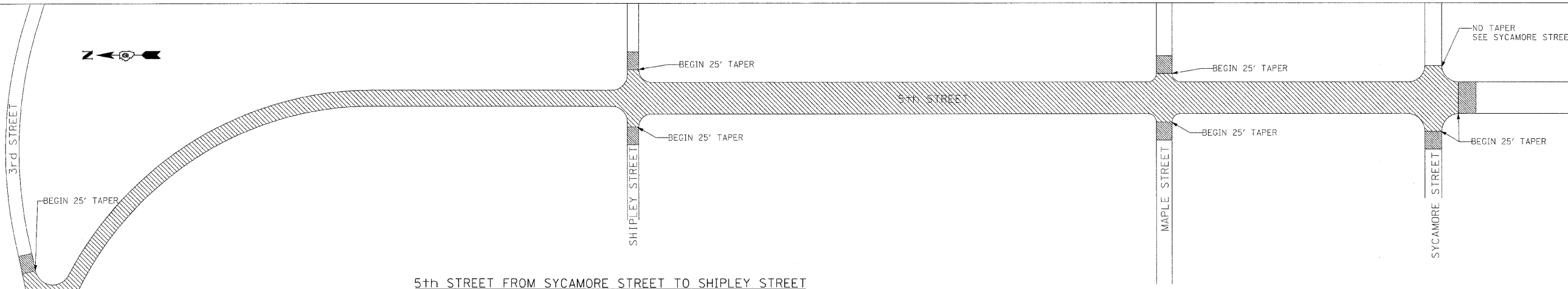
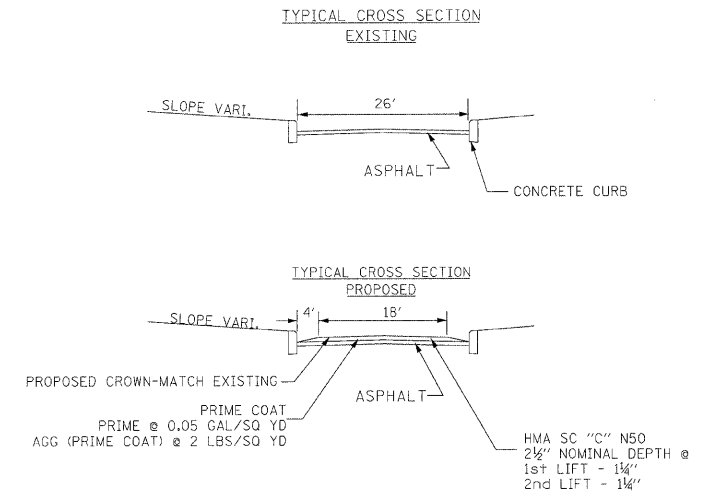
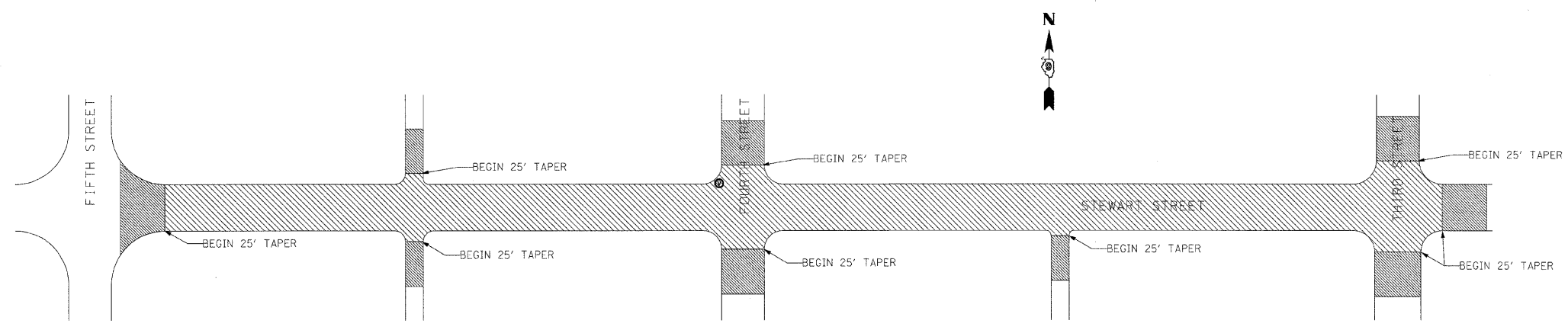

5th STREET FROM SYCAMORE STREET TO SHIPLEY STREET

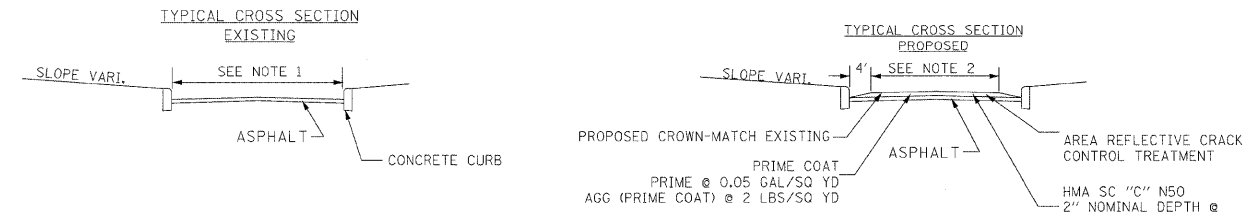

- NOTES:
- 36' WIDE IN TAPER SOUTH OF SYCAMORE ST. AND 44.1' WIDE FROM SYCAMORE NORTH TO SHIPLEY ST.
  - 28' WIDE IN TAPER SOUTH OF SYCAMORE ST. AND 36.1' WIDE FROM SYCAMORE NORTH TO SHIPLEY ST.

5th STREET FROM SHIPLEY STREET TO 3RD STREET

