

STATE OF ILLINOIS
DEPARTMENT OF TRANSPORTATION

| F.A.U. RTE. | SECTION | COUNTY | TOTAL SHEETS | SHEET NO. |
|-------------|------------|----------|--------------------|-----------|
| 1600 | 2020-119-1 | COOK | 14 | 1 |
| | | ILLINOIS | CONTRACT NO. 62L97 | |

D-91-519-20

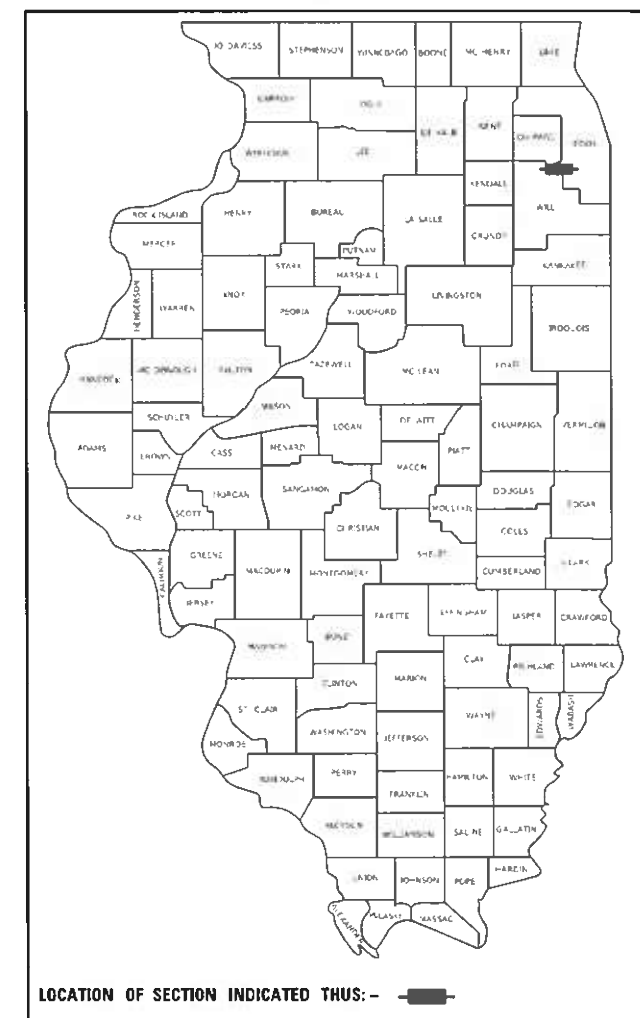

FOR INDEX OF SHEETS, SEE SHEET NO. 2

THIS PROJECT IS LOCATED IN UNINCORPORATED ORLAND PARK TOWNSHIP AND THE VILLAGE OF ORLAND PARK

PROPOSED
HIGHWAY PLANS

FAU ROUTE 1600: IL 7 (143RD STREET)
WILL-COOK ROAD TO SOUTHWEST HIGHWAY
SECTION: 2020-119-1
PROJECT: STP-4CJN(786)
CRACK AND JOINT SEALING
COOK COUNTY
C-91-317-20

TRAFFIC DATA:

IL 7:
PROJECT BEGIN TO PROJECT END:
ADT (2019) = 14800
SPEED LIMIT = 35 MPH

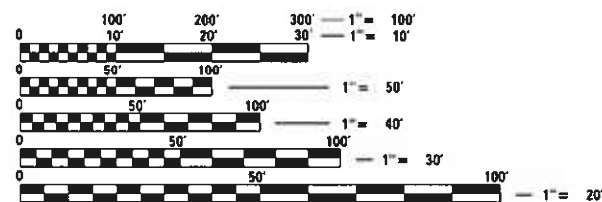

FULL SIZE PLANS HAVE BEEN PREPARED USING STANDARD ENGINEERING SCALES. REDUCED SIZED PLANS WILL NOT CONFORM TO STANDARD SCALES. IN MAKING MEASUREMENTS ON REDUCED PLANS, THE ABOVE SCALES MAY BE USED.

J.U.L.I.E.
JOINT UTILITY LOCATION INFORMATION FOR EXCAVATION
1-800-892-0123
OR 811

PROJECT BEGINS
STA 15+19

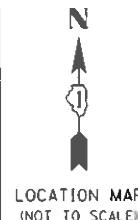
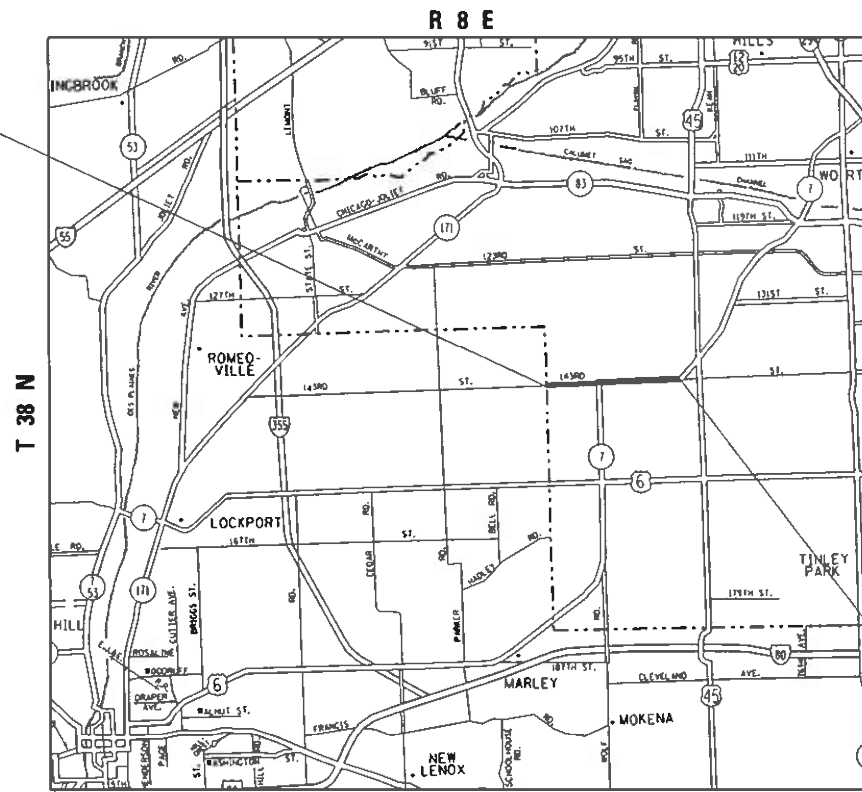

PROJECT ENDS
STA 155+16

GROSS LENGTH = 13,728 FT. = 2.6 MILES
NET LENGTH = 13,728 FT. = 2.6 MILES

PROJECT ENGINEER: VESELIN VELICHKOV (847) 705-4432
PROJECT MANAGER: FAWAD AQUEEL (847) 705-4247

CONTRACT NO. 62L97

STATE OF ILLINOIS
DEPARTMENT OF TRANSPORTATION

SUBMITTED June 18, 2020
Christy J. Doughty/AS
REGIONAL ENGINEER

August 14, 2020
Scott A. Elk
ENGINEER OF DESIGN AND ENVIRONMENT

August 14, 2020
James J. Gu
DIRECTOR OF HIGHWAYS PROJECT IMPLEMENTATION

PRINTED BY THE AUTHORITY
OF THE STATE OF ILLINOIS

INDEX OF SHEETS

| <u>SHEET NO.</u> | <u>DESCRIPTION</u> |
|------------------|-------------------------------------------------------------------------------------|
| 1 | TITLE SHEET |
| 2 | INDEX OF SHEETS, STATE STANDARDS AND GENERAL NOTES |
| 3 | SUMMARY OF QUANTITIES |
| 4 | CRACK AND JOINT SEALING DETAIL |
| 5-10 | PROPOSED ROADWAY AND PAVEMENT MARKING PLANS |
| 11 | TRAFFIC CONTROL AND PROTECTION FOR SIDE ROADS, INTERSECTIONS, AND DRIVEWAYS (TC-10) |
| 12 | DISTRICT ONE TYPICAL PAVEMENT MARKINGS (TC-13) |
| 13 | TRAFFIC CONTROL AND PROTECTION AT TURN BAYS (TO REMAIN OPEN TO TRAFFIC) (TC-14) |
| 14 | ARTERIAL ROAD INFORMATION SIGNING (TC-22) |

HIGHWAY STANDARDS

| | |
|-----------|---------------------------------------------------|
| 000001-07 | STANDARD SYMBOLS, ABBREVIATIONS AND PATTERNS |
| 701301-04 | LANE CLOSURE, 2L, 2W, SHORT TIME OPERATIONS |
| 701311-03 | LANE CLOSURE, 2L, 2W, MOVING OPERATIONS-DAY ONLY |
| 701501-06 | URBAN LANE CLOSURE |
| 701701-10 | URBAN SINGLE LANE CLOSURE, MULTILANE INTERSECTION |
| 701801-06 | SIDEWALK, CORNER OR CROSSWALK CLOSURE |
| 701901-08 | TRAFFIC CONTROL DEVICES |

GENERAL NOTES

- 1) BEFORE STARTING ANY EXCAVATION, THE CONTRACTOR SHALL CALL "J.U.L.I.E.". AT (800) 892-0123 OR 811 FOR FIELD LOCATIONS OF BURIED ELECTRIC, TELEPHONE AND GAS UTILITIES. 48 HOUR NOTIFICATION IS REQUIRED.
- 2) THE CONTRACTOR SHALL COORDINATE CONSTRUCTION ACTIVITIES WITH UTILITY COMPANIES OF THE VILLAGE OF ORLAND PARK.
- 3) ALL DAMAGE TO EXISTING PAVEMENT MARKINGS OR RAISED REFLECTIVE PAVEMENT MARKERS OUTSIDE THE REMOVAL LINE SHOWN ON THE PLANS SHALL BE REPLACED AT NO ADDITIONAL COST TO THE DEPARTMENT.
- 4) THE CONTRACTOR WILL NOT BE ALLOWED TO SET UP A YARD OR FIELD OFFICE ON STATE PROPERTY WITHOUT WRITTEN PERMISSION FROM THE DEPARTMENT.
- 5) IT SHALL BE THE CONTRACTOR'S RESPONSIBILITY TO VERIFY ALL DIMENSIONS AND CONDITIONS EXISTING IN THE FIELD PRIOR TO CONSTRUCTION AND ORDERING OF MATERIALS.
- 6) THE CONTRACTOR SHALL CONTACT THE DISTRICT ONE TRAFFIC CONTROL SUPERVISOR AT KALPANA.KANNAN-HOSADURGA@ILLINOIS.GOV A MINIMUM OF 72 HOURS IN ADVANCE OF BEGINNING WORK.
- 7) THE ENGINEER SHALL CONTACT PATRICE HARRIS AREA TRAFFIC FIELD ENGINEER AT PATRICE.HARRIS@ILLINOIS.GOV A MINIMUM OF TWO (2) WEEKS PRIOR TO THE PLACEMENT OF PERMANENT PAVEMENT MARKINGS.
- 8) ALL CRACK ROUTING & CRACK SEALING LOCATIONS WILL BE DETERMINED IN THE FIELD BY THE ENGINEER. CRACK ROUTING SHALL BE OMITTED WHERE VEHICLE DETECTOR LOOPS & RAISED REFLECTIVE PAVEMENT MARKERS ARE PRESENT IN THE PAVEMENT.
- 9) MATERIALS RESULTING FROM THE ROUTING OF CRACKS IN THE EXISTING PAVEMENT MAY BE PLACED, SHAPED AND COMPACTED TO THE SATISFACTION OF THE ENGINEER ALONG EXISTING AGGREGATE SHOULDERS ADJACENT TO THE PAVEMENT. ALL MATERIALS RESULTING FROM THE ROUTING OF CRACKS IN PAVEMENTS WITHOUT AGGREGATE SHOULDERS AND SURPLUS MATERIALS RESULTING FROM THE ROUTING OF CRACKS IN PAVEMENTS WITH AGGREGATE SHOULDERS, WHERE ALL MATERIALS ARE NOT PLACED ALONG EXISTING AGGREGATE SHOULDERS, SHALL BE DISPOSED OF AS SPECIFIED IN ARTICLE 202.03 OF THE STANDARD SPECIFICATIONS. OLD SEALANTS REMOVED PRIOR TO ROUTING SHALL BE DISPOSED OF AS SPECIFIED IN ARTICLE 202.03. THIS WORK WILL NOT BE PAID FOR SEPARATELY, BUT THE COST SHALL BE CONSIDERED AS INCLUDED IN THE CONTRACT UNIT PRICE FOR THE CONSTRUCTION ITEMS INVOLVED, AND NO ADDITIONAL COMPENSATION WILL BE ALLOWED.
- 10) MODIFIED URETHANE PAVEMENT MARKING SHALL BE PLACED IMMEDIATELY AFTER CRACK AND JOINT SEALER TEMPERATURE HAS COOLED DOWN AND DOES NOT AFFECT THE APPLICATION OF THE MODIFIED URETHANE PAVEMENT MARKING.
- 11) DO NOT SCALE PLANS FOR CONSTRUCTION DIMENSIONS.

MODEL: Default
FILE: h:\mhc\p\suplanroom.d\illinois.gov\PWIDOT\Documents\DOT_Offices\District 1\Projects\151920\CaddData\Design\151920-sh-egenerac.dgn

| | | | | | | | | | |
|-------------------------------|------------|-----------|-----------------------------------------------------------|---------------------------------------------------------------------------------------------------------------|---------------------------|---------|--------|--------------|-----------|
| USER NAME = hamwim | DESIGNED - | REVISED - | STATE OF ILLINOIS DEPARTMENT OF TRANSPORTATION | IL 7 (143RD ST) WILL-COOK RD TO SOUTHWEST HWY INDEX OF SHEETS, STATE STANDARDS & GENERAL NOTES | F.A.U. RTE. | SECTION | COUNTY | TOTAL SHEETS | SHEET NO. |
| DRAWN - | REVISED - | 1600 | | | 2020-119-I | COOK | 14 | 2 | |
| PLOT SCALE = 100,0000 ' / in. | CHECKED - | REVISED - | | | CONTRACT NO. 62L97 | | | | |
| PLOT DATE = 6/25/2020 | DATE - | REVISED - | | | ILLINOIS FED. AID PROJECT | | | | |
| | | | | SCALE: | SHEET | OF | SHEETS | STA. | TO STA. |

| SUMMARY OF QUANTITIES | | | | CONSTRUCTION TYPE CODE | | | | | SUMMARY OF QUANTITIES | | | | CONSTRUCTION TYPE CODE | | | | |
|-----------------------|-------------------------------------------------------------|--------|------------------------|------------------------------|--|--|--|--|-----------------------|--------------------------------------------------|-------|------------------------|------------------------------|--|--|--|------------------|
| CODE NO | ITEM | UNIT | TOTAL QUANTITIES URBAN | 0005 80% FED 20% STATE | | | | | CODE NO | ITEM | UNIT | TOTAL QUANTITIES URBAN | 0005 80% FED 20% STATE | | | | |
| 45100100 | CRACK ROUTING (PAVEMENT) | FOOT | 14184 | 14184 | | | | | * 78009008 | MODIFIED URETHANE PAVEMENT MARKING - LINE 8" | FOOT | 1377 | 1377 | | | | |
| 45100200 | CRACK FILLING | POUND | 10,831 | 10,831 | | | | | * 78009012 | MODIFIED URETHANE PAVEMENT MARKING - LINE 12" | FOOT | 1139 | 1139 | | | | |
| 67000400 | ENGINEER'S FIELD OFFICE, TYPE A | CAL MO | 3 | 3 | | | | | * 78009024 | MODIFIED URETHANE PAVEMENT MARKING - LINE 24" | FOOT | 413 | 413 | | | | |
| 67100100 | MOBILIZATION | L SUM | 1 | 1 | | | | | Z0030850 | TEMPORARY INFORMATION SIGNING | SO FT | 102.8 | 102.8 | | | | |
| 70102620 | TRAFFIC CONTROL AND PROTECTION, STANDARD 701501 | L SUM | 1 | 1 | | | | | | | | | | | | | |
| 70102625 | TRAFFIC CONTROL AND PROTECTION, STANDARD 701606 | L SUM | 1 | 1 | | | | | | | | | | | | | |
| 70102630 | TRAFFIC CONTROL AND PROTECTION, STANDARD 701601 | L SUM | 1 | 1 | | | | | | | | | | | | | |
| 70102635 | TRAFFIC CONTROL AND PROTECTION, STANDARD 701701 | L SUM | 1 | 1 | | | | | | | | | | | | | |
| 70102640 | TRAFFIC CONTROL AND PROTECTION, STANDARD 701801 | L SUM | 1 | 1 | | | | | | | | | | | | | |
| * 78009000 | MODIFIED URETHANE PAVEMENT MARKING - LETTERS AND SYMBOLS | SO FT | 1266 | 1266 | | | | | | | | | | | | | |
| * 78009004 | MODIFIED URETHANE PAVEMENT MARKING - LINE 4" | FOOT | 45978 | 45978 | | | | | | | | | | | | | |
| * 78009006 | MODIFIED URETHANE PAVEMENT MARKING - LINE 6" | FOOT | 4418 | 4418 | | | | | | | | | | | | | *=SPECIALTY ITEM |

REV-SEP

| | | | |
|---------------------------------------------------|-----------------------------------------------------------------|------------|-----------|
| FILE NAME = | USER NAME = hmw/m | DESIGNED - | REVISED - |
| p:\planroom\dtd\111\mof.gov\PI\001\Documents\VDOT | 0:\files\ofstr\ct\N\Projects\DI5\920\CAD\del\Des\grn\DI5\920-sr | DRAWN - | REVISED - |
| | PLOT SCALE = 100,000' / 1" = | CHECKED - | REVISED - |
| | PLOT DATE = 6/25/2020 | DATE - | REVISED - |

STATE OF ILLINOIS
DEPARTMENT OF TRANSPORTATION

IL 7 (143RD ST) WILL-COOK RD TO SOUTHWEST HWY
SUMMARY OF QUANTITIES

SCALE: SHEET NO. OF SHEETS STA. TO STA.

| | | | | |
|--------------------|------------|--------|---------------------------------------------------|-----------|
| F.A.U. RTE. | SECTION | COUNTY | TOTAL SHEETS | SHEET NO. |
| 1600 | 2020-119-1 | COOK | 14 | 3 |
| CONTRACT NO. 62L97 | | | FED. ROAD DIST. NO. 1 (ILLINOIS) FED. AID PROJECT | |

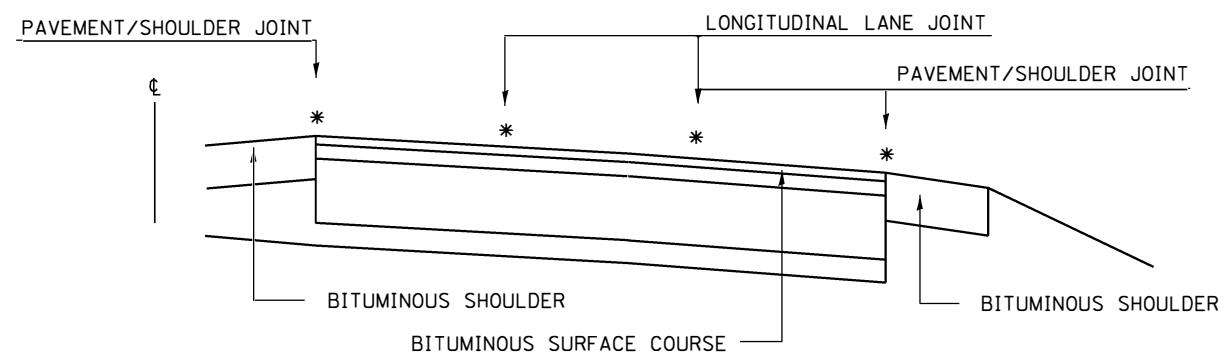

MULTI-LANE DIVIDED PAVEMENT

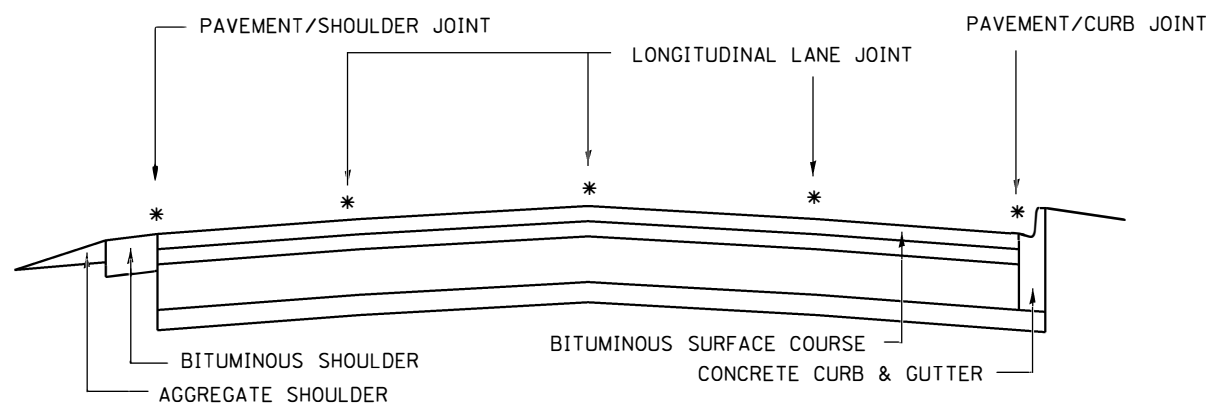

MULTI-LANE UNDIVIDED PAVEMENT

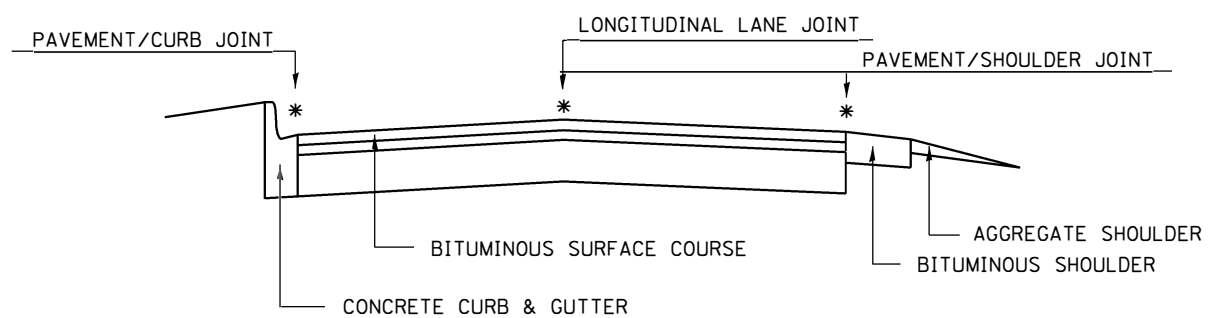

TWO-LANE PAVEMENT

PROPOSED TRANSVERSE CRACK ROUTING (PAVEMENT) & CRACK FILLING LOCATIONS NOT SHOWN

* PROPOSED LONGITUDINAL CRACK ROUTING (PAVEMENT) & CRACK FILLING LOCATIONS

GENERAL EXISTING TYPICAL SECTIONS

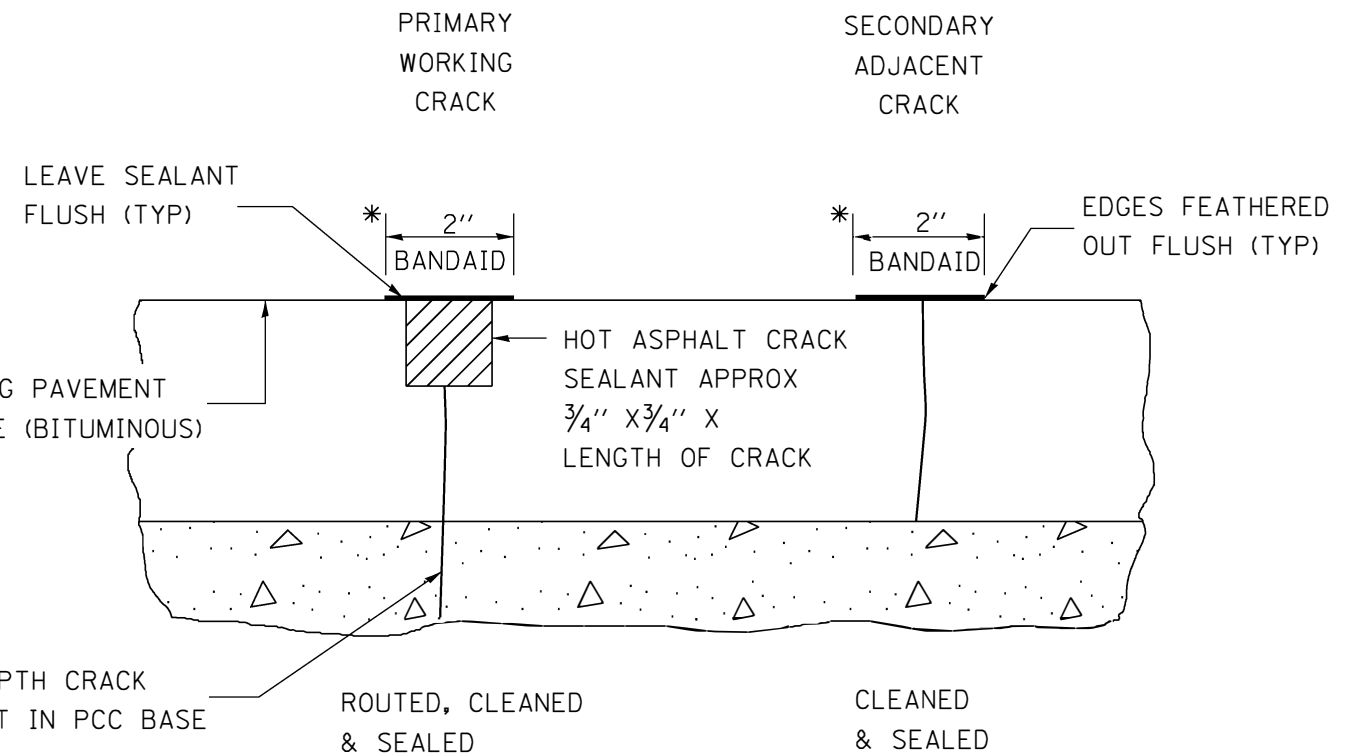

*

IN ALL LOCATIONS WHERE THE LONGITUDINAL CRACK CONFLICTS WITH EXISTING PAVEMENT MARKINGS (EITHER EDGE LINE OR LANE LINE) THE CRACK SHALL BE ROUTED & THE RESULTING RESERVOIR FILLED WITH SEALANT. ALL DAMAGES TO EXISTING RAISED REFLECTIVE PAVEMENT MARKERS SHALL BE REPLACED AT THE EXPENSE OF THE CONTRACTOR. ALL EXISTING PAVEMENT MARKINGS WITHIN THE PROJECT LIMITS SHALL BE RESTORED WITH MODIFIED URETHANE PAVEMENT MARKINGS.

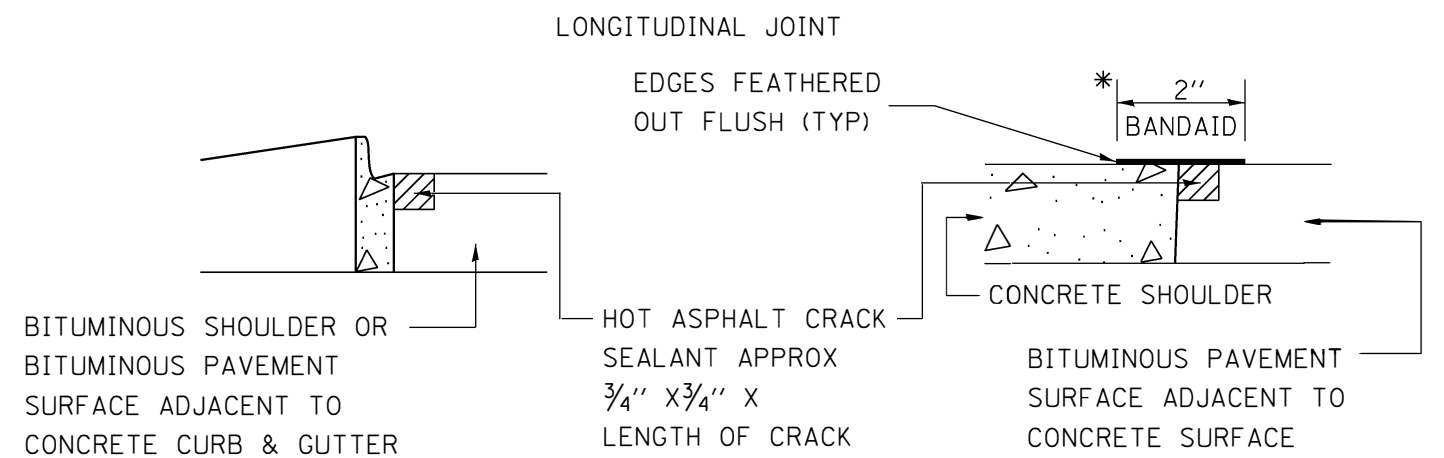

CRACK & JOINT SEALING DETAIL

| | | | |
|-----------------------------------------|-------------------------------|------------|-----------|
| FILE NAME = D151920-sht-schedule.dgn | USER NAME = hamwim | DESIGNED - | REVISED - |
| | | DRAWN - | REVISED - |
| | PLOT SCALE = 100.0000' / 1in. | CHECKED - | REVISED - |
| | PLOT DATE = 6/25/2020 | DATE - | REVISED - |

STATE OF ILLINOIS
DEPARTMENT OF TRANSPORTATION

IL 7 (143RD ST) WILL-COOK RD TO SOUTHWEST HWY
CRACK & JOINT SEALING DETAIL

SCALE: SHEET NO. OF SHEETS STA. TO STA.

| | | | | |
|--------------------|------------|--------|---------------------------|-----------|
| F.A.U. RTE. | SECTION | COUNTY | TOTAL SHEETS | SHEET NO. |
| 1600 | 2020-119-I | COOK | 14 | 4 |
| CONTRACT NO. 62L97 | | | ILLINOIS FED. AID PROJECT | |

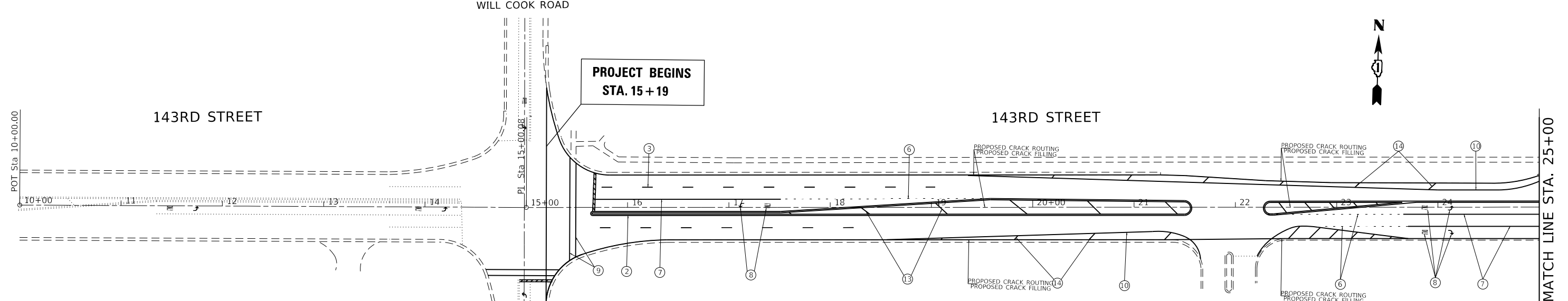

LEGEND: PROPOSED PAVEMENT STRIPING

- * = MODIFIED URETHANE PAVEMENT MARKING -
- ① * LINE 4", SKIP-DASH, YELLOW (10' LINE - 30' SPACE) - CENTERLINE (TYP)
- ② * LINE 2 @ 4", SOLID, YELLOW, 11" C-C - CENTERLINE (TYP)
- ③ * LINE 4", SKIP-DASH, WHITE (10' LINE - 30' SPACE) - LANE LINES (TYP)
- ④ * LINE 4", SOLID, YELLOW - EDGE LINE (TYP)
- ⑤ * LINE 4", SOLID, WHITE - EDGE LINE (TYP)
- ⑥ * LINE 6", SKIP-DASH, WHITE (2' LINE - 6' SPACE) - DOTTED LINES (TYP)
- ⑦ * LINE 6", SOLID, WHITE - TURN LANE MARKINGS (TYP)
- ⑧ * LETTERS & SYMBOLS, 8", SOLID, WHITE - TURN LANE MARKINGS (TYP)
- ⑨ * LINE 2 @ 6", SOLID, WHITE - CROSSWALK LINES (PEDESTRIAN) (TYP)
- ⑩ * LINE 8", SOLID, WHITE - GORE MARKING AND CHANNELIZING LINES (TYP)
- ⑪ * LINE 12", SOLID, WHITE - CROSSWALK LINES, LONGITUDINAL BARS (SCHOOL), (TYP). (SEE DISTRICT DETAIL TC-13 FOR SPACING)
- ⑫ * LINE 24", SOLID, WHITE - STOP LINES (TYP)
- ⑬ * LINE 12", SOLID, YELLOW - PAINTED MEDIANS DIAGONALS (TYP) (SEE DISTRICT DETAIL TC-13 FOR SPACING)
- ⑭ * LINE 12", SOLID, WHITE - DIAGONALS (BIKE & EQUESTRIAN) @ 45° (TYP) - SHOULDER DIAGONALS @ 45° (TYP) (SEE DISTRICT DETAIL TC-13 FOR SPACING)
- ⑮ * LINE 4", SOLID, YELLOW - CENTERLINE

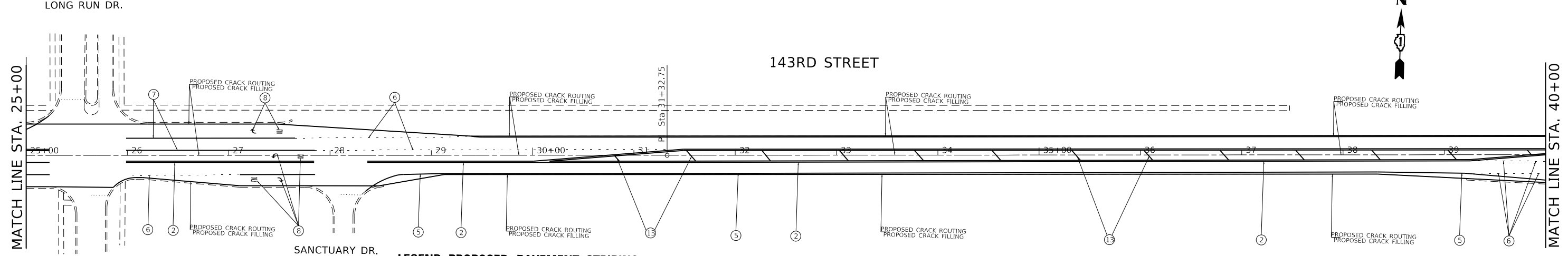

LEGEND: PROPOSED PAVEMENT STRIPING

- * = MODIFIED URETHANE PAVEMENT MARKING -
- ① * LINE 4", SKIP-DASH, YELLOW (10' LINE - 30' SPACE) - CENTERLINE (TYP)
- ② * LINE 2 @ 4", SOLID, YELLOW, 11" C-C - CENTERLINE (TYP)
- ③ * LINE 4", SKIP-DASH, WHITE (10' LINE - 30' SPACE) - LANE LINES (TYP)
- ④ * LINE 4", SOLID, YELLOW - EDGE LINE (TYP)
- ⑤ * LINE 4", SOLID, WHITE - EDGE LINE (TYP)
- ⑥ * LINE 6", SKIP-DASH, WHITE (2' LINE - 6' SPACE) - DOTTED LINES (TYP)
- ⑦ * LINE 6", SOLID, WHITE - TURN LANE MARKINGS (TYP)
- ⑧ * LETTERS & SYMBOLS, 8", SOLID, WHITE - TURN LANE MARKINGS (TYP)
- ⑨ * LINE 2 @ 6", SOLID, WHITE - CROSSWALK LINES (PEDESTRIAN) (TYP)
- ⑩ * LINE 8", SOLID, WHITE - GORE MARKING AND CHANNELIZING LINES (TYP)
- ⑪ * LINE 12", SOLID, WHITE - CROSSWALK LINES, LONGITUDINAL BARS (SCHOOL), (TYP). (SEE DISTRICT DETAIL TC-13 FOR SPACING)
- ⑫ * LINE 24", SOLID, WHITE - STOP LINES (TYP)
- ⑬ * LINE 12", SOLID, YELLOW - PAINTED MEDIANS DIAGONALS (TYP) (SEE DISTRICT DETAIL TC-13 FOR SPACING)
- ⑭ * LINE 12", SOLID, WHITE - DIAGONALS (BIKE & EQUESTRIAN) @ 45° (TYP) - SHOULDER DIAGONALS @ 45° (TYP) (SEE DISTRICT DETAIL TC-13 FOR SPACING)
- ⑮ * LINE 4", SOLID, YELLOW - CENTERLINE

MODEL: Default
 FILE: h:\a11\c:\p\pub\barroom.dwg
 PROJECT: 151920\CD\DATA\Design\151920-shw-plan.dwg

| | | | | | | | | | |
|-----------------------------------------------------------------------------|-----------------------|------------------------|--------------------------------------------------------------------|---------------------------------------------------------------------------------------------------------------------------|----------------------------------|------------------------------|--------------------|------------------------------|-------------------|
| USER NAME = hamwim PLOT SCALE = 100,0000' / in. PLOT DATE = 6/25/2020 | DESIGNED - DRAWN - | REVISED - REVISED - | STATE OF ILLINOIS DEPARTMENT OF TRANSPORTATION | PROPOSED ROADWAY PLAN AND PAVEMENT MARKING PLAN IL RTE 7 (143RD STREET) WILL-COOK RD. - SOUTHWEST HWY | F.A.U RTE. | SECTION 2020-119-I | COUNTY COOK | TOTAL SHEETS 14 | SHEET NO. 5 |
| | CHECKED - DATE - | REVISED - REVISED - | | | SCALE: 1"=50' SHEET OF SHEETS | STA. TO STA. | CONTRACT NO. 62L97 | ILLINOIS FED. AID PROJECT | |
| | DATE - | REVISED - | | | STA. TO STA. | ILLINOIS FED. AID PROJECT | | | |

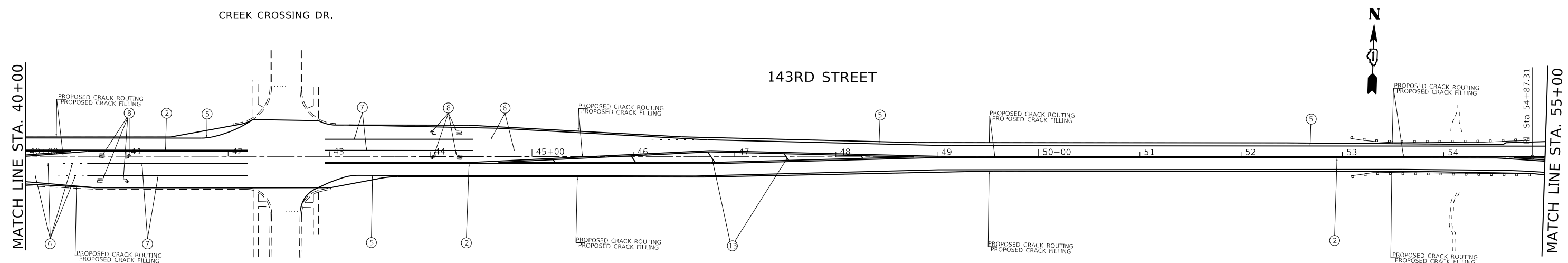

LEGEND: PROPOSED PAVEMENT STRIPING

* = MODIFIED URETHANE PAVEMENT MARKING -

- ① * LINE 4", SKIP-DASH, YELLOW (10' LINE - 30' SPACE) - CENTERLINE (TYP)
- ② * LINE 2 @ 4", SOLID, YELLOW, 11" C-C - CENTERLINE (TYP)
- ③ * LINE 4", SKIP-DASH, WHITE (10' LINE - 30' SPACE) - LANE LINES (TYP)
- ④ * LINE 4", SOLID, YELLOW - EDGE LINE (TYP)
- ⑤ * LINE 4", SOLID, WHITE - EDGE LINE (TYP)
- ⑥ * LINE 6", SKIP-DASH, WHITE (2' LINE - 6' SPACE) - DOTTED LINES (TYP)
- ⑦ * LINE 6", SOLID, WHITE - TURN LANE MARKINGS (TYP)
- ⑧ * LETTERS & SYMBOLS, 8", SOLID, WHITE - TURN LANE MARKINGS (TYP)
- ⑨ * LINE 2 @ 6", SOLID, WHITE - CROSSWALK LINES (PEDESTRIAN) (TYP)
- ⑩ * LINE 8", SOLID, WHITE - GORE MARKING AND CHANNELIZING LINES (TYP)
- ⑪ * LINE 12", SOLID, WHITE - CROSSWALK LINES, LONGITUDINAL BARS (SCHOOL), (TYP), (SEE DISTRICT DETAIL TC-13 FOR SPACING)
- ⑫ * LINE 24", SOLID, WHITE - STOP LINES (TYP)
- ⑬ * LINE 12", SOLID, YELLOW - PAINTED MEDIANS DIAGONALS (TYP) (SEE DISTRICT DETAIL TC-13 FOR SPACING)
- ⑭ * LINE 12", SOLID, WHITE - DIAGONALS (BIKE & EQUESTRIAN) @ 45° (TYP) - SHOULDER DIAGONALS @ 45° (TYP) (SEE DISTRICT DETAIL TC-13 FOR SPACING)
- ⑮ * LINE 4", SOLID, YELLOW - CENTERLINE

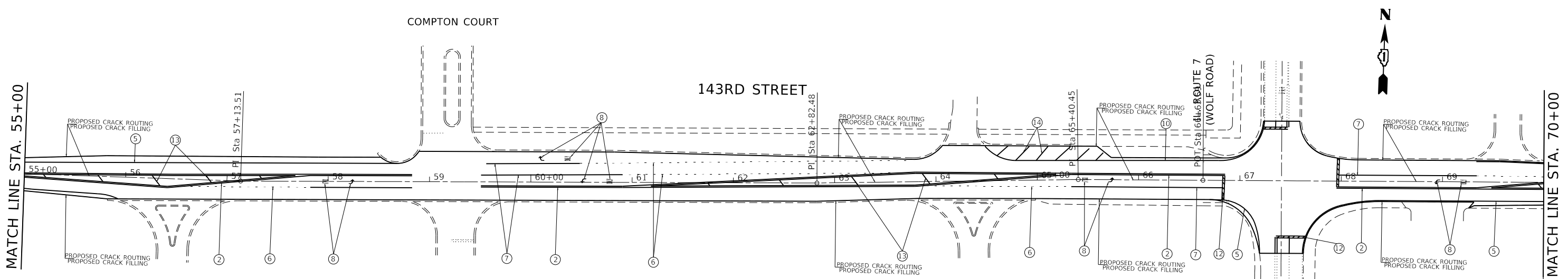

LEGEND: PROPOSED PAVEMENT STRIPING

* = MODIFIED URETHANE PAVEMENT MARKING -

- ① * LINE 4", SKIP-DASH, YELLOW (10' LINE - 30' SPACE) - CENTERLINE (TYP)
- ② * LINE 2 @ 4", SOLID, YELLOW, 11" C-C - CENTERLINE (TYP)
- ③ * LINE 4", SKIP-DASH, WHITE (10' LINE - 30' SPACE) - LANE LINES (TYP)
- ④ * LINE 4", SOLID, YELLOW - EDGE LINE (TYP)
- ⑤ * LINE 4", SOLID, WHITE - EDGE LINE (TYP)
- ⑥ * LINE 6", SKIP-DASH, WHITE (2' LINE - 6' SPACE) - DOTTED LINES (TYP)
- ⑦ * LINE 6", SOLID, WHITE - TURN LANE MARKINGS (TYP)
- ⑧ * LETTERS & SYMBOLS, 8", SOLID, WHITE - TURN LANE MARKINGS (TYP)
- ⑨ * LINE 2 @ 6", SOLID, WHITE - CROSSWALK LINES (PEDESTRIAN) (TYP)
- ⑩ * LINE 8", SOLID, WHITE - GORE MARKING AND CHANNELIZING LINES (TYP)
- ⑪ * LINE 12", SOLID, WHITE - CROSSWALK LINES, LONGITUDINAL BARS (SCHOOL), (TYP), (SEE DISTRICT DETAIL TC-13 FOR SPACING)
- ⑫ * LINE 24", SOLID, WHITE - STOP LINES (TYP)
- ⑬ * LINE 12", SOLID, YELLOW - PAINTED MEDIANS DIAGONALS (TYP) (SEE DISTRICT DETAIL TC-13 FOR SPACING)
- ⑭ * LINE 12", SOLID, WHITE - DIAGONALS (BIKE & EQUESTRIAN) @ 45° (TYP) - SHOULDER DIAGONALS @ 45° (TYP) (SEE DISTRICT DETAIL TC-13 FOR SPACING)
- ⑮ * LINE 4", SOLID, YELLOW - CENTERLINE

MODEL: Default
 FILE: h:\mhc\proj\pub\room\dat\illinois\gov\pww\DOT\Documents\DOT - Offices\District 1\Projects\151920\CADD\Drawings\151920-sh-hw-01.dwg

| | | |
|------------------------------|------------|-----------|
| USER NAME = hamwim | DESIGNED - | REVISED - |
| | DRAWN - | REVISED - |
| PLOT SCALE = 100,0000' / in. | CHECKED - | REVISED - |
| PLOT DATE = 6/25/2020 | DATE - | REVISED - |

STATE OF ILLINOIS
DEPARTMENT OF TRANSPORTATION

PROPOSED ROADWAY PLAN AND PAVEMENT MARKING PLAN
IL RTE 7 (143RD STREET) WILL-COOK RD. - SOUTHWEST HWY

SCALE: 1"=50' SHEET OF SHEETS STA. TO STA.

| | | | | |
|--------------------|------------|--------|---------------------------|-----------|
| F.A.U. RTE. | SECTION | COUNTY | TOTAL SHEETS | SHEET NO. |
| 1600 | 2020-119-I | COOK | 14 | 6 |
| CONTRACT NO. 62L97 | | | ILLINOIS FED. AID PROJECT | |

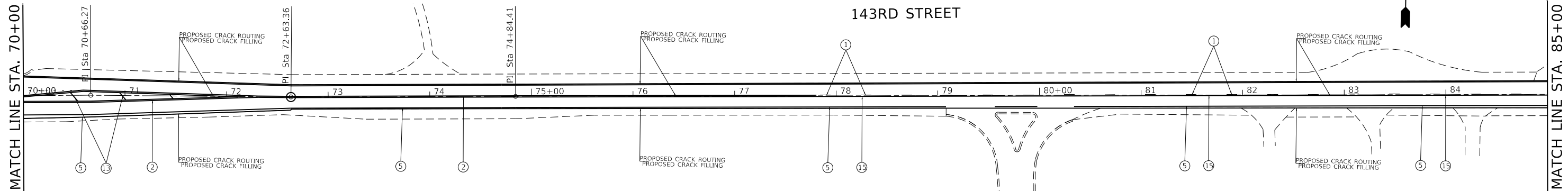

LEGEND: PROPOSED PAVEMENT STRIPING

* = MODIFIED URETHANE PAVEMENT MARKING -

- | | | |
|--------------------------------------------------------------------------|-----------------------------------------------------------------------------------------------------------------------------|----------------------------------------------------------------------------------------------------------------------------------------------------------|
| ① * LINE 4", SKIP-DASH, YELLOW (10' LINE - 30' SPACE) - CENTERLINE (TYP) | ⑦ * LINE 6", SOLID, WHITE - TURN LANE MARKINGS (TYP) | ⑫ * LINE 24", SOLID, WHITE - STOP LINES (TYP) |
| ② * LINE 2 @ 4", SOLID, YELLOW, 11" C-C - CENTERLINE (TYP) | ⑧ * LETTERS & SYMBOLS, 8", SOLID, WHITE - TURN LANE MARKINGS (TYP) | ⑬ * LINE 12", SOLID, YELLOW - PAINTED MEDIANS DIAGONALS (TYP) (SEE DISTRICT DETAIL TC-13 FOR SPACING) |
| ③ * LINE 4", SKIP-DASH, WHITE (10' LINE - 30' SPACE) - LANE LINES (TYP) | ⑨ * LINE 2 @ 6", SOLID, WHITE - CROSSWALK LINES (PEDESTRIAN) (TYP) | ⑭ * LINE 12", SOLID, WHITE - DIAGONALS (BIKE & EQUESTRIAN) @ 45° (TYP) - SHOULDER DIAGONALS @ 45° (TYP) (SEE DISTRICT DETAIL TC-13 FOR SPACING) |
| ④ * LINE 4", SOLID, YELLOW - EDGE LINE (TYP) | ⑩ * LINE 8", SOLID, WHITE - GORE MARKING AND CHANNELIZING LINES (TYP) | ⑮ * LINE 4", SOLID, YELLOW - CENTERLINE |
| ⑤ * LINE 4", SOLID, WHITE - EDGE LINE (TYP) | ⑪ * LINE 12", SOLID, WHITE - CROSSWALK LINES, LONGITUDINAL BARS (SCHOOL), (TYP), (SEE DISTRICT DETAIL TC-13 FOR SPACING) | |
| ⑥ * LINE 6", SKIP-DASH, WHITE (2' LINE - 6' SPACE) - DOTTED LINES (TYP) | | |

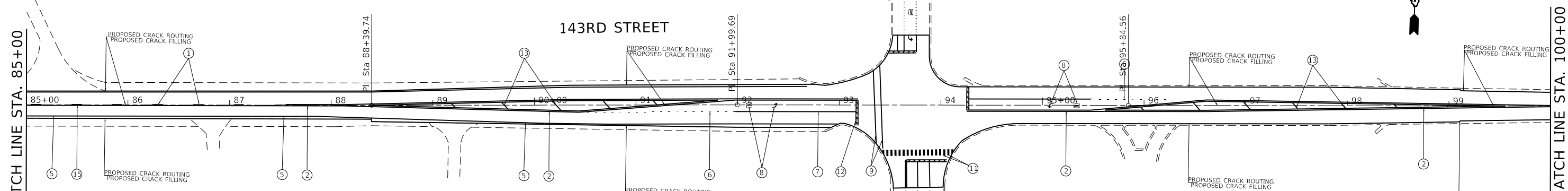

LEGEND: PROPOSED PAVEMENT STRIPING

* = MODIFIED URETHANE PAVEMENT MARKING -

- | | | |
|--------------------------------------------------------------------------|-----------------------------------------------------------------------------------------------------------------------------|----------------------------------------------------------------------------------------------------------------------------------------------------------|
| ① * LINE 4", SKIP-DASH, YELLOW (10' LINE - 30' SPACE) - CENTERLINE (TYP) | ⑦ * LINE 6", SOLID, WHITE - TURN LANE MARKINGS (TYP) | ⑫ * LINE 24", SOLID, WHITE - STOP LINES (TYP) |
| ② * LINE 2 @ 4", SOLID, YELLOW, 11" C-C - CENTERLINE (TYP) | ⑧ * LETTERS & SYMBOLS, 8", SOLID, WHITE - TURN LANE MARKINGS (TYP) | ⑬ * LINE 12", SOLID, YELLOW - PAINTED MEDIANS DIAGONALS (TYP) (SEE DISTRICT DETAIL TC-13 FOR SPACING) |
| ③ * LINE 4", SKIP-DASH, WHITE (10' LINE - 30' SPACE) - LANE LINES (TYP) | ⑨ * LINE 2 @ 6", SOLID, WHITE - CROSSWALK LINES (PEDESTRIAN) (TYP) | ⑭ * LINE 12", SOLID, WHITE - DIAGONALS (BIKE & EQUESTRIAN) @ 45° (TYP) - SHOULDER DIAGONALS @ 45° (TYP) (SEE DISTRICT DETAIL TC-13 FOR SPACING) |
| ④ * LINE 4", SOLID, YELLOW - EDGE LINE (TYP) | ⑩ * LINE 8", SOLID, WHITE - GORE MARKING AND CHANNELIZING LINES (TYP) | ⑮ * LINE 4", SOLID, YELLOW - CENTERLINE |
| ⑤ * LINE 4", SOLID, WHITE - EDGE LINE (TYP) | ⑪ * LINE 12", SOLID, WHITE - CROSSWALK LINES, LONGITUDINAL BARS (SCHOOL), (TYP), (SEE DISTRICT DETAIL TC-13 FOR SPACING) | |
| ⑥ * LINE 6", SKIP-DASH, WHITE (2' LINE - 6' SPACE) - DOTTED LINES (TYP) | | |

MODEL: Default
FILE: h:\mhc_p\pub\harcour\dot\illinois\p\pub\dot\Documents\DOT_Offices\District 1\Projects\151920\CADD\data\Design\151920-sh-hbar.dgn

| | | |
|------------------------------|------------|-----------|
| USER NAME = hamwim | DESIGNED - | REVISED - |
| PLOT SCALE = 100,0000' / in. | DRAWN - | REVISED - |
| PLOT DATE = 6/25/2020 | CHECKED - | REVISED - |
| | DATE - | REVISED - |

**STATE OF ILLINOIS
DEPARTMENT OF TRANSPORTATION**

**PROPOSED ROADWAY PLAN AND PAVEMENT MARKING PLAN
IL RTE 7 (143RD STREET) WILL-COOK RD. - SOUTHWEST HWY**

SCALE: 1"=50' SHEET OF SHEETS STA. TO STA.

| | | | | |
|---------------------------|------------|--------|--------------|-----------|
| F.A.U. RTE. | SECTION | COUNTY | TOTAL SHEETS | SHEET NO. |
| 1600 | 2020-119-I | COOK | 14 | 7 |
| CONTRACT NO. 62L97 | | | | |
| ILLINOIS FED. AID PROJECT | | | | |

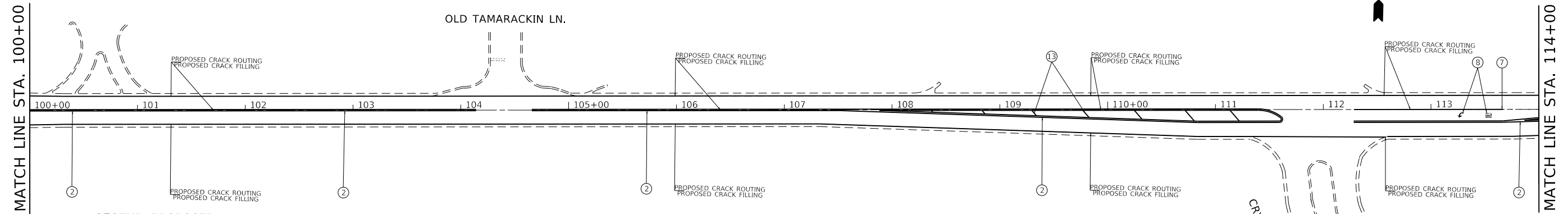

LEGEND: PROPOSED PAVEMENT STRIPING

- * = MODIFIED URETHANE PAVEMENT MARKING -
- ① * LINE 4", SKIP-DASH, YELLOW (10' LINE - 30' SPACE) - CENTERLINE (TYP)
 - ② * LINE 2 @ 4", SOLID, YELLOW, 11" C-C - CENTERLINE (TYP)
 - ③ * LINE 4", SKIP-DASH, WHITE (10' LINE - 30' SPACE) - LANE LINES (TYP)
 - ④ * LINE 4", SOLID, YELLOW - EDGE LINE (TYP)
 - ⑤ * LINE 4", SOLID, WHITE - EDGE LINE (TYP)
 - ⑥ * LINE 6", SKIP-DASH, WHITE (2' LINE - 6' SPACE) - DOTTED LINES (TYP)
 - ⑦ * LINE 6", SOLID, WHITE - TURN LANE MARKINGS (TYP)
 - ⑧ * LETTERS & SYMBOLS, 8", SOLID, WHITE - TURN LANE MARKINGS (TYP)
 - ⑨ * LINE 2 @ 6", SOLID, WHITE - CROSSWALK LINES (PEDESTRIAN) (TYP)
 - ⑩ * LINE 8", SOLID, WHITE - GORE MARKING AND CHANNELIZING LINES (TYP)
 - ⑪ * LINE 12", SOLID, WHITE - CROSSWALK LINES, LONGITUDINAL BARS (SCHOOL), (TYP), (SEE DISTRICT DETAIL TC-13 FOR SPACING)
 - ⑫ * LINE 24", SOLID, WHITE - STOP LINES (TYP)
 - ⑬ * LINE 12", SOLID, YELLOW - PAINTED MEDIANS DIAGONALS (TYP) (SEE DISTRICT DETAIL TC-13 FOR SPACING)
 - ⑭ * LINE 12", SOLID, WHITE - DIAGONALS (BIKE & EQUESTRIAN) @ 45° (TYP) - SHOULDER DIAGONALS @ 45° (TYP) (SEE DISTRICT DETAIL TC-13 FOR SPACING)
 - ⑮ * LINE 4", SOLID, YELLOW - CENTERLINE

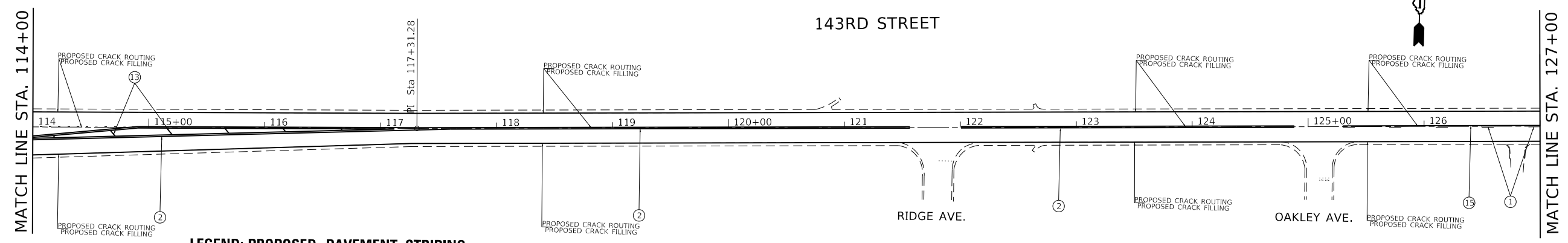

LEGEND: PROPOSED PAVEMENT STRIPING

- * = MODIFIED URETHANE PAVEMENT MARKING -
- ① * LINE 4", SKIP-DASH, YELLOW (10' LINE - 30' SPACE) - CENTERLINE (TYP)
 - ② * LINE 2 @ 4", SOLID, YELLOW, 11" C-C - CENTERLINE (TYP)
 - ③ * LINE 4", SKIP-DASH, WHITE (10' LINE - 30' SPACE) - LANE LINES (TYP)
 - ④ * LINE 4", SOLID, YELLOW - EDGE LINE (TYP)
 - ⑤ * LINE 4", SOLID, WHITE - EDGE LINE (TYP)
 - ⑥ * LINE 6", SKIP-DASH, WHITE (2' LINE - 6' SPACE) - DOTTED LINES (TYP)
 - ⑦ * LINE 6", SOLID, WHITE - TURN LANE MARKINGS (TYP)
 - ⑧ * LETTERS & SYMBOLS, 8", SOLID, WHITE - TURN LANE MARKINGS (TYP)
 - ⑨ * LINE 2 @ 6", SOLID, WHITE - CROSSWALK LINES (PEDESTRIAN) (TYP)
 - ⑩ * LINE 8", SOLID, WHITE - GORE MARKING AND CHANNELIZING LINES (TYP)
 - ⑪ * LINE 12", SOLID, WHITE - CROSSWALK LINES, LONGITUDINAL BARS (SCHOOL), (TYP), (SEE DISTRICT DETAIL TC-13 FOR SPACING)
 - ⑫ * LINE 24", SOLID, WHITE - STOP LINES (TYP)
 - ⑬ * LINE 12", SOLID, YELLOW - PAINTED MEDIANS DIAGONALS (TYP) (SEE DISTRICT DETAIL TC-13 FOR SPACING)
 - ⑭ * LINE 12", SOLID, WHITE - DIAGONALS (BIKE & EQUESTRIAN) @ 45° (TYP) - SHOULDER DIAGONALS @ 45° (TYP) (SEE DISTRICT DETAIL TC-13 FOR SPACING)
 - ⑮ * LINE 4", SOLID, YELLOW - CENTERLINE

MODEL: Default
 FILE: h:\mhc\proj\pub\room\dat\illinois.gov\pww\DOT\Documents\DOT - Offices\District 1\Projects\151920\CaddData\Design\151920-sh-hwy-lb-04.dgn

| | | |
|------------------------------|------------|-----------|
| USER NAME = hamwim | DESIGNED - | REVISED - |
| | DRAWN - | REVISED - |
| PLOT SCALE = 100,0000' / in. | CHECKED - | REVISED - |
| PLOT DATE = 6/25/2020 | DATE - | REVISED - |

STATE OF ILLINOIS
DEPARTMENT OF TRANSPORTATION

PROPOSED ROADWAY PLAN AND PAVEMENT MARKING PLAN
IL RTE 7 (143RD STREET) WILL-COOK RD. - SOUTHWEST HWY

SCALE: 1"=50' SHEET OF SHEETS STA. TO STA.

| | | | | |
|--------------------|------------|--------|---------------------------|-----------|
| F.A.U. RTE. | SECTION | COUNTY | TOTAL SHEETS | SHEET NO. |
| 1600 | 2020-119-I | COOK | 14 | 8 |
| CONTRACT NO. 62L97 | | | ILLINOIS FED. AID PROJECT | |

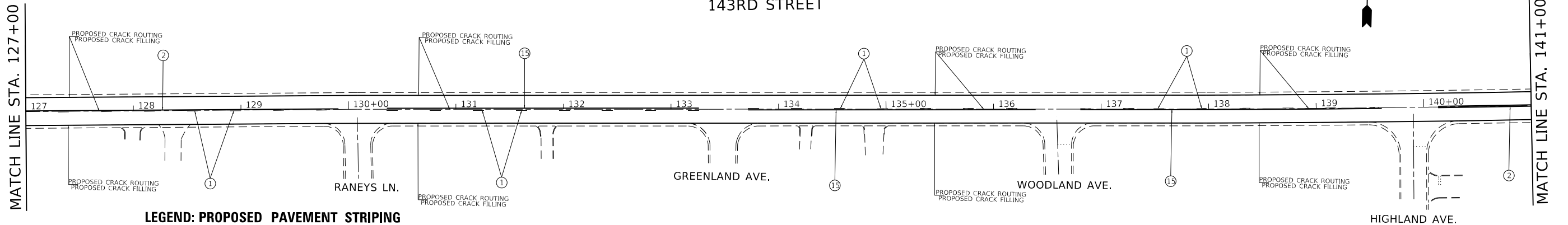

LEGEND: PROPOSED PAVEMENT STRIPING

- * = MODIFIED URETHANE PAVEMENT MARKING -
- ① * LINE 4", SKIP-DASH, YELLOW (10' LINE - 30' SPACE) - CENTERLINE (TYP)
 - ② * LINE 2 @ 4", SOLID, YELLOW, 11" C-C - CENTERLINE (TYP)
 - ③ * LINE 4", SKIP-DASH, WHITE (10' LINE - 30' SPACE) - LANE LINES (TYP)
 - ④ * LINE 4", SOLID, YELLOW - EDGE LINE (TYP)
 - ⑤ * LINE 4", SOLID, WHITE - EDGE LINE (TYP)
 - ⑥ * LINE 6", SKIP-DASH, WHITE (2' LINE - 6' SPACE) - DOTTED LINES (TYP)
 - ⑦ * LINE 6", SOLID, WHITE - TURN LANE MARKINGS (TYP)
 - ⑧ * LETTERS & SYMBOLS, 8", SOLID, WHITE - TURN LANE MARKINGS (TYP)
 - ⑨ * LINE 2 @ 6", SOLID, WHITE - CROSSWALK LINES (PEDESTRIAN) (TYP)
 - ⑩ * LINE 8", SOLID, WHITE - GORE MARKING AND CHANNELIZING LINES (TYP)
 - ⑪ * LINE 12", SOLID, WHITE - CROSSWALK LINES, LONGITUDINAL BARS (SCHOOL), (TYP), (SEE DISTRICT DETAIL TC-13 FOR SPACING)
 - ⑫ * LINE 24", SOLID, WHITE - STOP LINES (TYP)
 - ⑬ * LINE 12", SOLID, YELLOW - PAINTED MEDIANS DIAGONALS (TYP) (SEE DISTRICT DETAIL TC-13 FOR SPACING)
 - ⑭ * LINE 12", SOLID, WHITE - DIAGONALS (BIKE & EQUESTRIAN) @ 45° (TYP) - SHOULDER DIAGONALS @ 45° (TYP) (SEE DISTRICT DETAIL TC-13 FOR SPACING)
 - ⑮ * LINE 4", SOLID, YELLOW - CENTERLINE

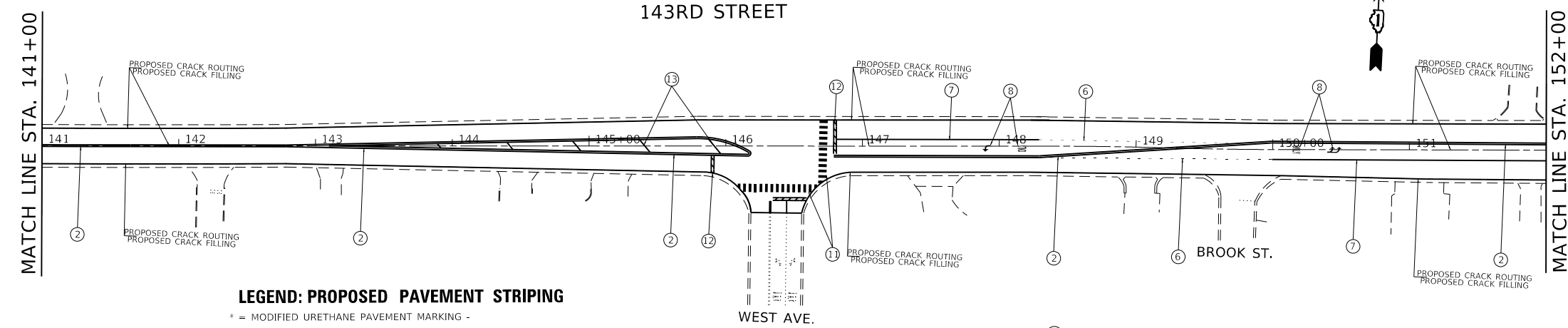

LEGEND: PROPOSED PAVEMENT STRIPING

- * = MODIFIED URETHANE PAVEMENT MARKING -
- ① * LINE 4", SKIP-DASH, YELLOW (10' LINE - 30' SPACE) - CENTERLINE (TYP)
 - ② * LINE 2 @ 4", SOLID, YELLOW, 11" C-C - CENTERLINE (TYP)
 - ③ * LINE 4", SKIP-DASH, WHITE (10' LINE - 30' SPACE) - LANE LINES (TYP)
 - ④ * LINE 4", SOLID, YELLOW - EDGE LINE (TYP)
 - ⑤ * LINE 4", SOLID, WHITE - EDGE LINE (TYP)
 - ⑥ * LINE 6", SKIP-DASH, WHITE (2' LINE - 6' SPACE) - DOTTED LINES (TYP)
 - ⑦ * LINE 6", SOLID, WHITE - TURN LANE MARKINGS (TYP)
 - ⑧ * LETTERS & SYMBOLS, 8", SOLID, WHITE - TURN LANE MARKINGS (TYP)
 - ⑨ * LINE 2 @ 6", SOLID, WHITE - CROSSWALK LINES (PEDESTRIAN) (TYP)
 - ⑩ * LINE 8", SOLID, WHITE - GORE MARKING AND CHANNELIZING LINES (TYP)
 - ⑪ * LINE 12", SOLID, WHITE - CROSSWALK LINES, LONGITUDINAL BARS (SCHOOL), (TYP), (SEE DISTRICT DETAIL TC-13 FOR SPACING)
 - ⑫ * LINE 24", SOLID, WHITE - STOP LINES (TYP)
 - ⑬ * LINE 12", SOLID, YELLOW - PAINTED MEDIANS DIAGONALS (TYP) (SEE DISTRICT DETAIL TC-13 FOR SPACING)
 - ⑭ * LINE 12", SOLID, WHITE - DIAGONALS (BIKE & EQUESTRIAN) @ 45° (TYP) - SHOULDER DIAGONALS @ 45° (TYP) (SEE DISTRICT DETAIL TC-13 FOR SPACING)
 - ⑮ * LINE 4", SOLID, YELLOW - CENTERLINE

MODEL: Default
 FILE: h:\mhc\proj\pub\harcourt\dot\illinois\gov\WID\DOT\Documents\DOT - Offices\District - 1\Projects\151920\Cadd\Drawn\Design\151920-sh-h-lb-01.dgn

| | | |
|------------------------------|------------|-----------|
| USER NAME = hamwim | DESIGNED - | REVISED - |
| | DRAWN - | REVISED - |
| PLOT SCALE = 100.0000' / in. | CHECKED - | REVISED - |
| PLOT DATE = 6/25/2020 | DATE - | REVISED - |

**STATE OF ILLINOIS
DEPARTMENT OF TRANSPORTATION**

**PROPOSED ROADWAY PLAN AND PAVEMENT MARKING PLAN
IL RTE 7 (143RD STREET) WILL-COOK RD. - SOUTHWEST HWY**

SCALE: 1"=50' SHEET OF SHEETS STA. TO STA.

| F.A.U. RTE. | SECTION | COUNTY | TOTAL SHEETS | SHEET NO. |
|--------------------|------------|------------------|--------------|-----------|
| 1600 | 2020-119-4 | COOK | 14 | 9 |
| CONTRACT NO. 62L97 | | | | |
| ILLINOIS | | FED. AID PROJECT | | |

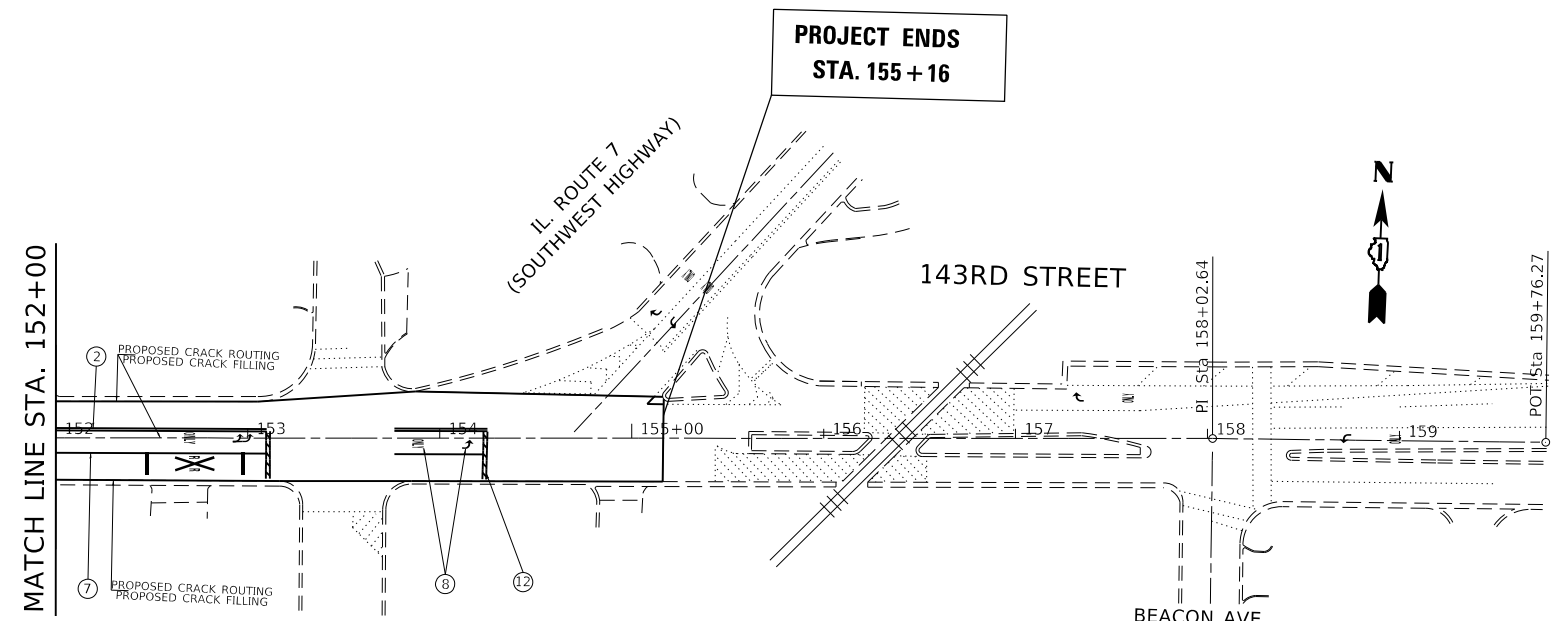

LEGEND: PROPOSED PAVEMENT STRIPING

- * = MODIFIED URETHANE PAVEMENT MARKING -
- ① * LINE 4", SKIP-DASH, YELLOW (10' LINE - 30' SPACE) - CENTERLINE (TYP)
 - ② * LINE 2 @ 4", SOLID, YELLOW, 11" C-C - CENTERLINE (TYP)
 - ③ * LINE 4", SKIP-DASH, WHITE (10' LINE - 30' SPACE) - LANE LINES (TYP)
 - ④ * LINE 4", SOLID, YELLOW - EDGE LINE (TYP)
 - ⑤ * LINE 4", SOLID, WHITE - EDGE LINE (TYP)
 - ⑥ * LINE 6", SKIP-DASH, WHITE (2' LINE - 6' SPACE) - DOTTED LINES (TYP)
 - ⑦ * LINE 6", SOLID, WHITE - TURN LANE MARKINGS (TYP)
 - ⑧ * LETTERS & SYMBOLS, 8", SOLID, WHITE - TURN LANE MARKINGS (TYP)
 - ⑨ * LINE 2 @ 6", SOLID, WHITE - CROSSWALK LINES (PEDESTRIAN) (TYP)
 - ⑩ * LINE 8", SOLID, WHITE - GORE MARKING AND CHANNELIZING LINES (TYP)
 - ⑪ * LINE 12", SOLID, WHITE - CROSSWALK LINES, LONGITUDINAL BARS (SCHOOL), (TYP), (SEE DISTRICT DETAIL TC-13 FOR SPACING)
 - ⑫ * LINE 24", SOLID, WHITE -
 - ⑬ * LINE 12", SOLID, YELLOW (SEE DISTRICT DETAIL TC-)
 - ⑭ * LINE 12", SOLID, WHITE - DIAGONALS (BIKE & EQ - SHOULDER DIAGONALS (SEE DISTRICT DETAIL 1
 - ⑮ * LINE 4", SOLID, YELLOW -

MODEL: Default
 FILE: h:\mhc\p\pub\harcam\dat\illinois.gov\RWIDOT\Documents\DOT_Offices\District_1\Projects\151920\CaddData\Design\151920-sh-143rd.dgn

| | | |
|-------------------------------|------------|-----------|
| USER NAME = hamwim | DESIGNED - | REVISED - |
| | DRAWN - | REVISED - |
| PLOT SCALE = 100,0000 ' / in. | CHECKED - | REVISED - |
| PLOT DATE = 6/25/2020 | DATE - | REVISED - |

**STATE OF ILLINOIS
 DEPARTMENT OF TRANSPORTATION**

**PROPOSED ROADWAY PLAN AND PAVEMENT MARKING PLAN
 IL RTE 7 (143RD STREET) WILL-COOK RD. - SOUTHWEST HWY**

SCALE: 1"=50' SHEET OF SHEETS STA. TO STA.

| F.A.U RTE. | SECTION | COUNTY | TOTAL SHEETS | SHEET NO. |
|------------|------------|----------|--------------------|-----------|
| 1600 | 2020-119-I | COOK | 14 | 10 |
| | | | CONTRACT NO. 62L97 | |
| | | ILLINOIS | FED. AID PROJECT | |

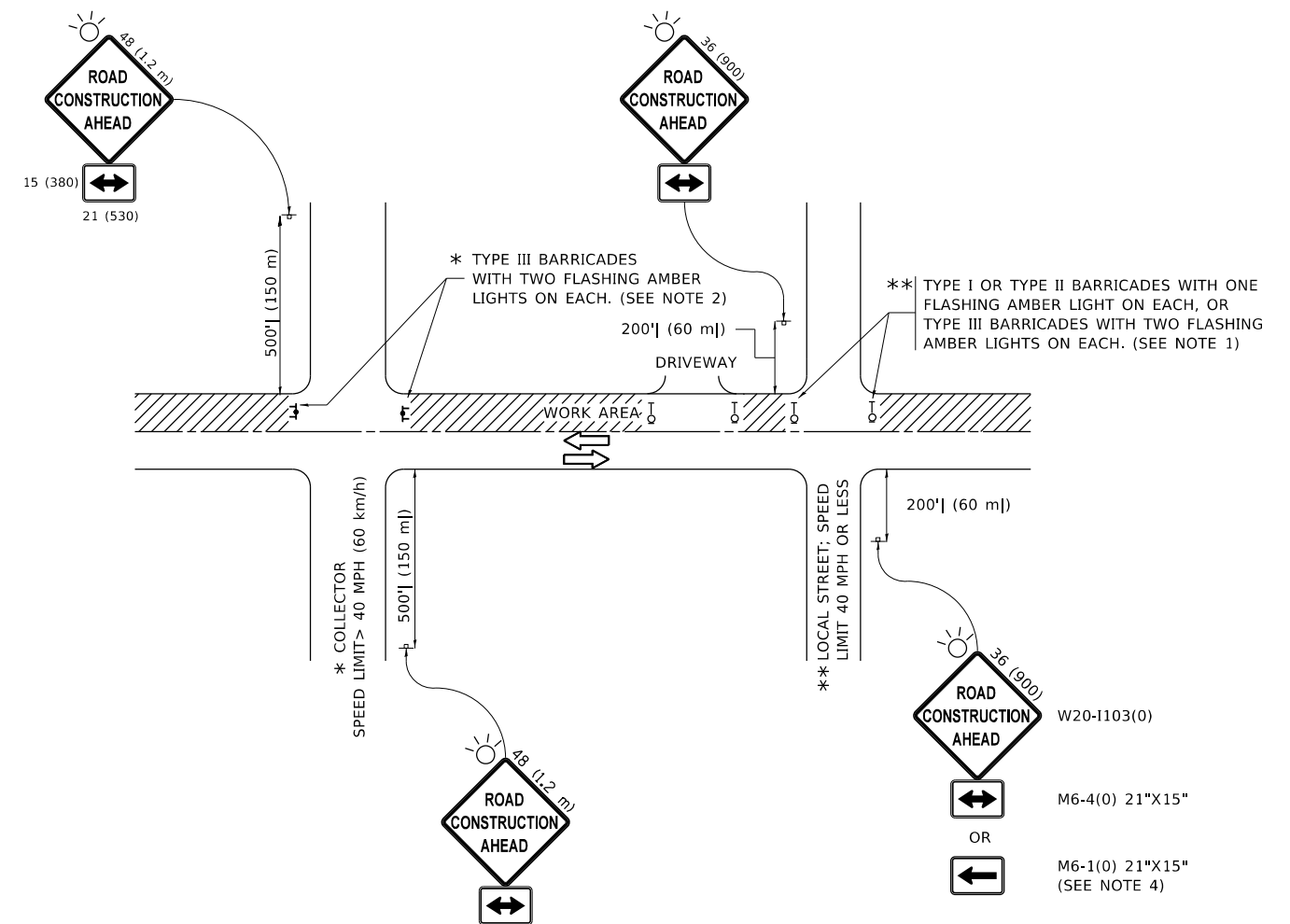

NOTES:

1. SIDE ROAD WITH A SPEED LIMIT OF 40 MPH (60 km/h) OR LESS AS SHOWN ON THE DRAWING AND AS DIRECTED BY THE ENGINEER:
 - a) ONE "ROAD CONSTRUCTION AHEAD" SIGN 36 x 36 (900x900) WITH A FLASHER MOUNTED ON IT APPROXIMATELY 200' (60 m) IN ADVANCE OF THE MAIN ROUTE.
 - b) THE CLOSED PORTION OF THE MAIN ROUTE SHALL BE PROTECTED BY BLOCKING WITH TYPE I, TYPE II OR TYPE III BARRICADES, 1/3 OF THE CROSS SECTION OF THE CLOSED PORTION.
2. SIDE ROAD WITH A SPEED LIMIT GREATER THAN 40 MPH (60 km/h) AS SHOWN ON THE DRAWING AND AS DIRECTED BY THE ENGINEER:
 - a) ONE "ROAD CONSTRUCTION AHEAD" SIGN 48 x 48 (1.2 m x 1.2 m) WITH A FLASHER MOUNTED ON IT APPROXIMATELY 500' (150 m) IN ADVANCE OF THE MAIN ROUTE.
 - b) BLOCKING WITH TYPE III BARRICADES, 1/2 OF THE CROSS SECTION OF THE CLOSED PORTION.
3. CONES MAY BE SUBSTITUTED FOR BARRICADES OR DRUMS AT HALF THE SPACING DURING DAY OPERATIONS. CONES SHALL BE A MINIMUM OF 28 (710) IN HEIGHT.
4. SIGNING AND THE WORK ZONE, A SINGLE HEADED ARROW (M6-1) SHALL BE USED IN LIEU OF THE DOUBLE HEADED ARROW (M6-4).
5. WHEN WORK IS BEING PERFORMED ON A SIDE ROAD OR DRIVEWAY, FOLLOW THE APPLICABLE STANDARD(S). THE DIRECTIONAL ARROW (M6-1 OR M6-4) SHALL BE COVERED OR REMOVED WHEN NO LONGER CONSISTENT WITH THE TRAFFIC CONTROL SET-UP.
6. ADVANCE WARNING SIGNS ARE TO BE OMITTED ON DRIVEWAYS UNLESS OTHERWISE SPECIFIED IN THE PLANS OR BY THE ENGINEER.
7. THE TRAFFIC CONTROL AND PROTECTION FOR SIDE ROADS, INTERSECTIONS, AND DRIVEWAYS SHALL BE INCLUDED IN THE COST OF SPECIFIED TRAFFIC CONTROL STANDARDS OR ITEMS.

All dimensions are in inches (millimeters) unless otherwise shown.

MODEL: Default
 FILE: h:\m\c_p\pub\haronom.dwg
 PROJECT: I:\Projects\151920\CADD\Design\Design\151920.dwg

| | | |
|------------------------------|-------------------|---------------------------------|
| USER NAME = hamwim | DESIGNED - L.H.A. | REVISED - A. HOUSEH 10-15-96 |
| PLOT SCALE = 100,0000' / in. | CHECKED - | REVISED - T. RAMMACHER 01-06-00 |
| PLOT DATE = 6/25/2020 | DATE - 06-89 | REVISED - A. SCHUETZE 07-01-13 |
| | | REVISED - A. SCHUETZE 09-15-16 |

**STATE OF ILLINOIS
DEPARTMENT OF TRANSPORTATION**

**TRAFFIC CONTROL AND PROTECTION FOR
SIDE ROADS, INTERSECTIONS, AND DRIVEWAYS**

SCALE: NONE SHEET 1 OF 1 SHEETS STA. TO STA.

| F.A.U. RTE. | SECTION | COUNTY | TOTAL SHEETS | SHEET NO. |
|---------------------------|------------|--------|--------------------|-----------|
| 1600 | 2020-119-I | COOK | 14 | 11 |
| TC-10 | | | CONTRACT NO. 62L97 | |
| ILLINOIS FED. AID PROJECT | | | | |

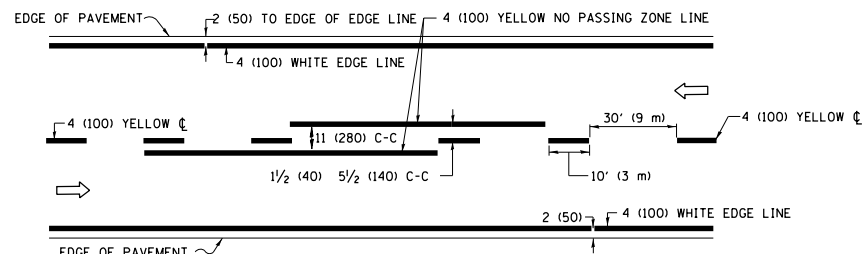

2-LANE ROADWAY

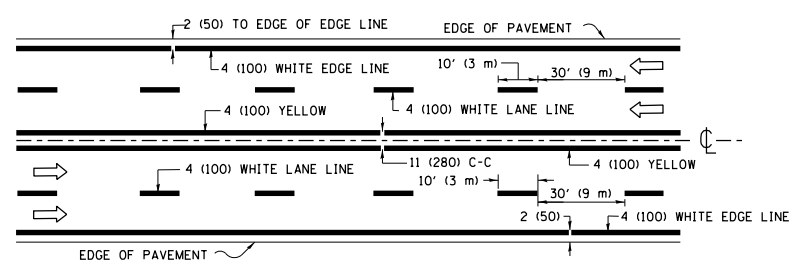

MULTI-LANE UNDIVIDED

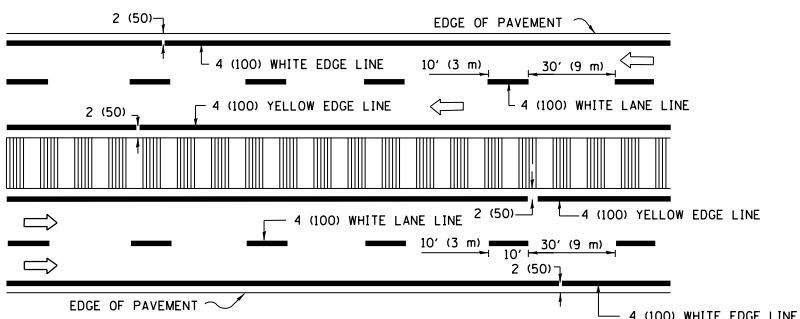

MULTI-LANE DIVIDED WITH MEDIAN

TYPICAL LANE AND EDGE LINE MARKING

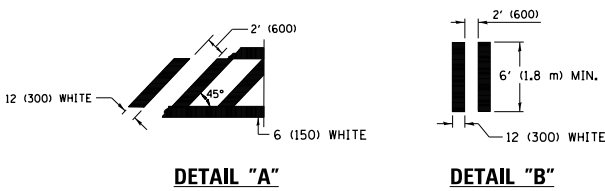
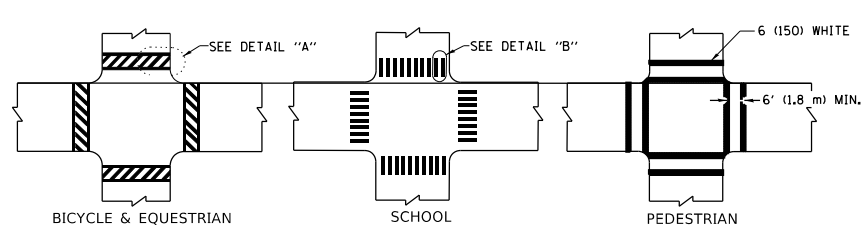

TYPICAL CROSSWALK MARKING

* MARKINGS SHALL BE INSTALLED PARALLEL TO THE CENTERLINE OF THE ROAD WHICH IT CROSSES

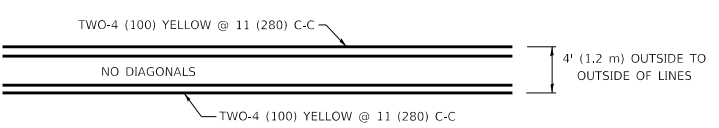

4' (1.2 m) WIDE MEDIANS ONLY

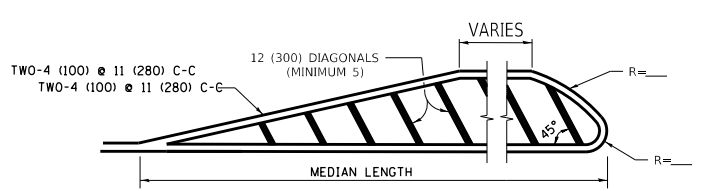

MEDIANS OVER 4' (1.2 m) WIDE

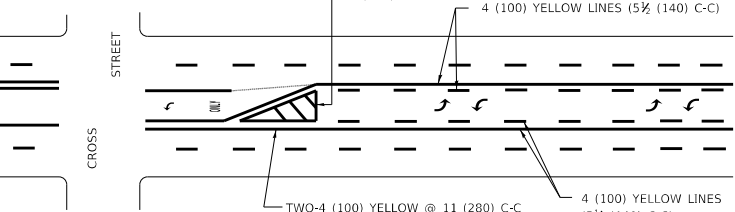

MEDIAN WITH TWO-WAY LEFT TURN LANE

TYPICAL PAINTED MEDIAN MARKING

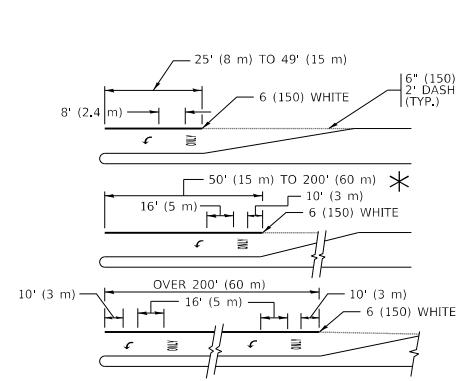

TYPICAL LEFT (OR RIGHT) TURN LANE

TYPICAL TURN LANE MARKING

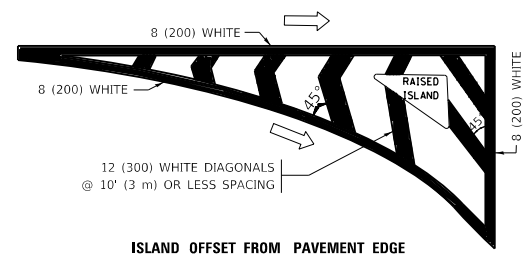

ISLAND OFFSET FROM PAVEMENT EDGE

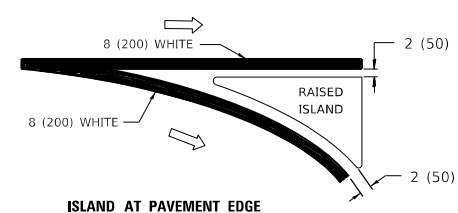

ISLAND AT PAVEMENT EDGE

TYPICAL ISLAND MARKING

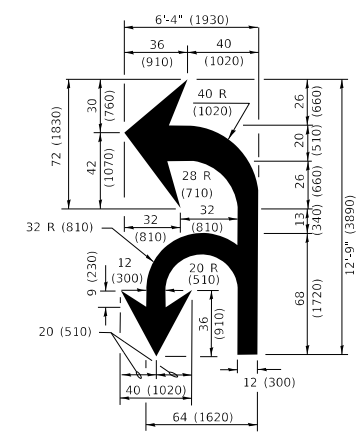

COMBINATION LEFT AND U-TURN

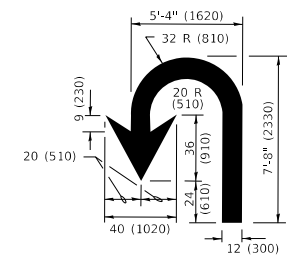

U-TURN

LANE REDUCTION TRANSITION
* LANE REDUCTION ARROWS REQUIRED AT SPEEDS OF 45 MPH OR GREATER OR WHEN SPECIFIED IN PLANS.

| D(FT) | SPEED LIMIT |
|-------|-------------|
| 345 | 30 |
| 425 | 35 |
| 500 | 40 |
| 580 | 45 |
| 665 | 50 |
| 750 | 55 |

| TYPE OF MARKING | WIDTH OF LINE | PATTERN | COLOR | SPACING / REMARKS |
|---------------------------------------------------------------------------------------------------|-----------------------------------------------------------------------------------------------|------------------------------|---------------------------------------------------------|--------------------------------------------------------------------------------------------------------------------------------------------------------------------|
| CENTERLINE ON 2 LANE PAVEMENT | 4 (100) | SKIP-DASH | YELLOW | 10' (3 m) LINE WITH 30' (9 m) SPACE |
| CENTERLINE ON MULTI-LANE UNDIVIDED PAVEMENT | 2 @ 4 (100) | SOLID | YELLOW | 11 (280) C-C |
| NO PASSING ZONE LINES: FOR ONE DIRECTION FOR BOTH DIRECTIONS | 4 (100) 2 @ 4 (100) | SOLID SOLID | YELLOW YELLOW | 5 1/2 (140) C-C FROM SKIP-DASH CENTERLINE 11 (280) C-C OMIT SKIP-DASH CENTERLINE BETWEEN |
| LANE LINES | 4 (100) 5 (125) ON FREEWAYS | SKIP-DASH SKIP-DASH | WHITE WHITE | 10' (3 m) LINE WITH 30' (9 m) SPACE |
| DOTTED LINES (EXTENSIONS OF CENTER, LANE OR TURN LANE MARKINGS) | SAME AS LINE BEING EXTENDED | SKIP-DASH | SAME AS LINE BEING EXTENDED | 2' (600) LINE WITH 6' (1.8 m) SPACE |
| EDGE LINES | 4 (100) | SOLID | YELLOW-LEFT WHITE-RIGHT | OUTLINE MEDIANS IN YELLOW |
| TURN LANE MARKINGS | 6 (150) LINE; FULL SIZE LETTERS & SYMBOLS (8' (2.4m)) | SOLID | WHITE | SEE TYPICAL TURN LANE MARKING DETAIL |
| TWO WAY LEFT TURN MARKING | 2 @ 4 (100) EACH DIRECTION 8' (2.4m) LEFT ARROW | SKIP-DASH AND SOLID IN PAIRS | YELLOW WHITE | 10' (3 m) LINE WITH 30' (9 m) SPACE FOR SKIP-DASH; 5 1/2 (140) C-C BETWEEN SOLID LINE AND SKIP-DASH LINE SEE TYPICAL TWO-WAY LEFT TURN MARKING DETAIL |
| CROSSWALK LINES (PEDESTRIAN) A. DIAGONALS (BIKE & EQUESTRIAN) B. LONGITUDINAL BARS (SCHOOL) | 2 @ 6 (150) 12 (300) @ 45° 12 (300) @ 90° | SOLID SOLID SOLID | WHITE WHITE WHITE | NOT LESS THAN 6' (1.8 m) APART 2' (600) APART 2' (600) APART SEE TYPICAL CROSSWALK MARKING DETAILS. |
| STOP LINES | 24 (600) | SOLID | WHITE | PLACE 4' (1.2 m) IN ADVANCE OF AND PARALLEL TO CROSSWALK, IF PRESENT, OTHERWISE, PLACE AT DESIRED STOPPING POINT, PARALLEL TO CROSSROAD CENTERLINE, WHERE POSSIBLE |
| PAINTED MEDIANS | 2 @ 4 (100) WITH 12 (300) DIAGONALS @ 45° NO DIAGONALS USED FOR 4' (1.2 m) WIDE MEDIANS | SOLID | YELLOW: TWO WAY TRAFFIC WHITE: ONE WAY TRAFFIC | 11 (280) C-C FOR THE DOUBLE LINE SEE TYPICAL PAINTED MEDIAN MARKING. |
| GORE MARKING AND CHANNELIZING LINES | 8 (200) WITH 12 (300) DIAGONALS @ 45° | SOLID | WHITE | DIAGONALS: 15' (4.5 m) C-C (LESS THAN 30MPH (50 km/h)) 20' (6 m) C-C 30MPH (50 km/h) TO 45MPH (70 km/h) 30' (9 m) C-C (OVER 45MPH (70 km/h)) |
| RAILROAD CROSSING | 24 (600) TRANSVERSE LINES "RR" IS 6' (1.8 m) LETTERS: 16 (400) LINE FOR "X" | SOLID | WHITE | SEE STATE STANDARD 780001 AREA OF: "R"=3.6 SQ. FT. (0.33 m²) EACH "X"=54.0 SQ. FT. (5.0 m²) |
| SHOULDER DIAGONALS (REQUIRED FOR SHOULDERS > 8') | 12 (300) @ 45° | SOLID | WHITE - RIGHT YELLOW - LEFT | 50' (15 m) C-C (LESS THAN 30MPH (50 km/h)) 75' (22.5 m) C-C 30 MPH (50 km/h) TO 45MPH (70 km/h) 150' (45 m) C-C (OVER 45MPH (70 km/h)) |
| U TURN ARROW | SEE DETAIL | SOLID | WHITE | 16.3 SF |
| 2 ARROW COMBINATION LEFT AND U TURN | SEE DETAIL | SOLID | WHITE | 30.4 SF |

FOR FURTHER DETAILS ON PAVEMENT MARKING REFER TO STANDARD SPECIFICATIONS FOR ROAD AND BRIDGE CONSTRUCTION AND STATE STANDARD 780001.

All dimensions are in inches (millimeters) unless otherwise shown.

MODEL: Default
FILE: h:\work\pub\planroom\ada\illinois.gov\p\DOT\Documents\DOT_Offices\Distdet_1\Projects\151920\CADD\Data\Design\Dist151920.dgn

| USER NAME | DESIGNED | REVISION | DATE |
|------------------------------|-----------|----------------------|------|
| = hamwim | - EVERS | - C. JUCIUS 09-09-09 | |
| | - | - C. JUCIUS 07-01-13 | |
| PLOT SCALE = 100.0000' / in. | CHECKED - | - C. JUCIUS 12-21-15 | |
| PLOT DATE = 6/25/2020 | DATE - | - C. JUCIUS 04-12-16 | |

**STATE OF ILLINOIS
DEPARTMENT OF TRANSPORTATION**

**DISTRICT ONE
TYPICAL PAVEMENT MARKINGS**

| | | | | |
|-------------|---------|-------------|------|---------|
| SCALE: NONE | SHEET 1 | OF 2 SHEETS | STA. | TO STA. |
|-------------|---------|-------------|------|---------|

| F.A.U. RTE. | SECTION | COUNTY | TOTAL SHEETS | SHEET NO. |
|--------------|------------|--------------------|------------------|-----------|
| 1600 | 2020-119-I | COOK | 14 | 12 |
| TC-13 | | CONTRACT NO. 62L97 | | |
| | | ILLINOIS | FED. AID PROJECT | |

TURN BAY ENTRANCE AT START OF LANE CLOSURE TAPER

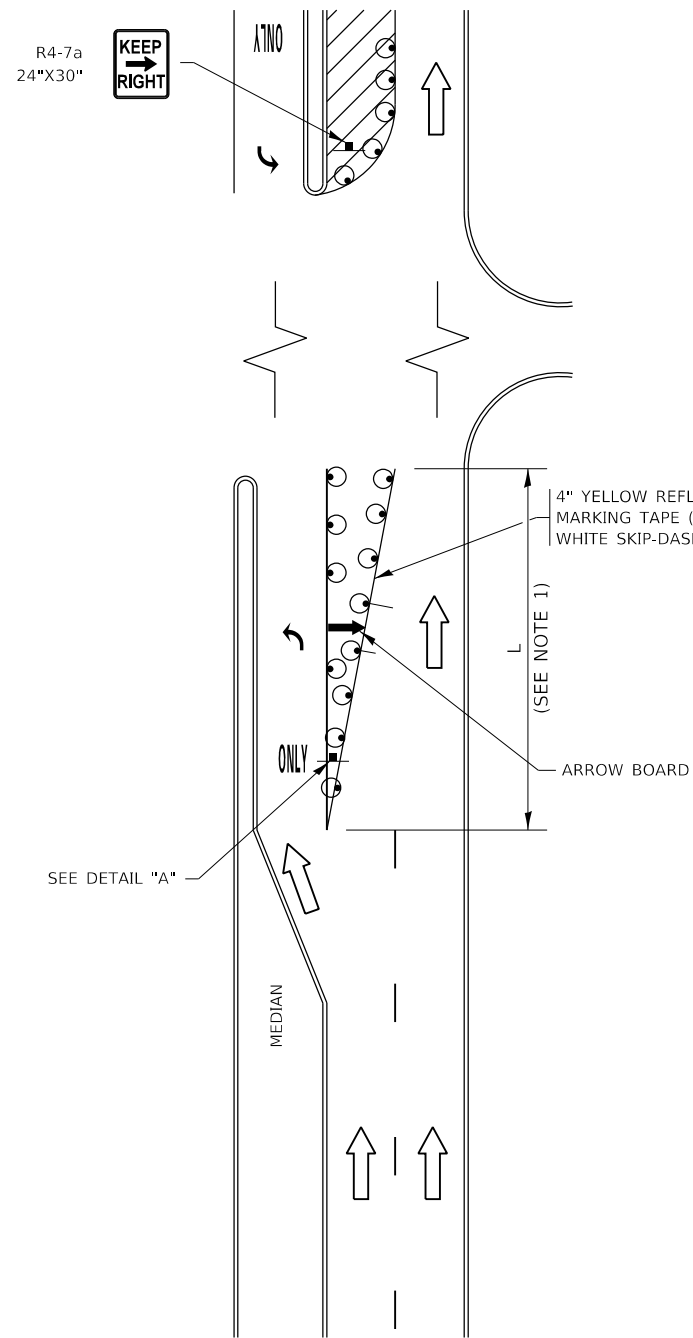

FIGURE 1

TURN BAY ENTRANCE WITHIN A LANE CLOSURE

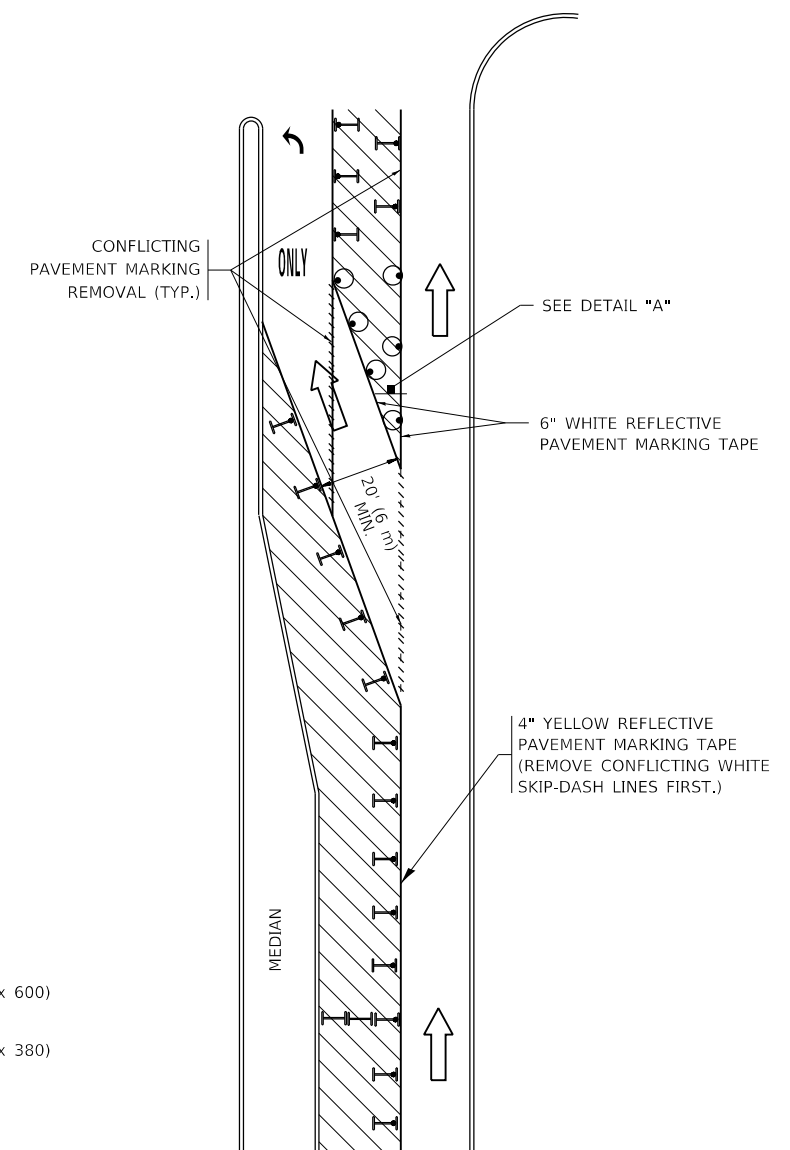

FIGURE 2

LEGEND

- WORK AREA
- LANE OPEN TO TRAFFIC
- ARROW BOARD
- TYPE I OR II BARRICADE OR DRUM WITH STEADY BURN LIGHT
- DRUM WITH STEADY BURN LIGHT
- SIGN ASSEMBLY
- TYPE I OR II CHECK BARRICADE WITH FLASHING LIGHT

NOTES:

1. A) WHEN "L" IS \leq THE STORAGE LENGTH OF THE TURN LANE (AS SHOWN IN FIG. 1), USE FIGURE 1.
 B) WHEN "L" IS $>$ THE STORAGE LENGTH OF THE TURN LANE OR THE TURN LANE IS WITHIN THE LANE CLOSURE, USE FIGURE 2.
2. CONES MAY BE SUBSTITUTED FOR BARRICADES OR DRUMS AT HALF THE SPACING DURING DAY OPERATIONS. CONES SHALL BE A MINIMUM OF 28 (710) IN HEIGHT.
3. LIGHTS WILL NOT BE REQUIRED ON BARRICADES OR DRUMS FOR DAY OPERATIONS. ALL LIGHTS SHALL BE MONODIRECTIONAL.
4. REFLECTIVE TEMPORARY PAVEMENT MARKINGS SHALL BE PLACED THROUGHOUT THE BARRICADED AREAS OF EACH TURN BAY AS SHOWN WHERE THE CLOSURE TIME IS GREATER THAN FOURTEEN (14) DAYS.
5. THIS APPLICATION ALSO APPLIES WHEN WORK IS BEING PERFORMED IN THE RIGHT LANE(S) AND THE RIGHT TURN BAY IS TO REMAIN OPEN. UNDER THIS CONDITION, "RIGHT TURN LANE" R3-1100R 24 x 24 (600 x 600) AND M6-2R 21 x 15 (530 x 380) SHALL BE USED.
6. THESE CONTROLS SHALL SUPPLEMENT MAINLINE TRAFFIC CONTROL FOR LANE CLOSURES.
7. THE SIGNS SHALL BE MOUNTED ABOVE THE BARRICADES/DRUMS ON SEPARATE SIGN SUPPORTS THAT MEET NCHRP 350 OR MASH REQUIREMENTS.
8. TRAFFIC CONTROL AND PROTECTION AT TURN BAYS (TO REMAIN OPEN TO TRAFFIC) SHALL BE INCLUDED IN THE COST OF SPECIFIED TRAFFIC CONTROL STANDARDS OR ITEMS.

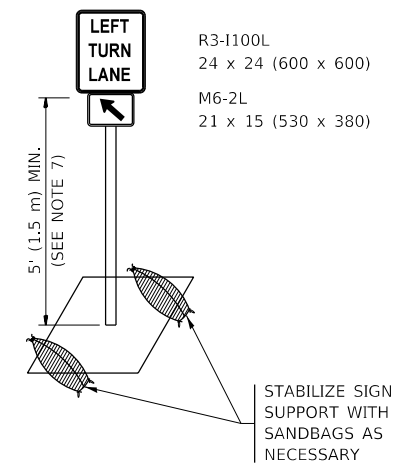

DETAIL A

All dimensions are in inches (millimeters) unless otherwise shown.

MODEL: Default
 FILE: h:\mhc_p\pub\planroom.d\at\illinois.gov\PROJECTS\DOT Documents\DOT Offices\District 1\Projects\151920\CaddData\Design\DESIGN.dgn

| | | |
|------------------------------|----------------------------------|--------------------------------|
| USER NAME = hamwim | DESIGNED - T. RAMMACHER 09-08-94 | REVISED - R. BORO 09-14-09 |
| | DRAWN - A. HOUSEH 11-07-95 | REVISED - A. SCHUETZE 07-01-13 |
| PLOT SCALE = 100,0000' / in. | CHECKED - A. HOUSEH 10-12-96 | REVISED - A. SCHUETZE 09-15-16 |
| PLOT DATE = 6/25/2020 | DATE - T. RAMMACHER 01-06-00 | REVISED - |

**STATE OF ILLINOIS
DEPARTMENT OF TRANSPORTATION**

**TRAFFIC CONTROL AND PROTECTION AT TURN BAYS
(TO REMAIN OPEN TO TRAFFIC)**

SCALE: NONE SHEET 1 OF 1 SHEETS STA. TO STA.

| | | | | |
|---------------------------|------------|--------------------|--------------|-----------|
| F.A.U. RTE. | SECTION | COUNTY | TOTAL SHEETS | SHEET NO. |
| 1600 | 2020-119-I | COOK | 14 | 13 |
| TC-14 | | CONTRACT NO. 62L97 | | |
| ILLINOIS FED. AID PROJECT | | | | |

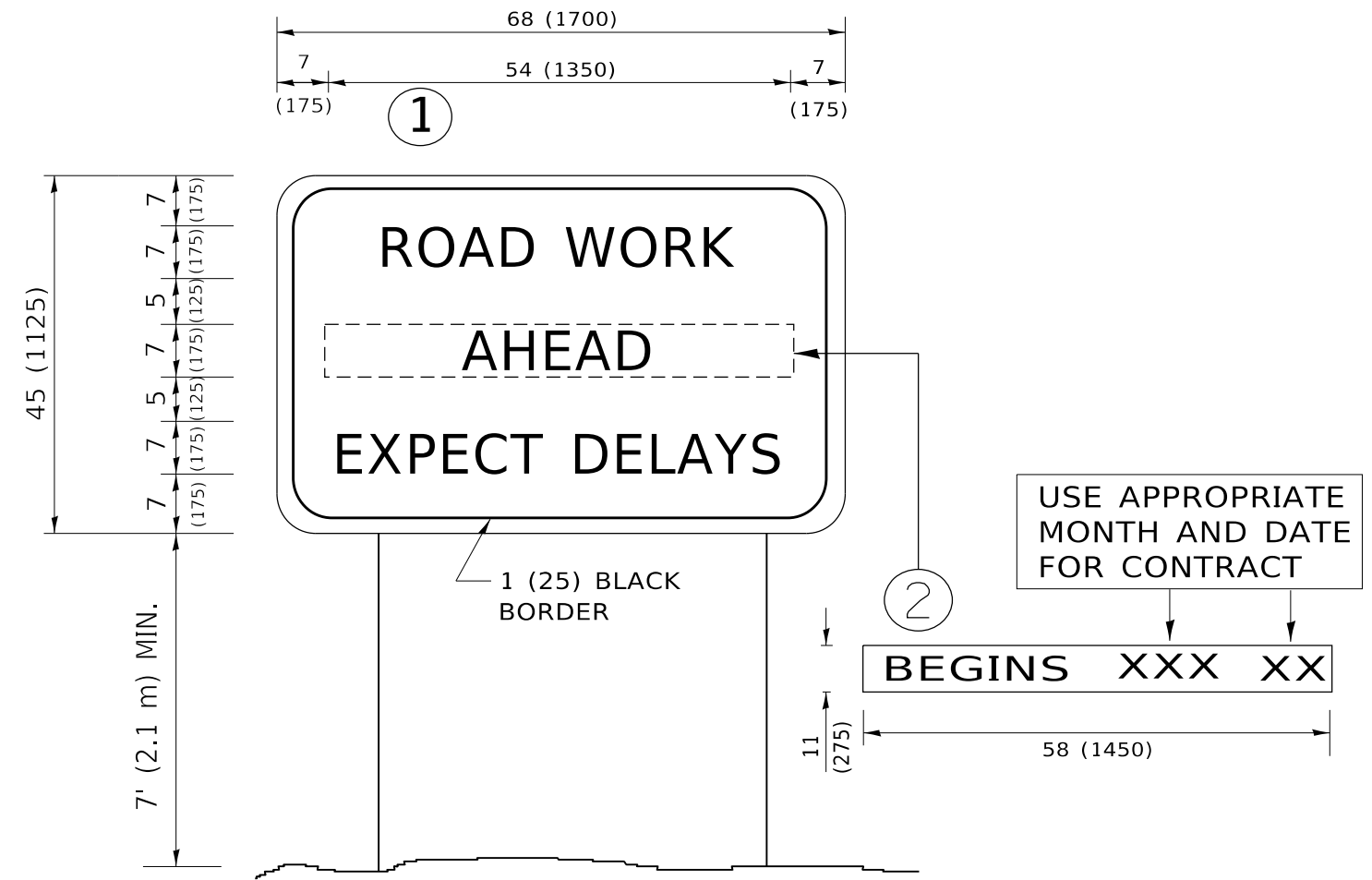

NOTES:

1. USE BLACK LETTERING ON ORANGE BACKGROUND.
2. ERECT SIGNS IN ADVANCE OF THE LOCATION FOR THE "ROAD CONSTRUCTION AHEAD" SIGN AT LOCATIONS AS DIRECTED BY THE ENGINEER.
3. ERECT SIGN ① WITH INSTALLED PANEL ② ONE WEEK PRIOR TO THE START OF CONSTRUCTION.
4. REMOVE PANEL ② SOON AFTER THE START OF CONSTRUCTION.
5. SEE SPECIAL PROVISION FOR "TEMPORARY INFORMATION SIGNING" FOR ADDITIONAL INFORMATION.
6. ONE SIGN ASSEMBLY EQUALS 25.70 SQ. FT. (2.3 SQ. M.)
7. SHALL BE PAID FOR AS TEMPORARY INFORMATION SIGNING.

ALL DIMENSIONS ARE IN INCHES (MILLIMETERS) UNLESS OTHERWISE SHOWN.

MODEL: Default
FILE: \\hpc1201\pub\hpc\room\dat\illinois.gov\PWIDOT\Documents\IDOT_Offices\IDOT\1\Projects\151920\CADD\Design\Design\DRS\4.dgn

| | | |
|-------------------------------|------------|---------------------------------|
| USER NAME = hamwim | DESIGNED - | REVISED - R. MIRS 09-15-97 |
| | DRAWN - | REVISED - R. MIRS 12-11-97 |
| PLOT SCALE = 100.0000 ' / in. | CHECKED - | REVISED - T. RAMMACHER 02-02-99 |
| PLOT DATE = 6/25/2020 | DATE - | REVISED - C. JUCIUS 01-31-07 |

**STATE OF ILLINOIS
DEPARTMENT OF TRANSPORTATION**

**ARTERIAL ROAD
INFORMATION SIGN**

SCALE: NONE SHEET 1 OF 1 SHEETS STA. TO STA.

| | | | | |
|---------------------------|------------|--------|--------------------|-----------|
| F.A.U. RTE. | SECTION | COUNTY | TOTAL SHEETS | SHEET NO. |
| 1600 | 2020-119-I | COOK | 14 | 14 |
| TC-22 | | | CONTRACT NO. 62L97 | |
| ILLINOIS FED. AID PROJECT | | | | |