

STATE OF ILLINOIS
DEPARTMENT OF TRANSPORTATION

F.A. RTE.	SECTION	COUNTY	TOTAL SHEETS	SHEET NO.
D9	TREE PRUNING 2018-1	SALINE	5	1
ILLINOIS			CONTRACT NO. 78590	

* FAP 869/ FAP 881 (IL 34/US 45)

D-99-042 -17

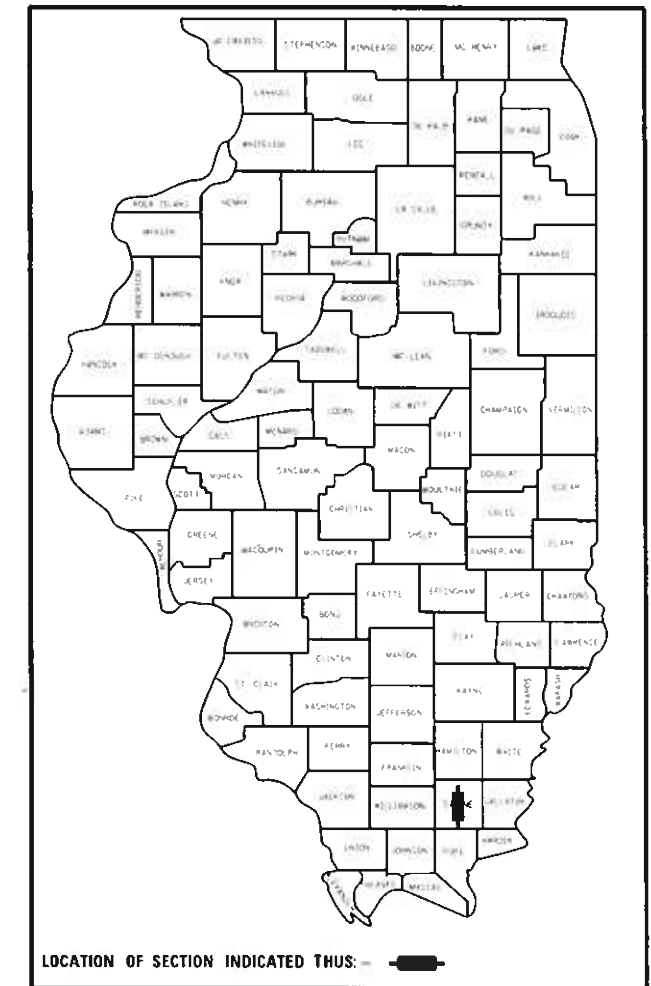

PROPOSED
HIGHWAY PLANS

FAP869(IL 34)/FAP881(US 45)
D9 TREE PRUNING 2018-1

TREE PRUNING
SALINE COUNTY

FOR INDEX OF SHEETS, SEE SHEET NO. 3
FOR SUMMARY OF QUANTITIES, SEE SHEET NO. 4

TRAFFIC DATA	
	2018
IL 34-FRANKLIN CO LINE TO GALLATIA	
ADT =	3,140
IL 34-GALLATIA TO RALEIGH	
ADT =	4,740
IL 34- RALEIGH TO HARRISBURG	
ADT =	4,120
US 45- HARRISBURG TO CARRIER MILLS	
ADT =	5,150
US 45- CARRIER MILLS TO STONE FORT	
ADT =	1,960

TOWNSHIPS

GALATIA, RALEIGH, HARRISBURG,
CARRIER MILLS, & STONEFORT

LOCATION #1-PROJECT BEGINS-US45
STATION 706+35

LOCATION #1-PROJECT ENDS-US45
STATION 78+25

LOCATION #2-PROJECT ENDS-IL 34
STATION 1608+85

LOCATION #2-PROJECT BEGINS-IL34
FRANKLIN CO. LINE

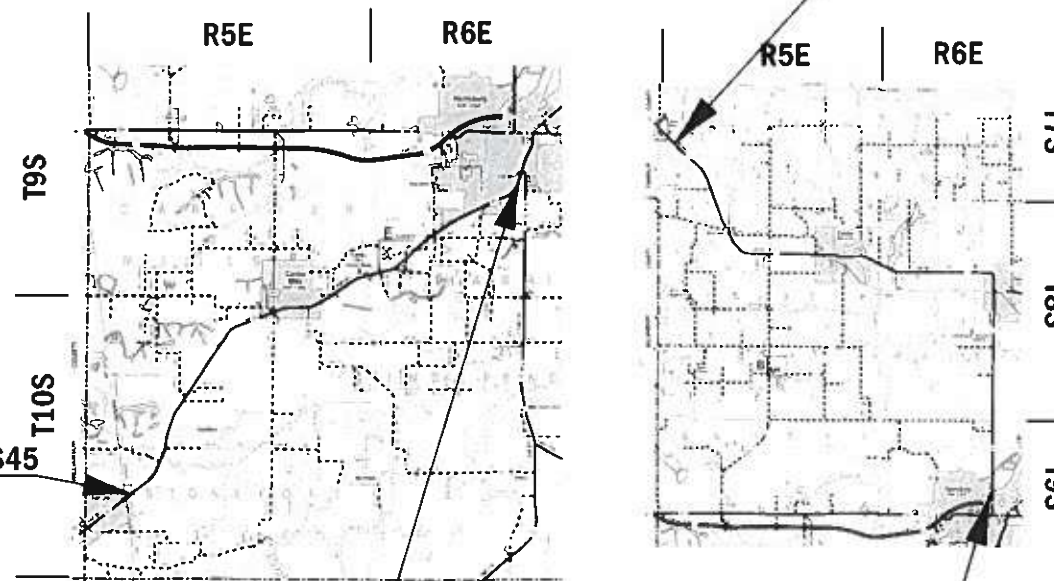

DESIGN DESIGNATION : NA
COORDINATE SYSTEM : NA
POSTED SPEED : VARIES

J.U.L.I.E.
JOINT UTILITY LOCATION INFORMATION FOR EXCAVATION
1-800-892-0123
OR 811

PROJECT ENGINEER: VALERIE ROLLA (618) 351-5214
PROJECT DESIGNER: ELISE KNOP (618) 351-5212

GROSS LENGTH = 86093 FT. = 16.3 MILES
NET LENGTH = 86093 FT. = 16.3 MILES

CONTRACT NO. 78590

STATE OF ILLINOIS
DEPARTMENT OF TRANSPORTATION

SUBMITTED 06-11-2020
[Signature]
REGION FIVE ENGINEER

August 14, 2020
[Signature]
ENGINEER OF DESIGN AND ENVIRONMENT

August 14, 2020
[Signature]
DIRECTOR OF HIGHWAYS PROJECT IMPLEMENTATION

PRINTED BY THE AUTHORITY
OF THE STATE OF ILLINOIS

Prepared By: Charles Stein
DISTRICT STUDIES & PLANS ENGINEER

Examined By: _____
DISTRICT LAND ACQUISITION ENGINEER

Examined By: Carrie Miller
DISTRICT PROGRAM DEVELOPMENT ENGINEER

Examined By: Kevin Kelly
DISTRICT OPERATIONS ENGINEER

Examined By: [Signature]
DISTRICT PROJECT IMPLEMENTATION ENGINEER

Examined By: Danley J. [Signature]
DISTRICT CONSTRUCTION ENGINEER

Examined By: [Signature]
DISTRICT MATERIALS ENGINEER

MDDP: [unclear]
FILE NAME: [unclear]

USER NAME = r01pav	DESIGNED - _____	REVISED - _____
DRAY/HI - _____	CHECKED - _____	REVISED - _____
DATE - _____	REVISED - _____	REVISED - _____

**STATE OF ILLINOIS
DEPARTMENT OF TRANSPORTATION**

SIGNATURE SHEET

SCALE _____ SHEET _____ OF _____ SHEETS STA _____ TO STA _____

F.A. RTE	SECTION	COUNTY	TOTAL SHEETS	SHEET NO.
VAR	D9_TREE PRUNING 2018-1	SALINE	5	2
			CONTRACT NO. 78590	
ILLINOIS FED. AID PROJECT				

INDEX OF SHEETS

SHEET NO	DESCRIPTION
1	COVER SHEET
2	SIGNATURE SHEET
3	INDEX OF SHEETS, HIGHWAY STANDARDS, STATION EQUATIONS & COMMITMENTS
4	SUMMARY OF QUANTITIES
5	SCHEDULE: TREE PRUNING

GENERAL NOTES

ANY DAMAGE DONE TO THE SHOULDERS AND FORSLOPE WILL BE REPAIRED AT NO COST TO THE DEPARTMENT.

COMMITMENTS: NO TREE TRIMMING WILL BE ALLOWED BETWEEN APRIL 1ST AND SEPTEMBER 30TH.

STATION EQUATIONS

IL 34	US 45
STA 914+69.5 BK = STA 967+93 AH	STA 0+00 BK = STA -4+73 AH
STA 983+81.6 BK = STA 983+75.5 AH	STA 338+72.3 BK = STA 338+77.5 AH
STA 1108+79.3 BK = STA 1113+00AH	STA 378+07.3 BK = STA 378+00 AH
STA 1210+99.6 BK = STA 1209+00 AH	STA 416+03.7 BK = STA 416+00 AH
STA 1403+22.6 BK = STA 1400+36.8 AH	STA 422+00 BK = STA 422+03.4 AH
	STA 613+55.4 BK = 613+57.8 AH
	STA 635+00 BK = STA 635+20.2 AH
	STA 701+52.3 BK = STA 701+00

HIGHWAY STANDARDS

- 000001-07_STANDARDSYMBOLSABBREVIATIONS&PATTERNS
- 701001-02_OFFRDOP-2L2W-15FTMINFROMEOP
- 701006-05_OFFRDOP-2L2W-15FTTOEOP
- 701201-05_LNCLOSURE2L2W-DAYONLY
- 701901-08_TRAFCNTRLDEVICES

STATE OF ILLINOIS
DEPARTMENT OF TRANSPORTATION

INDEX OF SHEETS, STATION EQUATIONS,
HIGHWAY STANDARDS, & COMMITMENT

SCALE: _____ SHEET ____ OF ____ SHEETS STA. _____ TO STA. _____

F.A. + RTE.	SECTION	COUNTY	TOTAL SHEETS	SHEET NO.
VAR	D9_TREE PRUNING 2018-1	SALINE	5	3
				CONTRACT NO. 78590
ILLINOIS FED. AID PROJECT				

TREE PRUNING

ROUTE	COUNTY	SIDE	STATION	TO	STATION	OMISSIONS	LENGTH	TREE PRUNING
						FT	FT	UNIT
US 45	SALINE	RT	689+00	TO	706+35		1785	17.85
US 45	SALINE	RT	644+56	TO	671+00	250	2394	23.94
US 45	SALINE	LT	612+00	TO	644+56		3236	32.36
US 45	SALINE	RT	491+50	TO	586+60		9510	95.1
US 45	SALINE	LT	506+70	TO	583+00		7630	76.3
US 45	SALINE	RT	380+75	TO	483+00		10225	102.25
US 45	SALINE	LT	380+75	TO	441+50		6075	60.75
US 45	SALINE	RT	151+00	TO	240+50		8950	89.5
US 45	SALINE	RT	78+25	TO	125+75		4750	47.5
IL 34	SALINE	RT	706+00	TO	719+70		1370	13.7
IL 34	SALINE	LT	706+50	TO	714+50		800	8
IL 34	SALINE	RT	730+40	TO	733+20		280	2.8
IL 34	SALINE	RT	742+85	TO	812+15		6930	69.3
IL 34	SALINE	LT	775+25	TO	805+00		2975	29.75
IL 34	SALINE	RT	823+00	TO	835+75		1275	12.75
IL 34	SALINE	LT	827+00	TO	835+75		875	8.75
IL 34	SALINE	RT	893+15	TO	903+00		985	9.85
IL 34	SALINE	LT/RT	990+85	TO	992+00		230	2.3
IL 34	SALINE	LT	1211+45	TO	1221+50		1005	10.05
IL 34	SALINE	LT	1264+16	TO	1266+14		198	1.98
IL 34	SALINE	LT	1278+80	TO	1306+00		2720	27.2
IL 34	SALINE	LT	1515+15	TO	1559+40		4425	44.25
IL 34	SALINE	RT	1527+65	TO	1557+00		2935	29.35
IL 34	SALINE	RT	1563+50	TO	1608+85		4535	45.35
TOTALS=								861

MODEL: Default
 FILE NAME: p:\pub\arcson.com.dwg
 PROJECT: 78590\CADD\Drawings\DOT_Offices\District_9\Projects\78590\CADD\Drawings\78590_sht.dwg

USER NAME = rollavr PLOT SCALE = 100.0000' / in. PLOT DATE = 6/2/2020	DESIGNED - _____ DRAWN - _____ CHECKED - _____ DATE - _____	REVISED - _____ REVISED - _____ REVISED - _____ REVISED - _____	STATE OF ILLINOIS DEPARTMENT OF TRANSPORTATION	TREE PRUNING SCHEDULE	SCALE: _____ SHEET _____ OF _____ SHEETS STA. _____ TO STA. _____	F.A. + RTE. - VAR D9_TREE PRUNING 2018-1 COUNTY SALINE TOTAL SHEETS 5 SHEET NO. 5 CONTRACT NO. 78590 ILLINOIS FED. AID PROJECT
---	--	--	---	------------------------------	---	---