

PROFILE	SURVEYED	BY	DATE
NOTE BOOK	GRADE CHECKED		
NO.	BY		
	STRUCTURE NOTATIONS		

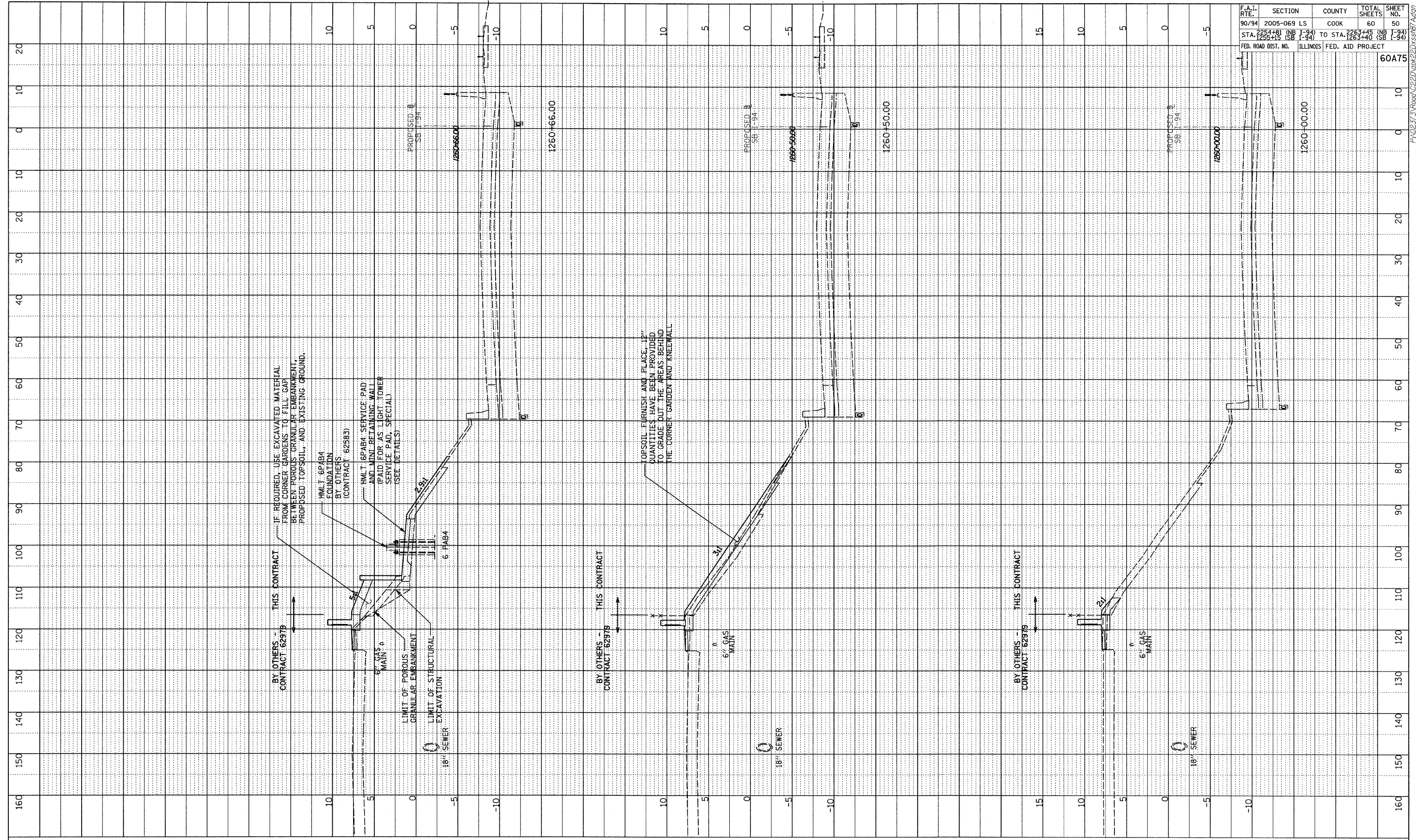

F.A.I. RTE.	SECTION	COUNTY	TOTAL SHEETS	SHEET NO.
90/94	2005-069 LS	COOK	60	50
STA. 2254+81 (NB I-94)				
1255+15 (SB I-94)				
FED. ROAD DIST. NO.	ILLINOIS	FED. AID PROJECT		
				60A75

TYLIN INTERNATIONAL

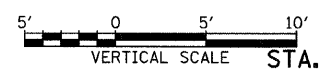
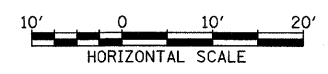

SB I-94 (DAN RYAN EXPRESSWAY)
STA. 1260+00.00 TO STA. 1260+66.00

F:\02\3\Area\222\gpk22\Drawn\7.dgn