

F.A.I. RTE.	SECTION	COUNTY	TOTAL SHEETS	SHEET NO.
57		WILL	303	25
STA.		TO STA.		
FED. ROAD DIST. NO.		ILLINOIS FED. AID PROJECT		
+99162) R-389-110-1-BR-2		CONTRACT: 62253		

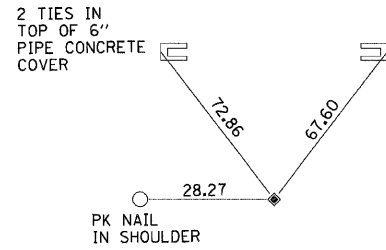

HORIZONTAL CONTROL POINTS



8" SPIKE IN C I-57 NORTH END POINT IN GRASS MEDIAN
HORIZONTAL CONTROL POINT NO. 13

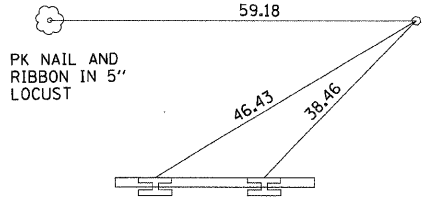

PK NAIL IN WEST EDGE OF PAVEMENT I-57 SB END POINT FOR SB EXIT RAMP TO MONEE ROAD
HORIZONTAL CONTROL POINT NO. 14

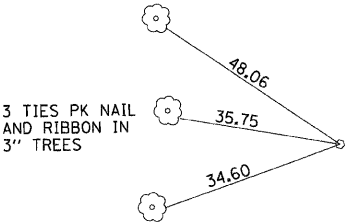

PK NAIL IN WEST SHOULDER OF SB I-57
HORIZONTAL CONTROL POINT NO. 15

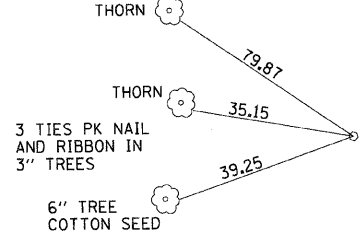

PK NAIL IN WEST SHOULDER OF SB I-57
HORIZONTAL CONTROL POINT NO. 16

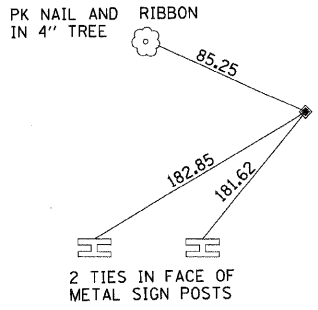

8" SPIKE IN GRASS NEAR WEST SHOULDER SB I-57
HORIZONTAL CONTROL POINT NO. 17

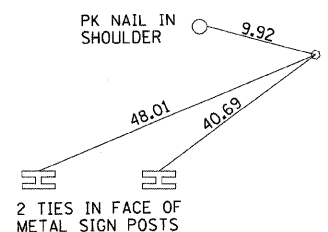

PK NAIL IN WEST EDGE OF PAVEMENT OF I-57 SB AND POINT OF SB EXIT RAMP
HORIZONTAL CONTROL POINT NO. 18

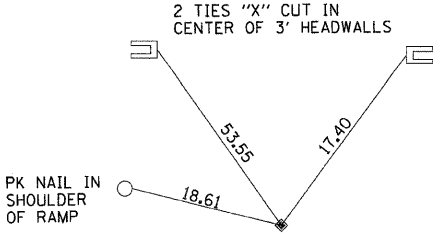

8" SPIKE IN GRASS PI FOR RAMP SB EXIT OF I-57 TO MONEE RD
HORIZONTAL CONTROL POINT NO. 19

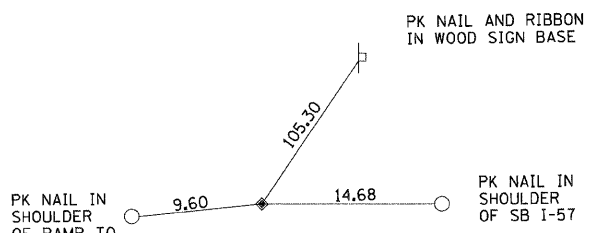

8" SPIKE IN GRASS PI FOR ENTRANCE RAMP FOR SB I-57
HORIZONTAL CONTROL POINT NO. 20

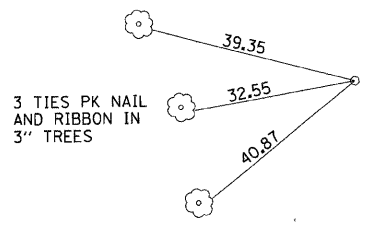

PK NAIL IN EDGE OF PAVEMENT I-57 SB BEGIN POINT FOR SB ENTRANCE RAMP I-57
HORIZONTAL CONTROL POINT NO. 21

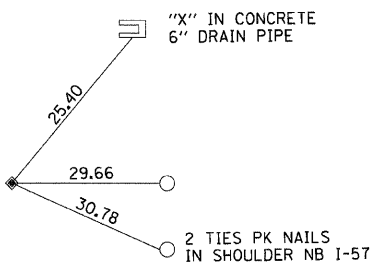

8" SPIKE IN CENTER GRASS MEDIAN I-57 BEGIN POINT
HORIZONTAL CONTROL POINT NO. 22

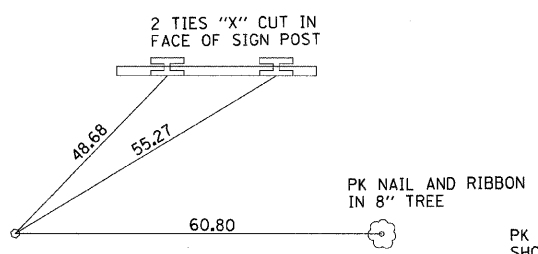

PK NAIL IN EAST EDGE OF PAVEMENT I-57 NB BEGIN POINT FOR NB EXIT RAMP TO MONEE RD.
HORIZONTAL CONTROL POINT NO. 23

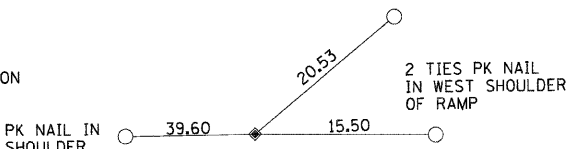

8" SPIKE IN GRASS PI FOR NB EXIT RAMP TO MONEE RD FROM I-57
HORIZONTAL CONTROL POINT NO. 24

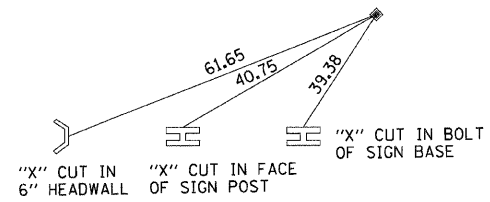

8" SPIKE IN WEST SHOULDER IN SB EXIT RAMP FROM I-57 TO MONEE ROAD
HORIZONTAL CONTROL POINT NO. 26

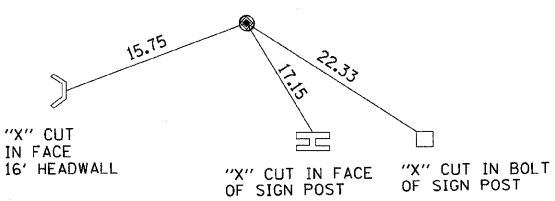

8" SPIKE IN GRASS PI FOR SB EXIT RAMP FROM I-57 TO MONEE ROAD
HORIZONTAL CONTROL POINT NO. 27

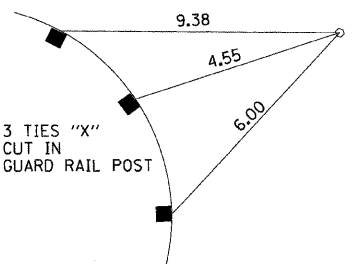

PK NAIL IN BIT SHOULDER OF EXIT RAMP EAST SIDE I-57
HORIZONTAL CONTROL POINT NO. 28

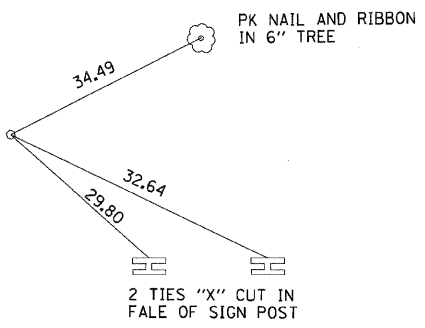

PK NAIL IN EAST SHOULDER OF NB EXIT RAMP FROM I-57 TO MONEE ROAD
HORIZONTAL CONTROL POINT NO. 29

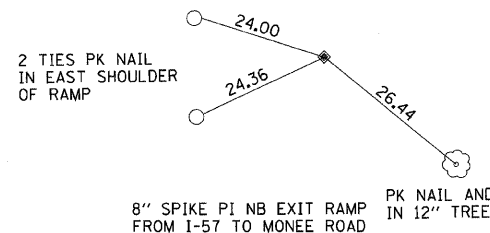

8" SPIKE PI NB EXIT RAMP FROM I-57 TO MONEE ROAD
HORIZONTAL CONTROL POINT NO. 30

REVISIONS	
NAME	DATE

ILLINOIS DEPARTMENT OF TRANSPORTATION
I-57 AT MANHATTAN - MONEE ROAD
ALIGNMENT, TIES, AND BENCHMARKS
3 OF 3

SCALE: VERT. NTS
HORIZ. NTS
DATE 9/19/2008
DRAWN BY ML, NS
CHECKED BY TMW

Clark Dietz
ENGINEERS

DESIGN FIRM REGISTRATION No. 184-009450
118 SOUTH CLINTON STREET SUITE 800
CHICAGO, IL 60661
PHONE : 312.648.9900
FAX : 312.648.0204

p:\022331\plans\sheet\102231A1P1_0003.dgn
8/17/2008