

F.A.I. RTE.	SECTION	COUNTY	TOTAL SHEETS	SHEET NO.
57	*	WILL	303	26

STA. TO STA.  
 FED. ROAD DIST. NO. ILLINOIS FED. AID PROJECT  
 +99(1&2) R-389-1HB-1-BR-2 CONTRACT: 62253

- LEGEND**
- PAVEMENT REMOVAL
  - PAVED SHOULDER REMOVAL
  - BRIDGE APPROACH PAVEMENT REMOVAL
  - CONCRETE CURB AND GUTTER REMOVAL  
-SEE TYPICAL SECTIONS FOR LOCATION OF TYPE AND SIZE
  - DRIVEWAY PAVEMENT REMOVAL
  - HOT-MIX ASPHALT PAVEMENT REMOVAL  
-SEE TYPICAL SECTIONS FOR REMOVAL DEPTH
  - PAVED DITCH REMOVAL
  - GUARDRAIL REMOVAL
  - TREE REMOVAL, IN. DIA.
  - AGGREGATE SHOULDER REMOVAL  
-TO BE INCLUDED IN THE UNIT PRICE FOR EARTH EXCAVATION

- NOTES:**
- 1) SEE DRAINAGE PLAN FOR DRAINAGE STRUCTURE AND SYSTEM REMOVAL
  - 2) SEE BRIDGE PLAN FOR ALL BRIDGE RELATED REMOVAL
  - 3) SEE GENERAL NOTES FOR SPECIAL AND HAZARDOUS WASTE REMOVAL

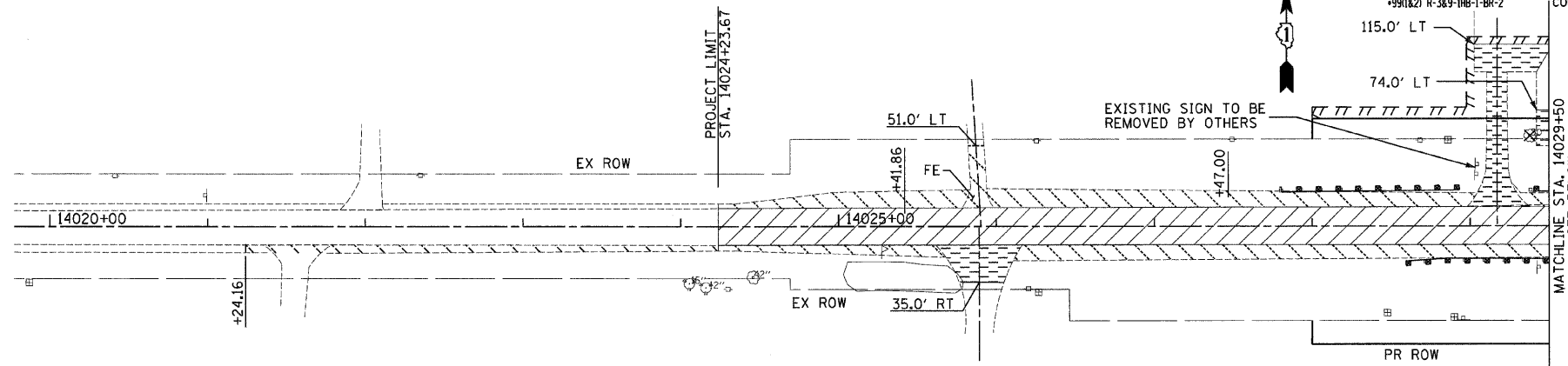

**MANHATTAN-MONEE ROAD**

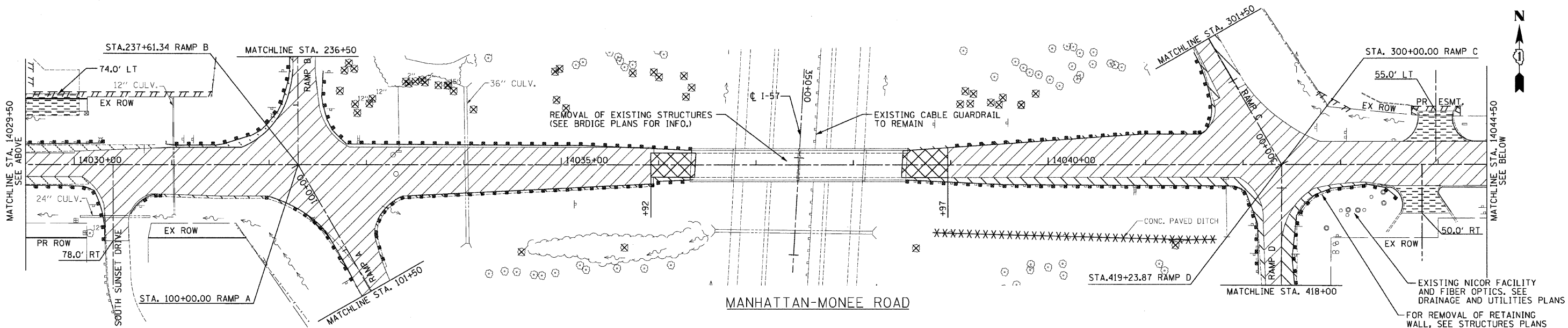

**MANHATTAN-MONEE ROAD**

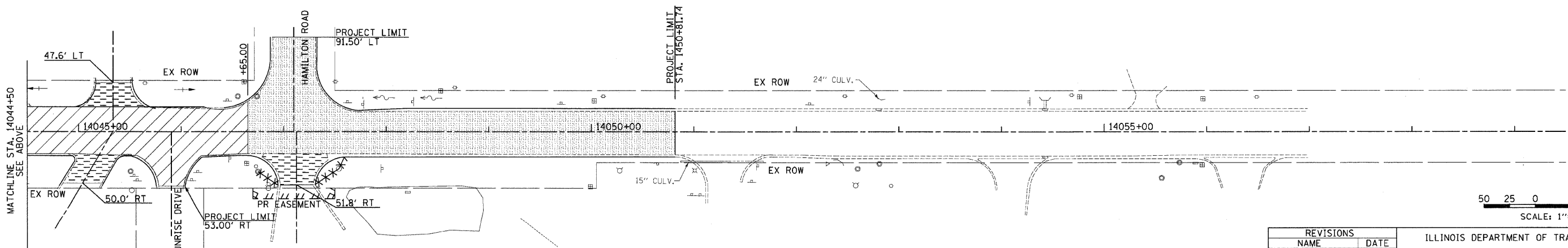

**MANHATTAN-MONEE ROAD**

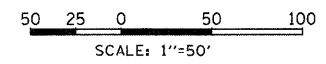

REVISIONS	
NAME	DATE

ILLINOIS DEPARTMENT OF TRANSPORTATION  
 I-57 AT MANHATTAN - MONEE ROAD  
 EXISTING CONDITIONS  
 MANHATTAN - MONEE ROAD  
 SCALE: VERT. NTS  
 HORIZ. 1"=50'  
 DATE 9/19/2008  
 DRAWN BY BDC, GH  
 CHECKED BY TMW

**Clark Dietz**  
 ENGINEERS

DESIGN FIRM REGISTRATION  
 No. 184-000450  
 118 SOUTH CLINTON STREET  
 SUITE 800  
 CHICAGO, IL 60661  
 PHONE : 312.648.9900  
 FAX : 312.648.0204

p:\0223\plans\sheet\1022310MPL 01PL.dgn  
 8/1/2008