

MANHATTAN-MONEE ROAD TRAFFIC CONTROL LEGEND

- TEMPORARY PAVEMENT, 6 IN.
- WORK AREA
- DIRECTION OF TRAFFIC
- ARROW BOARD
- TRAFFIC SIGN
- BARRICADE TYPE II, DRUM OR VERTICAL BARRICADE WITH MONO-DIRECTIONAL STEADY BURNING LIGHT (SEE NOTES FOR SPACING)
- BARRICADE TYPE III WITH STEADY BURNING LIGHT
- TEMPORARY PAVEMENT MARKINGS, TYPE III
 - SKIP-DASH WHITE, 5"
 - SKIP-DASH YELLOW, 5"
 - STOP LINE, 24"
 - SOLID LINE, 4"
 - DOUBLE CENTERLINE, YELLOW, 4"
 - DOTTED LINES (2'-6" SPACE), 4"
- TEMPORARY BARRIER WALL WITH BARRIER WALL REFLECTORS
- TEMPORARY IMPACT ATTENUATORS

MANHATTAN-MONEE ROAD TRAFFIC CONTROL NOTES

BARRICADE TYPE I OR TYPE II	
LOCATION	SPACING
TANGENT	100' CTS
RETURNS	25' CTS
CURVES	25' CTS
SHOULDER TAPERS	50' CTS
TAPERS	12' CTS

F.A.I. RTE.	SECTION	COUNTY	TOTAL SHEETS	SHEET NO.
57		WILL	303	39
STA. 14024+23.67		TO STA. 14029+50		
FED. ROAD DIST. NO. 111		ILLINOIS FED. AID PROJECT		
+991&2) R-3&9-11B-1&R-2		CONTRACT: 62253		

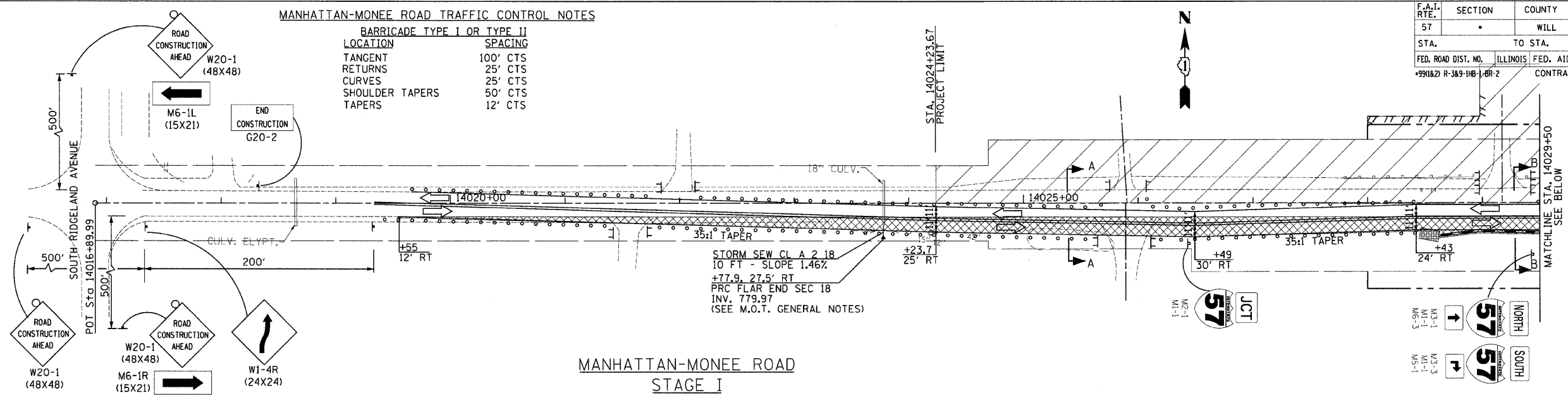

MANHATTAN-MONEE ROAD STAGE I

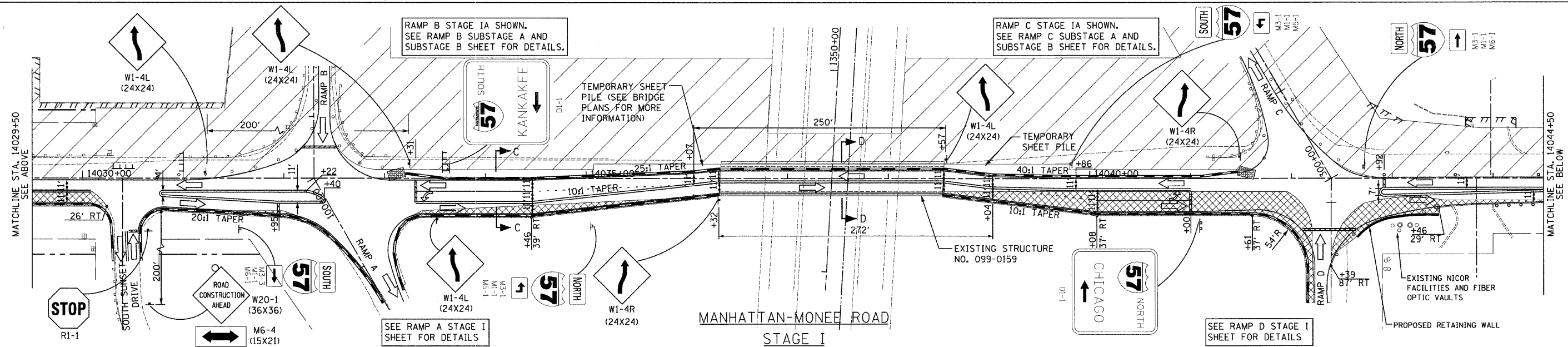

MANHATTAN-MONEE ROAD STAGE I

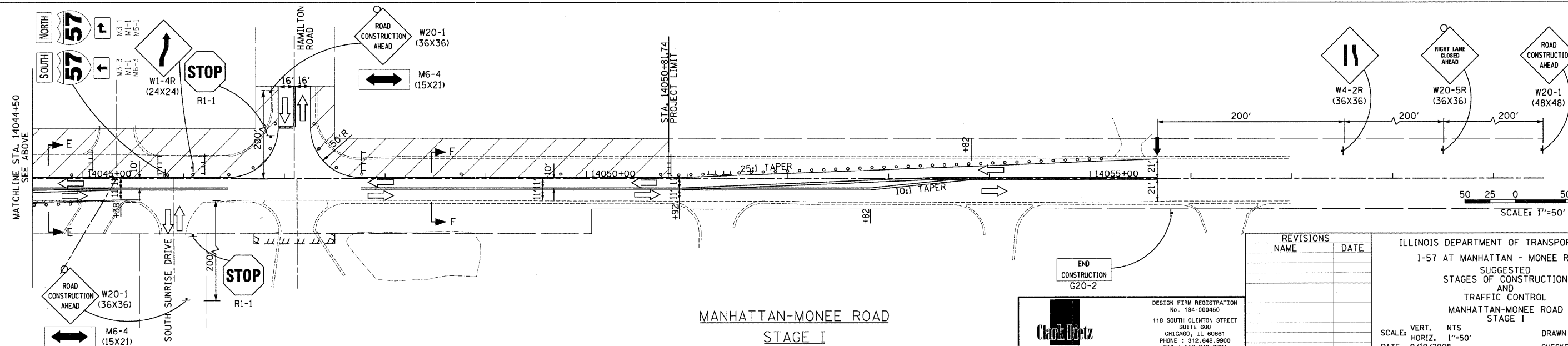

MANHATTAN-MONEE ROAD STAGE I

REVISIONS	
NAME	DATE

ILLINOIS DEPARTMENT OF TRANSPORTATION
 I-57 AT MANHATTAN - MONEE ROAD
 SUGGESTED STAGES OF CONSTRUCTION AND TRAFFIC CONTROL
 MANHATTAN-MONEE ROAD STAGE I
 SCALE: VERT. NTS
 HORIZ. 1"=50'
 DATE 9/19/2008
 DRAWN BY KLM
 CHECKED BY TMW

Clark Dietz
 ENGINEERS
 DESIGN FIRM REGISTRATION No. 184-000450
 SUITE 600
 118 SOUTH CLINTON STREET
 CHICAGO, IL 60661
 PHONE: 312.648.9900
 FAX: 312.648.0204

P:\02231\plans\sheets\02231\CS\0111.dgn
 8/1/2008