

SEEDING LEGEND :

SEED MIX 'A'

IDOT 2A		
Salt Tolerant Roadside Mixture		
30%	Inferno Tall Fescue or Tarheel II Tall Fescue	60#
30%	Fults Puccinellia Distans	60#
15%	Audubon Red Fescue	30#
15%	Rescue 911 Hard Fescue	30#
10%	Perennial Ryegrass	20#
		TOTAL 200# / A

SEED MIX 'B'

IDOT CLASS 4		
Native Grass Mixture		
30%	Annual Rye	25#
30%	Spring Oats	25#
18%	Perennial Ryegrass	15#
6%	Little Blue Stem	5#
6%	Side Oats Gamma	5#
5%	Big Blue Stem	4#
3%	Indian Grass	2#
1%	Prairie Switchgrass	1#
1%	Wild Rye	1#
		TOTAL 83# / A

SEED MIX 'C'

MODIFIED IDOT BLEND (Mesic to Wet Native Grasses)		
IDOT Class 4 - "Native Grass Mixture"		
30%	Annual Rye	25#
30%	Spring Oats	25#
18%	Perennial Ryegrass	15#
6%	Little Blue Stem	5#
6%	Side Oats Gamma	5#
5%	Big Blue Stem	4#
3%	Indian Grass	2#
1%	Prairie Switchgrass	1#
1%	Wild Rye	1#
		83# / A

IDOT Class 4B - (Wetland Grass & Sedges Only)		
10.72% Wetland Grasses (below)		
		6#
		6# / A

Species		
Blue Joint Grass	12%	
Sedge	6%	
Awl-Fruited Sedge	6%	
Sedge	6%	
Sedge	6%	
Needle Spike Rush	3%	
Blunt Spike Rush	3%	
Manna Grass	14%	
Common Rush	6%	
Slender Rush	6%	
Rush	6%	
Rice Cut Grass	10%	
Hard-Stemmed Bulrush	3%	
Dark Green Rush	3%	
River Bulrush	3%	
Softstem Bulrush	3%	
Grass	4%	

TOTAL 89# / A

For Seeding Times - See Sheet 116;
Erosion Control General Notes & Details

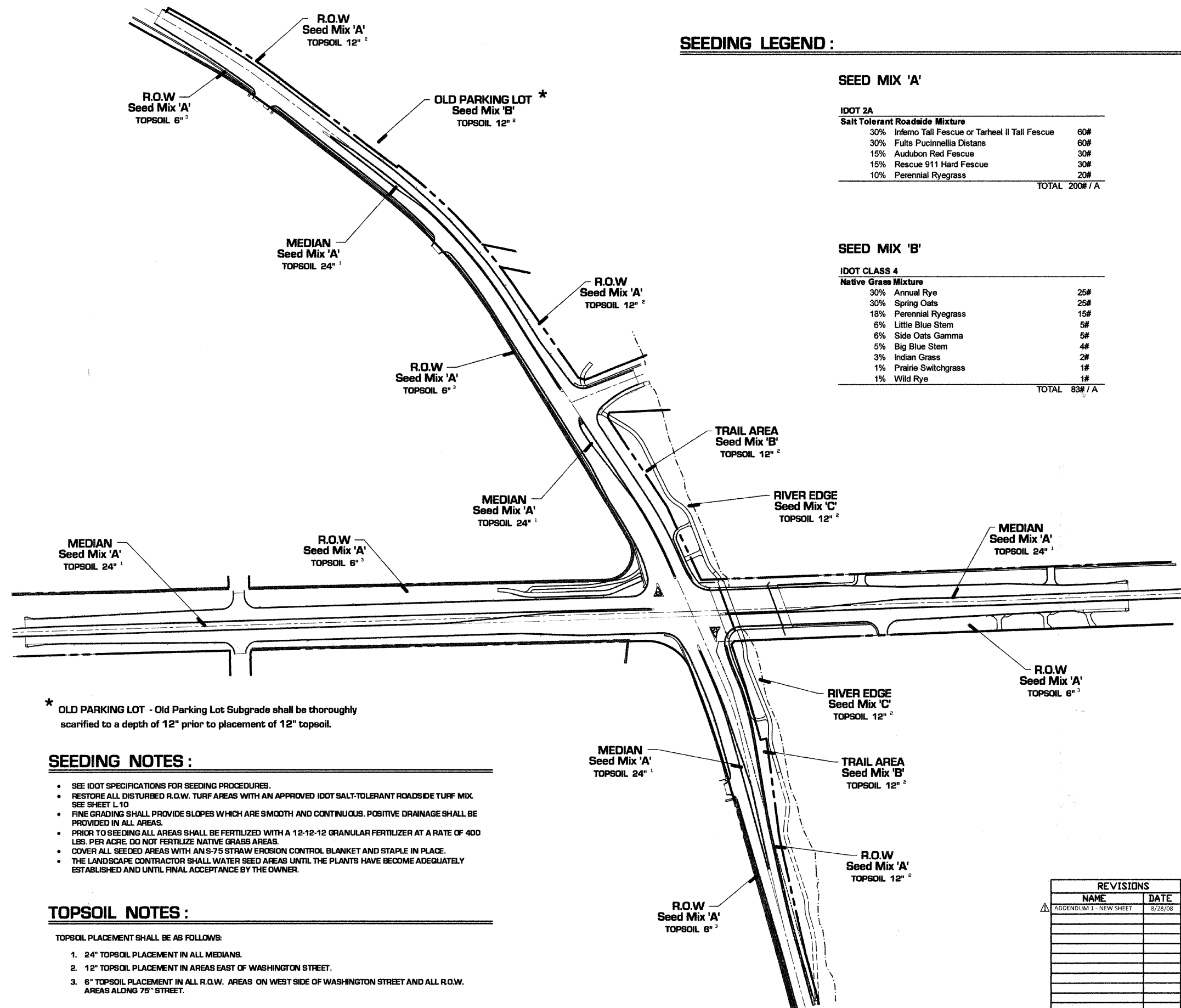
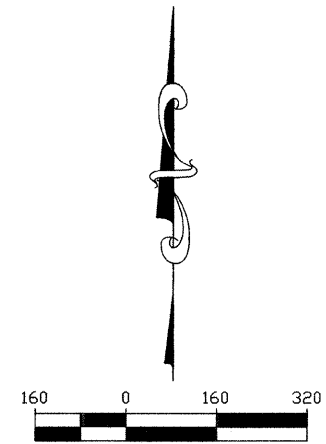

* OLD PARKING LOT - Old Parking Lot Subgrade shall be thoroughly scarified to a depth of 12" prior to placement of 12" topsoil.

SEEDING NOTES :

- SEE IDOT SPECIFICATIONS FOR SEEDING PROCEDURES.
- RESTORE ALL DISTURBED R.O.W. TURF AREAS WITH AN APPROVED IDOT SALT-TOLERANT ROADSIDE TURF MIX SEE SHEET L 10
- FINE GRADING SHALL PROVIDE SLOPES WHICH ARE SMOOTH AND CONTINUOUS. POSITIVE DRAINAGE SHALL BE PROVIDED IN ALL AREAS.
- PRIOR TO SEEDING ALL AREAS SHALL BE FERTILIZED WITH A 12-12-12 GRANULAR FERTILIZER AT A RATE OF 400 LBS. PER ACRE. DO NOT FERTILIZE NATIVE GRASS AREAS.
- COVER ALL SEEDED AREAS WITH AN S-75 STRAW EROSION CONTROL BLANKET AND STAPLE IN PLACE.
- THE LANDSCAPE CONTRACTOR SHALL WATER SEED AREAS UNTIL THE PLANTS HAVE BECOME ADEQUATELY ESTABLISHED AND UNTIL FINAL ACCEPTANCE BY THE OWNER.

TOPSOIL NOTES :

- TOPSOIL PLACEMENT SHALL BE AS FOLLOWS:
1. 24" TOPSOIL PLACEMENT IN ALL MEDIANS.
 2. 12" TOPSOIL PLACEMENT IN AREAS EAST OF WASHINGTON STREET.
 3. 6" TOPSOIL PLACEMENT IN ALL R.O.W. AREAS ON WEST SIDE OF WASHINGTON STREET AND ALL R.O.W. AREAS ALONG 75TH STREET.

REVISIONS	
NAME	DATE
ADDENDUM 1 - NEW SHEET	8/28/08

INTERSECTION IMPROVEMENT
WASHINGTON STREET - 75th STREET

**SEEDING & TOPSOIL
EXHIBIT**

CONSULTANT

**SIGNATURE
DESIGN GROUP**

City of **Naperville**

DRAWN: _____ SHEET NO. **L.10**

CHECKED: _____

APPROVED: _____

DATE: APRIL 11, 2008

SCALE: 1" = 160' - 0"

JOB NO.: P-91-494-00 PROJECT NO.: CMM-7003 (983)