

F.A.U. RTE.	SECTION	COUNTY	TOTAL SHEETS	SHEET NO.
2552	00-00114-00-PV	DuPAGE	563	230
STA.		TO STA.		
FED. ROAD DIST. NO.		ILLINOIS	FED. AID PROJECT	

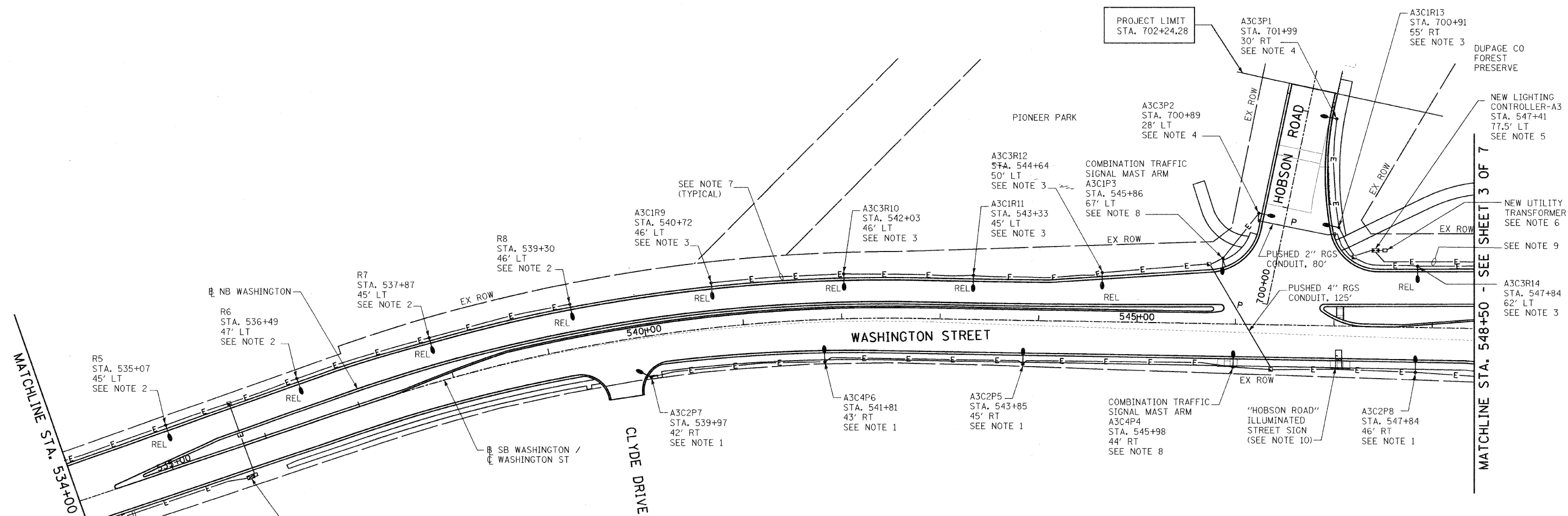
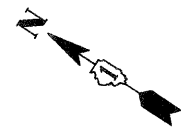

NOTES:

1. PROVIDE NEW LIGHT POLE AND ASSOCIATED LUMINAIRE PER NEW WORK REQUIREMENT. REFER TO GENERAL NOTES AND SYMBOLS SHEET FOR POLE AND LUMINAIRE INFORMATIONS.
2. EXISTING RELOCATED LIGHT POLES (R1 THROUGH R8) SHALL BE CONNECT TO EXISTING CIRCUIT FED FROM EXISTING CONTROLLER (EXISTING LIGHTING CONTROLLER IS LOCATED AT STA 535+74, 32' RT)
3. EXISTING RELOCATED LIGHT POLES (R9 THROUGH R14) SHALL BE CONNECTED TO NEW LIGHTING CONTROLLER "A3" AS INDICATED ON PLAN.
4. PROVIDE NEW LIGHTING POLE AND LUMINAIRE PER NEW WORK REQUIREMENT. PROVIDE NEW WIRES AND CONNECT TO NEW LIGHTING CONTROLLER "A3", AS INDICATED ON PLAN.
5. PROVIDE NEW LIGHTING CONTROLLER "A3", AS INDICATED ON PLAN. COORDINATE EXACT REQUIREMENTS WITH CITY OF NAPERVILLE.
6. PROVIDE NEW SERVICE FOR NEW CONTROLLER.
7. PROVIDE NEW CIRCUIT WIRES (3-1/C NO. 6 AWG, 1/C NO.6 AWG GROUND) WITHIN 2" DIAMETER UNIT DUCT.
8. PROVIDE NEW COMBINATION POLE WITH TRAFFIC SIGNAL MAST ARM AND LUMINAIRE. COORDINATE EXACT REQUIREMENTS WITH CITY OF NAPERVILLE.
9. PROVIDE 3/4" RGS CONDUIT WITH 2-1/C NO. 10 AWG, 1-1/C NO. 10 AWG GROUND FOR PEDESTRIAN WALKWAY BRIDGE LIGHTING CIRCUIT. CONDUIT ROUTE ALONG WITH STREET LIGHTING CIRCUIT.
10. PROVIDE 2-1/C NO. 10 AWG, 1-1/C NO. 10 AWG GROUND CIRCUIT WIRES IN 3/4" RGS CONDUIT AND CONNECT TO CLOSEST LIGHT POLE CIRCUIT. ILLUMINATED STREET SIGN AND ASSOCIATED POLE, FOUNDATION, BRACKETS ETC. SHALL BE PROVIDED BY OTHERS.

MATCHLINE STA. 534+00 - SEE SHEET 1 OF 7

MATCHLINE STA. 548+50 - SEE SHEET 3 OF 7



REVISIONS	
NAME	DATE
ADDENDUM 1- NEW SHEET	8/28/08

**INTERSECTION IMPROVEMENT
WASHINGTON STREET - 75th STREET
PROPOSED ELECTRICAL PLAN
WASHINGTON STREET
SHEET 2 OF 7
STA. 534+00 TO STA. 548+50**

CONSULTANT
TYLIN INTERNATIONAL

City of **Naperville**

DRAWN: JRH	SHEET NO.
CHECKED: FO	
APPROVED: DEM	
DATE: 04/11/08	
SCALE: 1"=50'-0"	
JOB NO.: P-91-494-00	PROJECT NO.: CMM-7003 (983)