

A-A
PRE STAGE A: W. 75TH STREET; STA. 130+50 TO STA. 139+50

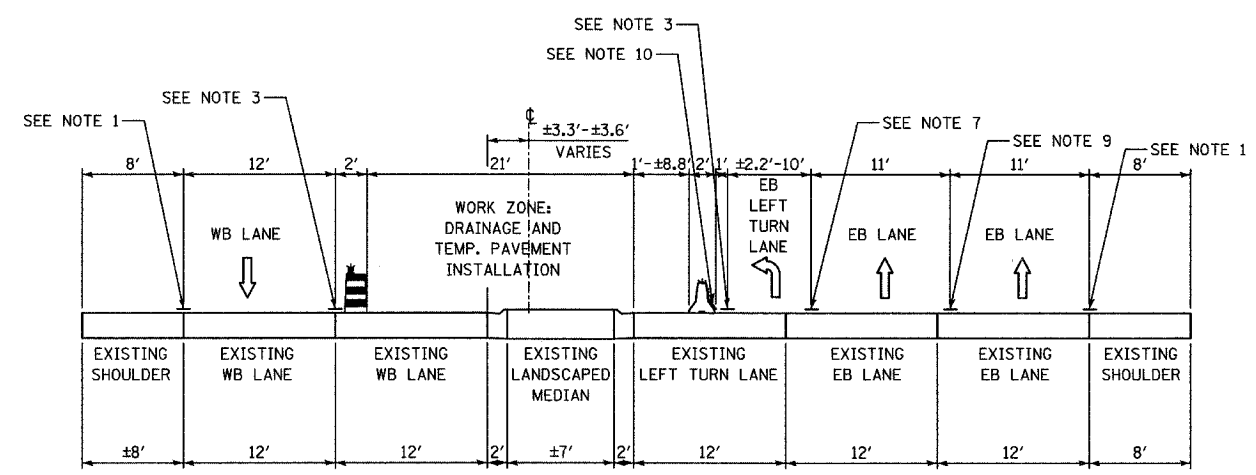

B-B
PRE STAGE A: W. 75TH STREET; STA. 146+10 TO STA. 147+50

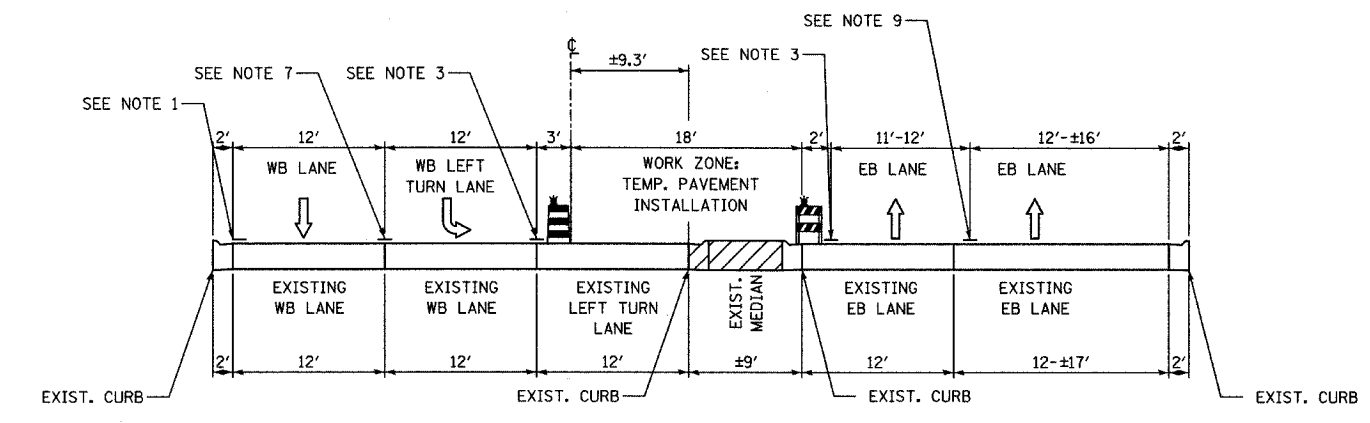

C-C
PRE STAGE A: E. 75TH STREET; STA. 150+00 TO STA. 150+87

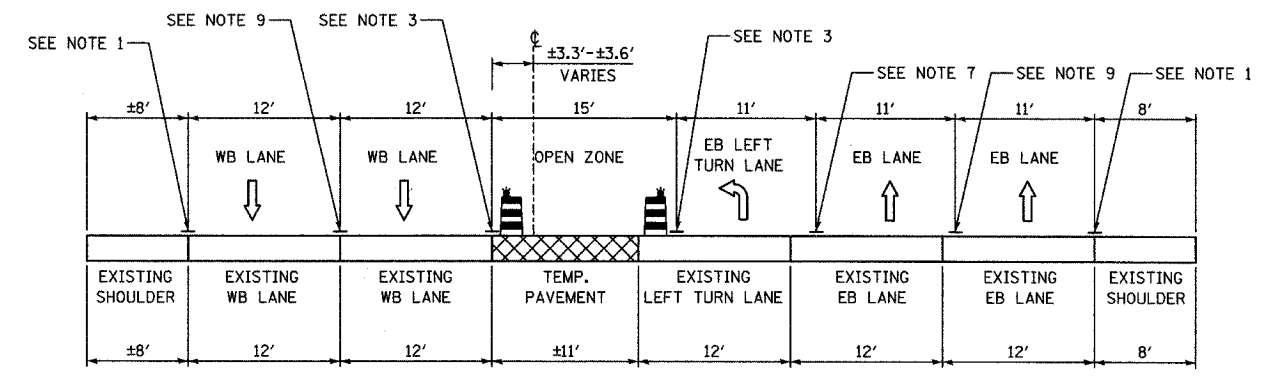

D-D
PRE STAGE B: W. 75TH STREET; STA. 146+10 TO STA. 147+50

- NOTE 1** - EXISTING PAVEMENT MARKING
- NOTE 2** - TEMPORARY PAVEMENT MARKING- LINE 4" (WHITE)
- NOTE 3** - TEMPORARY PAVEMENT MARKING- LINE 4" (YELLOW)
- NOTE 4** - TEMPORARY PAVEMENT MARKING- DOUBLE 4" (YELLOW), 11" CENTER TO CENTER
- NOTE 5** - TEMPORARY PAVEMENT MARKING- SKIP-DASH 4" (WHITE), 2' LINE WITH 6' SPACE
- NOTE 6** - TEMPORARY PAVEMENT MARKING- LINE 8" (WHITE)
- NOTE 7** - TEMPORARY PAVEMENT MARKING- LINE 6" (WHITE)
- NOTE 8** - TEMPORARY PAVEMENT MARKING- ON BARRIER WALL- LINE 6" (WHITE)
- NOTE 9** - TEMPORARY PAVEMENT MARKING- SKIP-DASH 4" (WHITE) 10' LINE WITH 30' SPACE
- NOTE 10** - TEMPORARY PAVEMENT MARKING- ON BARRIER WALL- LINE 6" (YELLOW)
- LEGEND:**
- TEMPORARY CONCRETE BARRIER (WITH REFLECTORS ON TOP AND SIDE FACING TRAFFIC)
 - TRAFFIC MOVEMENT
 - DRUM WITH MONO-DIRECTIONAL STEADY BURNING LIGHT
 - TYPE II BARRICADE WITH MONO-DIRECTIONAL STEADY BURNING LIGHT
 - WORK ZONE AREA
 - TEMPORARY PAVEMENT
- ALL MOT TYPICAL SECTIONS ARE DRAWN GOING UP-STATION
- DOUBLE YELLOW ONLY APPLIED ADJACENT TO MEDIAN - SEE PLANS FOR ADDITIONAL DETAIL

| REVISIONS | | INTERSECTION IMPROVEMENT WASHINGTON STREET - 75th STREET MAINTENANCE OF TRAFFIC TYPICAL SECTIONS SHEET 1 OF 13 | City of | |
|-----------|------|--|------------------------------|-----------|
| NAME | DATE | | | |
| | | CONSULTANT TYLIN INTERNATIONAL | DRAWN: | SHEET NO. |
| | | | CHECKED: | |
| | | | APPROVED: | |
| | | | DATE: APRIL 11, 2008 | |
| | | | SCALE: | |
| | | JOB NO. P-91-494-00 | PROJECT NO. M-CMM-7003 (985) | |