

THE PANEL ABOVE IS PROVIDED TO SHOW THE EXTENT OF THE STAGE 2 WORK ZONE. TRAFFIC IS IN THE SAME CONFIGURATION AS STAGE 1B.

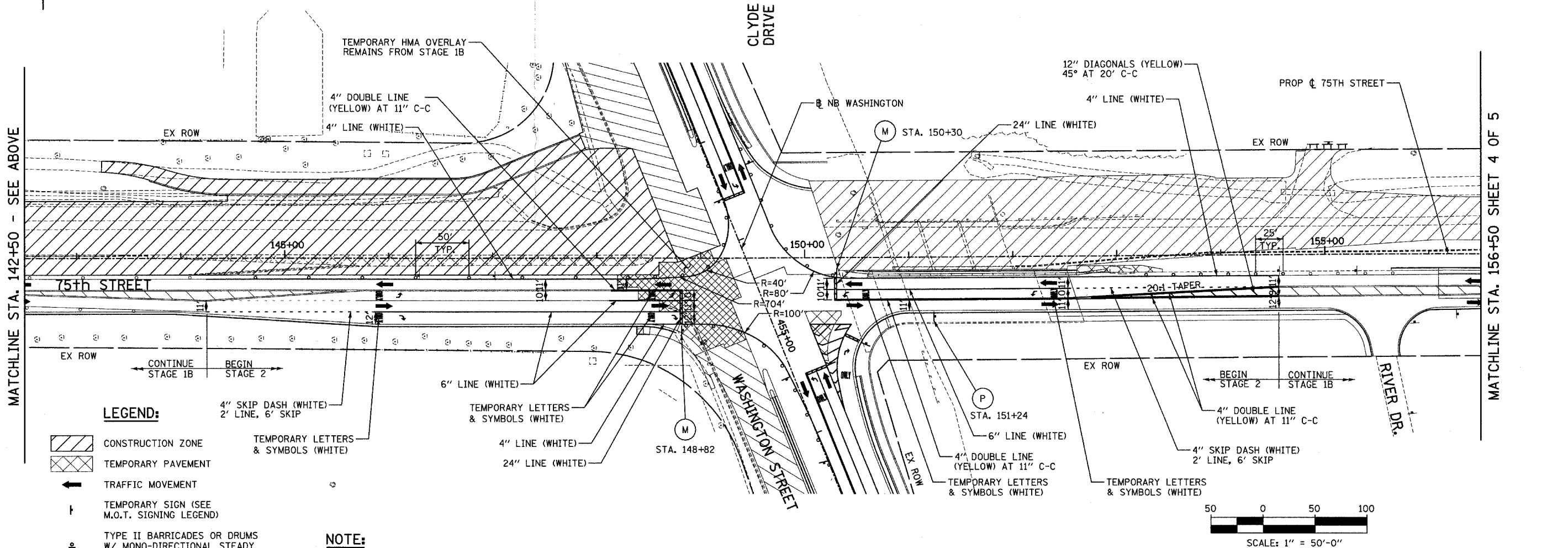

**LEGEND:**

- CONSTRUCTION ZONE
- TEMPORARY PAVEMENT
- TRAFFIC MOVEMENT
- TEMPORARY SIGN (SEE M.O.T. SIGNING LEGEND)
- TYPE II BARRICADES OR DRUMS W/ MONO-DIRECTIONAL STEADY BURNING LIGHT
- TYPE III BARRICADE W/2 FLASHING BIDIRECTIONAL LIGHTS
- TEMPORARY CONCRETE BARRIER
- ARROW BOARD
- M.O.T. APPURTENANCES REMAINING FROM PREVIOUS STAGES

**NOTE:**

SOME TEMPORARY M.O.T. SIGNING REMAINS FROM PREVIOUS STAGES - SEE PREVIOUS STAGE OR STAGES FOR SIGN TYPE AND LOCATION.

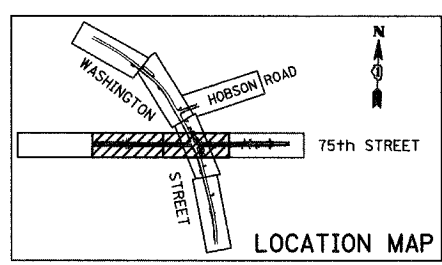
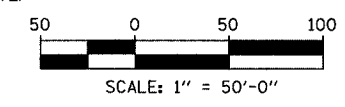

REVISIONS	
NAME	DATE

INTERSECTION IMPROVEMENT  
 WASHINGTON STREET - 75th STREET  
 MOT PLAN - STAGE 2  
 75th STREET  
 SHEET 3 OF 5  
 STA. 128+00 TO STA. 156+50  
 CONSULTANT  
**TYLIN** INTERNATIONAL

City of **Naperville**

DRAWN	SHEET NO.
CHECKED	
APPROVED	
DATE: APRIL 11, 2008	
SCALE	
JOB NO. P-91-494-00	PROJECT NO. M-CMM-7003 (985)

4/11/2008 2:27:34 PM P:\602417\Road\5\mst\204.dgn