

|                     |                |                  |              |           |
|---------------------|----------------|------------------|--------------|-----------|
| F.A.I. RT.:         | SECTION        | COUNTY           | TOTAL SHEETS | SHEET NO. |
| 2552                | 00-00114-00-PV | DuPAGE           | 563          | 176       |
| STA.                |                | TO STA.          |              |           |
| FED. ROAD DIST. NO. | ILLINOIS       | FED. AID PROJECT |              |           |

**TURF LEGEND :**

**SEED MIX 'A'**

**IDOT 2A**  
Salt Tolerant Roadside Mixture

|     |                                               |                |
|-----|-----------------------------------------------|----------------|
| 30% | Inferno Tall Fescue or Tarheel II Tall Fescue | 60#            |
| 30% | Fults Puccinellia Distans                     | 60#            |
| 15% | Audubon Red Fescue                            | 30#            |
| 15% | Rescue 911 Hard Fescue                        | 30#            |
| 10% | Perennial Ryegrass                            | 20#            |
|     |                                               | TOTAL 200# / A |

**SEED MIX 'B'**

**IDOT CLASS 4**  
Native Grass Mixture

|     |                     |               |
|-----|---------------------|---------------|
| 30% | Annual Rye          | 25#           |
| 30% | Spring Oats         | 25#           |
| 18% | Perennial Ryegrass  | 15#           |
| 6%  | Little Blue Stem    | 5#            |
| 6%  | Side Oats Gamma     | 5#            |
| 5%  | Big Blue Stem       | 4#            |
| 3%  | Indian Grass        | 2#            |
| 1%  | Prairie Switchgrass | 1#            |
| 1%  | Wild Rye            | 1#            |
|     |                     | TOTAL 83# / A |

**SEED MIX 'C'**

**MODIFIED IDOT BLEND (Mesic to Wet Native Grasses)**  
IDOT Class 4 - "Native Grass Mixture"

|     |                     |         |
|-----|---------------------|---------|
| 30% | Annual Rye          | 25#     |
| 30% | Spring Oats         | 25#     |
| 18% | Perennial Ryegrass  | 15#     |
| 6%  | Little Blue Stem    | 5#      |
| 6%  | Side Oats Gamma     | 5#      |
| 5%  | Big Blue Stem       | 4#      |
| 3%  | Indian Grass        | 2#      |
| 1%  | Prairie Switchgrass | 1#      |
| 1%  | Wild Rye            | 1#      |
|     |                     | 83# / A |

**IDOT Class 4B - (Wetland Grass & Sedges Only)**  
10.72% Wetland Grasses (below)

|  |  |        |
|--|--|--------|
|  |  | 6#     |
|  |  | 6# / A |

**Species**

|                      |     |               |
|----------------------|-----|---------------|
| Blue Joint Grass     | 12% |               |
| Sedge                | 6%  |               |
| Awl-Fruited Sedge    | 6%  |               |
| Sedge                | 6%  |               |
| Sedge                | 6%  |               |
| Needle Spike Rush    | 3%  |               |
| Blunt Spike Rush     | 3%  |               |
| Manna Grass          | 14% |               |
| Common Rush          | 6%  |               |
| Slender Rush         | 6%  |               |
| Rush                 | 6%  |               |
| Rice Cut Grass       | 10% |               |
| Hard-Stemmed Bulrush | 3%  |               |
| Dark Green Rush      | 3%  |               |
| River Bulrush        | 3%  |               |
| Softstem Bulrush     | 3%  |               |
| Grass                | 4%  |               |
|                      |     | TOTAL 89# / A |

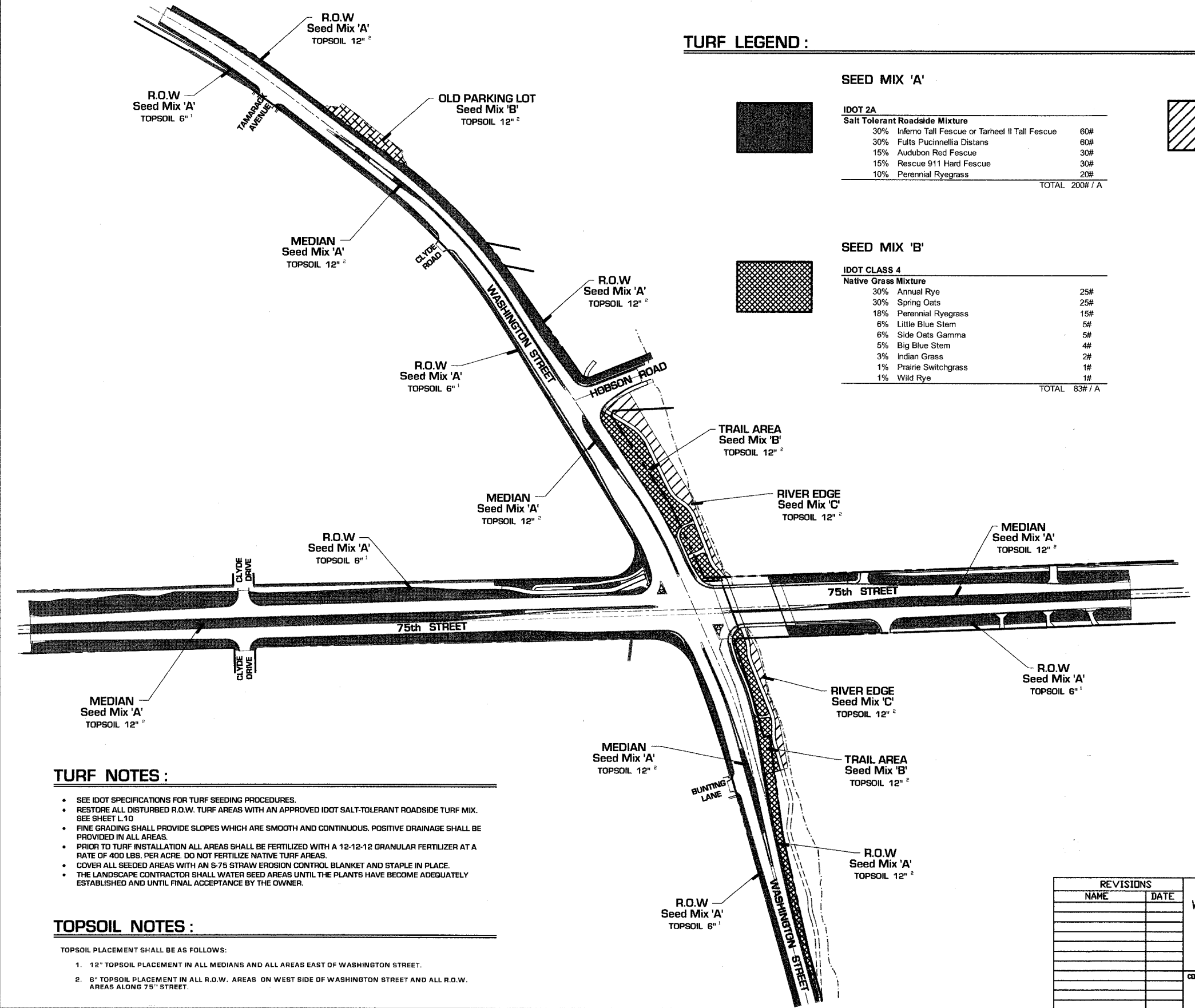

**TURF NOTES :**

- SEE IDOT SPECIFICATIONS FOR TURF SEEDING PROCEDURES.
- RESTORE ALL DISTURBED R.O.W. TURF AREAS WITH AN APPROVED IDOT SALT-TOLERANT ROADSIDE TURF MIX. SEE SHEET L-10
- FINE GRADING SHALL PROVIDE SLOPES WHICH ARE SMOOTH AND CONTINUOUS. POSITIVE DRAINAGE SHALL BE PROVIDED IN ALL AREAS.
- PRIOR TO TURF INSTALLATION ALL AREAS SHALL BE FERTILIZED WITH A 12-12-12 GRANULAR FERTILIZER AT A RATE OF 400 LBS. PER ACRE. DO NOT FERTILIZE NATIVE TURF AREAS.
- COVER ALL SEEDED AREAS WITH AN S-75 STRAW EROSION CONTROL BLANKET AND STAPLE IN PLACE.
- THE LANDSCAPE CONTRACTOR SHALL WATER SEED AREAS UNTIL THE PLANTS HAVE BECOME ADEQUATELY ESTABLISHED AND UNTIL FINAL ACCEPTANCE BY THE OWNER.

**TOPSOIL NOTES :**

- TOPSOIL PLACEMENT SHALL BE AS FOLLOWS:
1. 12" TOPSOIL PLACEMENT IN ALL MEDIANS AND ALL AREAS EAST OF WASHINGTON STREET.
  2. 6" TOPSOIL PLACEMENT IN ALL R.O.W. AREAS ON WEST SIDE OF WASHINGTON STREET AND ALL R.O.W. AREAS ALONG 75th STREET.

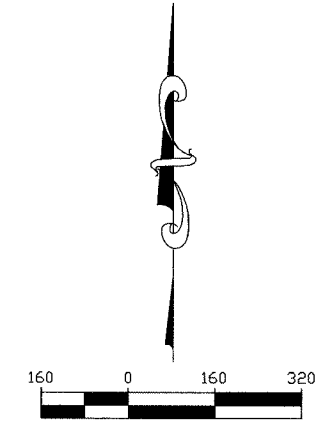

| REVISIONS |      |
|-----------|------|
| NAME      | DATE |
|           |      |
|           |      |
|           |      |
|           |      |
|           |      |
|           |      |
|           |      |
|           |      |
|           |      |

INTERSECTION IMPROVEMENT  
WASHINGTON STREET - 75th STREET

**TURF & TOPSOIL EXHIBIT**

CONSULTANT

**SIGNATURE DESIGN GROUP**

City of **Naperville**

DRAWN \_\_\_\_\_ SHEET NO. **L.10**

CHECKED \_\_\_\_\_

APPROVED \_\_\_\_\_

DATE: APRIL 11, 2008

SCALE: 1"=160'-0"

JOB NO.: P-91-494-00 PROJECT NO.: CMM-7003 (983)