

F.A.I. RTE.	SECTION	COUNTY	TOTAL SHEETS	SHEET NO.
2552	00-00114-00-PV	DuPAGE	563	219
STA.	TO STA.			
FED. ROAD DIST. NO.	ILLINOIS	FED. AID PROJECT		

CONTRACT NO. 63024



MATCHLINE STA. 142+50 - SEE BELOW

MATCHLINE STA. 156+50 - SEE SHEET 3 OF 3

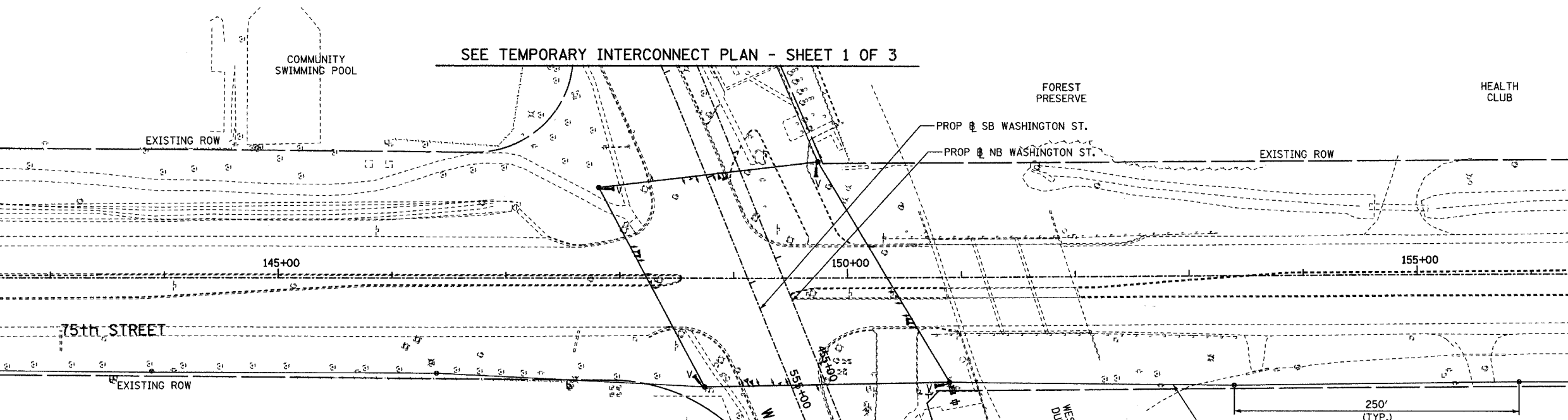
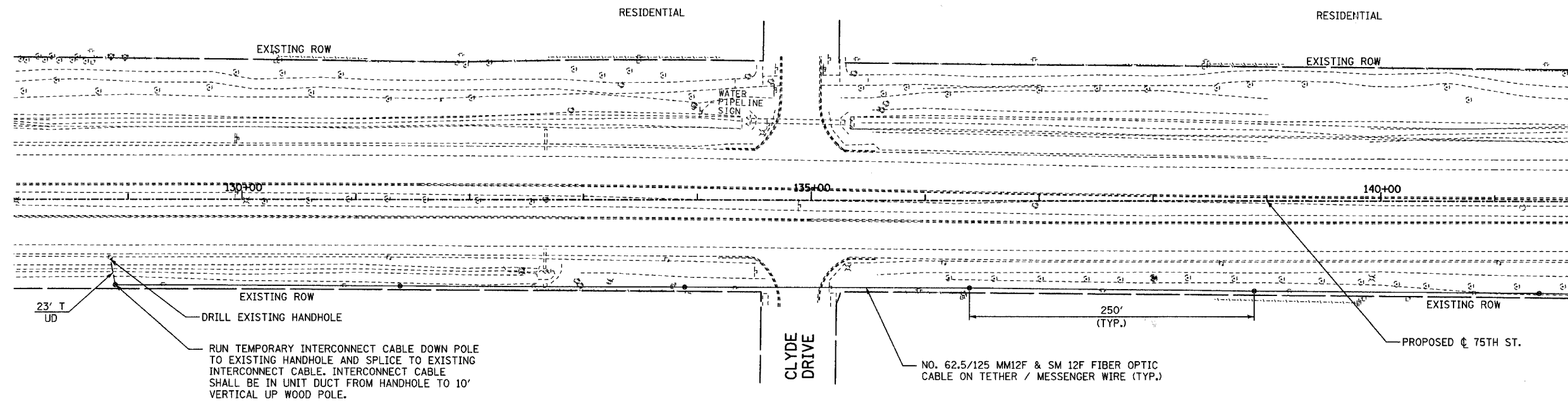

SEE TEMPORARY INTERCONNECT PLAN - SHEET 1 OF 3

**INTERCONNECT PLAN LEGEND**

- | PROPOSED | EXISTING |  |
|----------|----------|--|
|          |          | CONTROLLER                             |
|          |          | HANDHOLE                               |
|          |          | DOUBLE HANDHOLE                        |
|          |          | HEAVY DUTY HANDHOLE                    |
|          |          | G.S. CONDUIT IN TRENCH (OR PUSHED (P)) |
|          |          | DETECTOR LOOP                          |
|          |          | UNIT DUCT                              |
|          |          | SYSTEM                                 |
|          |          | INTERSECTION                           |

**TEMPORARY TRAFFIC SIGNAL LEGEND**

- |  |  |  |                                  |
|--|--|--|----------------------------------|
|  | TEMPORARY TRAFFIC SIGNAL HEAD SPAN WIRE MOUNTED ORIGINAL LOCATION  |  | VIDEO DETECTION                  |
|  | TEMPORARY TRAFFIC SIGNAL HEAD SPAN WIRE MOUNTED SECONDARY LOCATION |  | PEDESTRIAN PUSHBUTTON DETECTOR   |
|  | TEMPORARY WOOD POLE (CLASS 5 OR BETTER) 45 FOOT (13.7m) MINIMUM    |  | EMERGENCY VEHICLE LIGHT DETECTOR |
|  | TEMPORARY CONTROLLER CABINET                                       |  | CONFIRMATION BEACON              |
|  | TEMPORARY SPAN WIRE, TETHER WIRE, AND CABLE                        |  | VEHICLE DETECTOR, INDUCTION LOOP |
|  | TEMPORARY SERVICE INSTALLATION                                     |  | COMMON TRENCH                    |
|  | TEMPORARY PEDESTRIAN SIGNAL HEAD, BRACKET MOUNTED                  |  | UNIT DUCT                        |
|  | EXISTING TEMPORARY TRAFFIC SIGNAL HEAD SPAN WIRE MOUNTED           |  | G.S. CONDUIT IN TRENCH OR PUSHED |
|  |  |  | HANDHOLE                         |
|  |  |  | HEAVY DUTY HANDHOLE              |
|  |  |  | VIDEO DETECTION ZONES            |

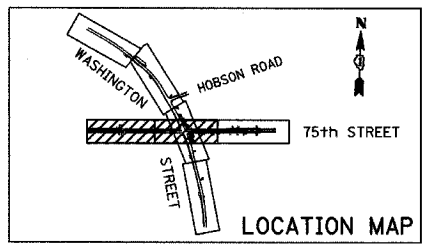
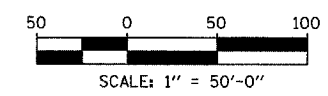

REVISIONS	
NAME	DATE

INTERSECTION IMPROVEMENT  
 WASHINGTON STREET - 75th STREET  
 TEMPORARY TRAFFIC SIGNAL  
 INTERCONNECT PLAN 75th STREET  
 SHEET 2 OF 3  
 STA. 128+00 TO STA. 156+50  
 CONSULTANT  
**TYLIN INTERNATIONAL**

City of **Naperville**

DRAWN: CBS	SHEET NO.
CHECKED: DAJ	
APPROVED:	
DATE: APRIL 11, 2008	
SCALE:	
JOB NO.: P-91-494-00	PROJECT NO.: M-CMM-7003 (985)