

F.A. RTE. 2552	SECTION	COUNTY	TOTAL SHEETS	SHEET NO.
	00-0014-00-PV	DUPAGE	563	246
STA.		TO STA.		
FED. ROAD DIST. NO.		ILLINOIS	FED. AID PROJECT	
CONTRACT 63024				

**LEGEND**

EXISTING		PROPOSED	
	E-WOOD POLE		PROPOSED CURB AND CONSTRUCTION
	E-SWITCH GEAR AND VAULT		PROPOSED-TYPE "A" MANHOLE
	E-DPU-ELECTRIC FACILITIES		PROPOSED-PVC DUCT BANK
	E-CURB		

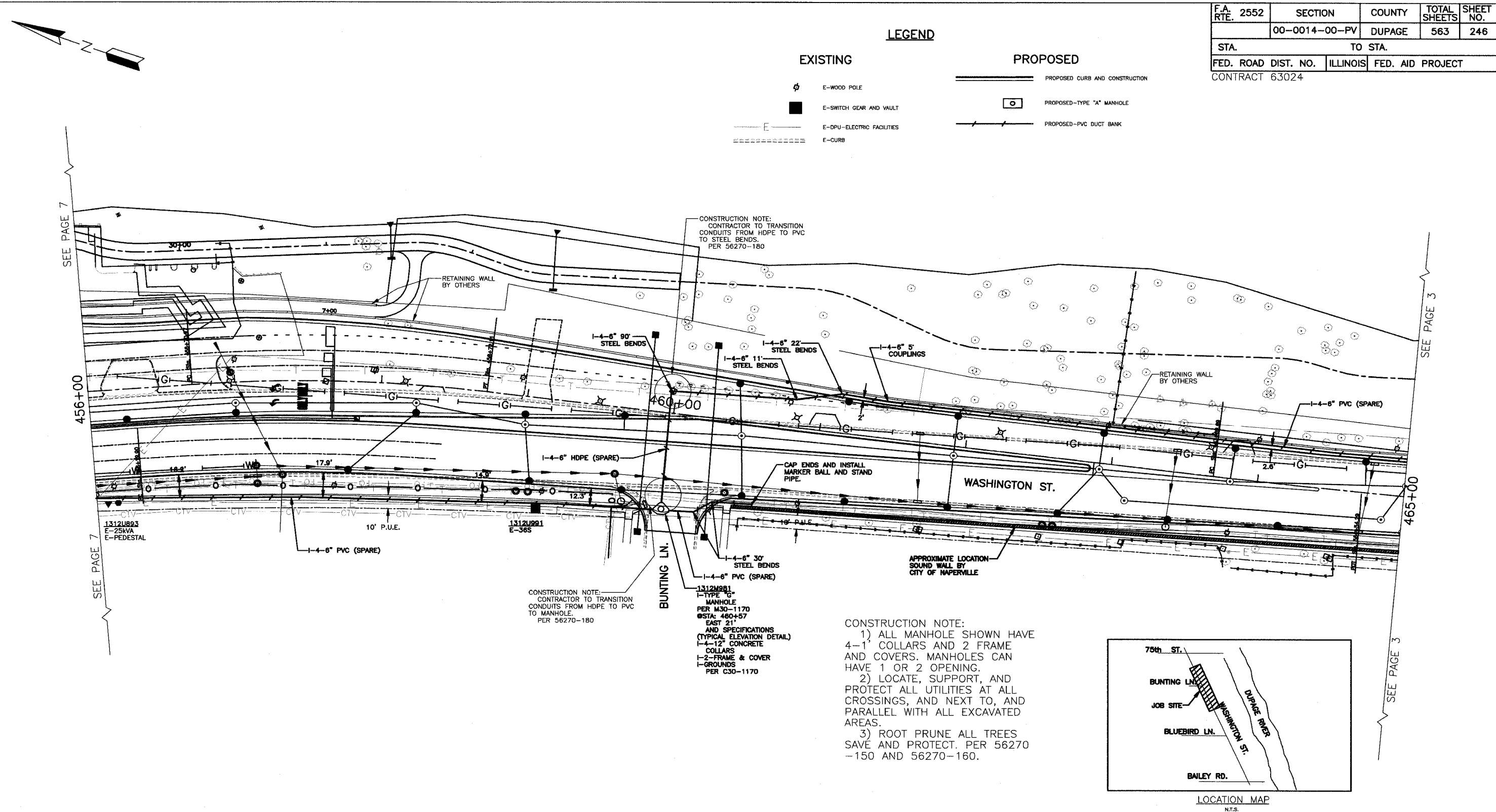

CONSTRUCTION NOTE:  
CONTRACTOR TO TRANSITION  
CONDUITS FROM HDPE TO PVC  
TO STEEL BENDS.  
PER 56270-180

CONSTRUCTION NOTE:  
CONTRACTOR TO TRANSITION  
CONDUITS FROM HDPE TO PVC  
TO MANHOLE.  
PER 56270-180

1312M981  
1-TYPE "A"  
MANHOLE  
PER M30-1170  
@STA: 460+57  
EAST 21'  
AND SPECIFICATIONS  
(TYPICAL ELEVATION DETAIL)  
1-4-12" CONCRETE  
COLLARS  
1-2-FRAME & COVER  
1-GROUNDS  
PER C30-1170

CONSTRUCTION NOTE:  
1) ALL MANHOLE SHOWN HAVE  
4-1" COLLARS AND 2 FRAME  
AND COVERS. MANHOLES CAN  
HAVE 1 OR 2 OPENING.  
2) LOCATE, SUPPORT, AND  
PROTECT ALL UTILITIES AT ALL  
CROSSINGS, AND NEXT TO, AND  
PARALLEL WITH ALL EXCAVATED  
AREAS.  
3) ROOT PRUNE ALL TREES  
SAVE AND PROTECT. PER 56270  
-150 AND 56270-160.

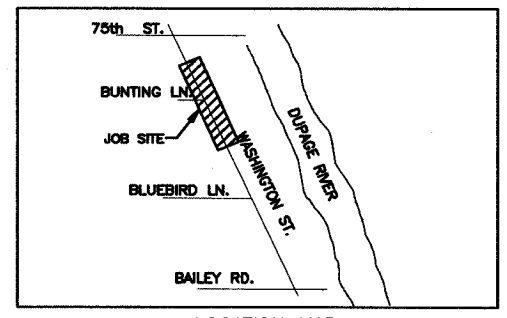

LOCATION MAP  
N.T.S.

WF# INFORMATION		CITY OF NAPERVILLE/DEPARTMENT OF PUBLIC UTILITIES - ELECTRIC			
CALL J.U.L.I.E. 18 HRS. PRIOR TO CONSTRUCTION					
WF# 58481 WASHINGTON ST. 75TH TO TAMARACK LN.	JOB 1 EU-73	PROJECT TITLE <b>75TH ST. AND WASHINGTON ST. ROAD IMPROVEMENTS</b>	MAP NO.: 1312	CAD FILE: 005627001C5.DWG	PROJECT NO.: EU12-06-03
WF# 58482 75TH ST. WASHINGTON ST. TO OLYMPUS DR. NORTH SIDE	JOB 2 EU-73	PROJECT DESCRIPTION CONDUIT LAYOUT, WITHOUT SECT-ONS	DRAWN BY: PM	COMPLETED BY:	
WF# 58484 75TH ST. WASHINGTON ST. TO CLYDE DR. SOUTH SIDE	JOB 3 EU-73	DATE 4-01-08	WORK REQUEST NO. 56270	AT&T:	
WF# 58485 WASHINGTON ST. 75TH TO BAILEY RD.	JOB 4 EU-73	ISSUED ENGINEER RPS	APPR:	SCALE: 1"=30'	SHEET 5 OF 73