

FIELD ENGINEER: MARLIN SOLOMON 847-705-4407

# BURLING

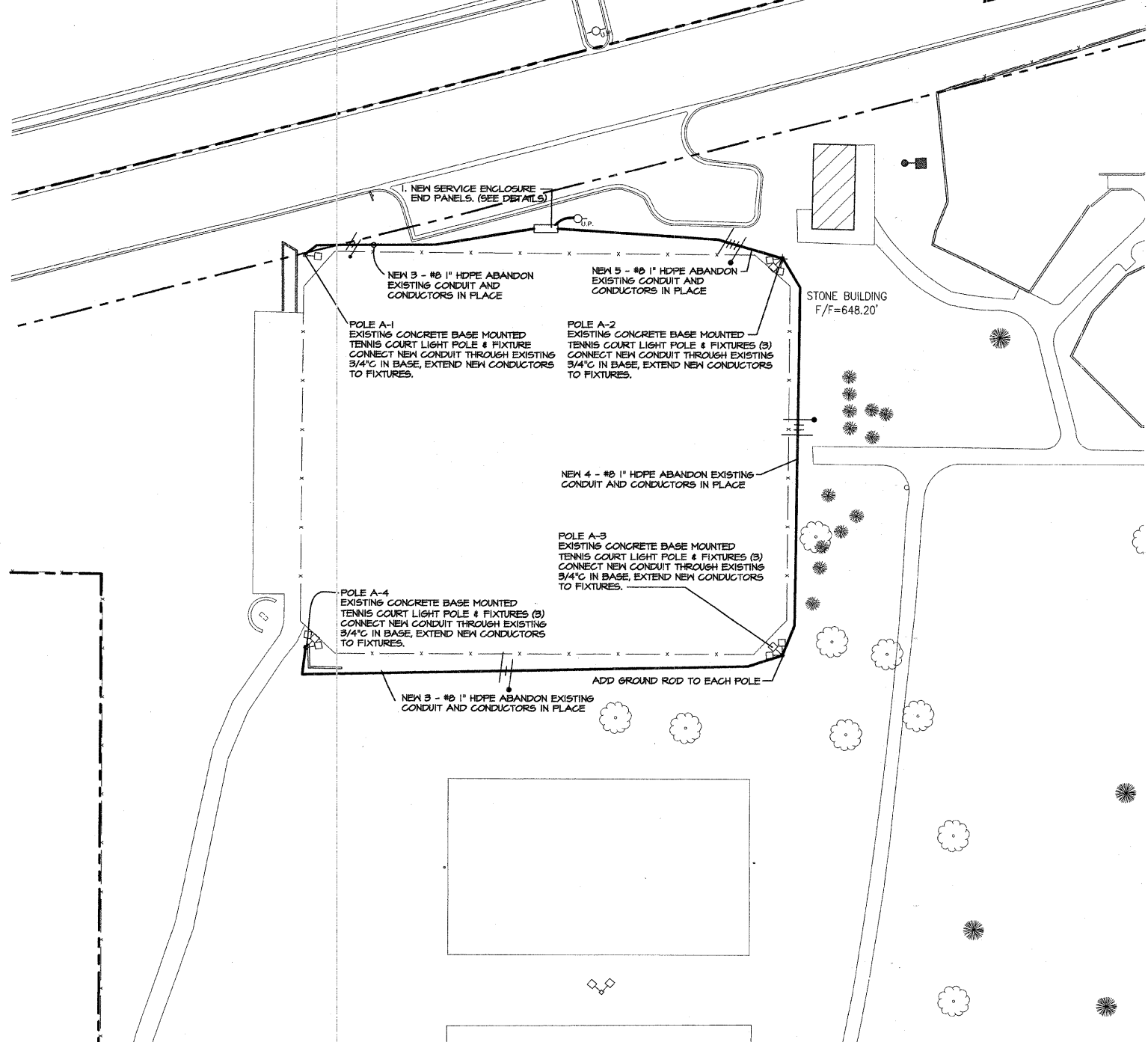
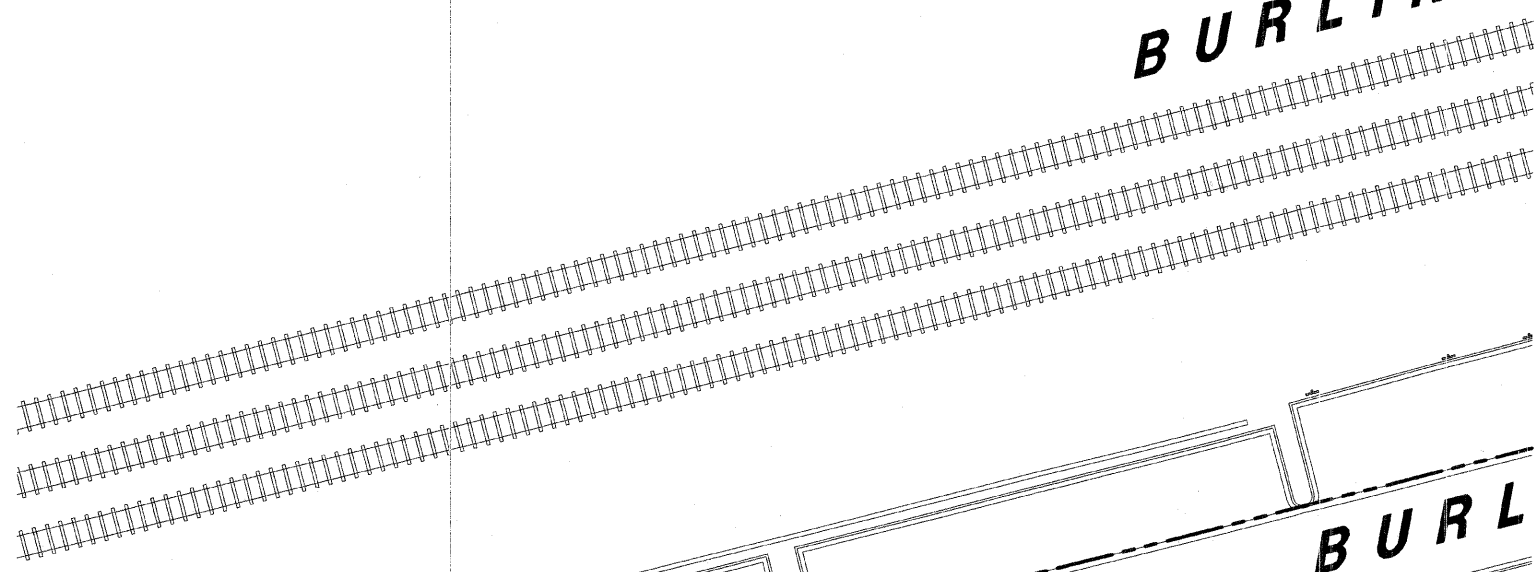

1. NEW SERVICE ENCLOSURE  
END PANELS. (SEE DETAILS)

NEW 3 - #8 1" HDPE ABANDON  
EXISTING CONDUIT AND  
CONDUCTORS IN PLACE

NEW 5 - #8 1" HDPE ABANDON  
EXISTING CONDUIT AND  
CONDUCTORS IN PLACE

POLE A-1  
EXISTING CONCRETE BASE MOUNTED  
TENNIS COURT LIGHT POLE & FIXTURE  
CONNECT NEW CONDUIT THROUGH EXISTING  
3/4" IN BASE, EXTEND NEW CONDUCTORS  
TO FIXTURES.

POLE A-2  
EXISTING CONCRETE BASE MOUNTED  
TENNIS COURT LIGHT POLE & FIXTURES (3)  
CONNECT NEW CONDUIT THROUGH EXISTING  
3/4" IN BASE, EXTEND NEW CONDUCTORS  
TO FIXTURES.

STONE BUILDING  
F/F=648.20'

NEW 4 - #8 1" HDPE ABANDON EXISTING  
CONDUIT AND CONDUCTORS IN PLACE

POLE A-3  
EXISTING CONCRETE BASE MOUNTED  
TENNIS COURT LIGHT POLE & FIXTURES (3)  
CONNECT NEW CONDUIT THROUGH EXISTING  
3/4" IN BASE, EXTEND NEW CONDUCTORS  
TO FIXTURES.

POLE A-4  
EXISTING CONCRETE BASE MOUNTED  
TENNIS COURT LIGHT POLE & FIXTURES (3)  
CONNECT NEW CONDUIT THROUGH EXISTING  
3/4" IN BASE, EXTEND NEW CONDUCTORS  
TO FIXTURES.

ADD GROUND ROD TO EACH POLE

NEW 3 - #8 1" HDPE ABANDON EXISTING  
CONDUIT AND CONDUCTORS IN PLACE

**DRAWING KEY NOTES**  
1. CONTRACTOR TO CONTACT COM ED AT 1-800-354-7661  
14 DAYS PRIOR TO STARTING WORK TO SCHEDULE  
SERVICE SHUT DOWN OF EXISTING METER + PANEL.

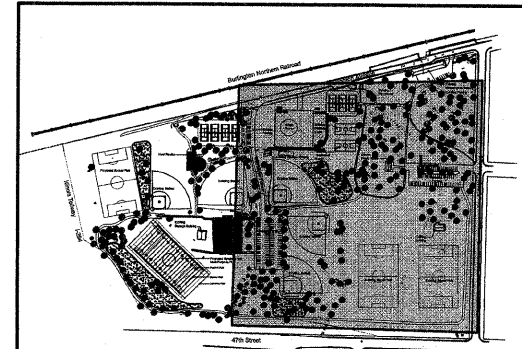
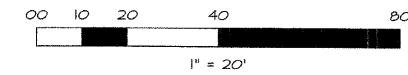

KEY MAP  
SPRING ROCK PARK

FA RITE	SECTION	COUNTY
---	05-P4096-00-PK	COOK
FED. ROAD DIST. NO.	ILLINOIS	CONTRACT NO. 63060

REVISIONS	DATE	BY
PER IDOT COMMENTS	6-19-08	JFG
PER IDOT COMMENTS	6-24-08	JFG
PER IDOT COMMENTS	7-18-08	JFG
PER IDOT COMMENTS	7-25-08	JFG

**W-T CIVIL ENGINEERING, LLC.**  
**CIVIL AND STRUCTURAL ENGINEERS**  
 2075 Pratum Avenue  
 Hoffman Estates, Illinois 60132  
 PH: (224) 293-6333 FAX: (224) 293-6444  
 www.wtengineering.com  
 IL License No.: 184-003492 Exp: 04/30/09



**SPRING ROCK PARK**  
**CENTRAL AVE & 47TH ST**  
**WESTERN SPRINGS, IL**

**TENNIS COURT**  
**ELECTRICAL**  
**PLAN**

DATE:	05/23/08
SCALE:	1" = 50'
DRAWN:	JFG
CHECK:	TOA
JOB:	CE06316
SHEET	21 OF 26