

F.A.P. RTE.	SECTION	COUNTY	TOTAL SHEET SHEETS	NO.
*	**	DEWITT	64	1

\*FAP 721 & 760  
 \*\*SECTION 114BR-2 & 124BR-1  
**CONTRACT NO. 70014**  
 D-95-020-99

STATE OF ILLINOIS  
 DEPARTMENT OF TRANSPORTATION  
 DIVISION OF HIGHWAYS

# PLANS FOR PROPOSED HIGHWAY IMPROVEMENT

PLAN = 1" = 20'  
 PROFILE HORIZ = 1" = 20'  
 VERT = 1" = 5'  
 CROSS SECTIONS HORIZ = 1" = 10'  
 VERT = 1" = 5'

FOR INDEX OF SHEETS, SEE SHEET NO. 2  
 FOR SUMMARY OF QUANTITIES, SEE SHEET NO. 3

J.U.L.I.E.  
 JOINT UTILITY LOCATION INFORMATION FOR EXCAVATION  
 1-800-892-0123  
 NIXON TOWNSHIP

**DESIGN DESIGNATION**  
 N.A. (BOX CULVERT REPLACEMENT)

FAP ROUTE 721 & 760 (IL-10 & IL-48)  
 SECTION 114BR-2 & 124BR-1  
 PROJECT NO F-000S(599)  
 BOX CULVERT REPLACEMENTS  
 DEWITT COUNTY  
 C-95-048-99

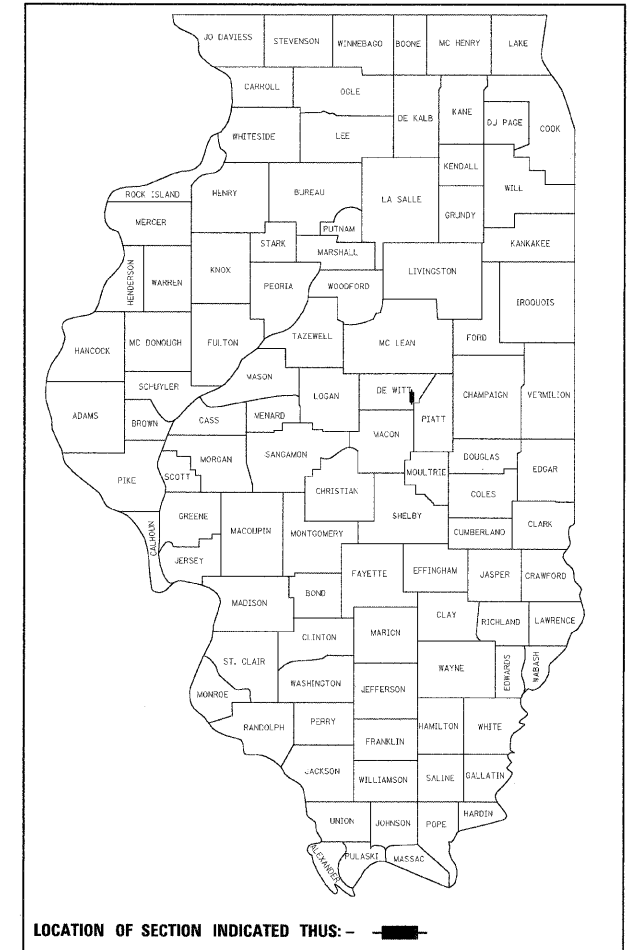

**ENGLISH RATIOS**

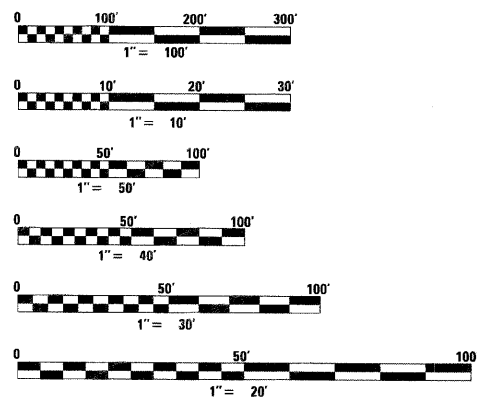

FULL SIZE PLANS HAVE BEEN PREPARED USING STANDARD ENGINEERING SCALES. REDUCED SIZED PLANS WILL NOT CONFORM TO STANDARD SCALES. IN MAKING MEASUREMENTS ON REDUCED PLANS, THE ABOVE SCALES MAY BE USED.

SECTION 124BR-1  
 BEGIN STA 72+65.00  
 END STA 73+39.50

SECTION 124BR-1 INCLUDES A DOUBLE 10' X 10' REINFORCED CONCRETE BOX CULVERT (CARRYING ILLINOIS ROUTE 48 OVER TRIBUTARY TO FRIENDS CREEK DITCH) STA 73+02.00 SN 020-2011 (PROPOSED) SN 020-0039 (EXISTING)

SECTION 114BR-2  
 BEGIN STA 672+94.50  
 END STA 674+92.50

SECTION 114BR-2 INCLUDES A DOUBLE 12' X 12' REINFORCED CONCRETE BOX CULVERT (CARRYING ILLINOIS ROUTE 10 OVER FRIENDS CREEK DITCH) STA 673+93.40 SN 020-2010 (PROPOSED) SN 020-0038 (EXISTING)

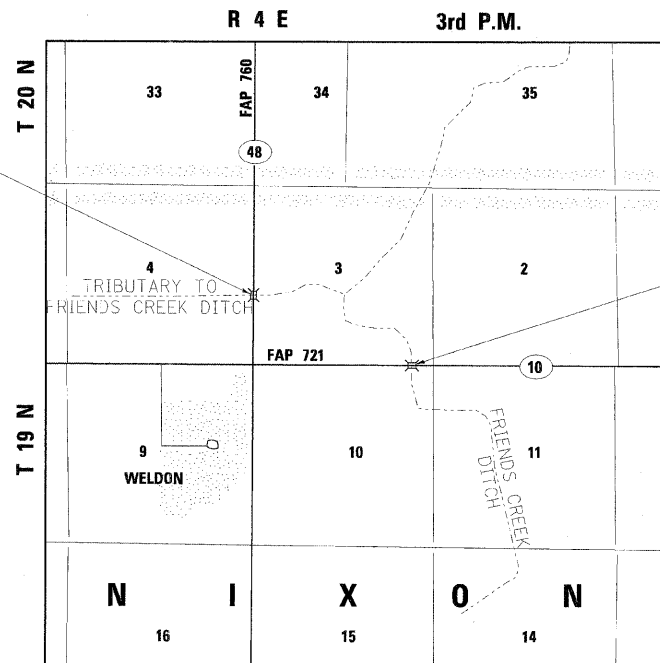

LOCATION MAP  
 NIXON TOWNSHIP

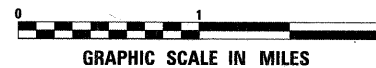

GROSS LENGTH OF SECTION 114BR-2 = 198 FT = .038 MI  
 NET LENGTH SECTION 114BR-2 = 198 FT

GROSS LENGTH OF SECTION 124BR-1 = 74.5 FT = .014 MI  
 NET LENGTH SECTION 124BR-1 = 74.5 FT

NET LENGTH PROJECT = 272.50 FT = .052 MI



*Jason A. Wattiers*  
 ILLINOIS PROFESSIONAL ENGINEER NO. 062-050429 DATE 03-17-2004  
 EXP. 11-30-2005

STATE OF ILLINOIS  
 DEPARTMENT OF TRANSPORTATION  
 DIVISION OF HIGHWAYS

SUBMITTED *July 9, 2008*

*[Signature]*  
 DISTRICT ENGINEER

*August 15, 2008*  
*Eric E. Harnett*  
 ENGINEER OF DESIGN AND ENVIRONMENT

*August 15, 2008*  
*Christine M. Reed*  
 DIRECTOR, DIVISION OF HIGHWAYS

**WOOLPERT**  
 WOOLPERT LLP  
 4315 North Illinois Street,  
 Suite 1C  
 Belleville, Illinois 62226-1045  
 618-277-7004  
 Fax-618-277-6114

**PRINTED BY THE AUTHORITY  
 OF THE STATE OF ILLINOIS**

HIGHWAY CLASSIFICATION	MINOR ARTERIAL
2000 ADT IL 10	1950 9.3% TRUCKS
2000 ADT IL 48	1300 9.4% TRUCKS
2020 ADT IL 10	2300 9.3% TRUCKS
2020 ADT IL 48	1500 9.4% TRUCKS

**CONTRACT NO. 70014**

N. FASIG PROJECT ENGINEER : 217-465-4181  
 J. STULTS CONSULTANT LIAISON CONTACT:

I:\V\PROJ\0473\fig\cover.dgn 03/17/2004 11:10:10 AM