

F.A.P. RTE.	SECTION	COUNTY	TOTAL SHEETS	SHEET NO.
721 & 760	114BR-2 & 124BR-1	DEWITT	64	9
STA.		TO STA.		
FED. ROAD DIST. NO.		ILLINOIS FED. AID PROJECT		
FAP 721 & 760		SECTION 114BR-2 & 124BR-1		
		CONTRACT NO. 70014		

NOTES:  
 ALL SIGNAGE, SPACING, TRAFFIC CONTROL EQUIPMENT AND TEMPORARY PAVEMENT MARKINGS SHALL BE IN ACCORDANCE WITH THE LATEST VERSION OF HIGHWAY STANDARD 701321.  
 ALL TEMPORARY BRIDGE TRAFFIC SIGNALS FOR STAGE I AND II WILL BE MEASURED AS 1 UNIT.  
 RCA AND SIGNAL AHEAD SIGNS SHALL BE PLACED AT ANY SIDEROAD LOCATED WITHIN THE MAINLINE TRAFFIC CONTROL SIGNING LIMITS. THE LOCATIONS TO BE DETERMINED BY THE ENGINEER. THESE SIGNS WILL NOT BE MEASURED FOR PAYMENT, BUT WILL BE INCLUDED IN THE VARIOUS TRAFFIC CONTROL ITEMS.

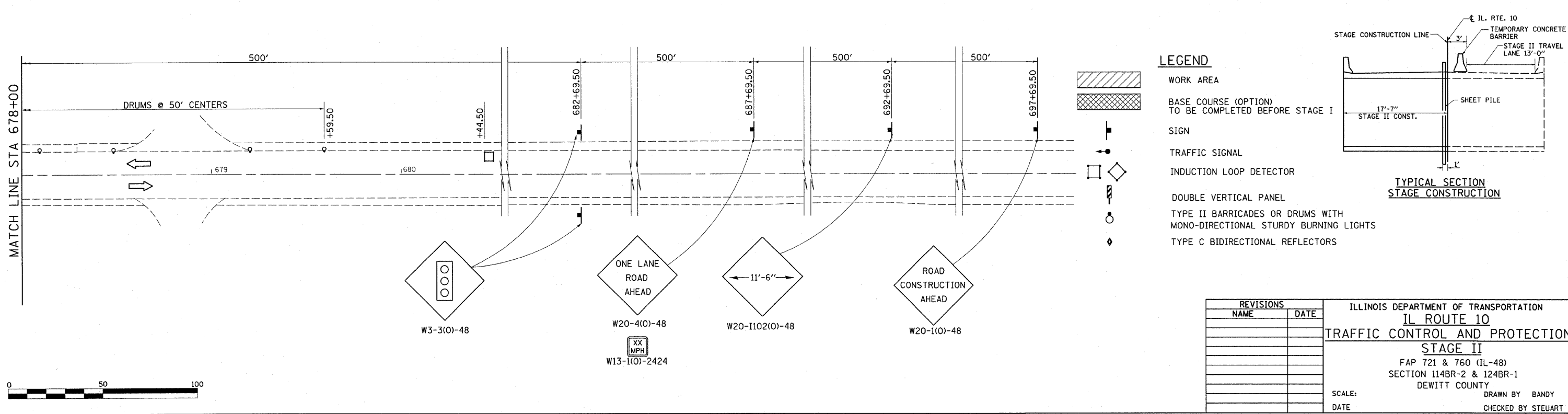
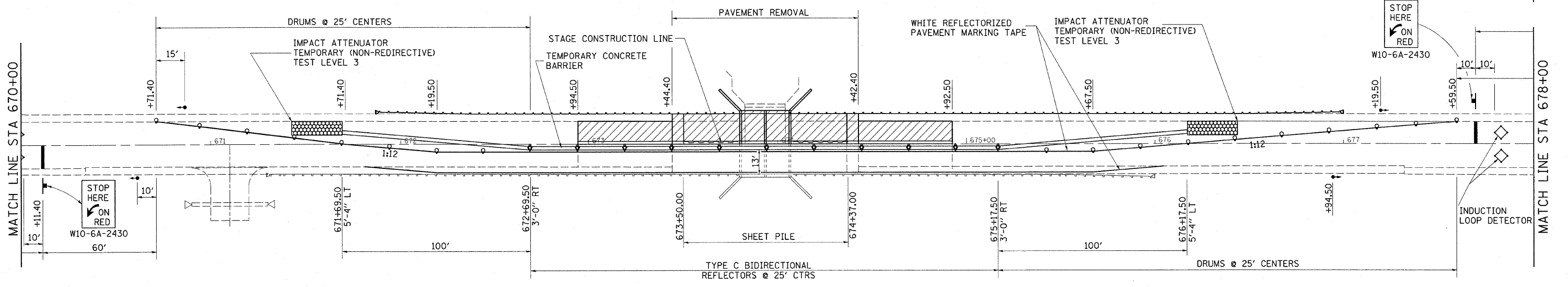
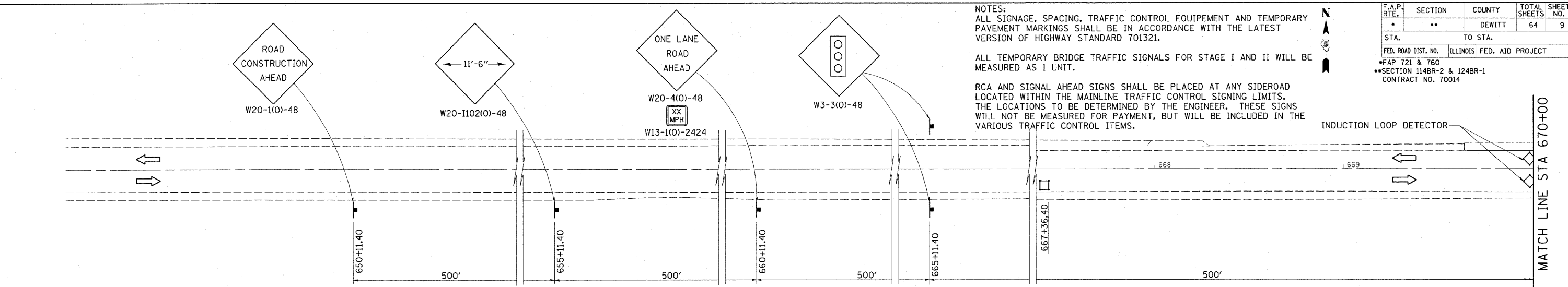

- LEGEND**
- WORK AREA
  - BASE COURSE (OPTION) TO BE COMPLETED BEFORE STAGE I
  - SIGN
  - TRAFFIC SIGNAL
  - INDUCTION LOOP DETECTOR
  - DOUBLE VERTICAL PANEL
  - TYPE II BARRICADES OR DRUMS WITH MONO-DIRECTIONAL STURDY BURNING LIGHTS
  - TYPE C BIDIRECTIONAL REFLECTORS

REVISIONS	
NAME	DATE

ILLINOIS DEPARTMENT OF TRANSPORTATION  
**IL ROUTE 10**  
**TRAFFIC CONTROL AND PROTECTION**  
**STAGE II**  
 FAP 721 & 760 (IL-48)  
 SECTION 114BR-2 & 124BR-1  
 DEWITT COUNTY  
 SCALE: \_\_\_\_\_ DRAWN BY BANDY  
 DATE \_\_\_\_\_ CHECKED BY STEUART

