

SEC 3, T 19 N, R 4 E, 3RD P.M.

F.A.P. RTE.	SECTION	COUNTY	TOTAL SHEETS	SHEET NO.
721	114BR-2	DEWITT	64	12
STA. 665+00		TO STA. 671+00		
FED. ROAD DIST. NO.		ILLINOIS	FED. AID PROJECT	
CONTRACT NO. 70014				

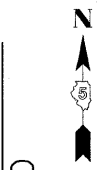
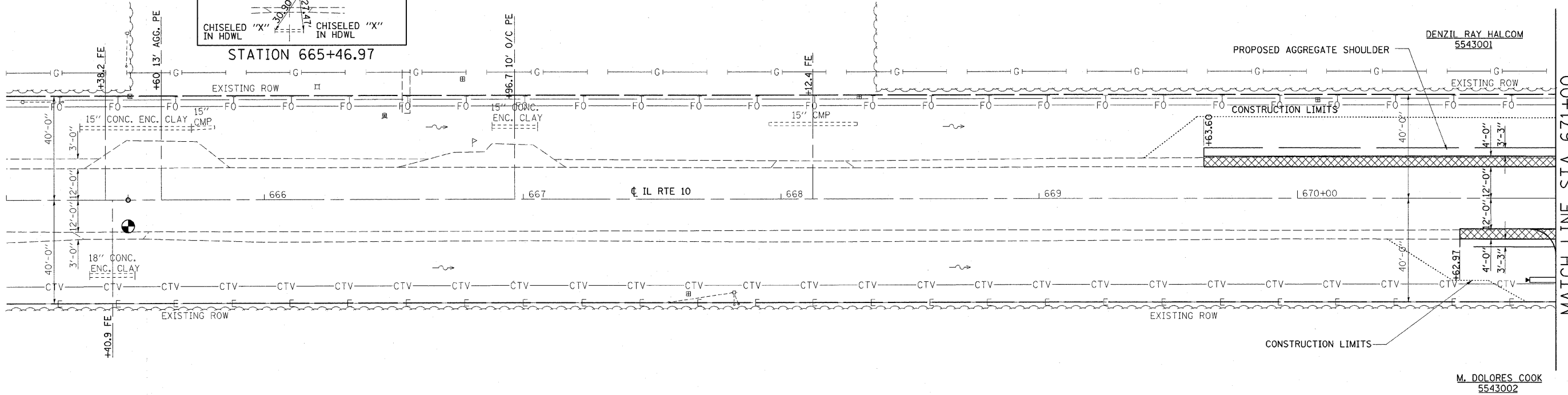
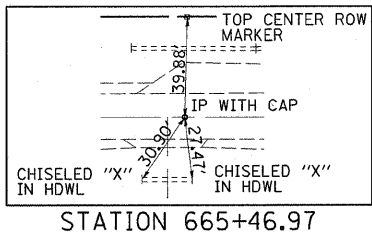

MATCH LINE STA 671+00

PROPOSED BASE COURSE OPTION

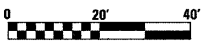

PLAN	SURVEYED	DATE
	PLOTTED	
	CHECKED	
	BY	
	NO. OF WAY CHECKED	
	DATE FILE NAME	

PROFILE	SURVEYED	DATE
	PLOTTED	
	CHECKED	
	BY	
	NO. OF WAY CHECKED	
	DATE FILE NAME	

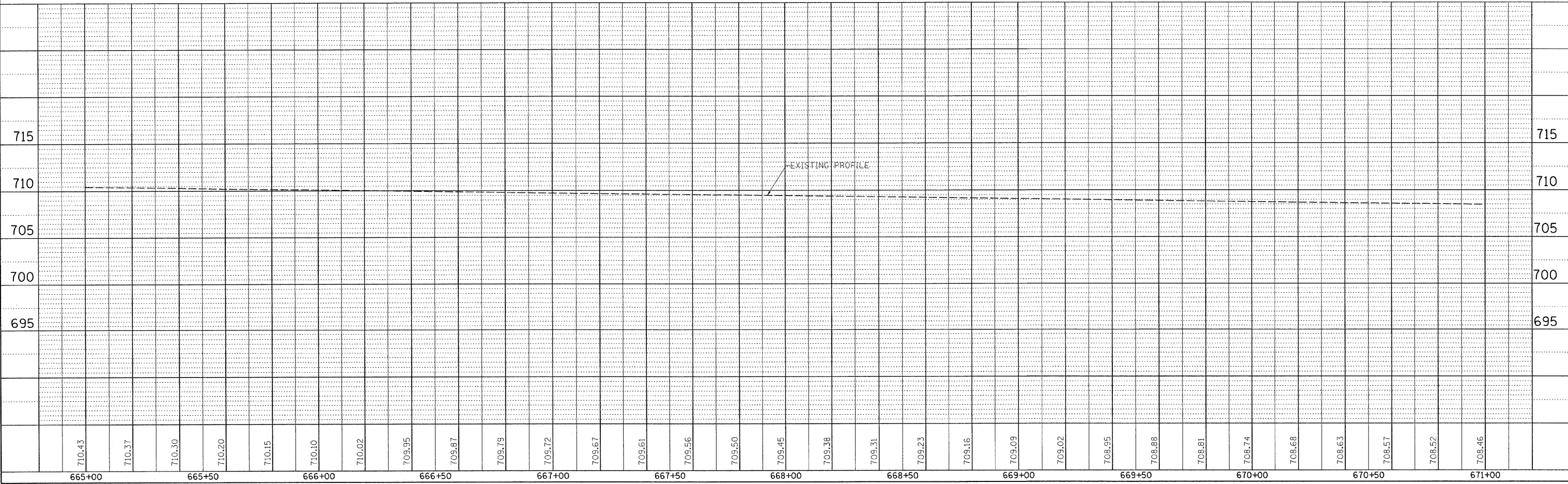

PLAN AND PROFILE, FAP ROUTE 721 (IL-10), STA 665+00 TO STA 671+00