

F.A.P. RTE.	SECTION	COUNTY	TOTAL SHEETS	SHEET NO.
721	114BR-2	DEWITT	64	13
STA.		TO STA.		
FED. ROAD DIST. NO.		ILLINOIS FED. AID PROJECT		
CONTRACT NO. 70014				

SECTION 114 BR-2 BEGINS STATION 672+94.50

SECTION 114 BR-2 ENDS STATION 674+92.50

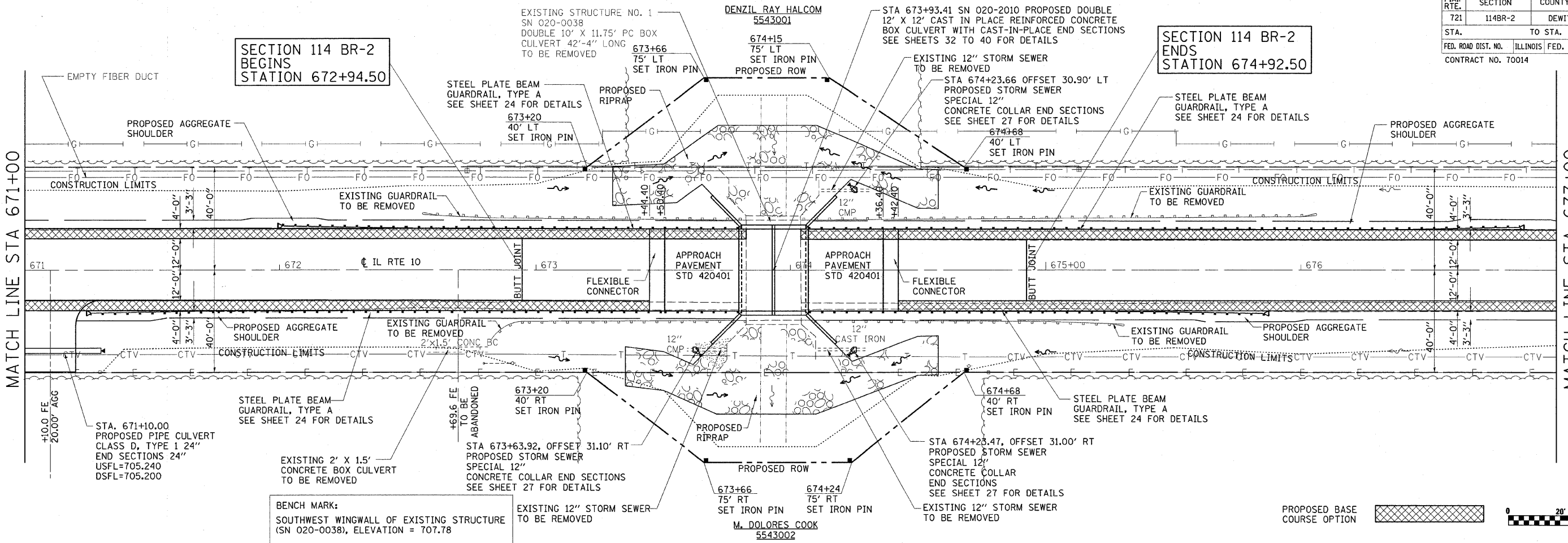

BENCH MARK:
SOUTHWEST WINGWALL OF EXISTING STRUCTURE (SN 020-0038), ELEVATION = 707.78



PLAN	SURVEYED	DATE
NO.	BY	
	PLOTTED	
	REVISIONS	
	BY	
	DATE	

PROFILE	SURVEYED	DATE
NO.	BY	
	PLOTTED	
	REVISIONS	
	BY	
	DATE	

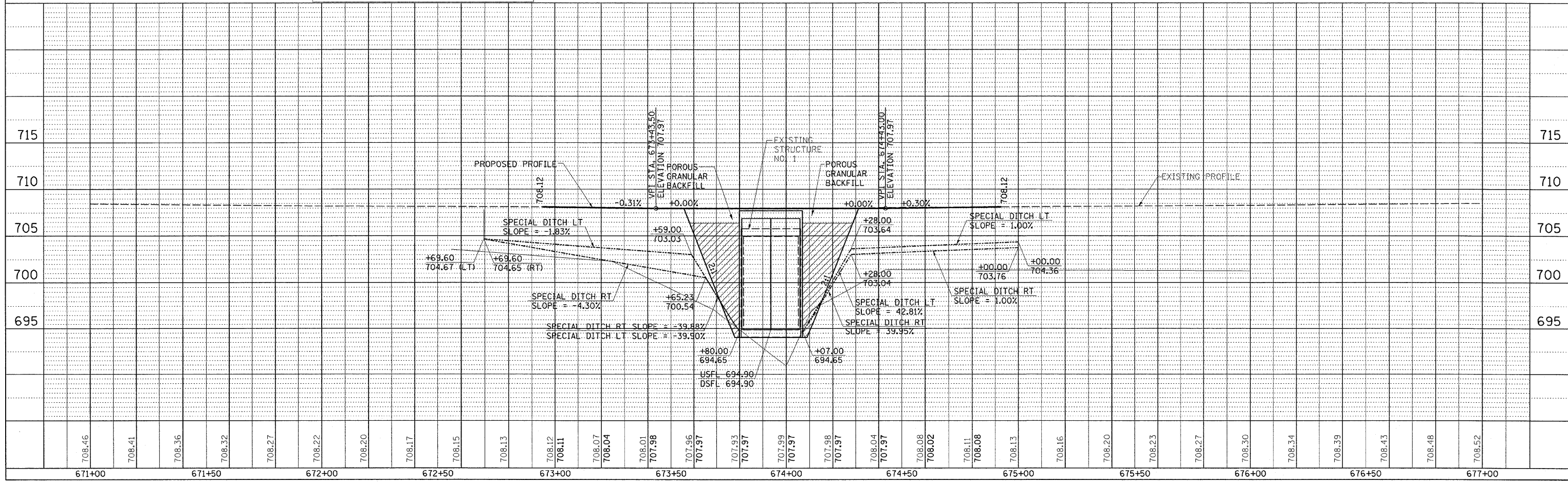

PLAN AND PROFILE, FAP ROUTE 721 (IL-10), STA 671+00 TO STA 677+00