

SEC 3, T 19 N, R 4 E, 3RD P.M.

F.A.P. RTE.	SECTION	COUNTY	TOTAL SHEETS	SHEET NO.
721	114BR-2	DEWITT	64	14
STA. 677+00		TO STA. 683+00		
FED. ROAD DIST. NO.	ILLINOIS	FED. AID PROJECT		
CONTRACT NO. 70014				

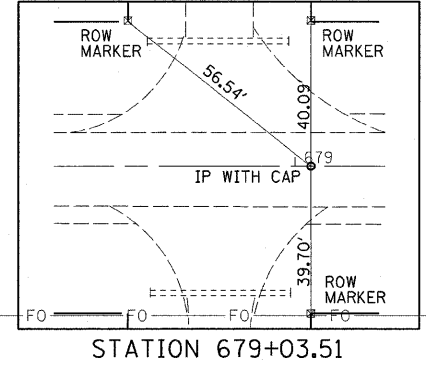
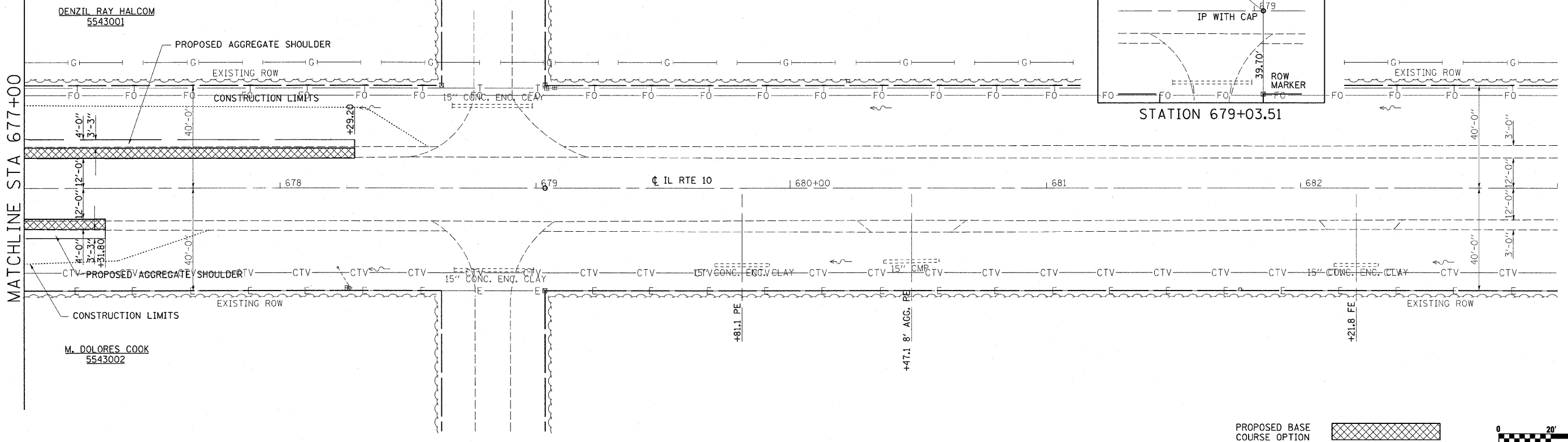

PLAN	SURVEYED	DATE
	BY	
	PLOTTED	
	CHECKED	
	BY	
	NOTE BOOK	
	NO.	
	STRUCTURE	
	NOTATIONS	
	CHFD	

PROFILE	SURVEYED	DATE
	BY	
	PLOTTED	
	CHECKED	
	BY	
	NOTE BOOK	
	NO.	
	STRUCTURE	
	NOTATIONS	
	CHFD	

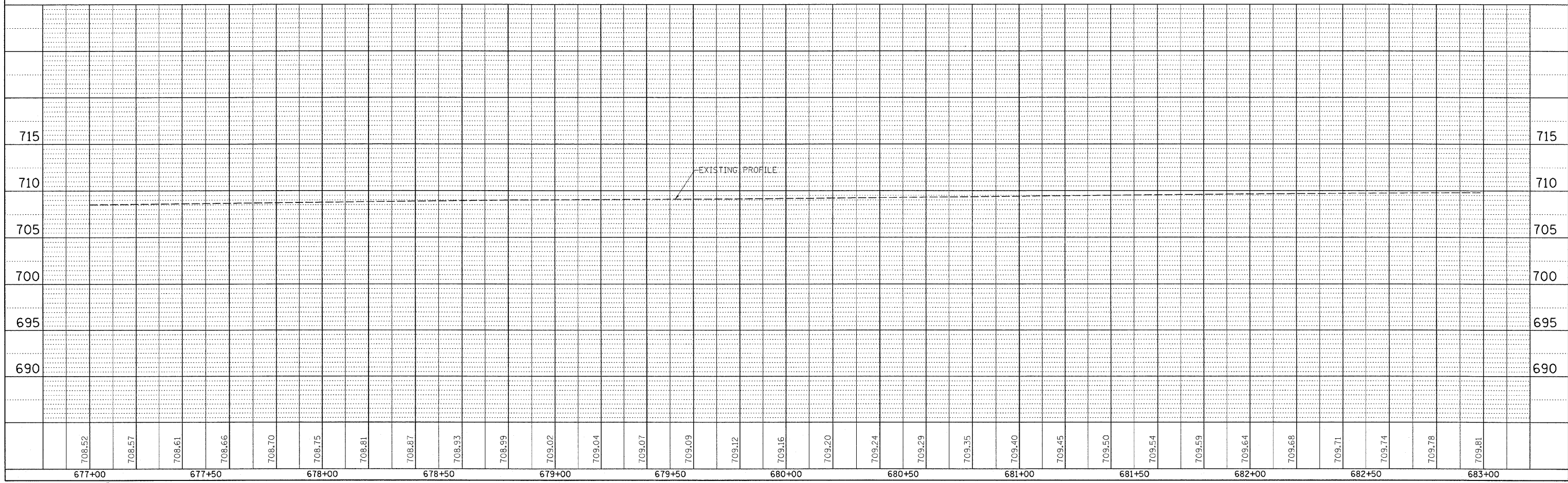

PLAN AND PROFILE, FAP ROUTE 721 (IL-10), STA 677+00 TO STA 683+00