

F.A.P. RTE.	SECTION	COUNTY	TOTAL SHEETS	SHEET NO.
310	60-(16B, 16-1B)	MADISON	62	6
STA. 156+00.00		TO STA. 161+50.00		
FED. ROAD DIST. NO.		ILLINOIS	FED. AID PROJECT	
CONTRACT NO. 76567				

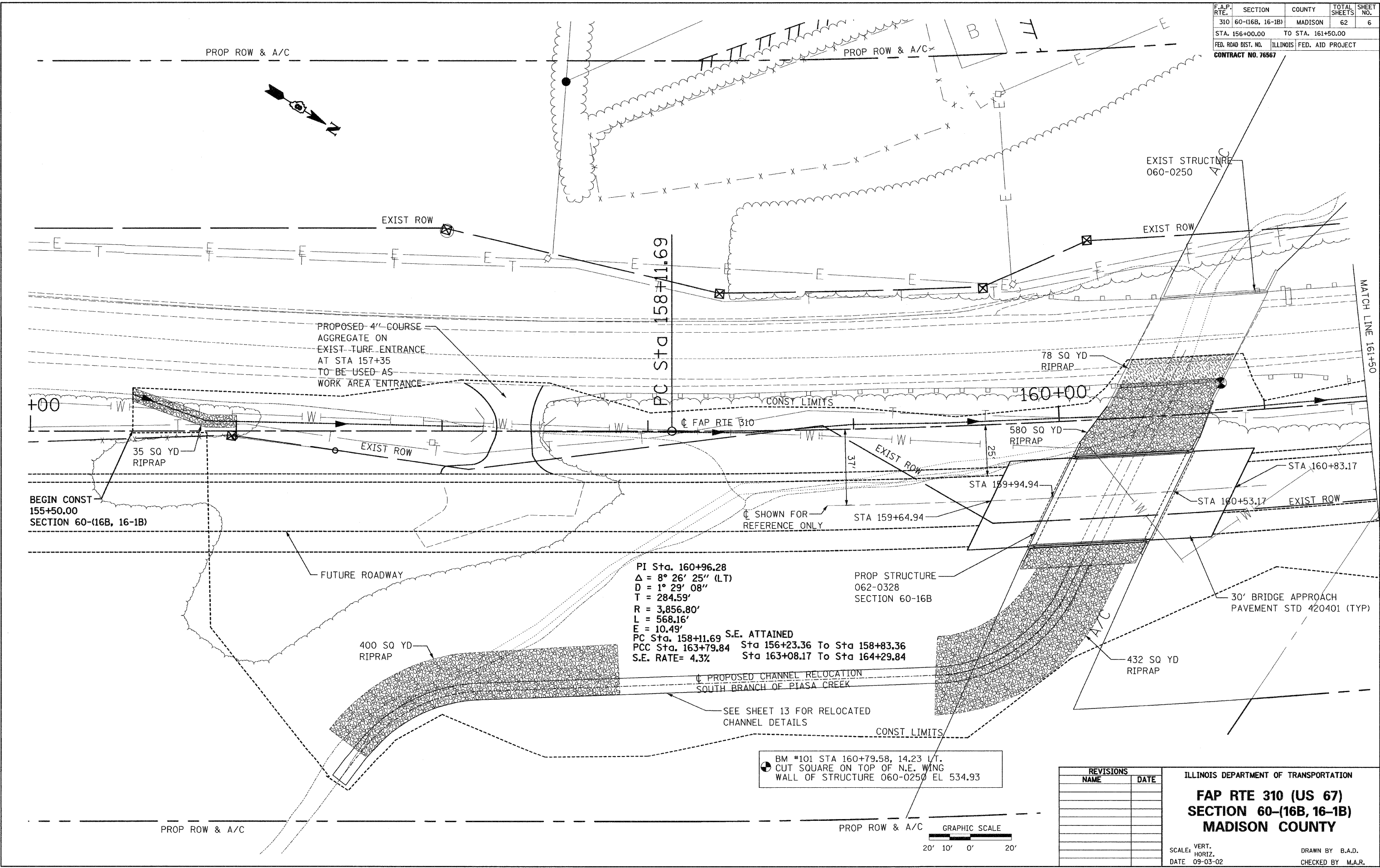

PI Sta. 160+96.28  
 $\Delta = 8^{\circ} 26' 25''$  (LT)  
 $D = 1^{\circ} 29' 08''$   
 $T = 284.59'$   
 $R = 3,856.80'$   
 $L = 568.16'$   
 $E = 10.49'$   
 PC Sta. 158+11.69 S.E. ATTAINED  
 PCC Sta. 163+79.84 Sta 156+23.36 To Sta 158+83.36  
 S.E. RATE= 4.3% Sta 163+08.17 To Sta 164+29.84

BM #101 STA 160+79.58, 14.23 L.T.  
 CUT SQUARE ON TOP OF N.E. WING  
 WALL OF STRUCTURE 060-0250 EL 534.93

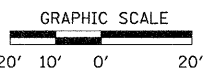

REVISIONS	
NAME	DATE

ILLINOIS DEPARTMENT OF TRANSPORTATION  
**FAP RTE 310 (US 67)**  
**SECTION 60-(16B, 16-1B)**  
**MADISON COUNTY**  
 SCALE: VERT. \_\_\_\_\_  
 HORIZ. \_\_\_\_\_  
 DATE 09-03-02  
 DRAWN BY B.A.D.  
 CHECKED BY M.A.R.