

STATE OF ILLINOIS
DEPARTMENT OF TRANSPORTATION

F.A.P. RTE.	SECTION	COUNTY	TOTAL SHEETS	SHEET NO.
310	60-(16B, 16-1B)	MADISON	62	23
STA. 160+24.00				
FED. ROAD DIST. NO.	ILLINOIS	FED. AID PROJECT		
CONTRACT NO. 76567				

Sheet No. 4
12 Sheets

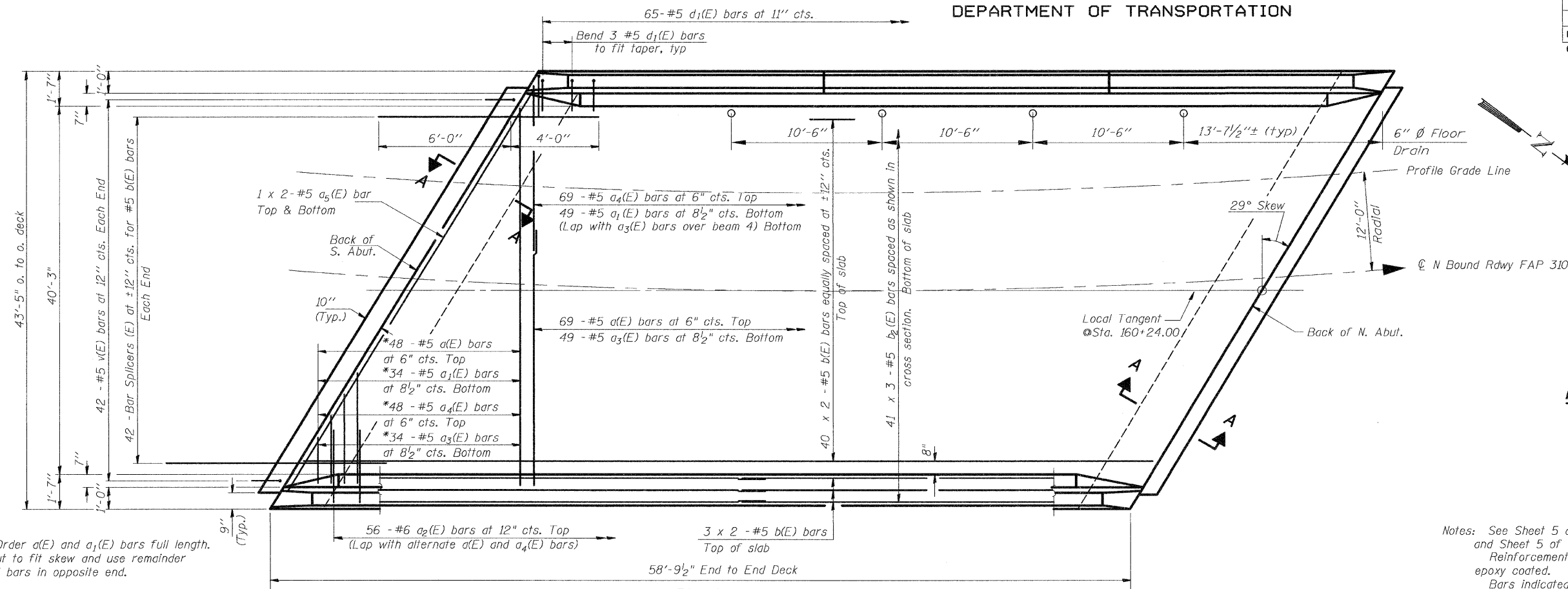

MIN. BAR LAP

#4 bar	= 1'-4"
#5 bar	= 1'-8"
#6 bar	= 2'-0"
#8 bar	= 3'-5"

Notes: See Sheet 5 and 6 of 12 for superstructure details and Sheet 5 of 12 for Bill of Material. Reinforcement bars designated (E) shall be epoxy coated. Bars indicated thus 40 x 2-#5 etc. indicates 40 lines of bars with 2 lengths per line. See Sheet 5 of 12 for parapet reinforcement. See Sheet 6 of 12 for section A-A

* Order a(E) and a1(E) bars full length. Cut to fit skew and use remainder of bars in opposite end.

PLAN

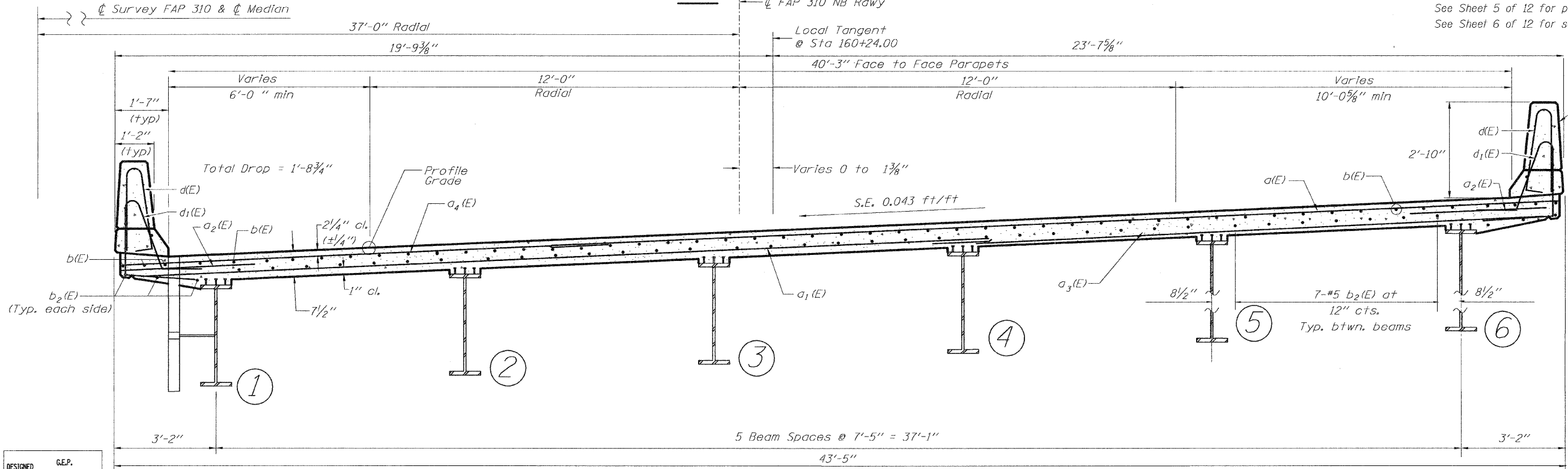

CROSS SECTION
(Looking Ahead)

SUPERSTRUCTURE DETAILS
FAP 310 (US 67)
OVER TRIB SOUTH BRANCH
OF PIASA CREEK
SECTION 60-(16B, 16-1B)
MADISON COUNTY
STA 160+24.00
SN 060-0328

DESIGNED	G.E.P.
CHECKED	J.L.G.
DRAWN	B.A.D.
CHECKED	J.L.G.

SI-2-L 12-21-00