

CONTRACT NO.: 83943

F.A.J. RTE.	SECTION	COUNTY	TOTAL SHEETS	SHEET NO.
3887	96-00159-00-CH	KANE	70	19
STA. 4+60.20		TO STA. 8+83.13		
FED. ROAD DIST. NO.	ILLINOIS	FED. AID PROJECT		

GRAPHIC SCALE

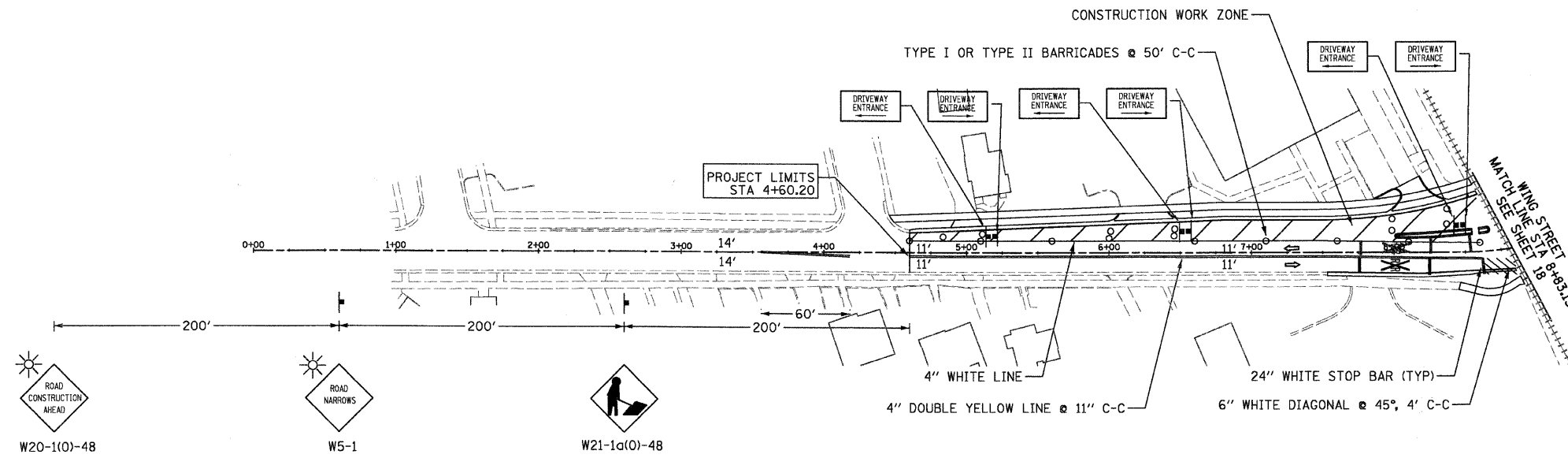
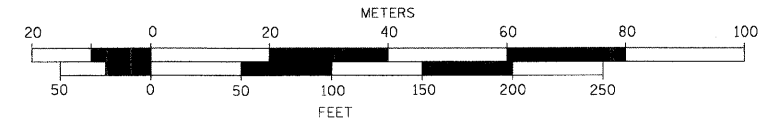

SYMBOLS

- TYPE I OR TYPE II BARRICADES AT 50' C-C TANGENTS; 25' C-C TAPERS; 12' C-C RADII (TYP)
- ┆ SIGN ON PORTABLE OR PERMANENT SUPPORT
- ☀ MONO-DIRECTIONAL FLASHING BEACON
- ARROW BOARD
- ▨ WORK ZONE

NOTES:

1. ALL TEMPORARY PAVEMENT MARKINGS WILL BE PAINT.
2. EXISTING MEDIANS AND ISLANDS SHALL BE REMOVED PRIOR TO STAGE 3.
3. SOUTH CURBLINE AND SIDEWALK TO BE CONSTRUCTED AFTER WIDENING IS COMPLETED AND PRIOR TO RESURFACING.

**RHA&A**  
 Robert H. Anderson & Associates, Inc.  
 Consulting Engineers  
 Timbers Professional Center  
 220 West River Drive, St. Charles, IL 60174  
 Phone - 630.584.3530 Fax - 630.584.3047

REVISIONS	
NAME	DATE

ILLINOIS DEPARTMENT OF TRANSPORTATION  
 ILLINOIS ROUTE 31 AND WING STREET

MAINTENANCE OF TRAFFIC  
 STAGE 3  
 STA 4+60.20 TO STA 8+83.13

SCALE: VERT. 1"=50'  
 HORIZ. 1"=50'  
 DATE: FEBRUARY 13, 2008

DRAWN BY: TC  
 DESIGN BY: TC  
 CHECKED BY: KMA

2/12/2008 H:\ELGIN\1.2981.4\DESIGN\ADGN\1.9M1187.DGN